



# **SKYLINE FASCIA** - 3&4 inch Chain Control

PRODUCT SPECIFICATIONS

# CONTENTS

<b>SECTION A   OVERVIEW</b>		<b>01</b>
GENERAL SCHEMATICS .....		01
SYSTEM OPTIONS .....		02
SYSTEM UPGRADES .....		02
COLOR OPTIONS ..		02
<b>SECTION B   SPECIFICATION IMAGES</b>		<b>03</b>
ARCHITECTURAL VIEWS .....		03
MAXIMUM ROLL DIAMETERS .....		04
FASCIA DEDUCTIONS + NOTCH .....		04
DEDUCTIONS .....		05
<b>SECTION C   ASSEMBLY &amp; INSTALLATION</b>		<b>07</b>
3" FASCIA - SKYLINE .....		07
4" FASCIA - SKYLINE .....		08
4" FASCIA - EASY LINK SYSTEM .....		09
4" FASCIA - INTERMEDIATE LINK SYSTEM .....		10
4" FASCIA - INFINITE ADJUSTER .....		10
TWO SHADES WITH ONE 4" FASCIA .....		12
TWO SHADES WITH TWO 4" FASCIA .....		12
4" ADJUSTABLE BRACKETS - SHADE TELESCOPING PREVENTION .....		12

## DISCLAIMER

**INTRODUCTION**  
This Product Specifications manual for Skyline 3&4" Fascia has been produced by Rollease Acmeda to supply the necessary information for the safe and correct installation of Skyline 3&4" Fascia.

**DISCLAIMER**  
Rollease Acmeda has used reasonable care in preparing the information included in this document, but makes no representations or warranties as to the completeness or accuracy of the information. Information is supplied upon the condition that the persons receiving the information will make their own determination as to its suitability for their purposes prior to use. Rollease Acmeda assumes no liability whatsoever for any damages incurred by you resulting from errors in or omissions from the information included herein. Rollease Acmeda reserves the right to make changes without further notice to any products to improve reliability, function or design.

**COPYRIGHT**  
COPYRIGHT © ROLLEASE ACMEDA  
All rights are reserved. No part of this document may be reproduced or utilised in any means, by any means, electronic or mechanical including photocopying, recordings, or by any information storage or retrieval system, without the express permission from Rollease Acmeda.

## GENERAL SCHEMATICS

### 3" FASCIA

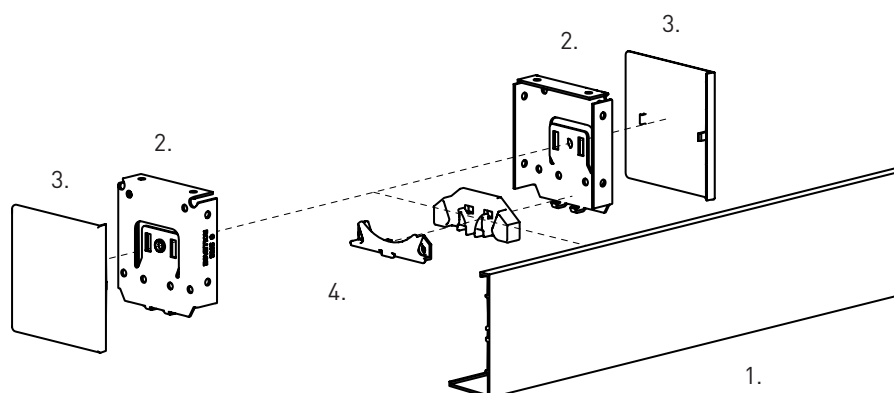

#### SYSTEM INDEX:

1. 3" Skyline Square Fascia
2. 3" Skyline Fascia Bracket
3. 3" Skyline Square End Cap
4. Chain Diverter & Cover Set

### 4" FASCIA

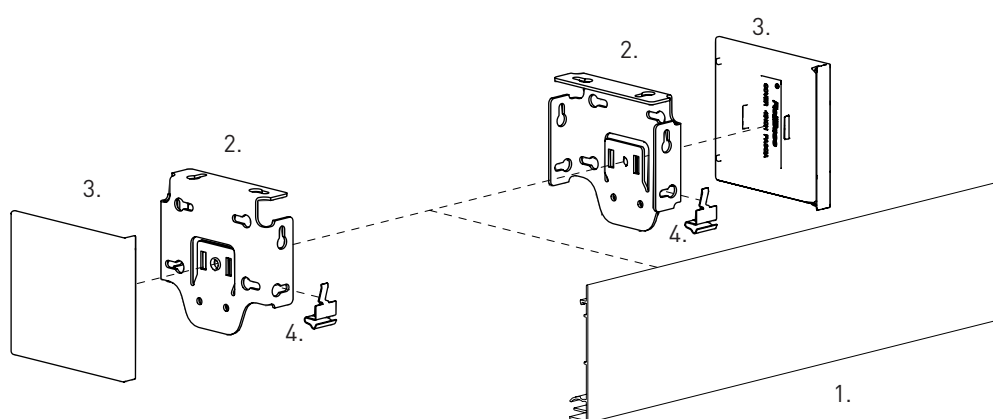

#### SYSTEM INDEX:

1. 4" Skyline Square Fascia
2. 4" Skyline Fascia Bracket
3. 4" Skyline Bracket Cover
4. Skyline Bracket Clip

## SYSTEM OPTIONS

### CONTROL OPTIONS



## SYSTEM UPGRADES

### SINGLE LINK SYSTEM

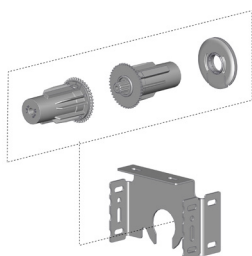

### LINK - ADJUSTABLE

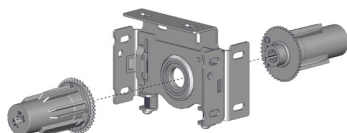

## COLOR OPTIONS

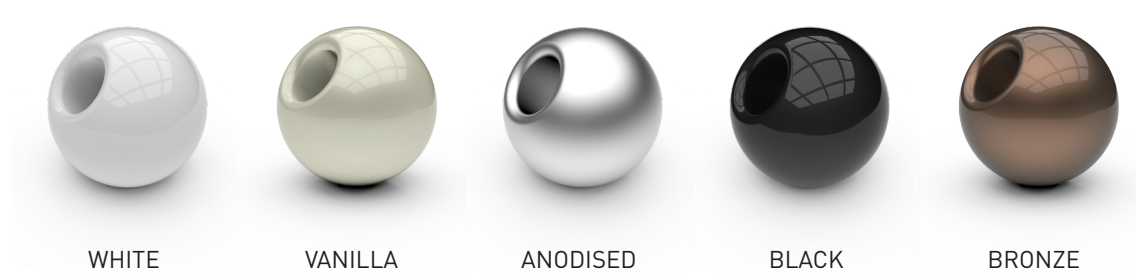

## ARCHITECTURAL VIEWS

### 3" FASCIA

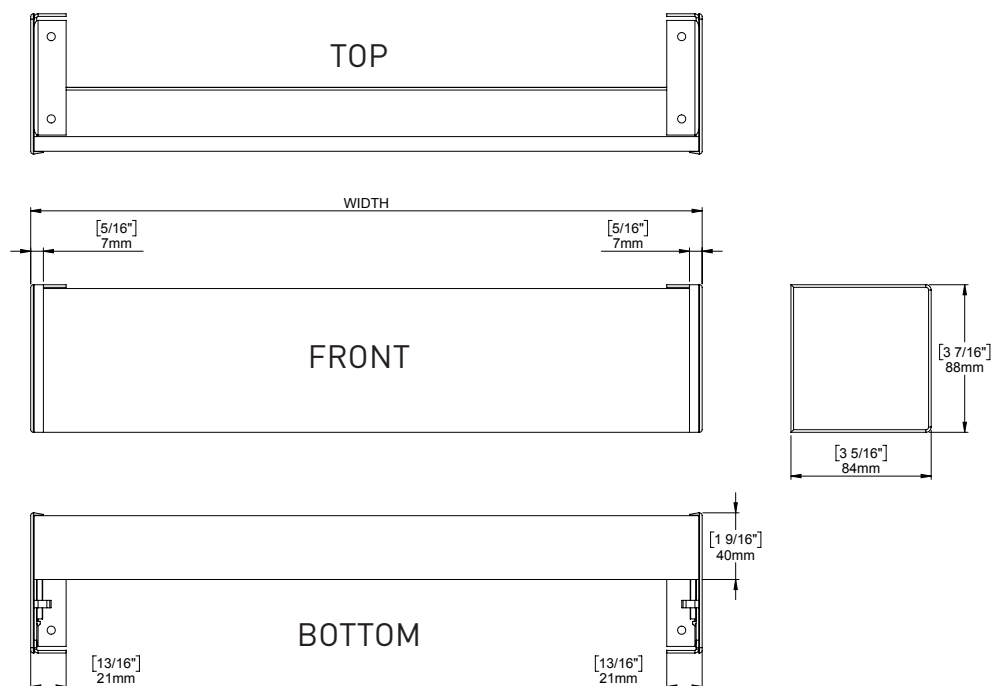

### 4" FASCIA

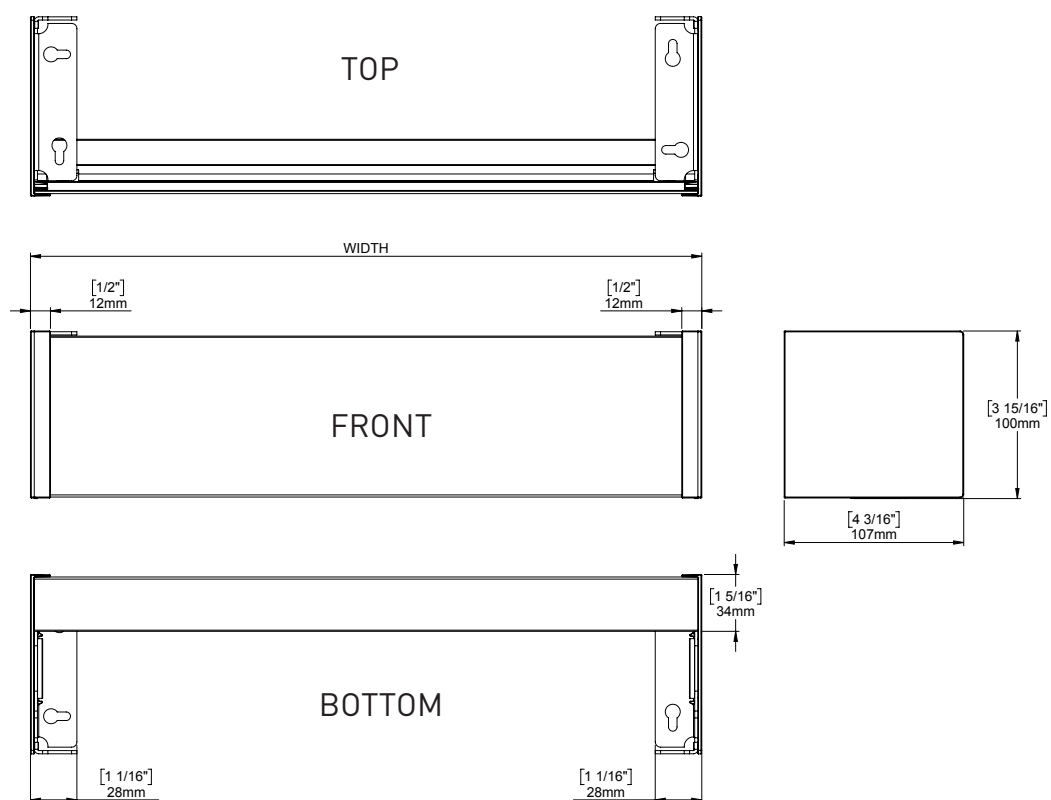

## MAXIMUM ROLL DIAMETERS

3" FASCIA

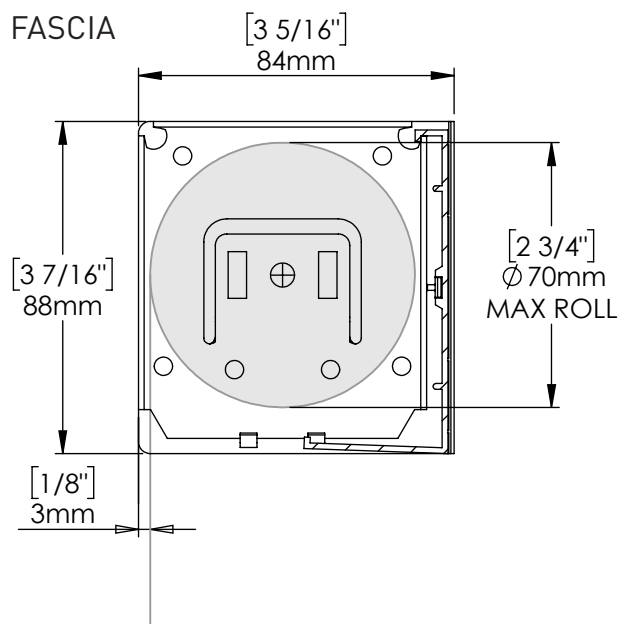

System	Tube	Max Distance from back of bracket X
3"	1-1/8"	24mm [15/16"]
	1-1/4"	22mm [7/8"]
	1-1/2"	19mm [3/4"]
	2"	13mm [1/2"]
	2-1/2"	19mm [3/4"]

4" FASCIA

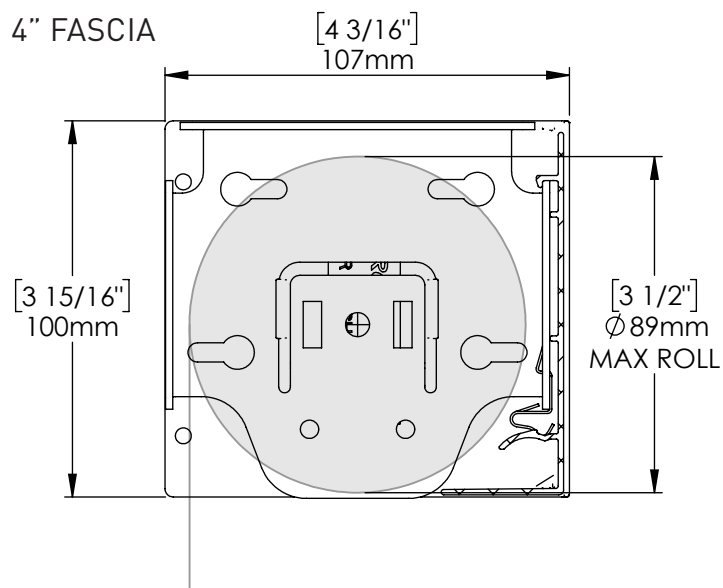

System	Tube	Max Distance from back of bracket X
4"	1-1/8"	37mm [1-7/16"]
	1-1/4"	35mm [1-3/8"]
	1-1/2"	32mm [1-1/4"]
	2"	26mm [1"]
	2-1/2"	19mm [3/4"]

## FASCIA DEDUCTIONS + NOTCH

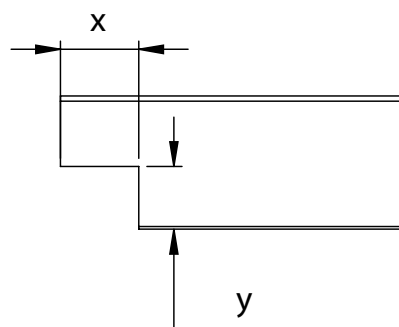
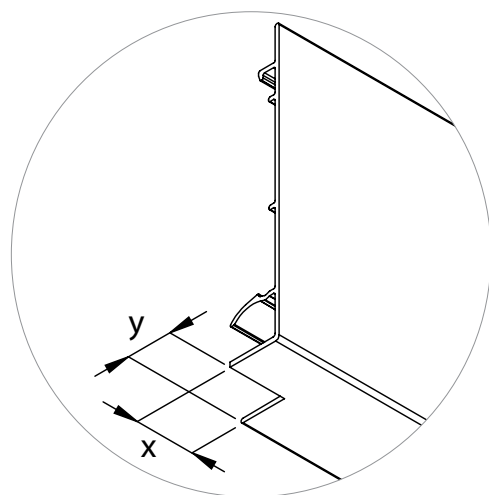

CONFIGURATION	NOTCH DIMENSIONS		FASCIA DEDUCTIONS	
	x	y	With Bracket Covers	Without Bracket Covers
3" FASCIA PANEL FOR ALL CLUTCHES	-	-	Shade Width - 4mm [0.16"]	Shade Width
4" FASCIA PANEL FOR SL15 CLUTCH	-	-		
4" FASCIA PANEL FOR SL20 CLUTCH	-	-		
4" FASCIA PANEL FOR G200 CLUTCH	-	-		
4" FASCIA PANEL FOR SL30 CLUTCH	20mm [3/4"]	16mm [5/8"]		
4" FASCIA PANEL FOR G400 CLUTCH	20mm [3/4"]	16mm [5/8"]		

## DEDUCTIONS

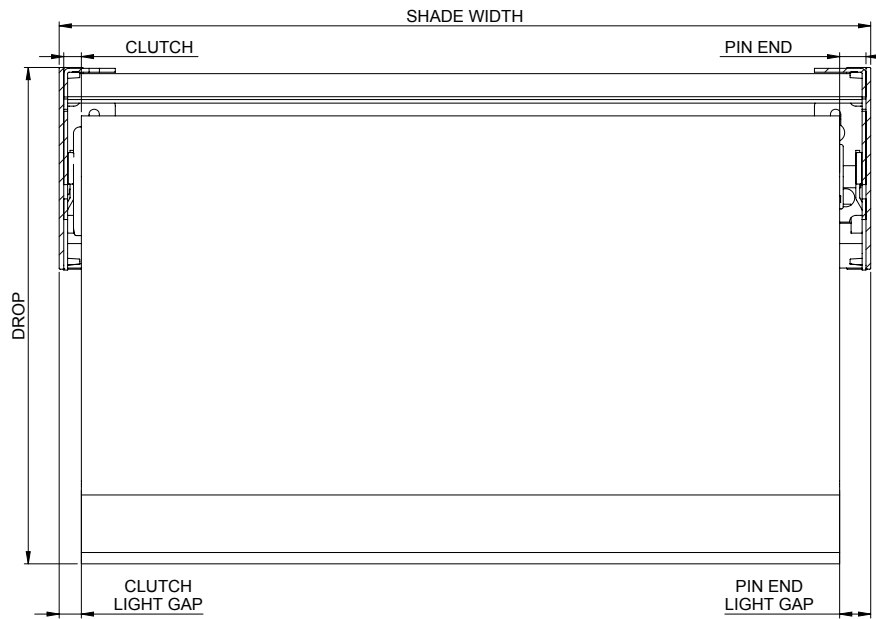

System	Tube	Clutch	Brackets	Pin End	Adapter	Chain Diverter	Tube Deduction		Light Gap with Bracket Covers*		
							With Bracket Covers	Without Bracket Covers	Control Side	Pin End Side	
3"	1-1/8"	SL10	SLFBKT3xx	SLPEV01xx	-	SL15CDCVR	32mm [1.26"]	28mm [1.10"]	17mm [0.67"]	15mm [0.59"]	
	1-1/4"	SL10		SLPEV03xx	SLA03xx	SL15CDCVR					
	1-1/2"	SL10		SLPEV53xx	SLA53xx	SL15CDCVR					
	1-1/8"	SL15		SLPEV01xx	-	SL15CDCVR					
	1-1/4"	SL15		SLPEV03xx	SLA03xx	SL15CDCVR					
	1-1/2"	SL15		SLPEV53xx	SLA53xx	SL15CDCVR					
	1-1/2"	SL20		SLPEV53xx	-	SLCDxx	34mm [1.33"]	30mm [1.17"]	19mm [0.74"]		
	2"	SL20		SLPEV53xx	RA2xx	SLCDxx					
	1-1/2"	G200		SLPEVHD53xx	-	SLCDxx	37mm [1.47"]	33mm [1.31"]	21mm [0.84"]	16mm [0.63"]	
	2"	G200		SLPEVHD53xx	RA2xx	SLCDxx					
4"	1-1/8"	SL15	SLFBKT4xx	SLPEV01xx	-	-	33mm [1.28"]	28mm [1.10"]	18mm [0.69"]	15mm [0.59"]	
	1-1/4"	SL15		SLPEV03xx	SLA03xx						
	1-1/2"	SL15		SLPEV653xx	SLA53xx						
	1-1/2"	SL20		SLPEV653xx	-		35mm [1.35"]	30mm [1.17"]	20mm [0.76"]	15mm [0.59"]	
	2"	SL20		SLPEV653xx	RA2xx		36mm [1.40"]	31mm [1.22"]	21mm [0.81"]	15mm [0.59"]	
	1-1/2"	SL30		SLPEV653xx	-		37mm [1.46"]	32mm [1.25"]	21mm [0.84"]	16mm [0.62"]	
	2"	SL30		SLPEV653xx	RA2xx		38mm [1.49"]	34mm [1.31"]	22mm [0.87"]	16mm [0.62"]	
	2-1/2"	SL30		SLPEV653xx	RA25xx		37mm [1.43"]	32mm [1.25"]	21mm [0.81"]	16mm [0.62"]	
	1-1/2"	G200		SLPEHD653xx	-		37mm [1.43"]	32mm [1.25"]	21mm [0.81"]	16mm [0.62"]	
	2"	G200		SLPEHD653xx	RA2xx						
	1-1/2"	G400		SLPEHD653xx	-						
	2"	G400		SLPEHD653xx	RA2xx						
	2-1/2"	G400		SLPEHD653xx	RA2xx						
NOTES	*For 3" Systems - Deduct 2mm [0.08"] from each side to for Light Gap "without bracket covers" value										
	*For 4" Systems - Deduct 3mm [0.09"] from each side to for Light Gap "without bracket covers" value										

## DEDUCTIONS

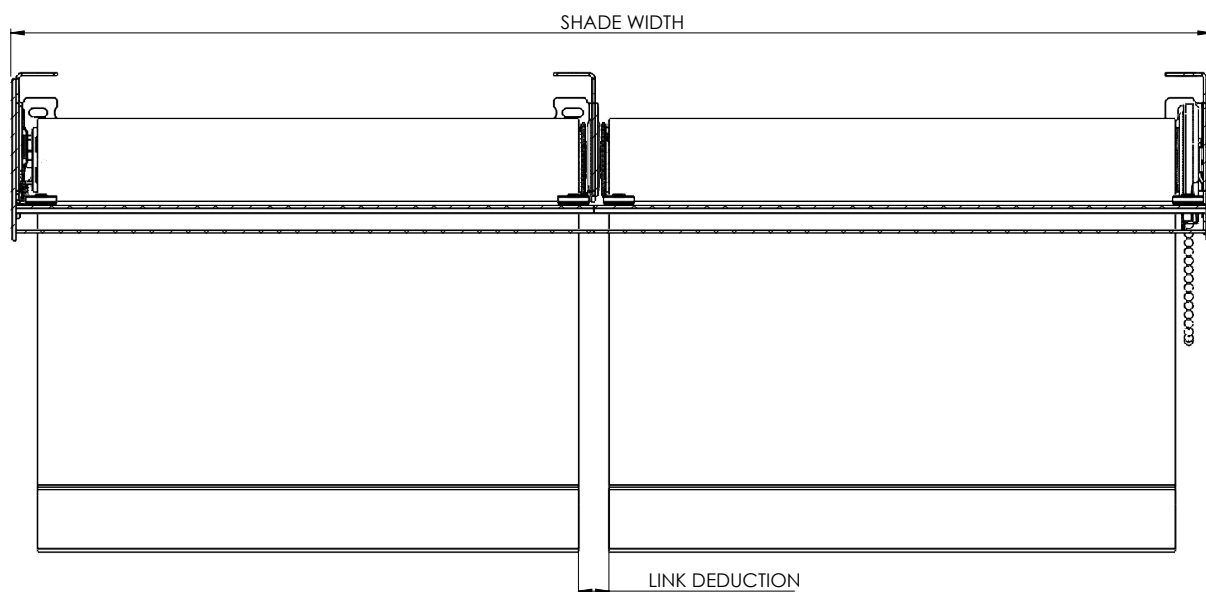

LINK SYSTEM	DEDUCTION
EASY-LINK	17mm [11/16"]
SKYLINE EASY-LINK	19mm [3/4"]
INFINITE LINK	18mm [11/16"]



## 3" FASCIA - SKYLINE

Wall Mount

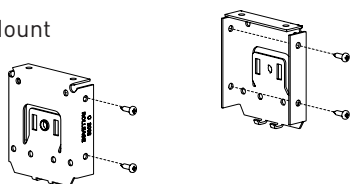

Inside Mount

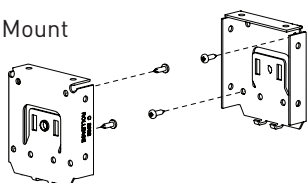

Ceiling Mount

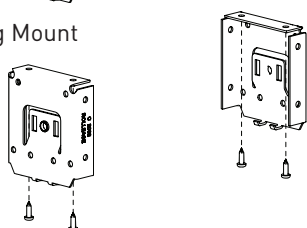

Attach Chain Diverter

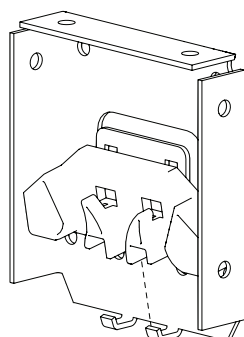

Align Clutch end first, swing assembly to bracket

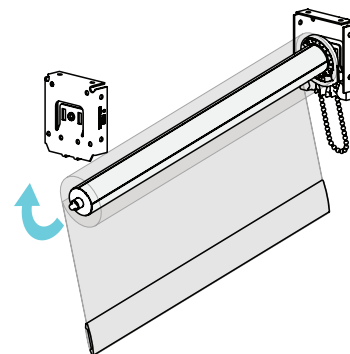

Ensure Clutch Hooks engage Bracket

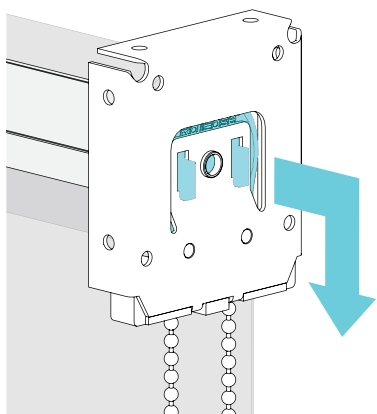

Align the chain in the diverter (SAME POSITION FOR ALL CLUTCHES)

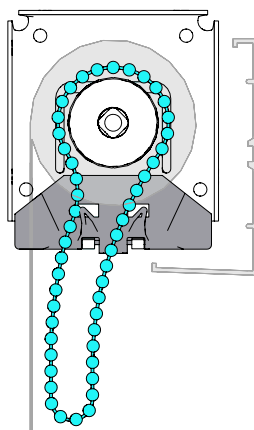

SL10 & SL15:  
Attach Chain Diverter Cover

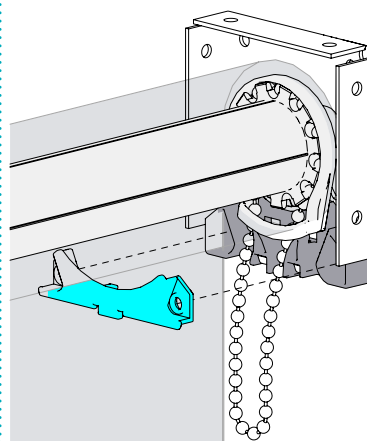

This allows room for fascia attachment

If needed, secure the cover with screws

SL20 & G200  
(No Cover)

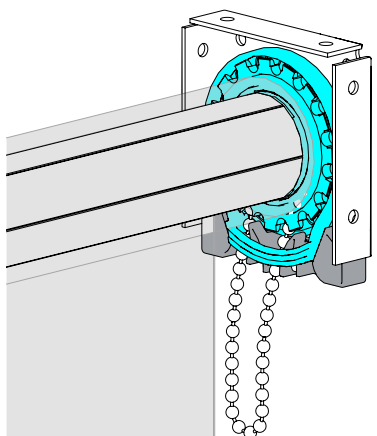

Attach Fascia Cover. Swing from top

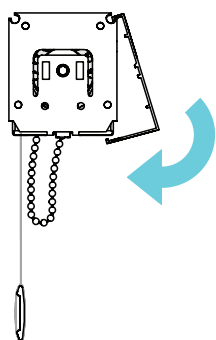

Attach Bracket Covers

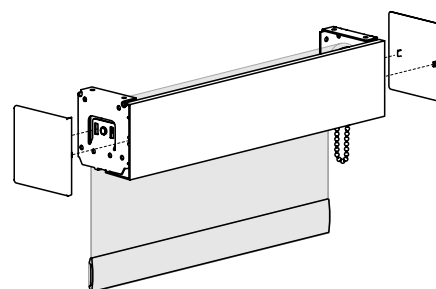

## 4" FASCIA - SKYLINE

Wall Mount

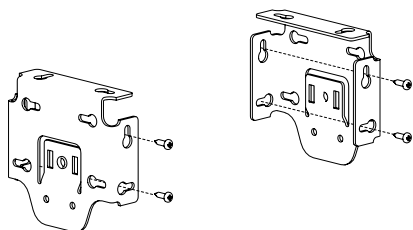

Ceiling Mount

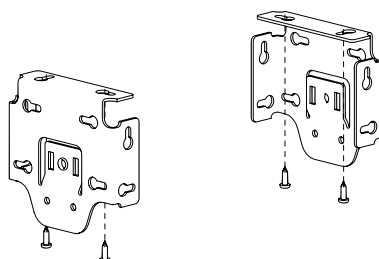

Inside Mount

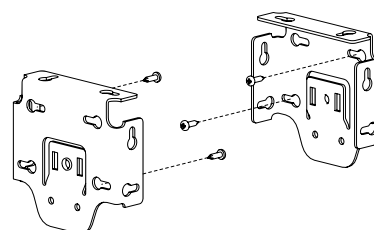

Compress Idler, swing assembly to bracket

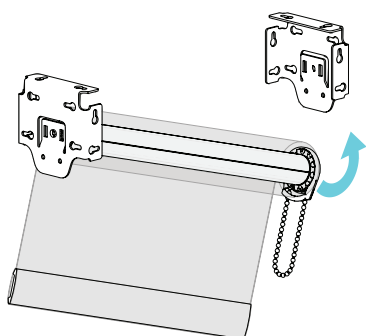

Ensure Clutch Hooks engage Bracket

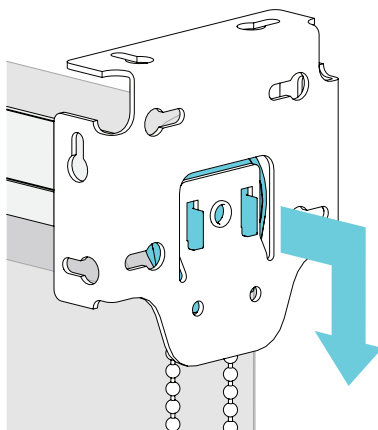

Attach Bracket Clip

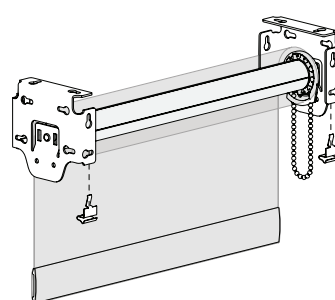

Attach Fascia Cover. Swing from top

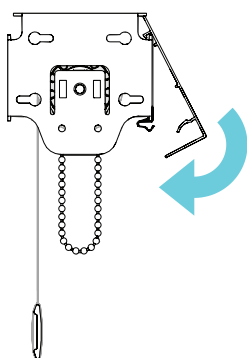

Attach Bracket Covers

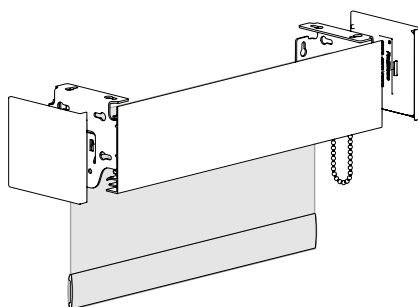

## 4" FASCIA - EASY LINK SYSTEM

Attach the bearing to the drive

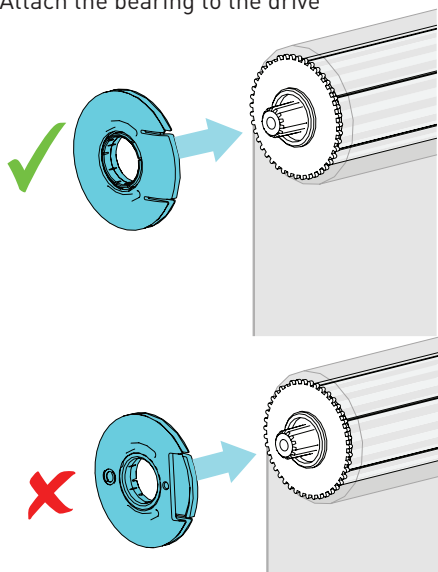

Ensure Clutch hooks engage with the bracket

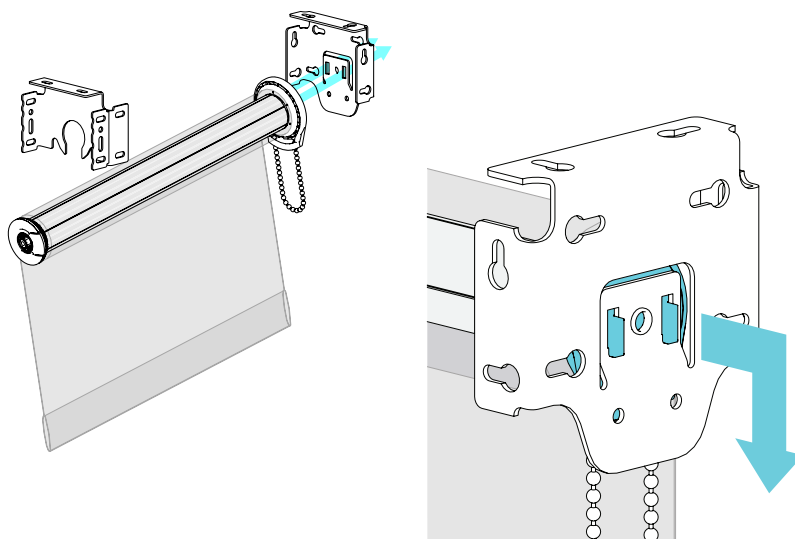

Swing in the Easy-Link End

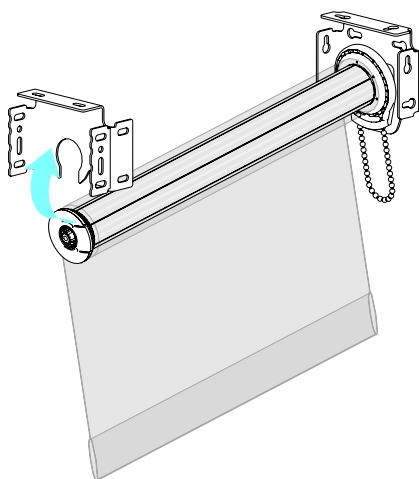

Rotate the Bracket Disk with the Skyline Bracket to lock the blind in place

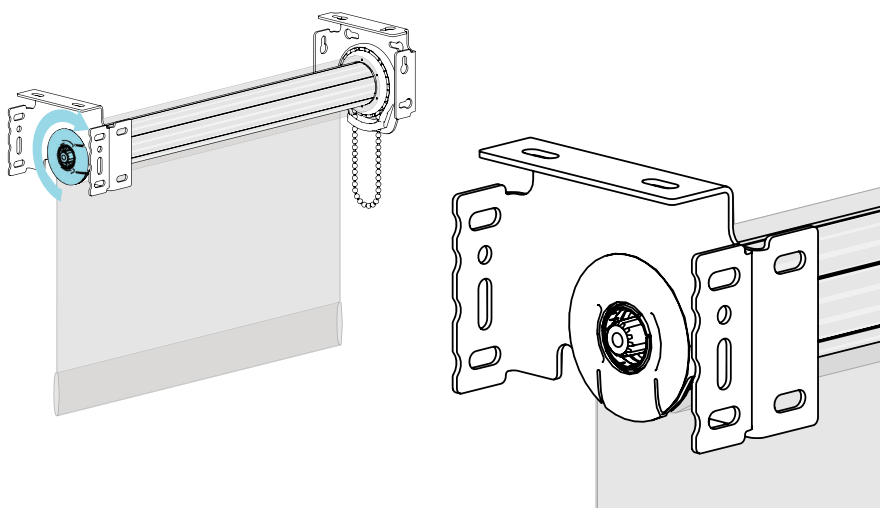

Ensure the Drive engages with the Bearing

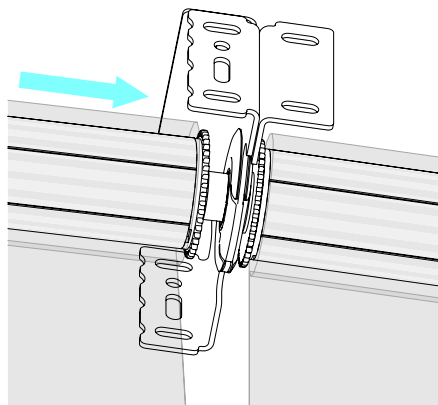

Attach the idler end to the bracket

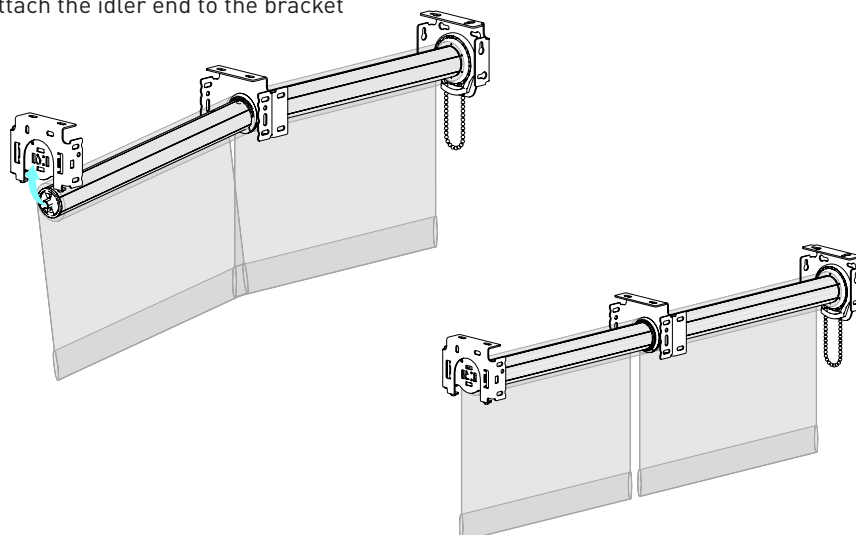

## 4" FASCIA - INTERMEDIATE LINK SYSTEM

Attach the bearing to the drive

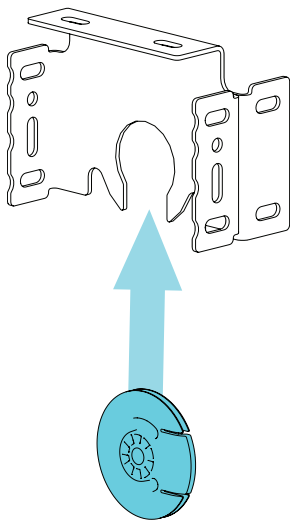

Rotate the Bracket Disk with the Skyline Bracket to lock the bearing in place

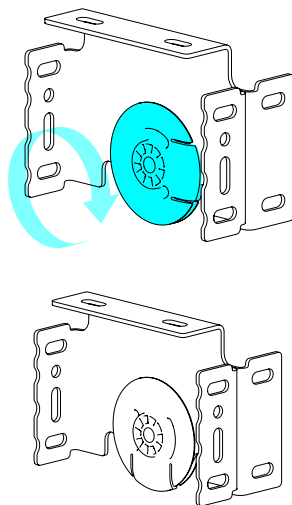

Ensure Clutch hooks engage with the bracket

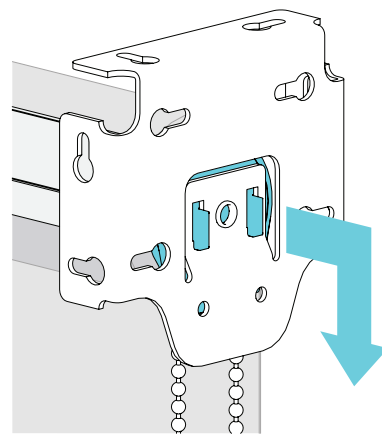

Attach the idler end to the bracket

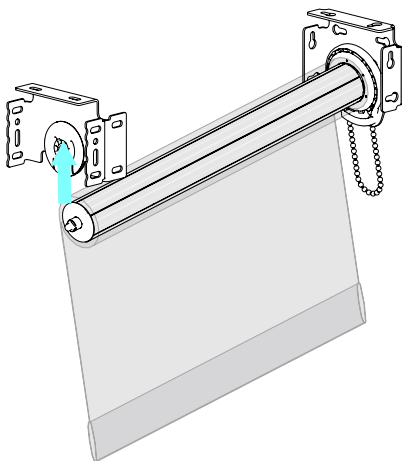

Attach the idler end of the second shade to the bracket

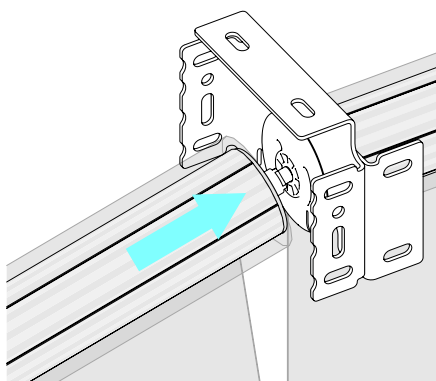

Attach the other idler end of the second shade to the bracket

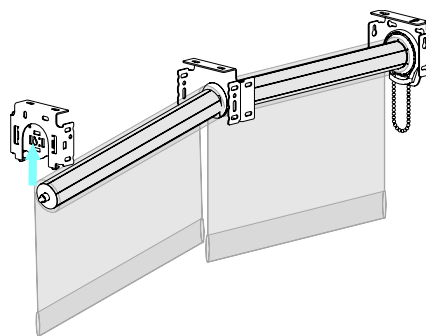

## 4" FASCIA - INFINITE ADJUSTER

Insert adjuster housing into tube. Then, insert one end of the triangular shaped link through the bearing and then slide the triangular link with bearing into the housing that is in the tube

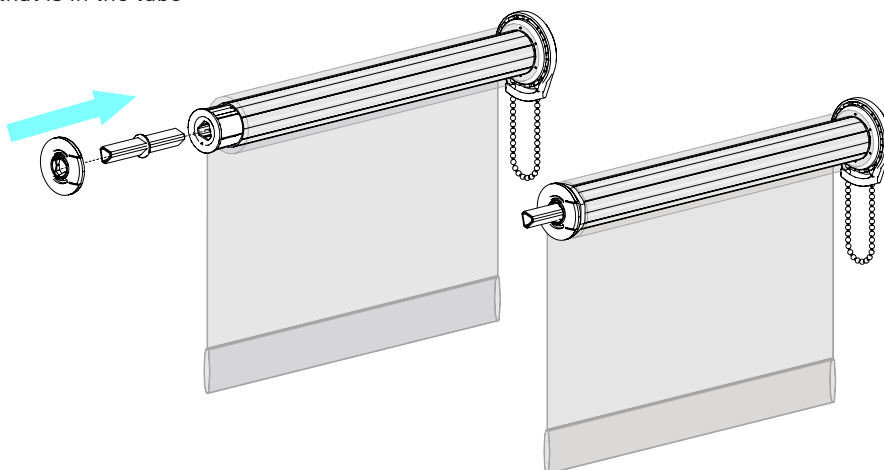

Take tube with the Idler or Pin End in it, and place the Infinite adjuster wheel into the opposite end of the tube. The Infinite Adjuster can never be used in the same tube as the clutch (or motor)

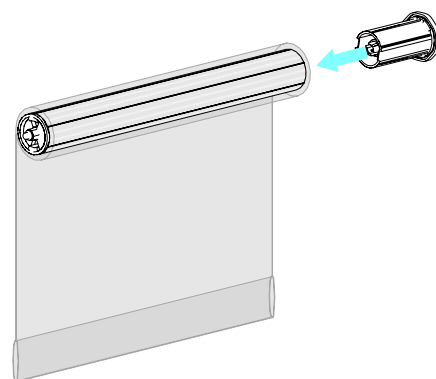

Insert the Infinite Adjuster (on the Idler End) onto the triangular shaped link

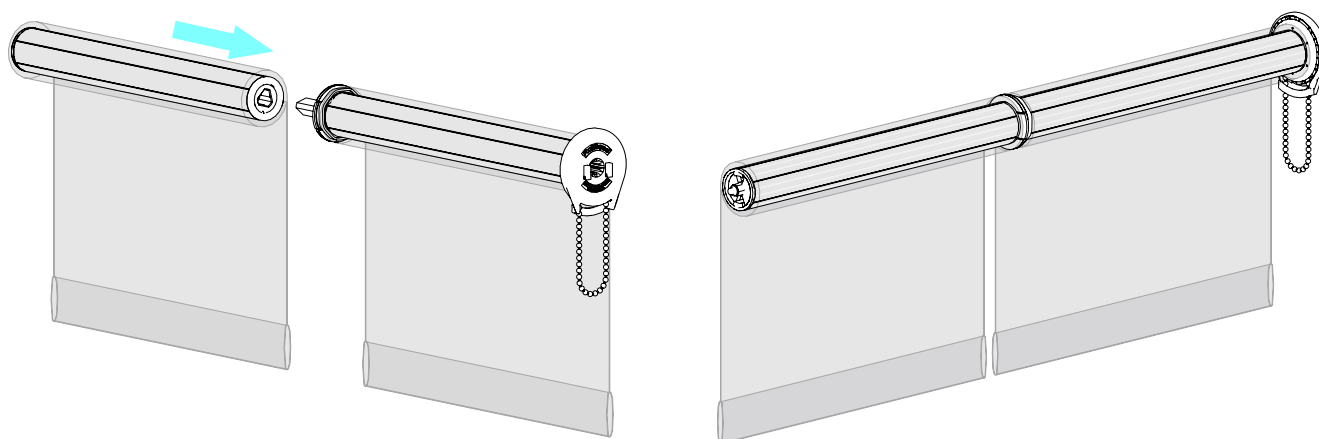

All the link shades should be connected and installed together treating them as one unit. While the ends of the shades that are being linked are supported, insert the clutch and pin end into their respective brackets. This will cause the shades to bow down in a "V"-like shape. If the shades are large this will require two installers. The shades require support and should not be left to hang by the clutch and pin end alone

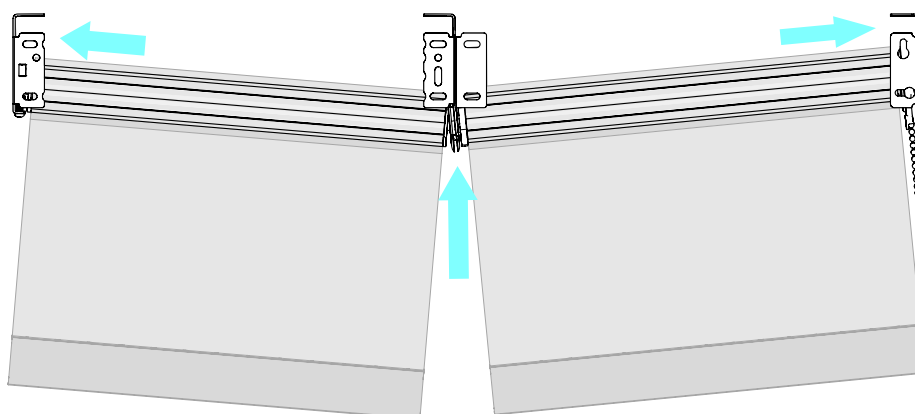

Rotate the Bracket Disk to lock the blind in place

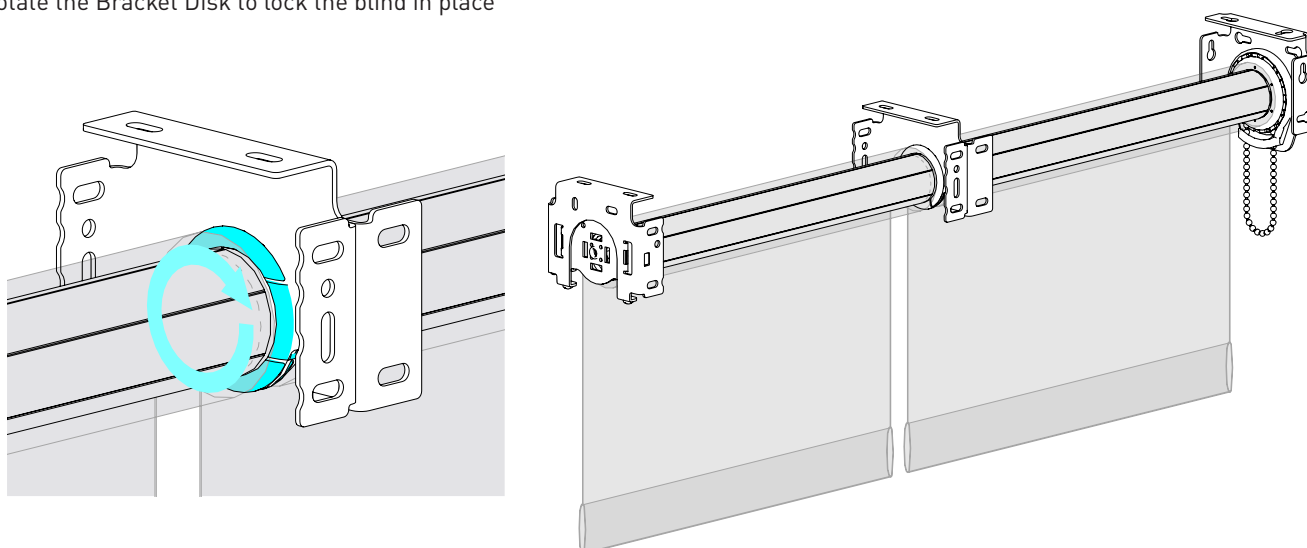

## TWO SHADES WITH ONE 4" FASCIA

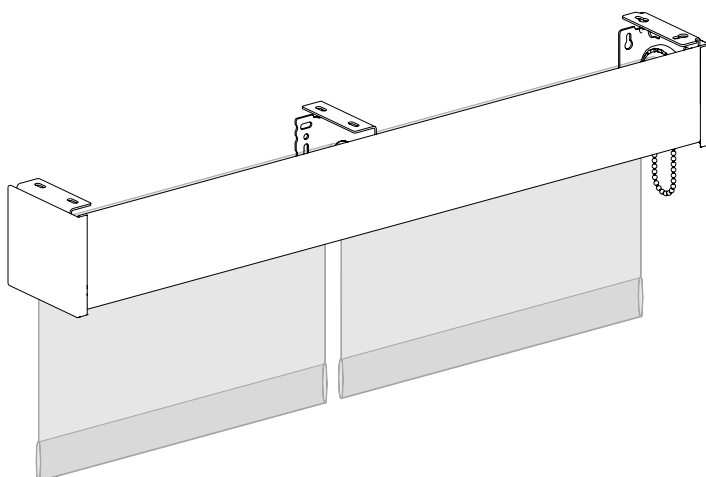

## TWO SHADES WITH TWO 4" FASCIA

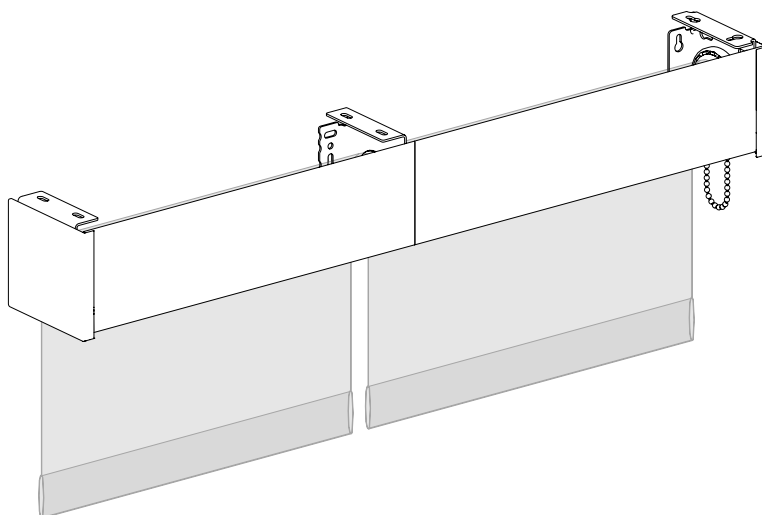

## 4" ADJUSTABLE BRACKETS - SHADE TELESCOPING PREVENTION

Telescoping is when the shade gathers to one side or the other as it is rolled up. This is typically a leveling problem, however; it can be solved by adjusting the shade level using the 4" Adjustable Brackets.

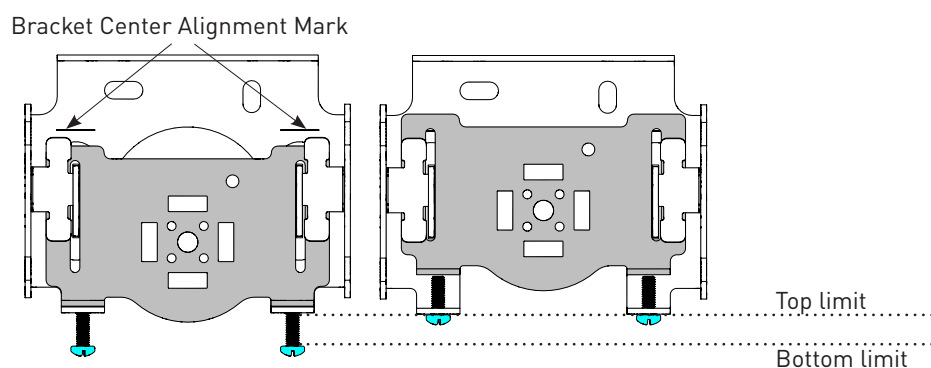

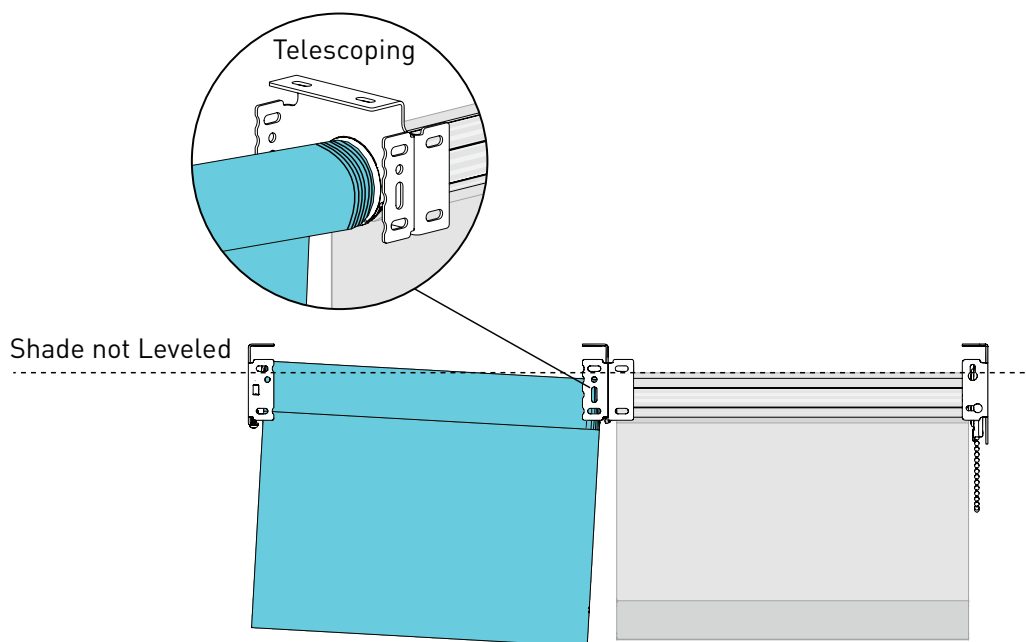

Adjustment of the bracket is needed when the window has not been framed correctly or the structure settles. This can lead to uneven light gaps on the side or telescoping.

Adjust the position of blind by rotating the screws of the 4" Adjustable bracket. Ensure the Shade is levelled properly.

