

FASCIA 4" SKYLINE SYSTEM

The 4" Fascia offers a timeless and seamless decorative cover, which can be added to our popular roller systems, providing an elegant semi open fascia to hide a top roller mechanism. The link bracket enables using one motor for two different shades. With the 4" link bracket you can choose to cover the shades with one nice continuous fascia extrusion without a seam between the shades or with two separate shorter fascia extrusions. Sharing a control per fascia system to simultaneous operation of two shades. The fascia system provides durable hardware that lasts and offers numerous upgrades to suit the needs of various installation types. From the use of adjustable brackets and Link System, the 4inch Skyline Fascia System will ensure that the roller blind will operate as well as it looks.

AESTHETIC FEATURES

- Clean lines for contemporary aesthetic.

ASSEMBLY / INSTALLATION BENEFITS

- When using Adjustable Brackets (optional), certain variations in tolerances can be tweaked for smooth installation and operation of the blinds.

FUNCTIONAL BENEFITS

- Compatible with Skyline & Automate controls.
- Clip - accomodates variances in extension to provide secure fit.
- Link option - multiple shades operated by single control & light gap minimised.

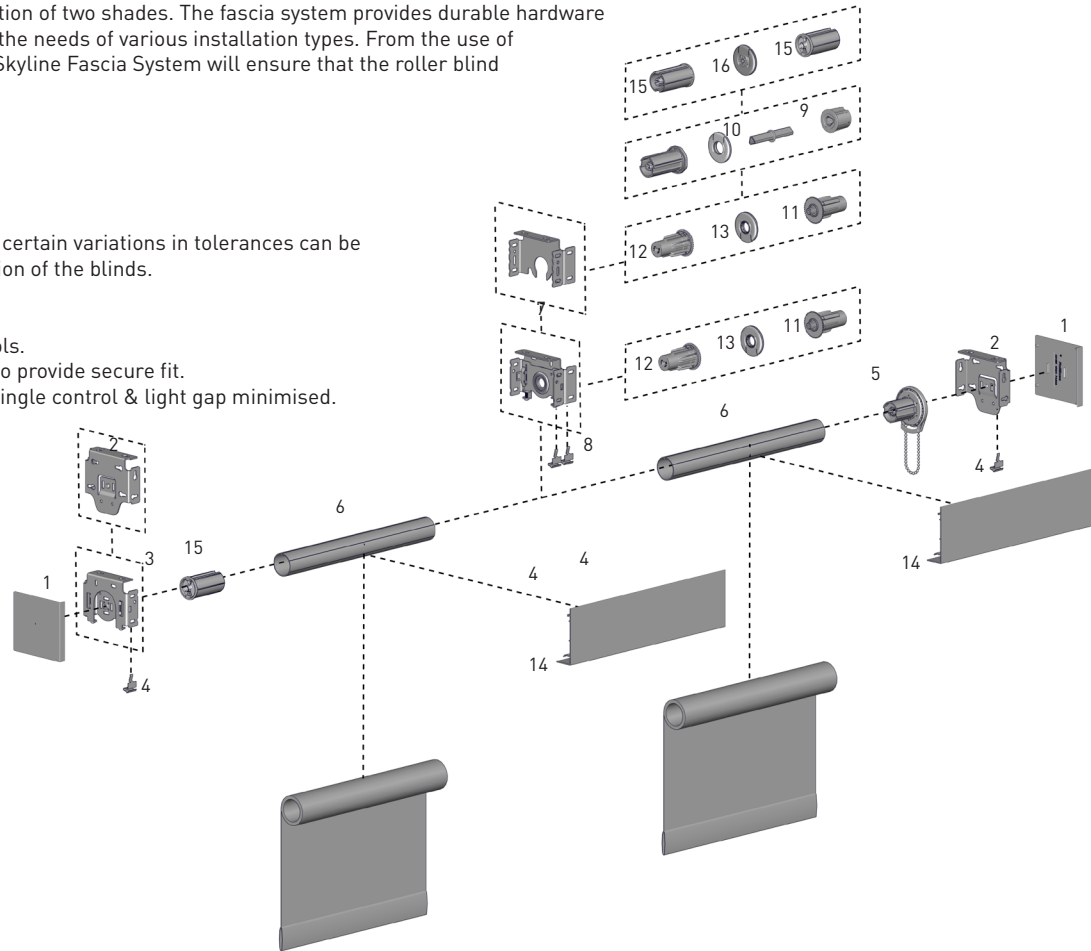

SYSTEM INDEX

- 1 4" SKYLINE SQUARE END CAP
SLFCVR4xx
- 2 4" SKYLINE FASCIA BRACKET
SLFBKT4xx
- 3 4" SKYLINE FASCIA ADJUSTABLE BRACKET
RB88-2106-xxx003
- 4 4" SKYLINE BRACKET CLIP
SLFBKTCLP4
- 5 CLUTCH
Refer to system Product Specifications Manual
- 6 TUBE
Refer to system Product Specifications Manual
- 7 4" SL SKYLINE ADJUSTABLE EASY-LINK BRACKET
RB88-2106-xxx004
- 8 4" SKYLINE SPLIT FASCIA LINK BRACKET
RB88-2106-xxx002
- 9 INFINITE ADJUSTER
LSADJKITxx
- 10 MEDIUM EASY-LINK BRACKET BEARINGS
BRACKET DISK + BEARING
RB41-0501-xxx000
- 11 MEDIUM EASY-LINK SYSTEM MALE DRIVE
RB41-1002-xxx038
- 12 MEDIUM EASY-LINK SYSTEM FEMALE DRIVE
RB41-1001-xxx038
- 13 MEDIUM EASY-LINK BRACKET BEARINGS
RB41-0502-xxx000
- 14 SKYLINE SQUARE FASCIA
SLSF4xx16
- 15 PIN END
When having Pin to Pin connection, use a clutch on the idler end instead of pin end.
- 16 MEDIUM LINK DISC PIN TO PIN
RB41-0503-xxx000

xxx = COLOUR, LLL = LENGTH

COLOUR RANGE



CONTROL OPTIONS

CHAIN CONTROL



MOTORIZED



SYSTEM UPGRADE

SINGLE LINK SYSTEM

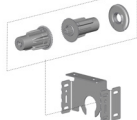

LINK - ADJUSTABLE



SYSTEM OPTION

ADJUSTABLE PIN END BRACKET

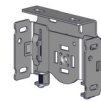

INFINITE ADJUSTER

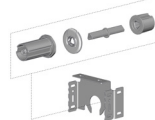

INTERMEDIATE LINK



EASY LINK

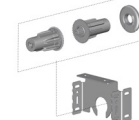

SPECIFICATIONS

MAX ROLL

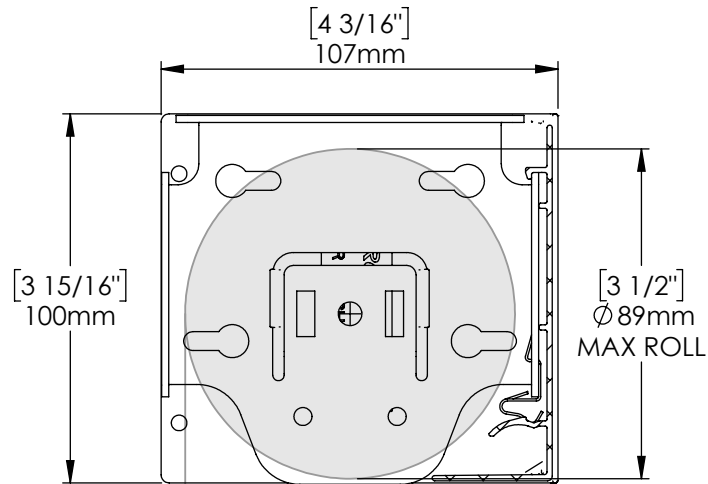

DEDUCTION

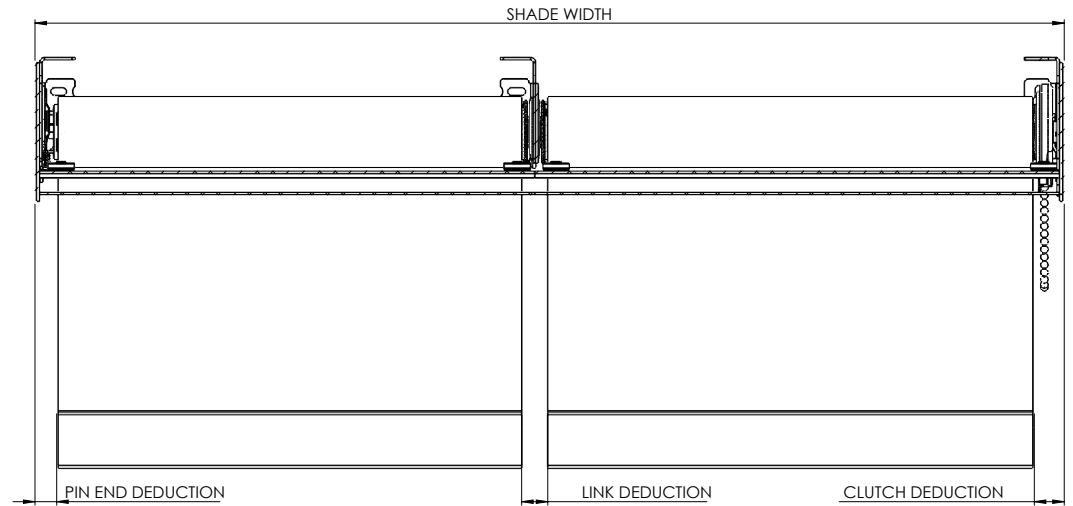

Note: Refer to Skyline Fascia 4" Product Specification manual for pin end and control end deductions.

LINK SYSTEM	DEDUCTION
EASY-LINK	17mm [11/16"]
SKYLINE EASY-LINK	19mm [3/4"]
INFINITE LINK	18mm [11/16"]

CLIP AND COVER ATTACHMENT

Attach Clip

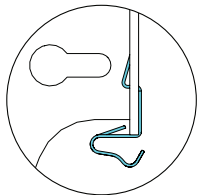
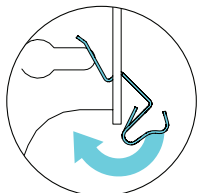

Attach Cover*

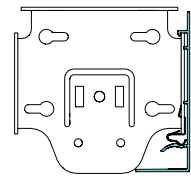
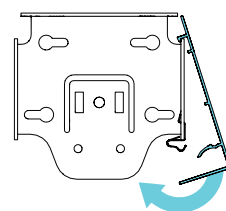

*Anodized Fascia will have a rough texture and care must be used for proper fit.

TUBE SPECS

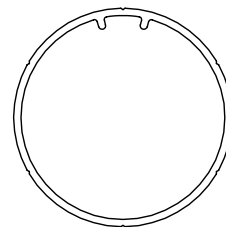

1-1/2" Tube

With tape

CODE: RTEA4TLL
OD: 38mm [1-1/2"]

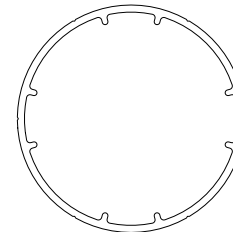

2" Tube

With tape

CODE: RTEA5TLL
OD: 51mm [2"]

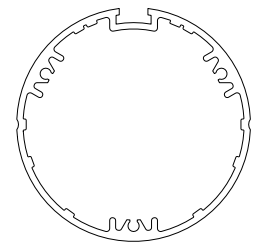

2-1/2" Tube

With tape

CODE: RTEA6TLL
OD: 64mm [2-1/2"]