

MULTI-LINK™ SYSTEM S60

The Rollease Acmeda Multi-Link™ system provides a solution to linking shades within the Uni System range. Designed to allow multiple shades to be controlled using a single motor or chain control operation. Maximum width requirements can be achieved with minimal gap disturbances.

AESTHETIC FEATURES

- Color coded components.
- Optional screw plate cover providing a neat finish.

ASSEMBLY / INSTALLATION BENEFITS

- Retractable Intermediate Drive allowing shades to be installed separately to brackets.
- Adjustable bracket allowing for an overall height adjustment of 10mm [0.39"] (5mm [0.19"] up/down).
- Combo Intermediate bracket allows linking of dual shades.
- Cost effective Non Adjustable bracket option.

FUNCTIONAL BENEFITS

- Noise dampening bearings ensure a silent & smooth operation.
- Intermediate receiver incorporates a rotating lock mechanism to achieve accurate levelling.
- Intermediate Drive & Receiver manufactured from high grade ABS polycarbonate alloy & machined steel.

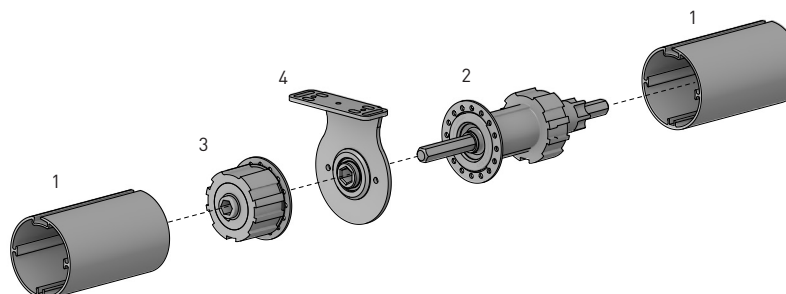
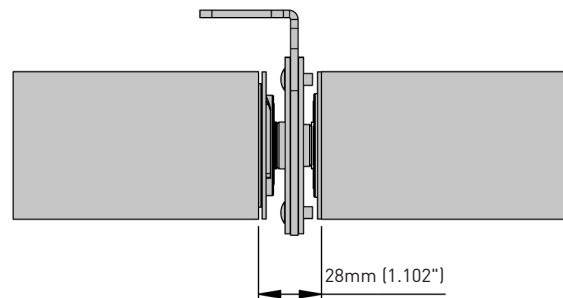
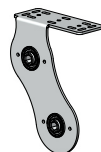
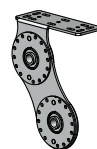
DEDUCTION**SYSTEM OPTIONS****NON ADJUSTABLE
BRACKET****NON ADJUSTABLE
COMBO BRACKET****ADJUSTABLE
COMBO BRACKET****SYSTEM INDEX**

1	Aluminium Tube S60
2	Multi-Link™ Intermediate Drive
	RB56-1002-xxx060 - 60STD
	RB56-1002-xxx080 - 80HD
3	Multi-Link™ Intermediate Receiver
	RB56-2002-xxx060 - 60STD
	RB56-2002-xxx080 - 80HD
4	Intermediate Bracket - Adjustable
	RB56-7201-xxx060 - Top/Ceiling Fix - 60mm
	RB56-7201-xxx080 - Top/Ceiling Fix - 80mm
	RB56-7202-xxx060 - Face/Wall Fix - 60mm
	RB56-7202-xxx080 - Face/Wall Fix - 80mm

xxx= color

COLOR RANGE**CONTROL OPTIONS****CHAIN CONTROL****CRANK GEAR****MOTORIZED**

UNI-LINK SYSTEM S60

The Rollease Acmeda Uni-Link system was designed to achieve a degree specific angled operation when linking multiple shades. Driven by a single motor, the Uni-Joint system can achieve a maximum angle of 90 degrees.

AESTHETIC FEATURES

- Color coded components.
- Optional screw plate cover providing a neat finish.

ASSEMBLY / INSTALLATION BENEFITS

- Height adjustable intermediate bracket.
- Distance adjustable to minimise gaps.

FUNCTIONAL BENEFITS

- Single operation for multiple angled shades.
- Maximum achievable angle of 90 degrees.
- Intermediate bracket made from high grade stamped steel.

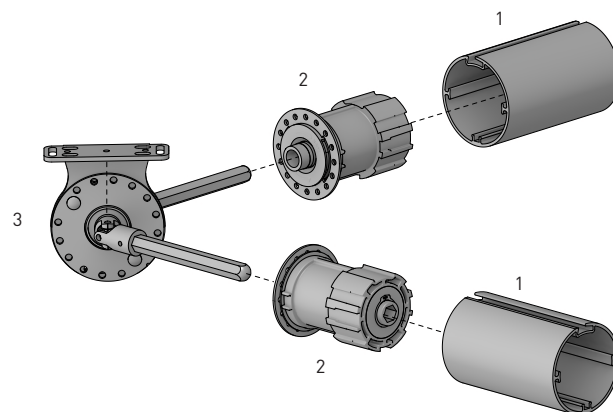

SYSTEM INDEX

1	Aluminium Tube S60
2	Uni-Link Intermediate Receiver
	RB56-3002-xxx060 - 60STD
	RB56-3002-xxx080 - 80HD
3	Uni-Link Intermediate Bracket - Adjustable
	RB56-7401-xxx060 - Top/Ceiling Fix - 60mm
	RB56-7401-xxx080 - Top/Ceiling Fix - 80mm
	RB56-7402-xxx060 - Face/Wall Fix - 60mm
	RB56-7402-xxx080 - Face/Wall Fix - 80mm

xxx= color ## = size

COLOUR RANGE



CONTROL OPTIONS

CHAIN CONTROL



CRANK GEAR



MOTORISED

