

## HOOK TUBE SYSTEM

The Rollease Acmeda Hook Tube System is an innovative system that lets the user change the fabric of the shade effortlessly even when the tube is installed in cassette.

### AESTHETICAL FEATURES

- Fabric can be changed inline with current trends

### PRODUCTION & ASSEMBLY FEATURES

- The Tube can remain installed in cassette/ Fascia when fabric is changed

### FUNCTIONAL BENEFITS

- Easy to remove and reattach fabric to the tube
- Fabric changing functionality to systems fabricated with Rollease Acmeda's most popular clutches, motors and cordless spring system(s) in the US

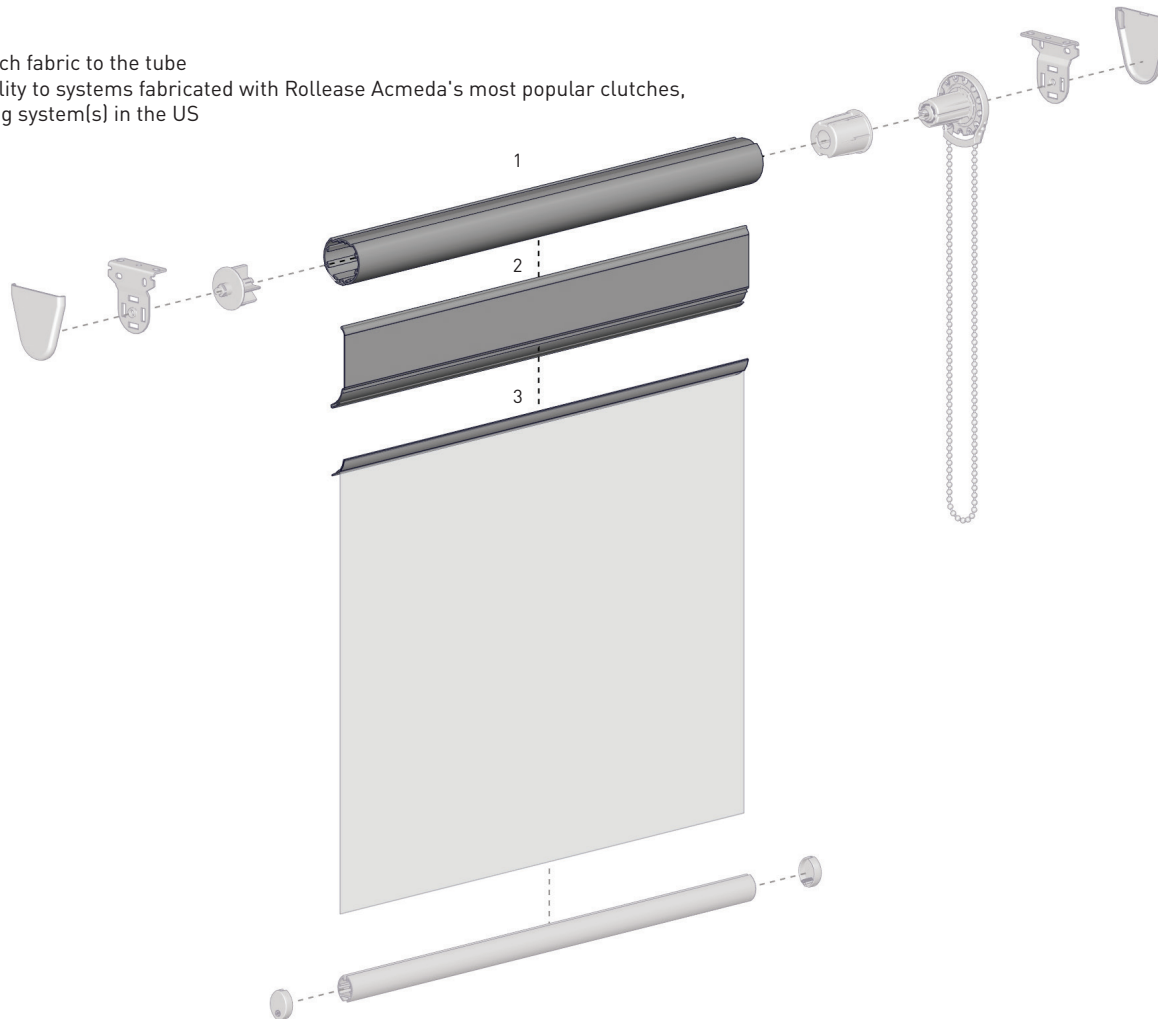

## SYSTEM INDEX

- |   |   |
|---|---|
| 1 | TUBE ALUMINUM HT 1-1.5" X 16 FT MILL FINISH<br>RB95-0238-000487 |
| 2 | HT FLEXIBLE TUBE HOOK GREY- BLACK- 16FT<br>RB95-0403-338487     |
| 3 | HT STIFF FABRIC HOOK - BLACK -16FT - TAPED<br>RB95-0402-050487  |

## CONTROL OPTIONS

### CHAIN CONTROL



### MOTORIZED



### SPRING ASSIST



## SYSTEM COMPATIBILITY

- SKYLINE
- R-SERIES
- EASY SPRING PLUS
- EASY SPRING ULTRA
- EASY SPRING WAND
- AUTOMATE

**SPECIFICATIONS**

**COMPATIBILITY**

SKYLINE	CLUTCH	SL15H01	SL20H53	SL30H53	RGALH	RGAL400	
	ADAPTER	SLA53	-				
	PIN END	SLPEHD53xx	SLPE653xx				
R SERIES	CLUTCH	R16C53	R24C53	RGALxx	RGAL400xx	SA24L36xx	SA24L45xx
	PIN END	REP53					
EASY SPRING PLUS							
EASY SPRING ULTRA							
EASY SPRING WAND							
AUTOMATE	MOTOR	AUTOMATE   Li-ion [25mm/1.1Nm/40r] ARC-MTR012V	AUTOMATE   Li-ion [28mm/2.0Nm/28r] ARC-MTR012V	AUTOMATE   Li-ion [25mm/1.1Nm/40r] WND-MTR012V	AUTOMATE   DC [25mm/1.1Nm/40r] ARC-MTR012V	AUTOMATE   DC [28mm/2.0Nm/28r] ARC-MTR012V	
	MOTOR (CODE)	MTDCBRF25-1.1	MTDCBRFQ28-2	MTDCBSW25-1.1	MTDCRF25-1.1	MTDCRFQ28 - 2	
	MOTOR CROWN	MTCR-25-1.5	MTCR-28-1.5	MTCR-25-1.5	MTCR-25-1.5	MTCR-28-1.5	

**TUBE SPECS**

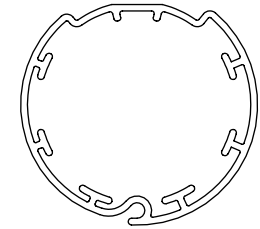

**1-3/4" Tube**

CODE: RB95-0238-000487  
 OD: 45mm [1-3/4"]  
 Length: 4.8m [16ft]

**DEDUCTIONS, MAX ROLL AND MAX LOAD**

Refer to the Skyline/R-Series/Cassette 100/120 Quick Reference Guide for 1-1/2" systems

**ASSEMBLY INSTRUCTIONS**

1 ATTACH SPLINE TO THE TUBE

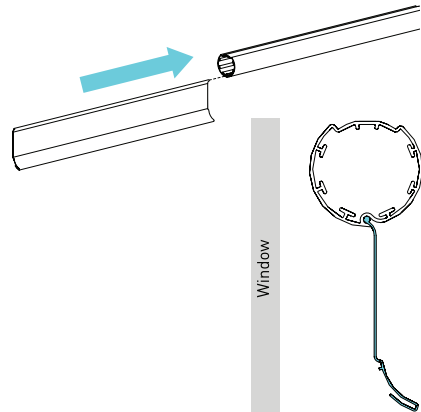

2 ATTACH THE STIFF HOOK AS SHOWN TO THE FACE OF THE FABRIC

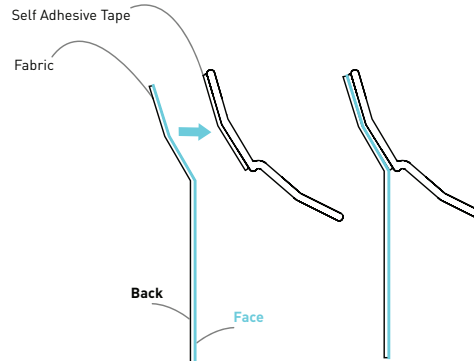

3 ATTACH FABRIC HOOK TO THE FLEXIBLE TUBE HOOK

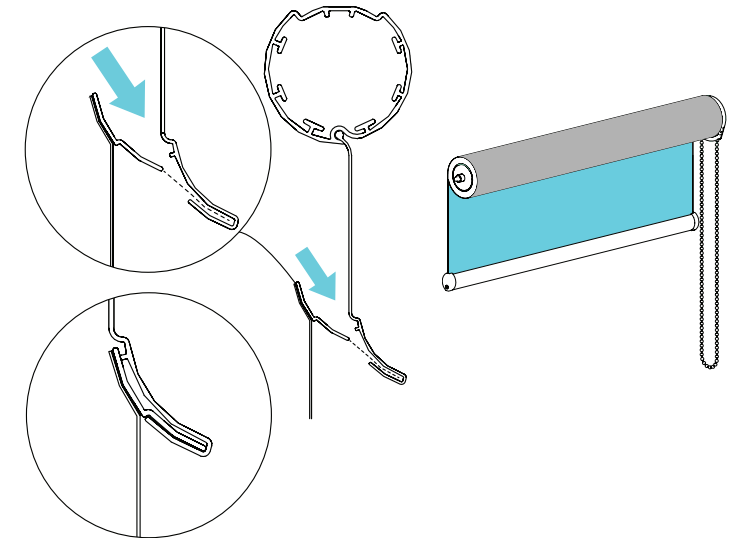

**CHANGING THE FABRIC**

Remove the Fabric from the Fabric Hook and repeat step 2 and 3.