



Easy Spring Ultra Skyline

ASSEMBLY MANUAL



CONTENTS

SECTION A TOOLS AND ADDITIONAL ITEMS REQUIRED	3
PART A – PART TOOLS REQUIRED	3
PART B – ADDITIONAL ITEMS REQUIRED (NOT SUPPLIED)	3
SECTION B SYSTEM DETAILS	4
PART A – OVERVIEW	4
PART B – SYSTEM OPTIONS	5
PART C – BOM & CUTTING LIST	6
SECTION C PREPARATION	8
FABRIC PREPARATION	8
SECTION D ASSEMBLY	9
PART A – TUBE	9
PART B – CONTROL	11
PART C – PRE-TENSION	12
SECTION E DISASSEMBLY (IF REQUIRED)	14
PART A – SPRING CONTROL (STANDARD)	14
PART B – BOOSTER & DECELERATOR	14
SECTION F SYSTEM UPGRADES	15
SECTION G LIFTING CAPACITY	15
SECTION H PRE-TENSION	16
SPRING PRE-TENSION CHARTS	16
SECTION I PREPARE & PACK	17
A - OPEN SYSTEM	17
B - CASSETTE SYSTEM.....	18
SECTION J TROUBLESHOOTING	19

DISCLAIMER

INTRODUCTION

This manual for Easy Spring Ultra Skyline has been produced by Rollease Acmeda to supply the necessary information regarding Easy Spring Ultra Skyline.

DISCLAIMER

Rollease Acmeda has used reasonable care in preparing the information included in this document, but makes no representations or warranties as to the completeness or accuracy of the information. Information is supplied upon the condition that the persons receiving the information will make their own determination as to its suitability for their purposes prior to use. Rollease Acmeda assumes no liability whatsoever for any damages incurred by you resulting from errors in or omissions from the information included herein. Rollease Acmeda reserves the right to make changes without further notice to any products to improve reliability, function or design.

COPYRIGHT

COPYRIGHT © ROLLEASE ACMEDA

All rights are reserved. No part of this document may be reproduced or utilised in any means, by any means, electronic or mechanical including photocopying, recordings, or by any information storage or retrieval system, without the express permission from Rollease Acmeda.

SECTION A | TOOLS AND ADDITIONAL ITEMS REQUIRED

PART A – PART TOOLS REQUIRED

- Saw
- Screw Driver – Philips Head & Flat Head
- Mallet
- Scissors
- Measuring Tape
- Pencil
- Booster Pre-tension tool

PART B – ADDITIONAL ITEMS REQUIRED (NOT SUPPLIED)

To assemble an Easy Spring Ultra Skyline, the following non-stocked items are required:

- Fabric

PART A – OVERVIEW

GENERAL SCHEMATIC

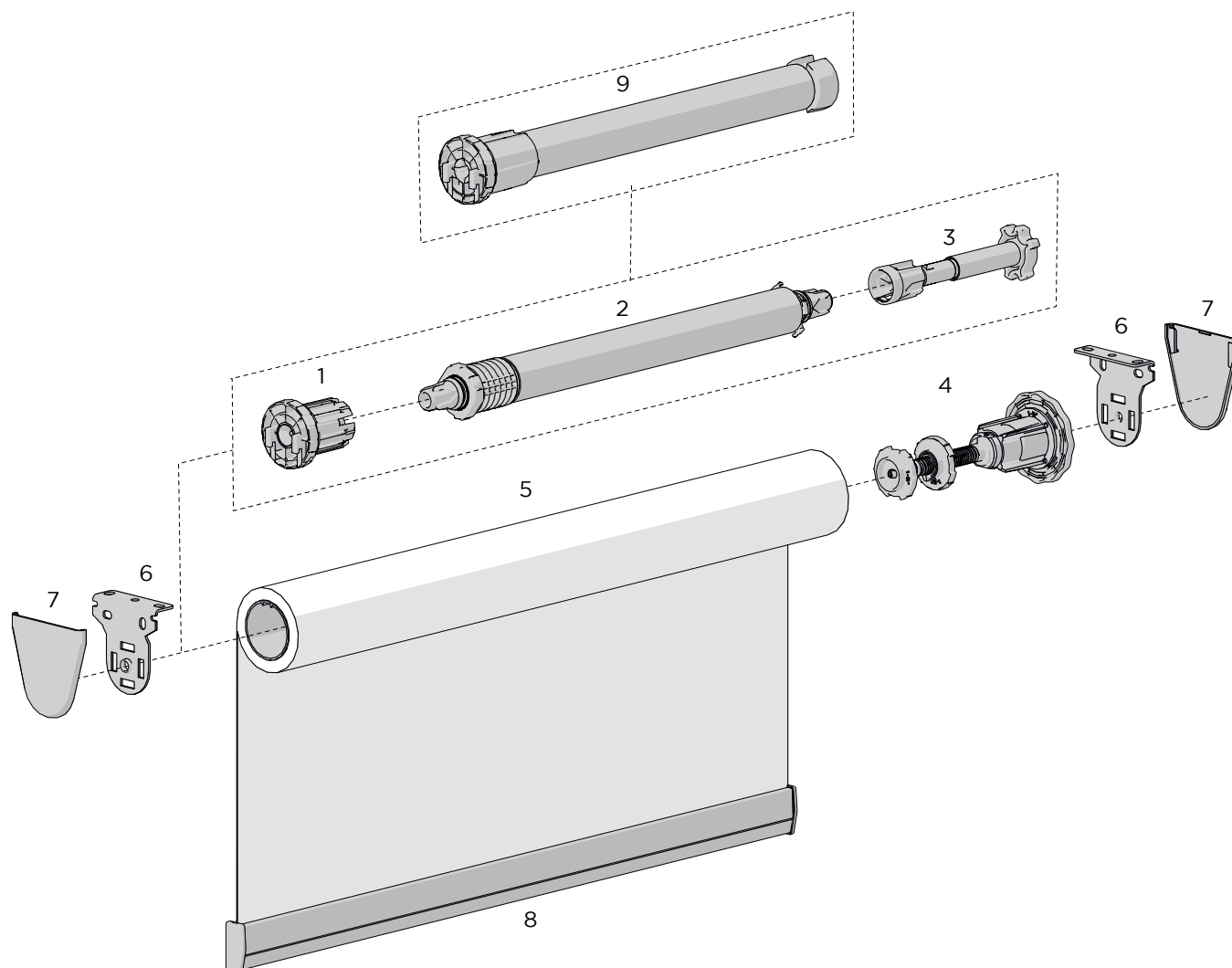

Note: The side of the spring control determines what handed blind it is.

SYSTEM INDEX:

1. Spring Control - 1.5" Tube
2. Booster Universal
3. Booster Decelerator
4. Limiter - Single Stop
5. Aluminium Tube
6. Mounting Brackets
7. Bracket Covers
8. Weightbar
9. Compact Booster

PART B – SYSTEM OPTIONS

TUBE OPTIONS

1-1/2" TUBE

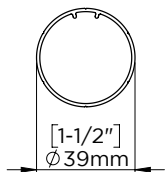

SYSTEM UPGRADES | LX BRACKETS

CF90 CASSETTE FASCIA SUITE (INCLUDING EDGE)

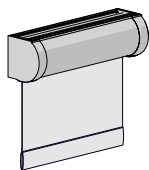

CF90 ROUND

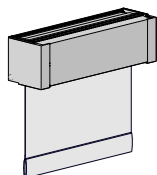

CF90 SQUARE

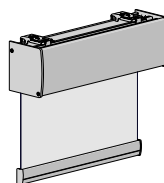

P95

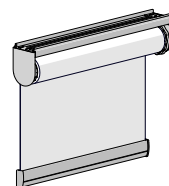

MOUNTING RAIL

SYSTEM UPGRADES

ROUND CASSETTE

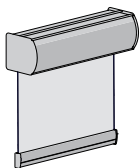

3"/4"/5" FASCIA

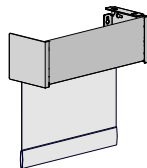

Note: Cassette 100/120 Brackets required.

COLOR RANGE



PURE
WHITE

069



SILVER
GREY

338

WEIGHTBAR



FLAT ALUMINIUM

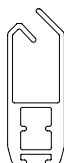

F4115 FLAT HD



ROUND ALUMINIUM



OVAL ALUMINIUM



D30



INTERNAL HEM BAR

PART C – BOM & CUTTING LIST

		PART NUMBER	DESCRIPTION	U.O.M	QTY	DEDUCTION
--	--	-------------	-------------	-------	-----	-----------

						1.5" BRACKET
						OPEN**

INSTALL	OPEN BLIND	SLB660W	Skyline Standard Bracket	Set	1	
		SLBCW	Standard Bracket Cover	Set	1	
		SLB680RW	Skyline Bracket (2")	Set	1	
		SLBC680BK	Skyline Bracket Cover (2")	Set	1	
		SLNB660xx	Skyline Bracket Narrow	Piece	1	
		SLNBC660xx	Skyline Bracket Cover Narrow	Piece	1	
		SLNB680xx	Skyline Bracket Narrow (2")	Piece	1	
		SLNBC680xx	Skyline Bracket Cover Narrow (2")	Piece	2	
		SLB660IW	Skyline Bracket Intermediate Standard	Piece	1 or >	
		SLB680IBW	Skyline Bracket Intermediate 2"	Piece	1 or >	
		SL01-0306-xxx040	Skyline LX Bracket 40mm Pitch	Piece	2	
		SL01-0306-xxx055	Skyline LX Bracket 55mm Pitch	Piece	2	
		RB08-4151-xxx040	LX Bracket Cover Caps 40mm Projection	Set	1	
		RB08-4151-xxx055	VX/LX Bracket Cover Caps 55mm Projection	Set	1	
		RB12-3812-503038	ESU Pre-Tension Retaining Clip 38mm (1.5")	Piece	1	

CONTROLS	SPRING - LH	RB12-3241-069038	Spring Control 1.5" Tube	Piece	1	
		RB12-6101-xxx038	Limiter - Single Stop Universal 1.5"	Piece	1	
		RB12-7101-xxx138	Booster Decelerator 1.5" LH - Blue Tail	Piece	1	
	SPRING - RH	RB12-3241-069038	Spring Control 1.5" Tube	Piece	1	
		RB12-6101-xxx038	Limiter - Single Stop Universal 1.5"	Piece	1	
		RB12-7102-xxx238	Booster Decelerator 1.5" RH - Red Tail	Piece	1	
	BOOSTER UNIVERSAL	RB12-3800-xxx038	Booster Univ. SHORT 1.5"	Piece	1	
		RB12-3801-xxx038	Booster Univ. LGT 1.5"			
		RB12-3802-xxx038	Booster Univ. STD 1.5"			
	BOOSTER COMPACT (LH Only)	RB12-3805-xxx038	Booster LH + Decelerator Compact 38 1.5"	Piece	1	
		RB12-6102-xxx038	Skyline Limiter – Single Stop Universal Short 1.5" (38mm)	Piece	1	

Note:

Short, Light (LGT), and Standard (STD) boosters require separate spring control and decelerator. Compact booster has integrated control and decelerator.

SECTION B | SYSTEM DETAILS

PART NUMBER		DESCRIPTION	U.O.M	QTY	DEDUCTION
					1.5" TUBE
					OPEN**
BOTTOM RAIL	RB91-1232-xxxLLL	D30 SILENT Medium Bottom Rail	mm [inch]	1	W - 35mm [1-3/8"]
	RB91-2131-xxx002	D30 Medium Bottom Rail End Caps LH & RH	Set	1	
	RB92-1501-001100	15mm Flat Spline	mm [inch]	1	W - 35mm [1-3/8"]
	RB92-1502-001075	15mm Flat Spline - D/S MP-HR TAPE			
	RB92-1503-001075	15mm Flat Spline - D/S MP-HR TAPE B/SIDES			
	VB05-0301-xxxLLL	Base Rail Weight Rod	mm [inch]	0 or 1	W - 75mm [2-15/16"]
	SB91-0011-050500	Fabric Brush	mm [inch]	1	W - 35mm [1-3/8"]
	RB91-1205-xxxLLL	Flat Aluminium Bottom Rail	mm [inch]	1	W - 35mm [1-3/8"]
	RB91-2105-xxx001	Flat Bottom Rail End Caps	Set	1	
	RB92-1001-001100	10mm Flat Spline	mm [inch]	1	W - 35mm [1-3/8"]
	RB92-1002-001075	10mm Flat Spline - D/S MP-HR TAPE	mm [inch]		
	RB92-1003-001075	10mm Flat Spline - D/S MP-HR TAPE B/SIDES	mm [inch]		
	SB91-0011-050500	Fabric Brush	mm [inch]	1	W - 35mm [1-3/8"]
	VB05-0301-xxxLLL	Base Rail Weight Rod	mm [inch]	0 or 1	W - 75mm [2-15/16"]
	SB06-0201-xxxLLL	F4115 Flat Heavy Duty Bottom Rail	mm [inch]	1	W - 35mm [1-3/8"]
	SB06-0201-xxxLLL	F4115 Flat Heavy Duty End Cap	Set	1	
	RB92-1501-001100	15mm Flat Spline	mm [inch]	1	W - 35mm [1-3/8"]
	RB92-1502-001075	15mm Flat Spline - D/S MP-HR TAPE	mm [inch]		
	RB92-1503-001075	15mm Flat Spline - D/S MP-HR TAPE B/SIDES	mm [inch]		
	SB91-0011-050500	Fabric Brush	mm [inch]		W - 35mm [1-3/8"]
	VB05-0301-xxxLLL	Base Rail Weight Rod	mm [inch]	0 or 1	W - 75mm [2-15/16"]
	RB91-1226-xxxLLL	Oval Aluminium Bottom Rail	mm [inch]	1	W - 35mm [1-3/8"]
	RB91-2126-xxx001	Oval Bottom Rail End Cap	Set	1	
	RB92-1001-001100	10mm Flat Spline	mm [inch]	1	W - 35mm [1-3/8"]
	RB92-1002-001075	10mm Flat Spline - D/S MP-HR TAPE	mm [inch]		
	RB92-1003-001075	10mm Flat Spline - D/S MP-HR TAPE B/SIDES	mm [inch]		
	VB05-0301-xxxLLL	Base Rail Weight Rod	mm [inch]	0 or 1	W - 75mm [2-15/16"]
	RB91-1203-xxxLLL	Round Aluminium Bottom Rail	mm [inch]	1	W - 35mm [1-3/8"]
	RB91-2104-xxx022	Round Slimline Bottom Rail End Cap	Set	1	
	RB92-1501-001100	15mm Flat Spline	mm [inch]	1	W - 35mm [1-3/8"]
	RB92-1502-001075	15mm Flat Spline - D/S MP-HR TAPE			
	RB92-1503-001075	15mm Flat Spline - D/S MP-HR TAPE B/SIDES			
	VB05-0301-xxxLLL	Base Rail Weight Rod	mm [inch]	0 or 1	W - 75mm [2-15/16"]
	RCBIHB16	Internal Hem Bar	mm [inch]	0 or 1	W - 35mm [1-3/8"]
TUBE	RTEA-4T05-000580/RTEA4Txx	Rollease Tube + M/P Tape 1-1/2"	mm [inch]	1	W - 35mm [1-3/8"]
	TAPE36	Multi-Purpose Double Sided Tape 1/2"	mm [inch]		
	TAPE361	Multi-Purpose Double Sided Tape 1"	mm [inch]		
FABRIC	NOT SUPPLIED	Fabric Width	mm [inch]	1	W - 35mm [1-3/8"]
		Fabric Drop	mm [inch]		D + 150mm [5-7/8"]

**No Covers - If covers are required, add an extra 4mm [3/16"] to deduction. The side of the spring control determines what handed blind it is.

FABRIC PREPARATION

SECURE SPLINE FOR WEIGHT BAR USING STAPLES/DOUBLE SIDED TAPE

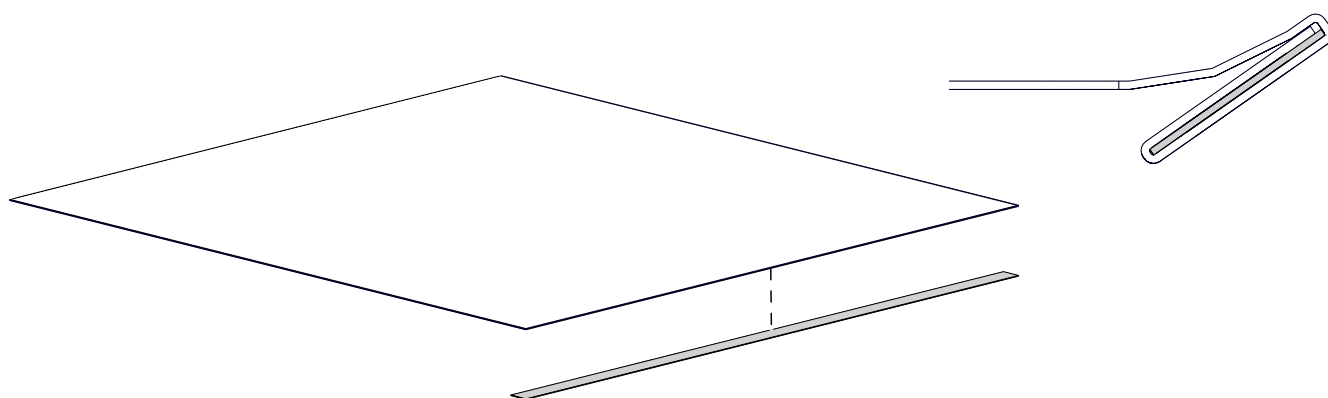

PART A - TUBE

STEP 1 - ATTACH FABRIC ON THE TUBE USING DOUBLE SIDED TAPE

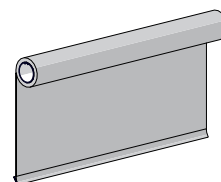
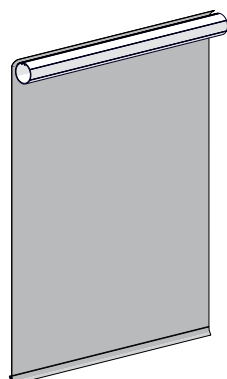
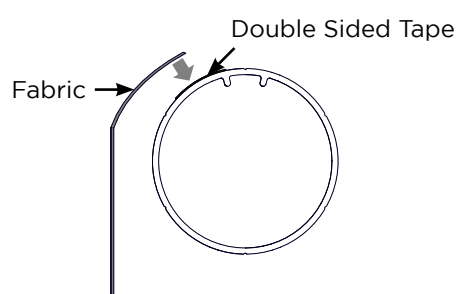

Note: Min 2 full wraps of fabric on the tube

STEP 2 - SLIDE BOTTOM RAIL ONTO FABRIC

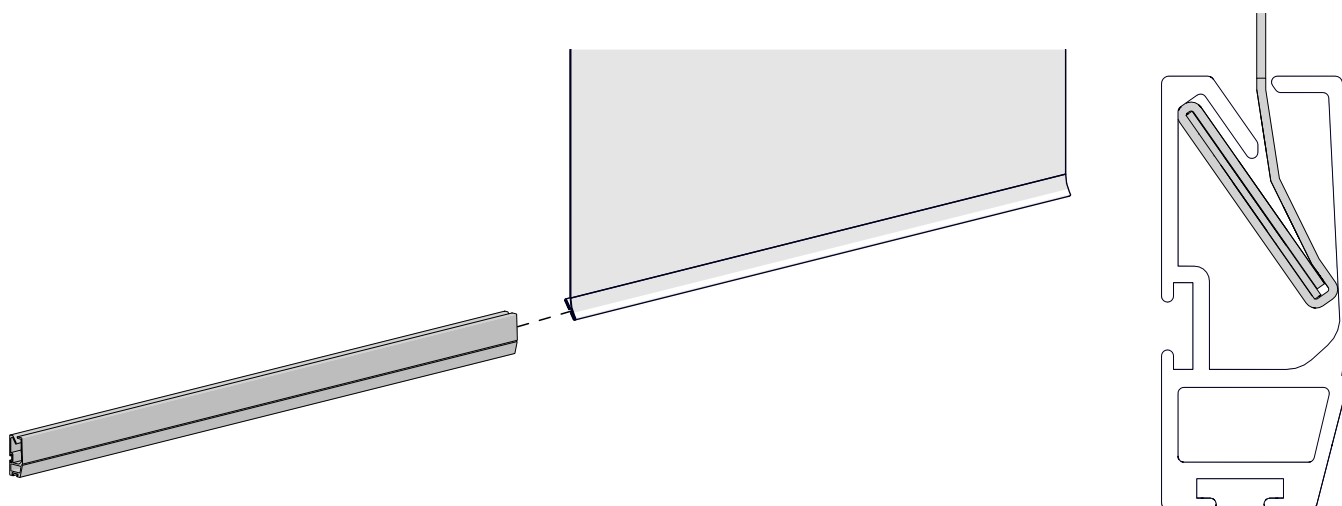

NOTE: Refer to "ATTACHING FABRIC WITH FLAT SPLINE TO BOTTOM RAIL" document for spline installation instructions

Optional: Insert Ballast (if additional weight is required to improve appearance of fabric)

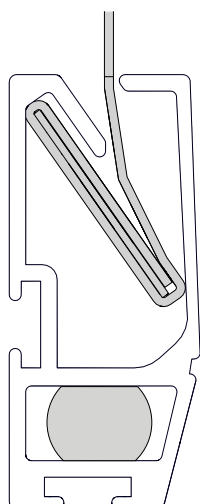

STEP 3 - INSERT BOTTOM RAIL END CAPS

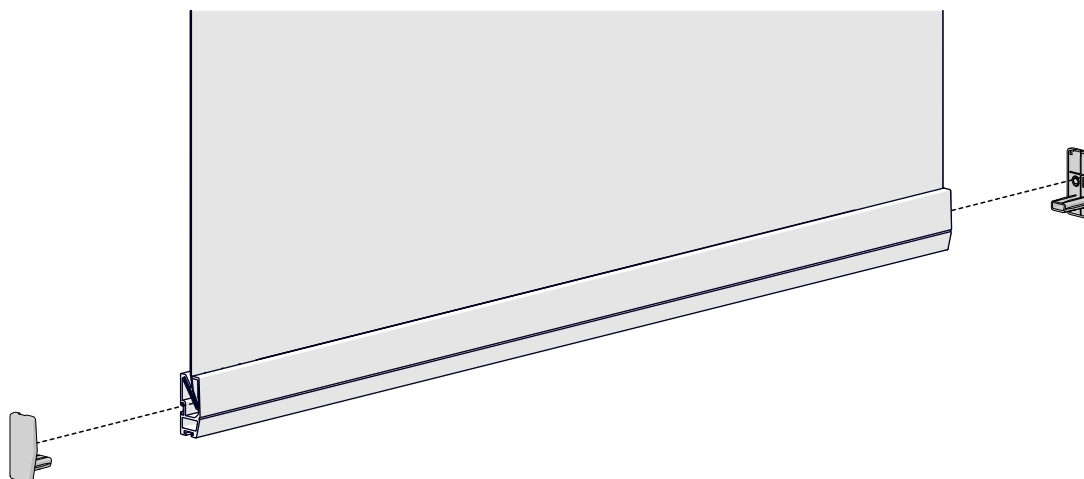

STEP 4 - LIMITER

Left Hand Side Limiter configuration (For Right hand control)

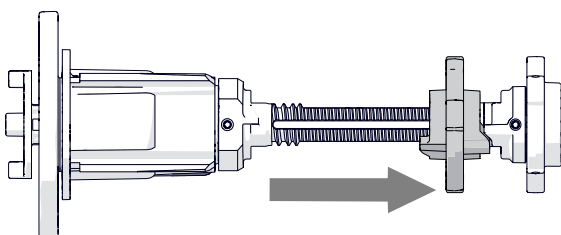

Right Hand Side Limiter configuration (For Left hand control)

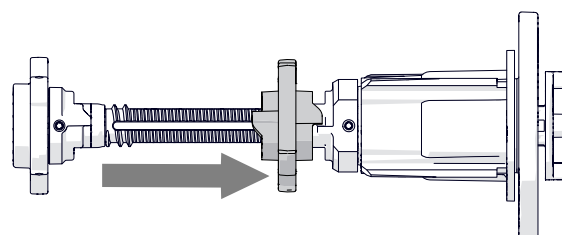

STEP 5 - INSERT LIMITER INTO TUBE

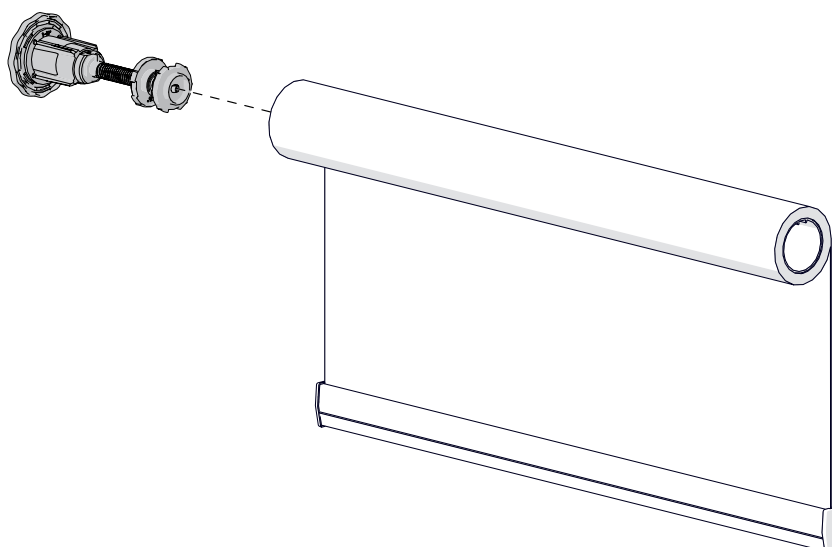

PART B – CONTROL

Note – When installing items onto the booster hold hand behind opposite end to spring, do not hold the sleeve or tube adapter.

STEP 1 – ATTACH THE SPRING CONTROL AND DECELERATOR TO THE BOOSTER

(Note: STEP 1 is not needed for compact booster. Compact booster is an all in one piece)

For left hand control, clip the Spring Control onto the blue end of the Universal Booster

LEFT HAND CONTROL

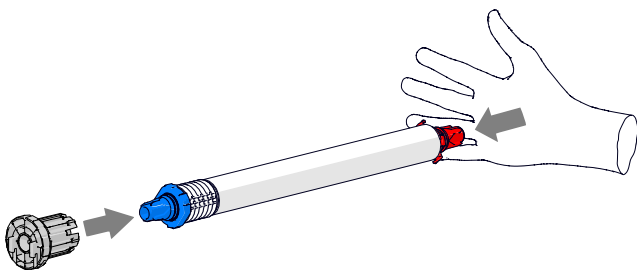

For right hand control, clip the Spring Control onto the red end of the Universal Booster

RIGHT HAND CONTROL

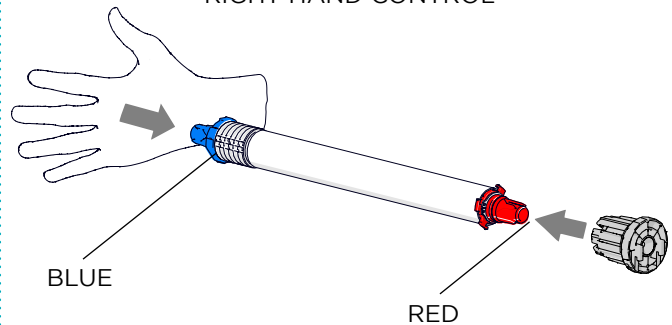

Snap Decelerator to Booster

LEFT HAND CONTROL

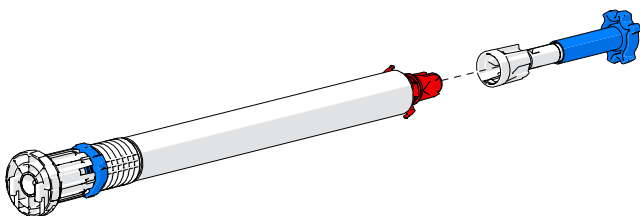

RIGHT HAND CONTROL

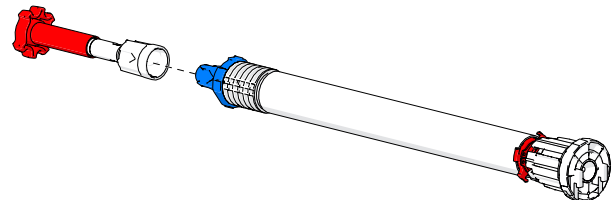

STEP 2 – INSERT BOOSTER INTO TUBE

Right Hand Booster for Back Roll shown as example

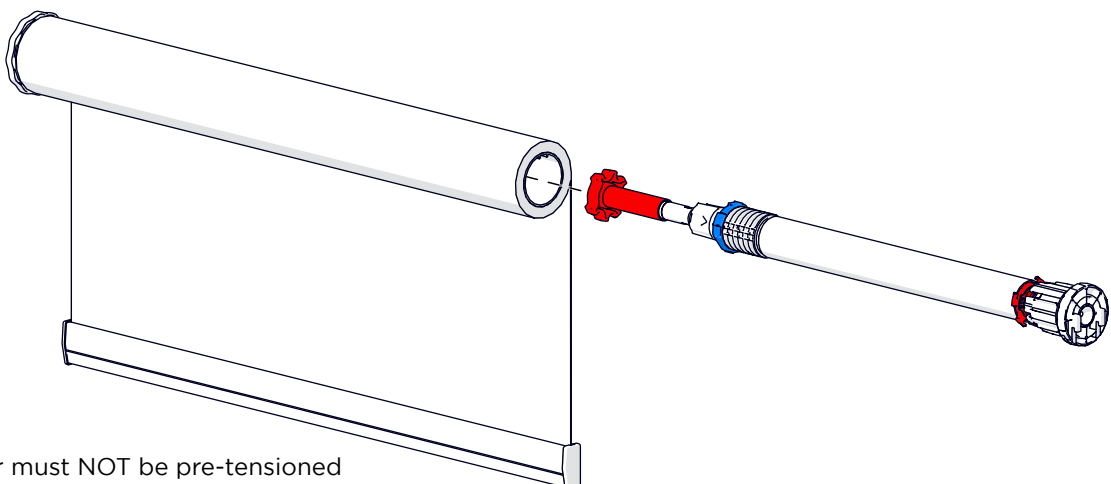

NOTE: Booster must NOT be pre-tensioned

PART C – PRE-TENSION

STEP 1 – USE BOOSTER PRE-TENSION TOOL TO PRE-TENSION BLIND

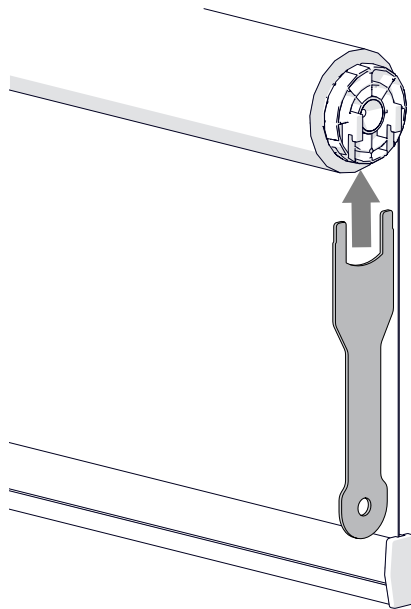

**LH INSTALL (BACKROLL):
ROTATE CLOCKWISE**

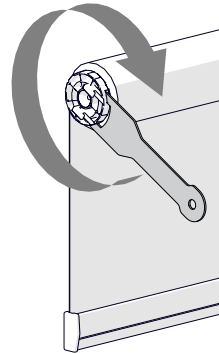

**RH INSTALL (BACKROLL):
ROTATE ANTI-CLOCKWISE**

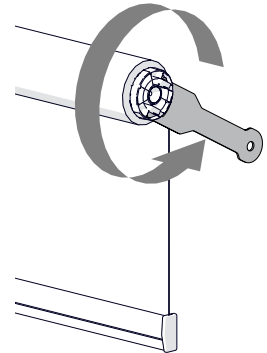

LOCK SPRING:

After pre-tensioning,
to lock the spring,
rotate 90° clockwise.

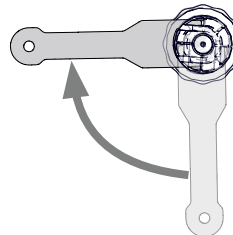

After pre-tensioning, to
lock the spring, rotate 90°
anti-clockwise.

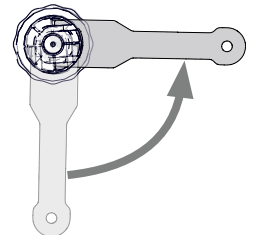

Refer to Section H to determine the minimum number of pre-turns required.

STEP 2 – REMOVING PRE-TENSIONS

Note:
Rotate 45° passed
desired tension to **unlock**
the spring

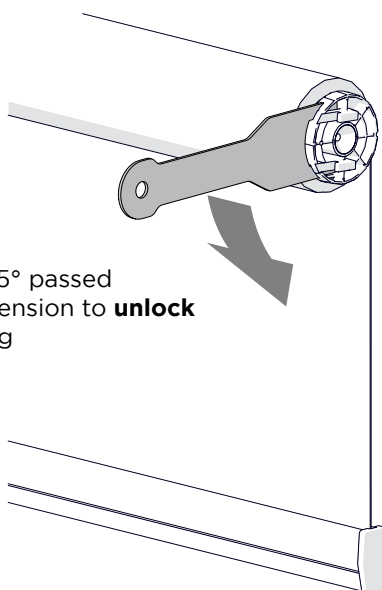

Slightly turn spring head in the same direction to pre-tension

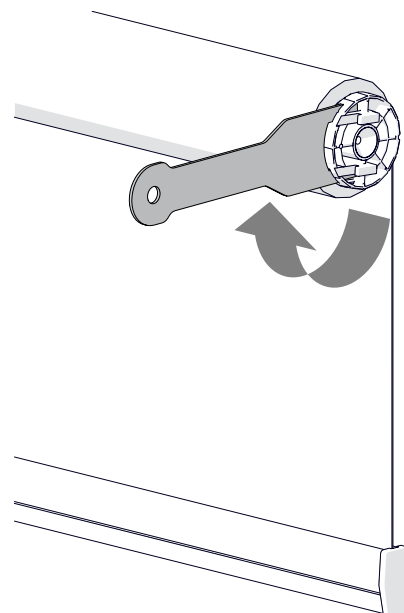

Release spring head and it will un-tension itself
(Spring head will spin in the opposite direction of pre-tensioning)

STEP 3 - ATTACH PRE-TENSION RETAINING CLIP

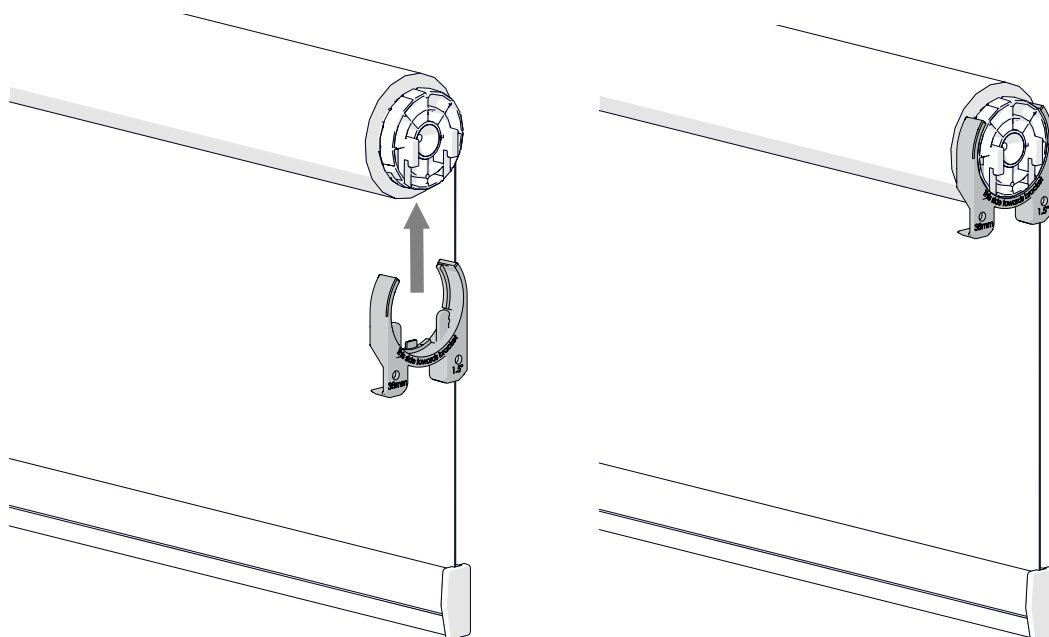

STEP 4 - SECURE HEAD TO THE BRACKET USING SCREW (CASSETTE SYSTEM ONLY)

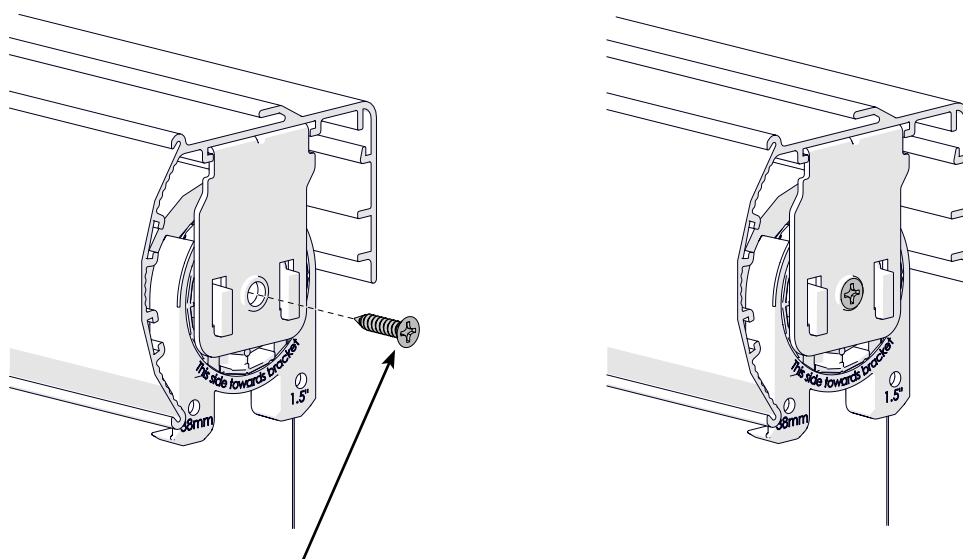

#8 x 3/4" Self Tapping Counter Sunk Screw

Note: Refer to installation manual for how to install in brackets.

PART A - SPRING CONTROL (STANDARD)

STEP 1 - WEDGE OFF SPINDLE WITH A FLAT HEAD SCREW DRIVER

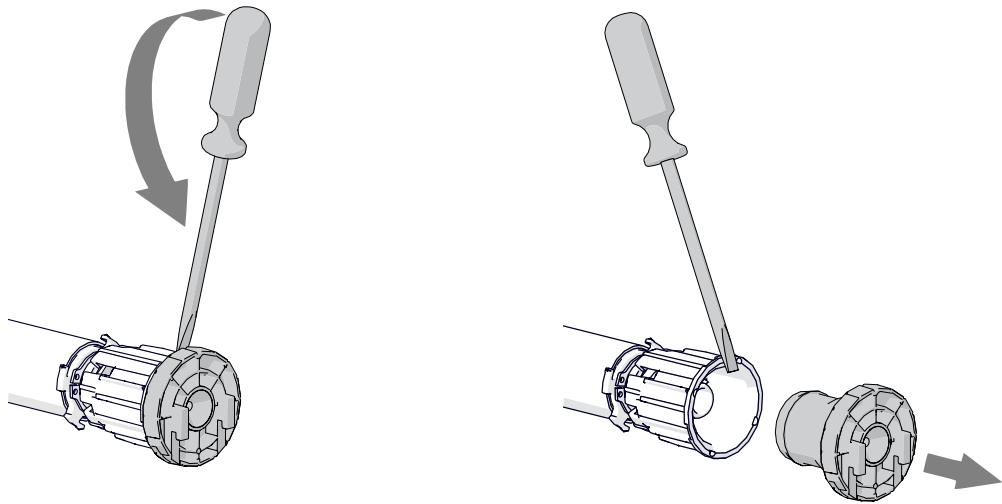

STEP 2 - ROTATE AND TWIST OFF CONNECTOR FROM BOOSTER



PART B - BOOSTER & DECELERATOR

(Note: Not applicable for compact booster)

Wedge off decelerator with a flat head screwdriver by twisting the screwdriver at the 2 clip points, slightly twist off one side and then the other to make it easier to remove. (The clipping points are located under the openings on the decelerator adapter)

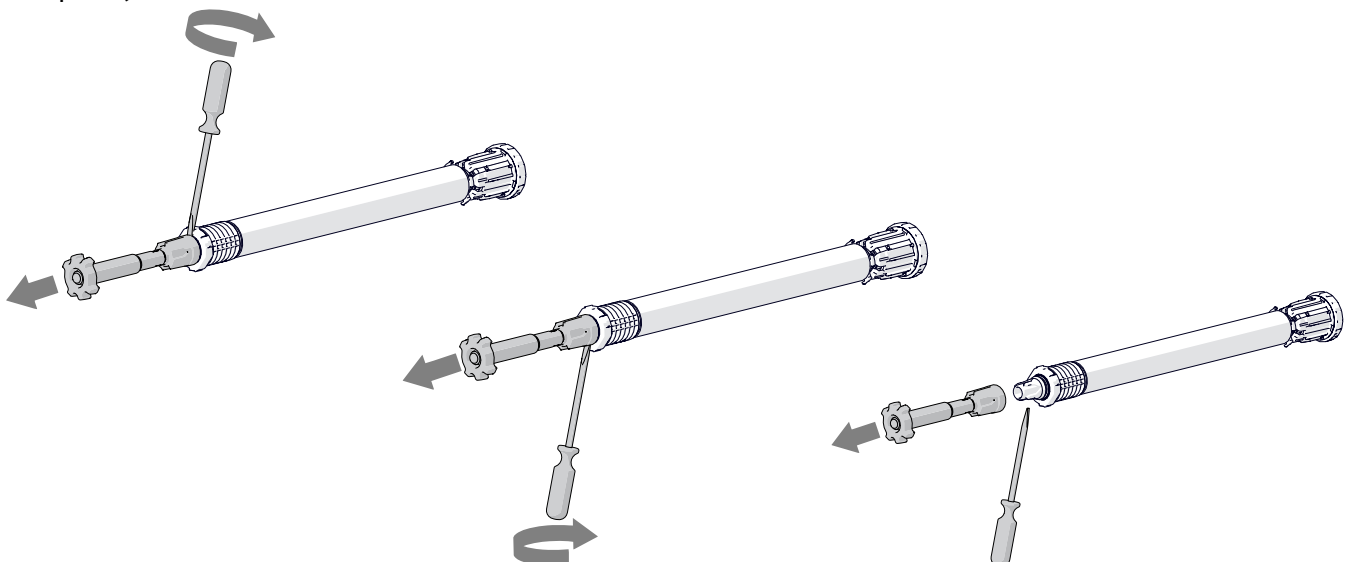

SECTION F | SYSTEM UPGRADES

Easy Spring Ultra is compatible with CF90. To install the shade with a CF90, refer to the CF90 Manual.

Easy Spring Ultra is also compatible with Cassette 100 and Cassette 120. To install the shade with Cassette 100 and Cassette 120, refer to Cassette 100 and Cassette 120 manual.

SECTION G | LIFTING CAPACITY

TUBE	BOOSTER				
	COMPACT	SHORT	LIGHT	STANDARD	HEAVY DUTY
	0.49 NM 0.36 FT. LBS	0.46 NM 0.34 FT. LBS	0.60 NM 0.44 FT. LBS	1.09 NM 0.80 FT. LBS	1.77 NM 1.30 FT. LBS
1 ½ INCH	2.61KG (5.75LBS)	4.8KG (10.69LBS)	4.8KG (10.69LBS)	4.8KG (10.69LBS)	NA

SPRING PRE-TENSION CHARTS

1.5" (38mm) TUBE - D30 Medium Weight Bar (No Ballast)

420 GSM (12.39 oz/yd²) | Thickness 0.55mm (0.022")

		WIDTH																			
		0.46	0.60	0.80	1.00	1.20	1.40	1.60	1.80	2.00	2.20	2.40	2.60	2.80	3.00	3.20	3.40	3.60	3.80		
DROP	m																				
	0.50	9	10	11	14	15	16	17	18	18	19	11	12	12	13	13	14	14	15	20	
	0.60	9	10	11	14	15	16	17	18	19	20	11	12	12	13	13	14	14	15		
	0.70	9	10	11	14	15	16	17	18	19	20	11	12	13	13	14	14	15	15		
	0.80	9	10	11	14	15	16	17	18	19	20	11	12	13	13	14	14	15	15	31	
	0.90	9	10	11	14	15	17	18	19	20	11	12	13	13	14	14	15	15			
	1.00	9	10	11	14	15	17	18	19	20	11	12	13	13	14	14	15	16			
	1.10	9	10	11	15	15	17	18	19	20	11	12	13	14	14	15	15	16		43	
	1.20	9	10	11	15	16	17	18	19	20	11	13	13	14	14	15	16	16			
	1.30	9	10	11	15	16	18	19	20	21	11	13	13	14	15	15	16	17			
	1.40	9	10	12	15	17	18	19	20	21	13	13	14	14	15	16	16			55	
	1.50	9	10	12	15	17	18	19	20	22	13	13	14	15	15	16	17				
	1.60	9	10	12	16	17	18	19	21	22	13	14	14	15	16	16	17				
	1.70	9	10	12	16	17	19	20	21	22	13	14	15	15	16	17	17			67	
	1.80	9	10	12	16	18	19	20	21	23	13	14	15	16	16	17	18				
	1.90	9	10	12	17	18	19	20	22	13	14	14	15	16	17	17	18				
2.00	10	10	12	17	18	19	21	22	13	14	15	15	16	17	18				79		
2.10	10	10		17	18	20	21	23	13	14	15	16	17	17	18						
2.20	10			17	19	20	21	23	14	14	15	16	17	18	18						
2.30				17	19	20	22	23	14	15	16	16	17	18	19				91		
2.40				18	19	21	22	24	14	15	16	17	18	18	19						
		24			47				71			94			118		142		in		

1.5" TUBES WITH BOOSTER

	COMPACT
	SHORT
	LIGHT
	STANDARD
LINKED	STANDARD
OUTSIDE PRODUCT SPECIFICATIONS	

PARAMETERS

FABRIC DENSITY: 420gsm

FABRIC THICKNESS: 0.6mm

WEIGHT BAR: D30 Medium Bottom Rail

MINIMUM BLIND WIDTH = 460mm [18"]

NOTE: The above chart is indicative only. Due to variances in fabric weights, weight bar weights, addition of ballast and friction the optimum number of pre-turns will vary blind to blind. For more accurate information please refer to the pre-rotation document.

A - OPEN SYSTEM

Ensure all required items to complete installation are packed;

1. Shade Assembly
2. 2 x Bracket Cover
3. 2 x Mounting Bracket
4. Appropriate Fasteners
5. ESU Pre-Tension Retaining Clip 38mm (1.5")* - *Optional*

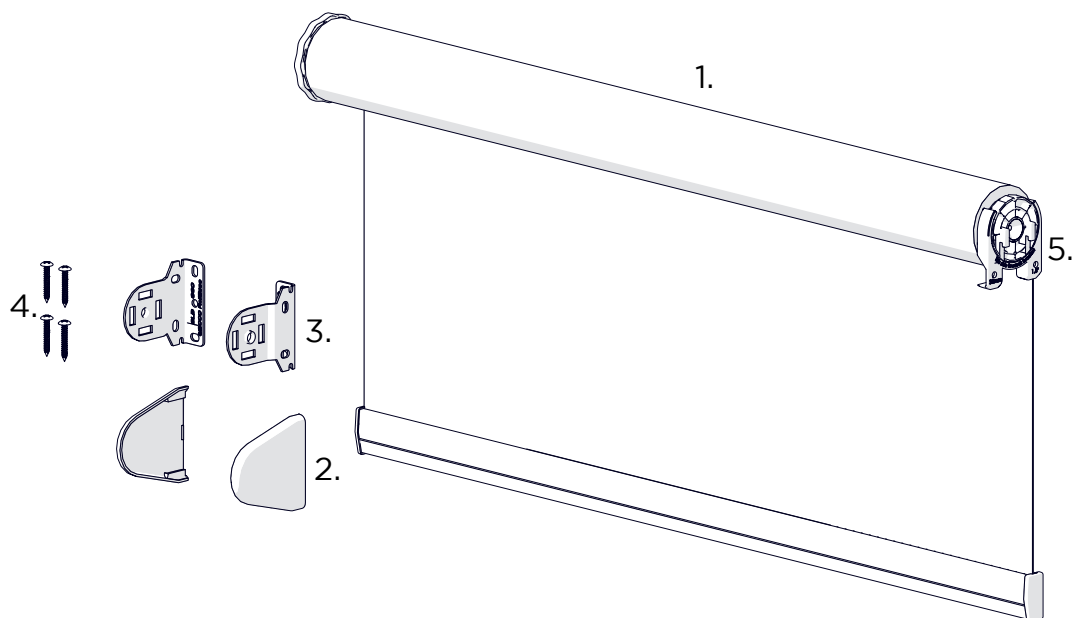

*The clip must be removed before the shade is operated.

B - CASSETTE SYSTEM

Ensure all required items to complete installation are packed;

1. Shade Assembly
2. Mounting Bracket (as required)
3. Appropriate Fasteners (as required)
4. #8 x 3/4" Self Tapping Counter Sunk Screw*
5. ESU Pre-Tension Retaining Clip 38mm (1.5")**

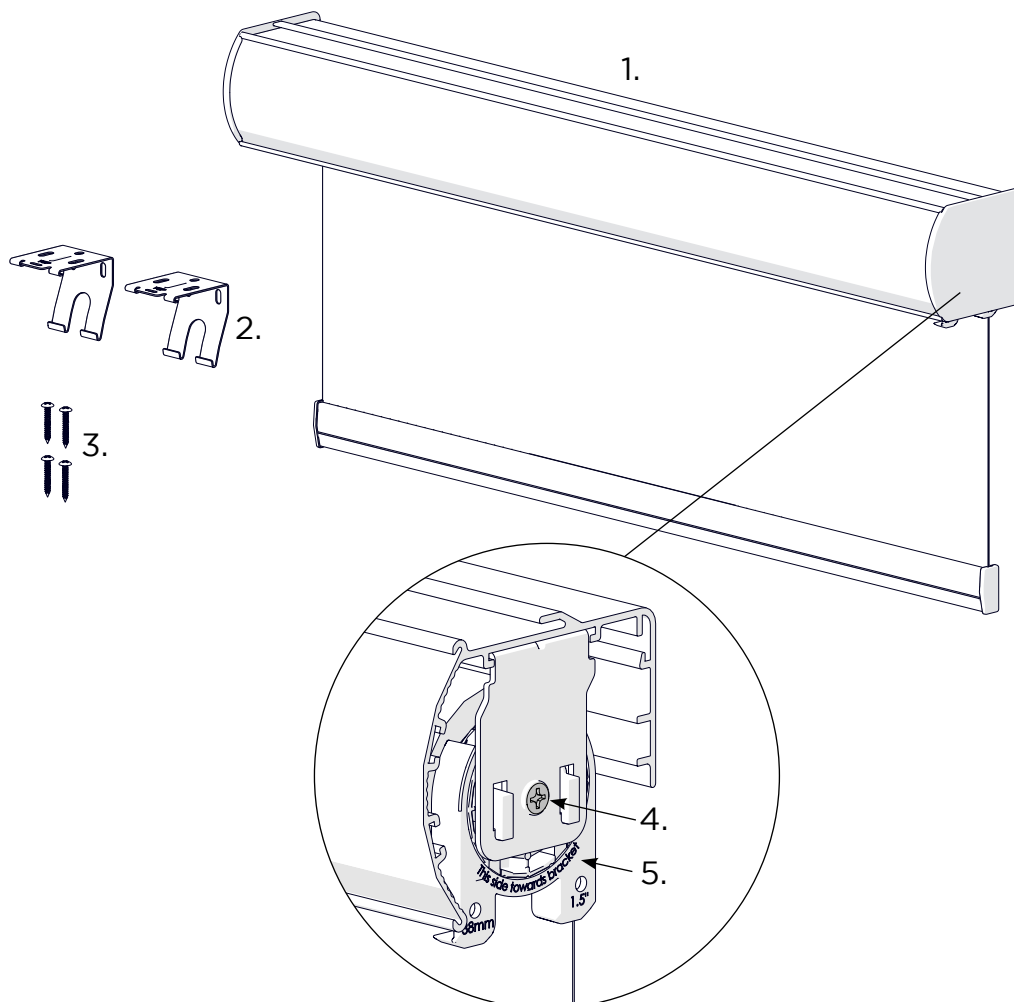

* The screw is used to secure the head to the bracket during transportation of Cassette, Pelmet, and Mounting Rails. (screw should be removed before installing the shade)

** The clip must be removed before the shade is operated.

SECTION J | TROUBLESHOOTING

NO.	PROBLEM	CAUSE	SOLUTION
1	Erratic Behaviour	Spring Control on wrong end	Remove and re-install on other end (See Section E, Part A)
	Blind falls	No Pre-Turns	Refer to charts for correct pre-turns
2	Blind will raise quickly	Wrong Decelerator	Remove and re-install correct Decelerator (See Section E, Part B, Booster & Decelerator)
		Too many Pre-Turns	Remove Pre-Turns (See Section D, Part C)
For pretension + limit position adjustment please refer to the Installation Manual			