

ZIPSCREEN

FEATURES & BENEFITS

- Ideal solution for enclosing Pergolas, Al Fresco & outdoor entertaining areas offering privacy and protection from the sun, wind, rain and insects in a clean, architectural look.
- Custom designed system can be made in widths of up to 7 metres (22.9ft) or drops up to 5 metres (16.4ft), offering you an external solution to fit almost any area.
- Wide range of standard colours and ability to custom powder-coat extrusions to suit any external environment.
- Streamlined-design offering multiple control options provides ease of assembly and installation in exterior applications.
- Motorized versions are provided with impact detection functionality and can be paired with our Sun & Wind sensor to provide an intelligent and reliable outdoor shading system.
- Single-piece F56 & F72 weight bars provide ultimate rigidity & outstanding performance over large openings.



HARDWARE

OPEN BRACKETS

SQUARE

EXTREME

BOX

BOX 120

BOX 190

CONTROLS

MOTOR

SPRING

CRANK

TUBES

78mm

110/130/160mm

WEIGHT BARS

F56

F72

COLOUR RANGE

- black
- pure white
- classic cream
- paperbark
- woodland grey
- monument
- bronze

5 YEAR WARRANTY

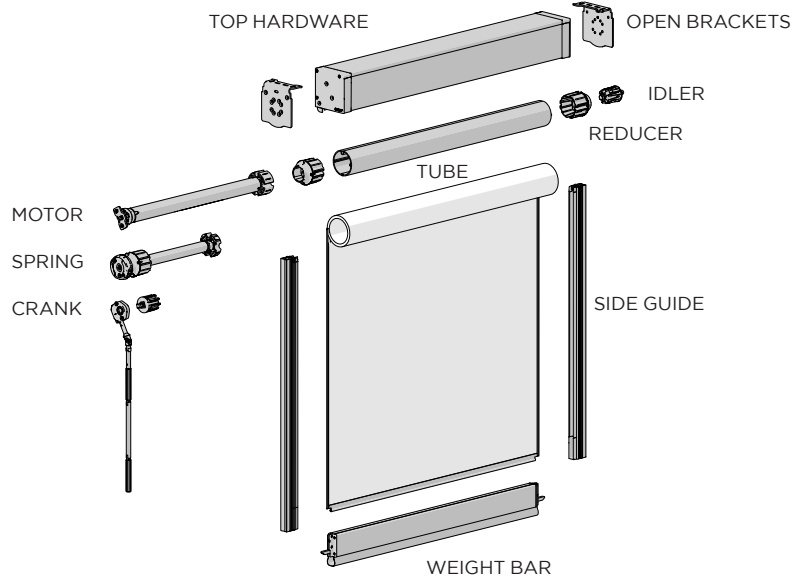

KEY SYSTEM FEATURES

PREMIUM CONTROL OPTIONS



Motorized Controls

Powered by Automate™, Zipscreen shades can be remote-controlled or integrated into home automation platforms to provide the ultimate outdoor living experience.



Manual Controls

Crank controls are perfect for areas with high ceilings while Spring controls provides the ability to seamlessly move the shade up and down to the desired position.

THE ZIPSCREEN DIFFERENCE

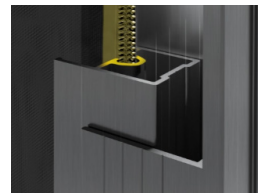

Hidden side retention system keeps the fabric secure in channels.

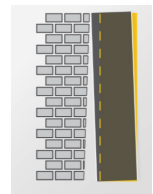

Adjustable side channels enable easy installation in out-of-square openings, up to 20mm (3/4") per side

SECURE ASSEMBLY & INSTALLATION

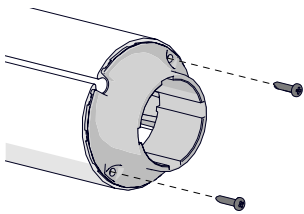

Reducer screws into tube for secure, reliable connection.

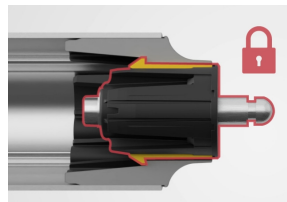

Snap-lock features provide secure connection and fast assembly.

CLEAN, SMOOTH LOOK WITH ULTRA-LOCK

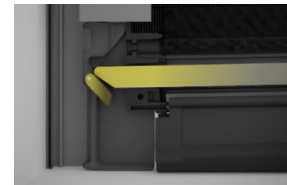

Exclusive to the Zipscreen system, the patented Ultra-Lock hidden locking mechanism integrates into the side channels. Durable, reliable and completely unobtrusive, Ultra-Lock secures and tensions the shade for a smooth, taut fabric finish.

SYSTEM OPTIONS

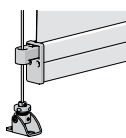

WIRE GUIDE

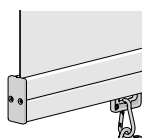

STRAIGHT DROP

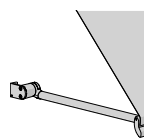

PIVOT ARM

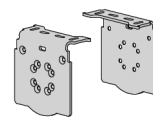

OPEN BRACKETS

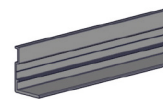

L-Fixing Rail
(Outside Mount)

ZIPSCREEN

MINIMUM WIDTH

MOTOR	CRANK	500mm [19-11/16"]
	15 Nm (AU)	770mm [30-5/16"]
	15 Nm (US)	805mm [31-11/16"]
SPRING	10 Nm (US)	905mm [35-5/8"]
	COMPACT	550mm [21-5/8"]
	LIGHT	730mm [28-3/4"]
	STANDARD	930mm [36-5/8"]
	HEAVY	1080mm [42-1/2"]
	EXTRA HEAVY	1290mm [50-13/16"]
	ULTRA HEAVY	1460mm [57-1/2"]

MAX ROLL

BOX 120	Ø110mm [4-5/16"]
BOX 190	Ø156mm [6-1/8"]
OPEN SQUARE	Ø130mm [5-1/8"]
OPEN EXTREME	Ø170mm [6-11/16"]

SYSTEM CAPACITY

		WIDTH													
		1.0	1.5	2.0	2.5	3.0	3.5	4.0	4.5	4.8	5.8	6.0	6.5	7.0	
DROP	m														
	1.0														40
	1.5														60
	2.0														79
	2.4														95
	3.0														119
3.5														138	
4.0														158	
4.5														178	
5.0														197	
		40	60	79	99	119	138	158	178	189	229	237	256	276	in

SYSTEM	BRACKETS
Zipscreen Wire Guide Straight Drop Pivot Arm	Box 120 or Open Brackets
Zipscreen	Box 120
Wire Guide Straight Drop	Box 120
Zipscreen	Open Brackets
Zipscreen	Box 190
Outside Product Specifications	

TECHNICAL DATA

SYSTEM	TOP HARDWARE			TUBES				CONTROLS			W.BARS		
	BOX 120	BOX 190	OPEN	78MM	110MM	130MM	160MM	SPRING	CRANK	MOTOR	F56	F72	PIVOT
ZIPSCREEN	✓	✓	✓	✓	✓	✓		✓	✓	✓	✓	✓	
WIRE GUIDE	✓	✓	✓	✓	✓	✓	✓		✓	✓	✓	✓	
STRAIGHT DROP	✓	✓	✓	✓	✓	✓	✓		✓	✓	✓	✓	
PIVOT ARM	✓		✓	✓					✓	✓			✓

78MM			S100				SYSTEM OPTIONS		WIRE GUIDE OPTIONS					
BRACKETS	BOX 120	OPEN		BOX 190	OPEN		WEIGHT BARS	F56	F72	3.2MM	4MM			
TUBES	78MM STD/HD	78MM STEEL		S100 110MM		S100 130MM		LOCKS	ULTRA-LOCK	BOLT LOCK		3.2MM BRACKET	UNIVERSAL BRACKET	
CONTROLS	CRANK	SPRING	MOTOR	MOTOR				SPRING ADDONS	HANDLES		PULL STICK	4MM BRACKETS	FLOOR MOUNT	FACE FIX