



SS38

PRODUCT SPECIFICATIONS

CONTENTS

SECTION A OVERVIEW	01
GENERAL SCHEMATICS	01
SYSTEM OPTIONS	03
SECTION B SPECIFICATION CHARTS	04
DIRECT DRIVE	04
PLANETARY DRIVE	06
0.8Nm MOTOR	08
0.6Nm MOTOR	10
MOUNTING CLIP MEASUREMENTS	12
SECTION D MATERIAL COMPOUNDS	13
SECTION E WARRANTY	14

DISCLAIMER

INTRODUCTION

This Product Specifications manual for SS38 Systems has been produced by Rollease Acmeda to supply the necessary information for the safe and correct installation of SS38 Systems.

DISCLAIMER

Rollease Acmeda has used reasonable care in preparing the information included in this document, but makes no representations or warranties as to the completeness or accuracy of the information. Information is supplied upon the condition that the persons receiving the information will make their own determination as to its suitability for their purposes prior to use. Rollease Acmeda assumes no liability whatsoever for any damages incurred by you resulting from errors in or omissions from the information included herein. Rollease Acmeda reserves the right to make changes without further notice to any products to improve reliability, function or design.

COPYRIGHT

COPYRIGHT © ROLLEASE ACMEDA

All rights are reserved. No part of this document may be reproduced or utilised in any means, by any means, electronic or mechanical including photocopying, recordings, or by any information storage or retrieval system, without the express permission from Rollease Acmeda.

GENERAL SCHEMATICS

CHAIN CONTROL

The SS38 Roman Shade System offers an elegant square profile housing new operating mechanisms designed for efficient and smooth operation.

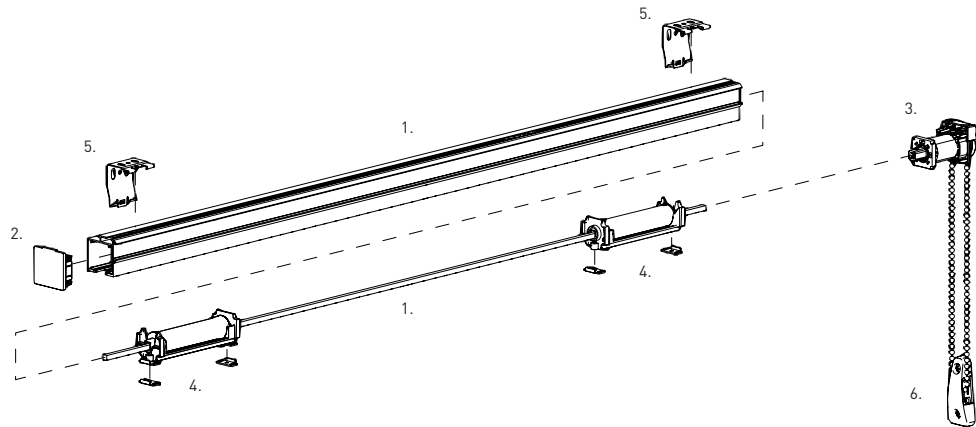

SYSTEM INDEX: Chain Control

1. SS38 Aluminum Profile + Crimp Tape & Square Tiltrod
2. SS38 Head Rail End Cap
3. SS38 Drive Unit
4. SS38 Spool with Cord 4m [13.12ft]
5. SS38 Low Profile Mounting Clip
6. Chainhold Tension Device

CL 0.8Nm CORD LIFT MOTOR

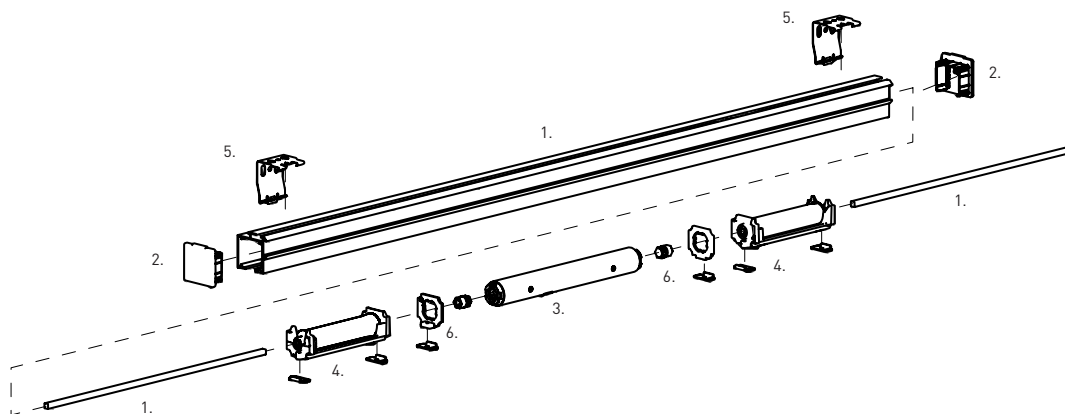

SYSTEM INDEX: 0.8Nm Motor

1. SS38 Aluminum Profile + Crimp Tape & Square Tiltrod
2. SS38 Head Rail End Cap
3. CL 0.8Nm Cord Lift Motor
4. SS38 Spool with Cord 4m [13.12ft]
5. SS38 Low Profile Mounting Clip
6. SS38 Cord Lift Motor Adapter Kit

GENERAL SCHEMATICS

CL 0.6Nm CORD LIFT MOTOR - US ONLY

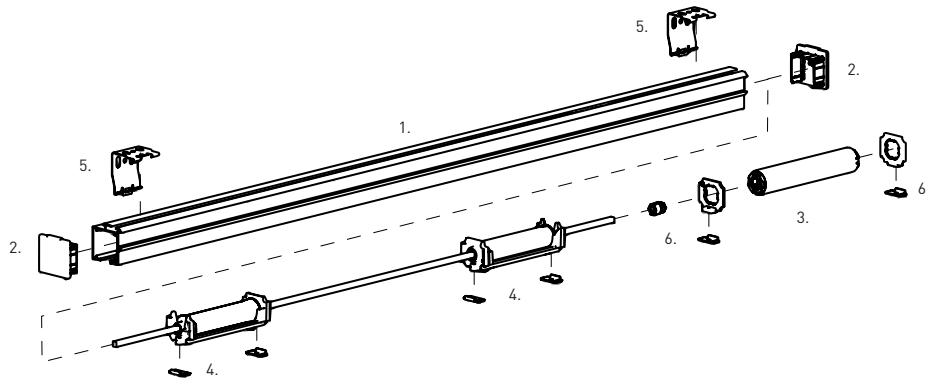

SYSTEM INDEX: 0.6Nm Motor

1. SS38 Aluminum Profile + Crimp Tape & Square Tiltrod
2. SS38 Head Rail End Cap
3. CL 0.6 Nm Cord Lift Motor
4. SS38 Spool with Cord 4m [13.12ft]
5. SS38 Low Profile Mounting Clip
6. SS38 Cord Lift Motor Adapter Kit

SYSTEM OPTIONS

MOTOR OPTIONS

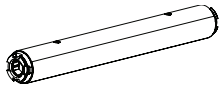

CL 0.8Nm



CL 0.6Nm

CHAIN CONTROL OPTIONS

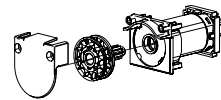

PLANETARY DRIVE

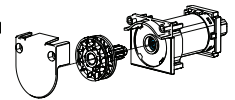

DIRECT DRIVE

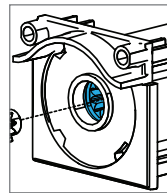

NOTE:
The direct drive can be identified by an internal blue component.

COMPONENT OPTIONS

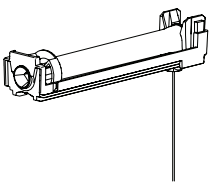

SLIM SPOOL

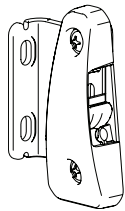

CHAIN HOLD TENSION DEVICE



SAFETY SHROUD

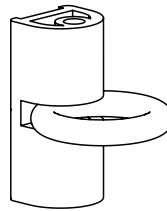

RING LOCK (US ONLY)

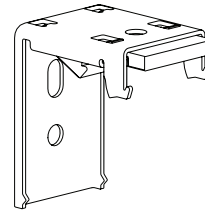

SPRING LOADED MOUNTING BRACKET (AU + EU ONLY)

COLOR OPTIONS



069

WHITE



020

ANODISED*



050

BLACK*

*NOT AVAILABLE IN US



SECTION B | SPECIFICATION CHARTS

DIRECT DRIVE

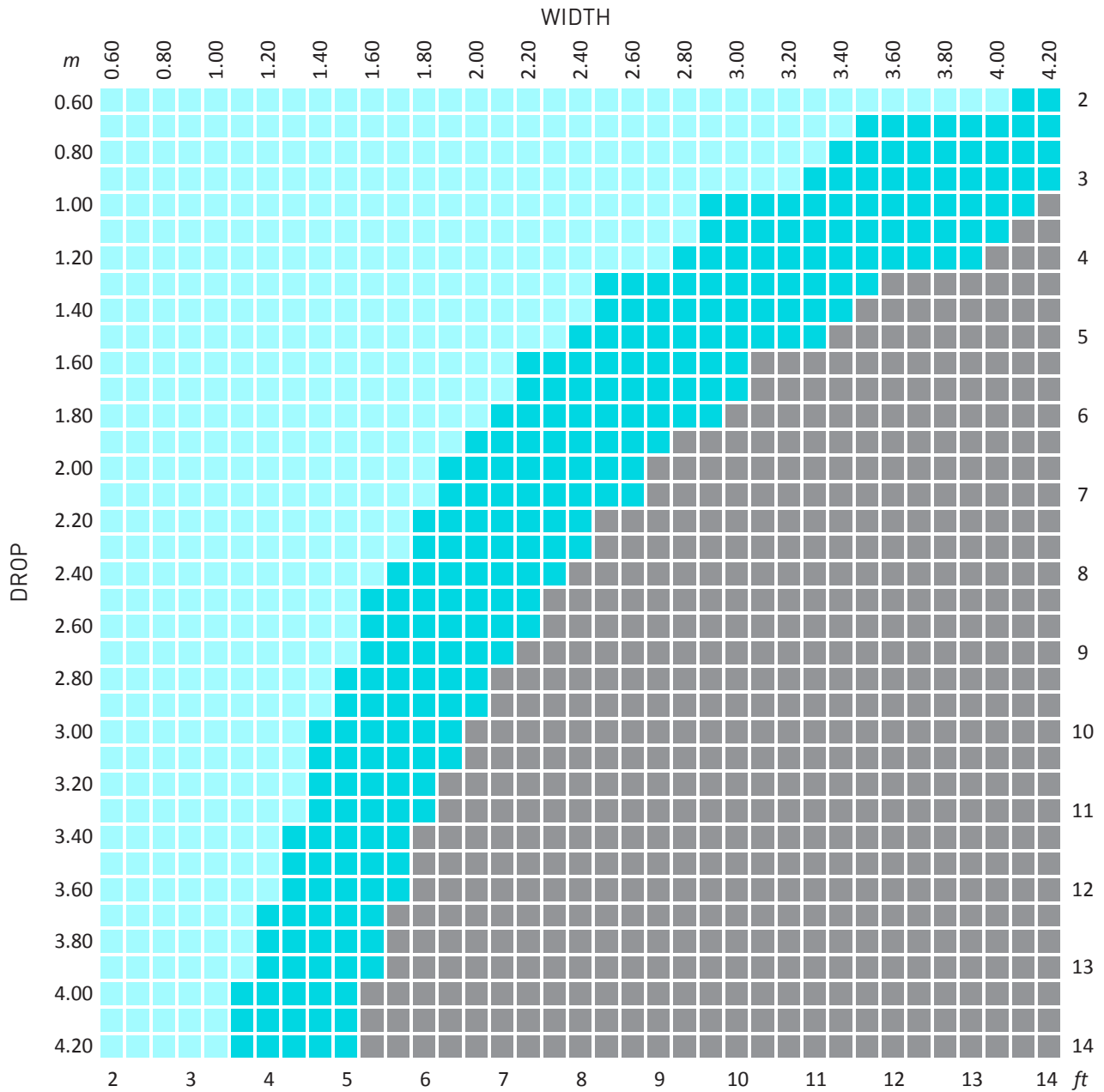
DIRECT DRIVE - 160gsm (5oz/Yd²)



Minimum Shade Width = 406mm [16"]



LEGEND	DESCRIPTION
	Direct Drive - CTS Spool 3.5kg User Effort
	Direct Drive - Slim Spool 3.5kg User Effort
	Cannot be achieved - outside product specifications

SECTION B | SPECIFICATION CHARTS

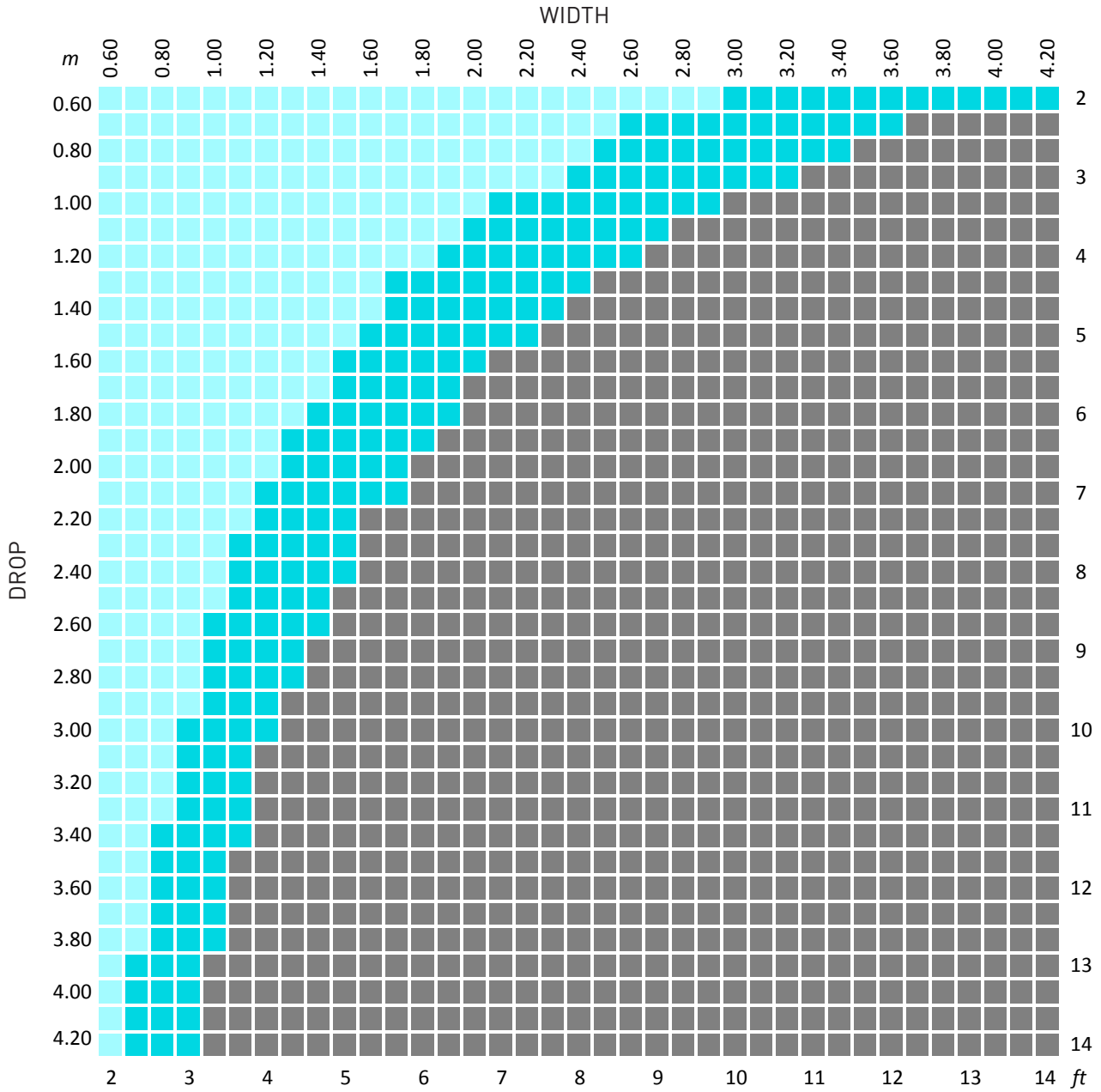
DIRECT DRIVE - 430gsm (12oz/Yd²)



Minimum Shade Width = 406mm [16"]

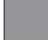

LEGEND	DESCRIPTION
	Direct Drive - CTS Spool 3.5kg User Effort
	Direct Drive - Slim Spool 3.5kg User Effort
	Cannot be achieved - outside product specifications

PLANETARY DRIVE

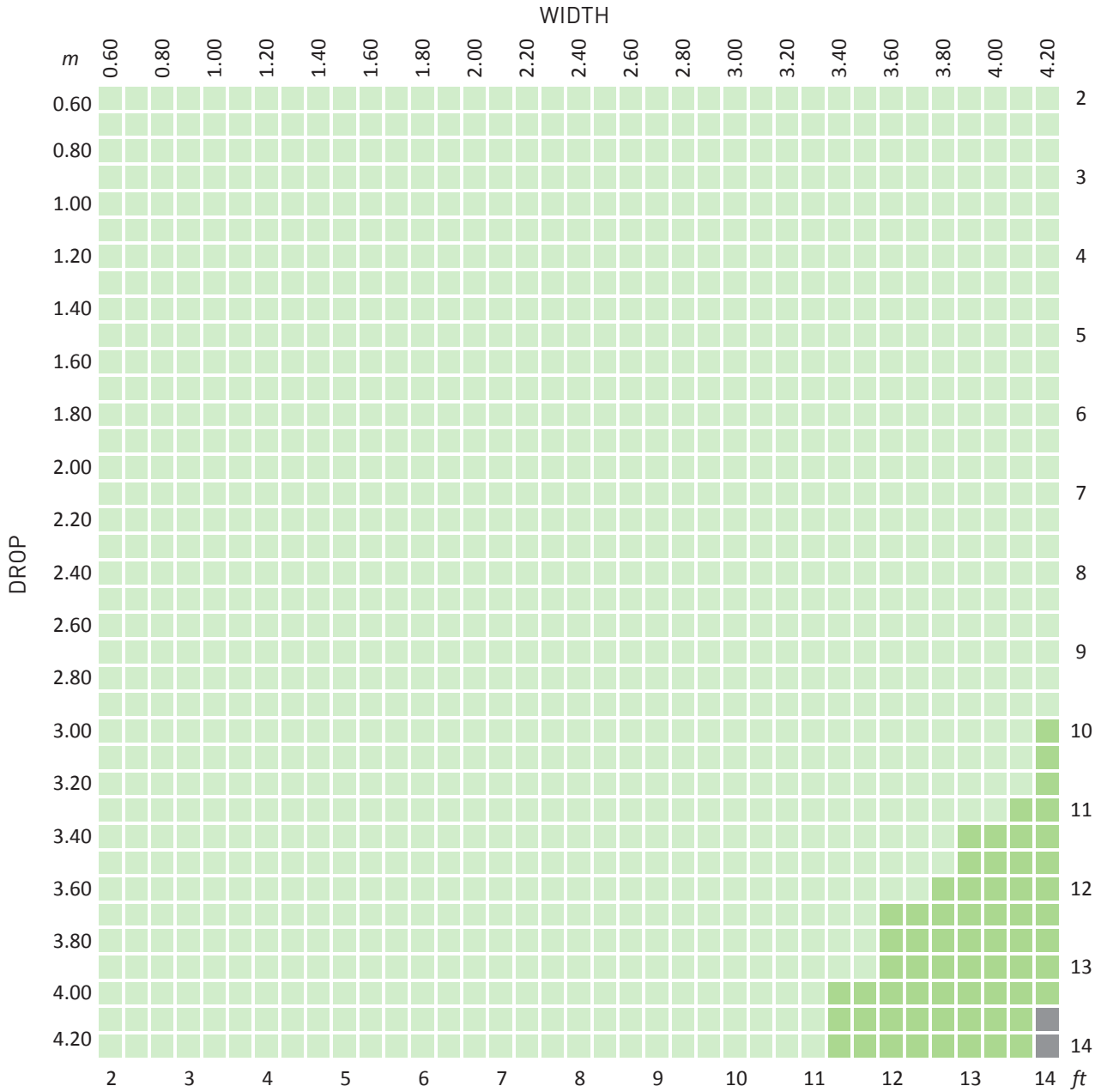
PLANETARY DRIVE - 160gsm (5oz/Yd²)



Minimum Shade Width = 406mm [16"]



LEGEND	DESCRIPTION
	Planetary Drive - CTS Spool 3.5kg User Effort
	Planetary Drive - Slim Spool 3.5kg User Effort
	Cannot be achieved - outside product specifications

SECTION B | SPECIFICATION CHARTS

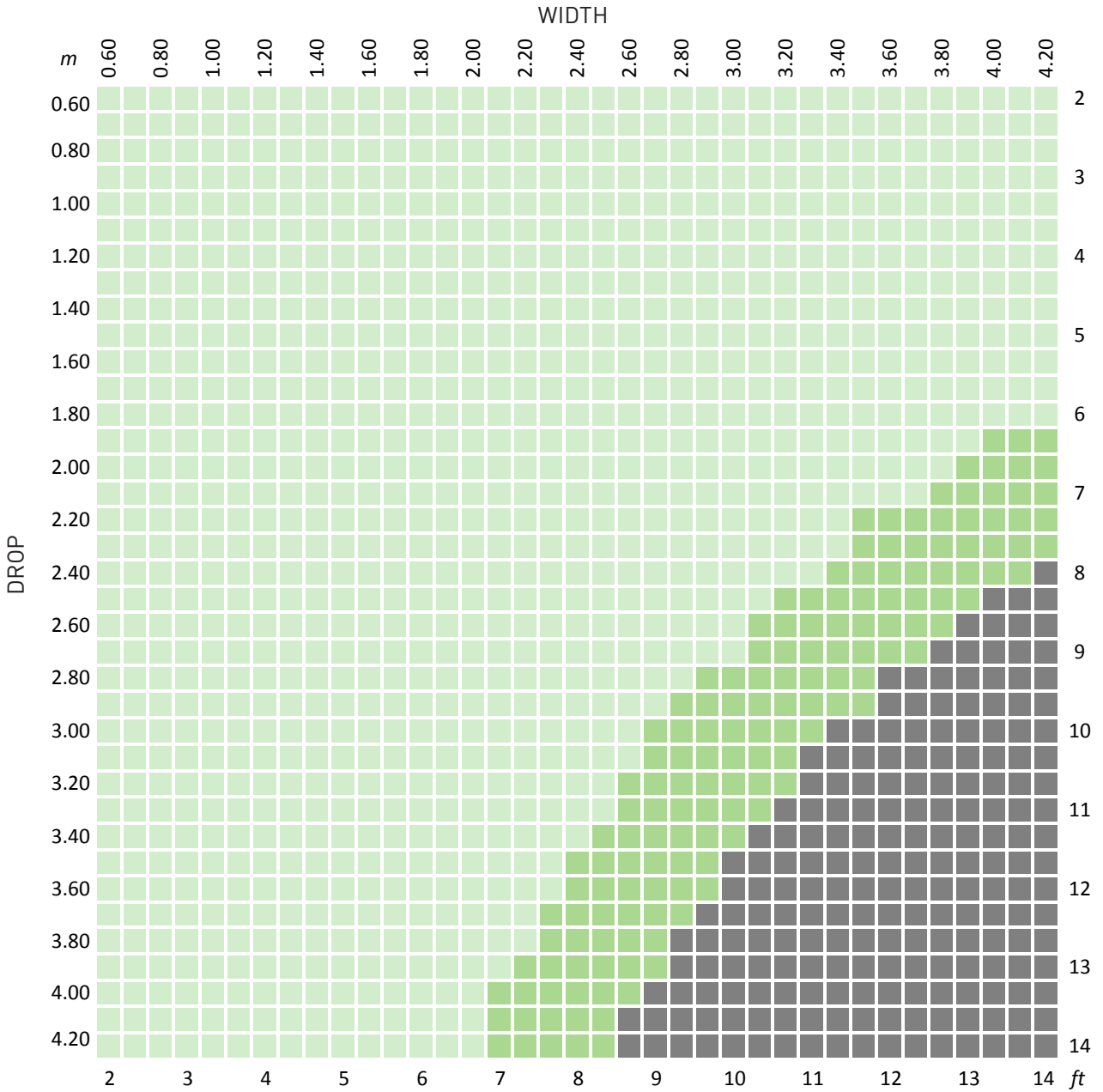
PLANETARY DRIVE - 430gsm (12oz/Yd²)



Minimum Shade Width = 406mm [16"]



LEGEND	DESCRIPTION
	Planetary Drive - CTS Spool 3.5kg User Effort
	Planetary Drive - Slim Spool 3.5kg User Effort
	Cannot be achieved - outside product specifications

0.8Nm MOTOR

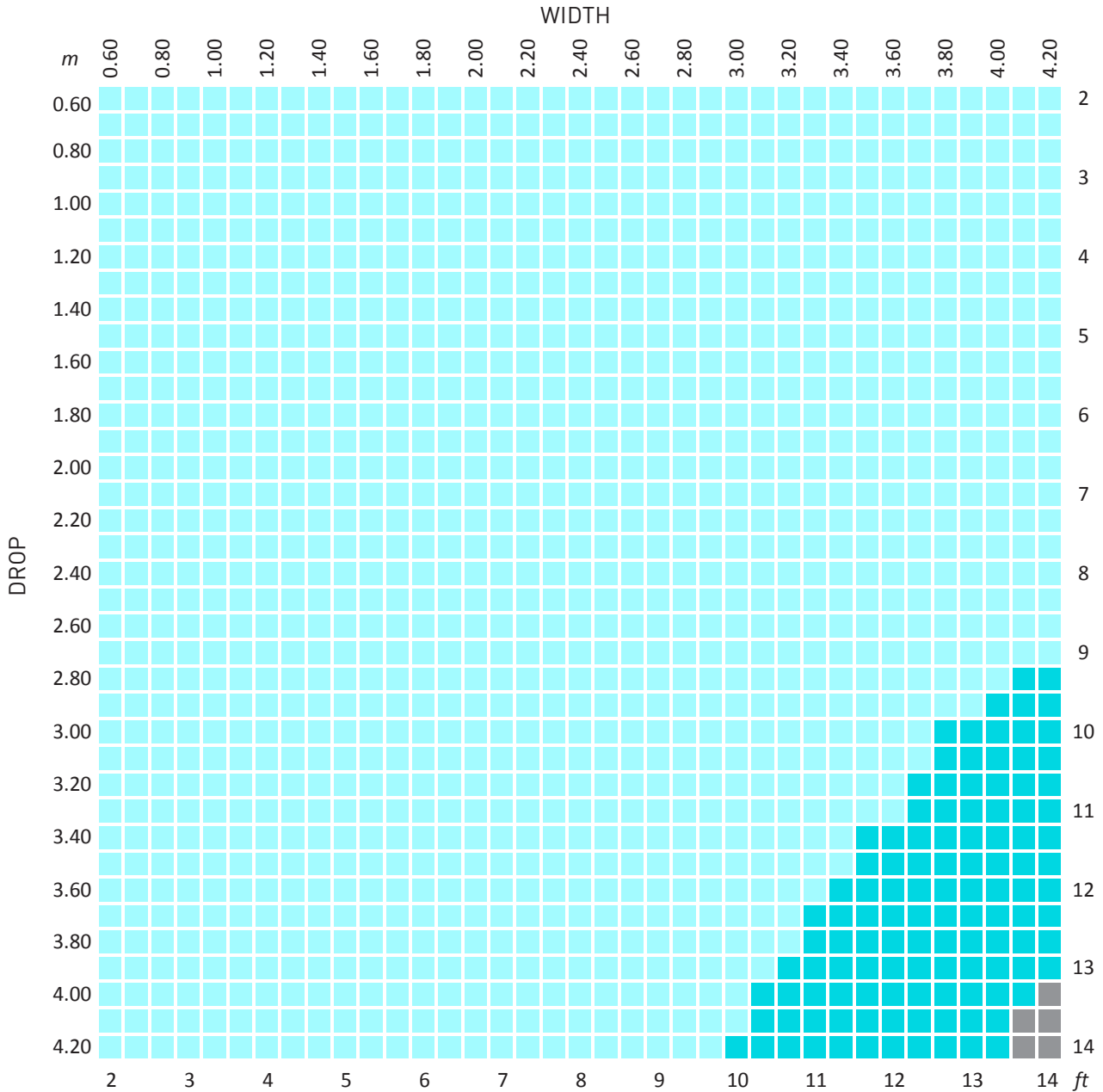
0.8Nm MOTOR - 160gsm (5oz/Yd²)



Minimum Shade Width = 520mm [20"]



LEGEND	DESCRIPTION
	0.8Nm Motor - CTS Spool
	0.8Nm Motor - Slim Spool
	Cannot be achieved - outside product specifications

SECTION B | SPECIFICATION CHARTS

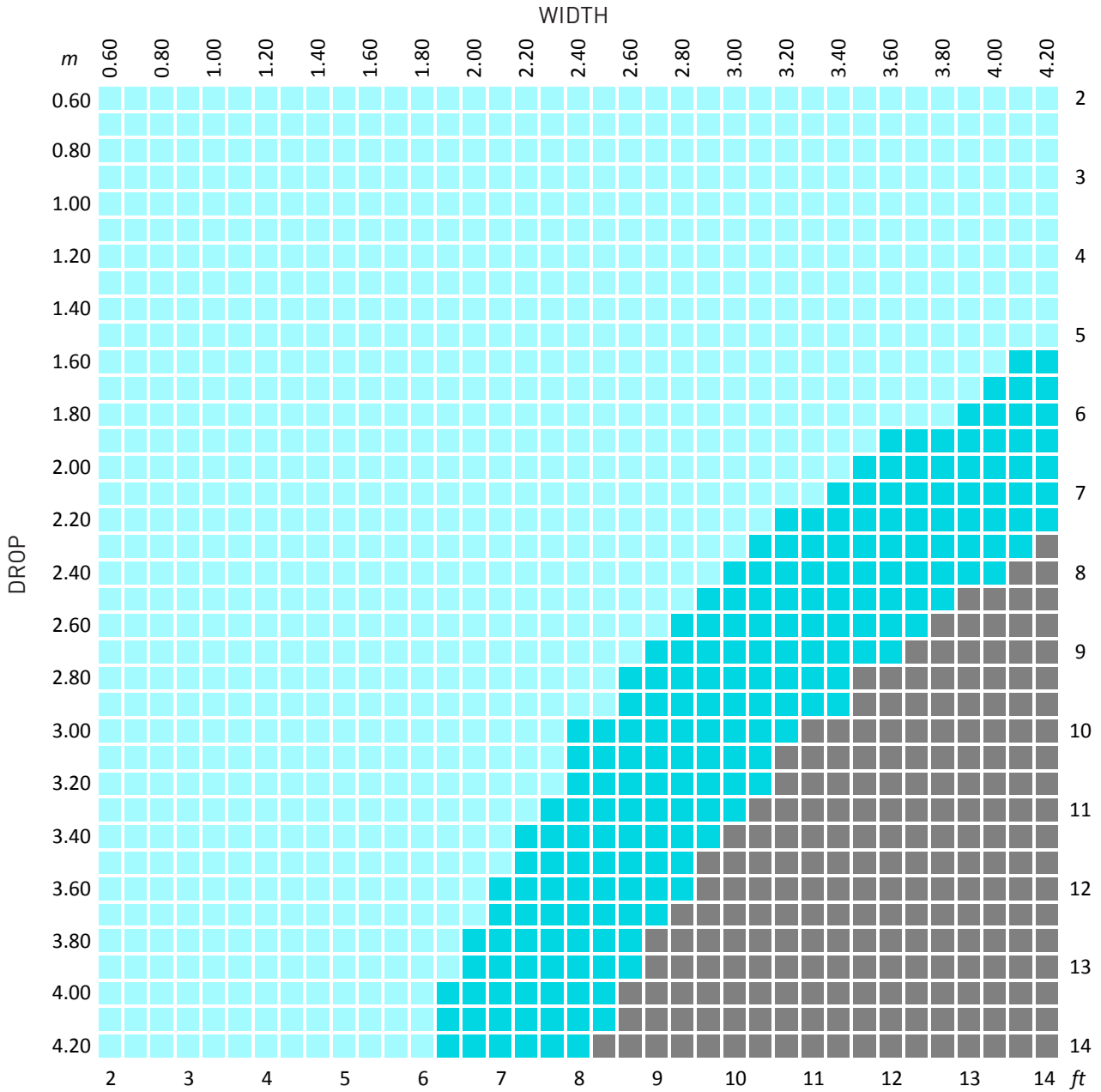
0.8Nm MOTOR - 430gsm (12oz/Yd²)



Minimum Shade Width = 520mm [20"]



LEGEND	DESCRIPTION
	0.8Nm Motor - CTS Spool
	0.8Nm Motor - Slim Spool
	Cannot be achieved - outside product specifications

0.6Nm MOTOR

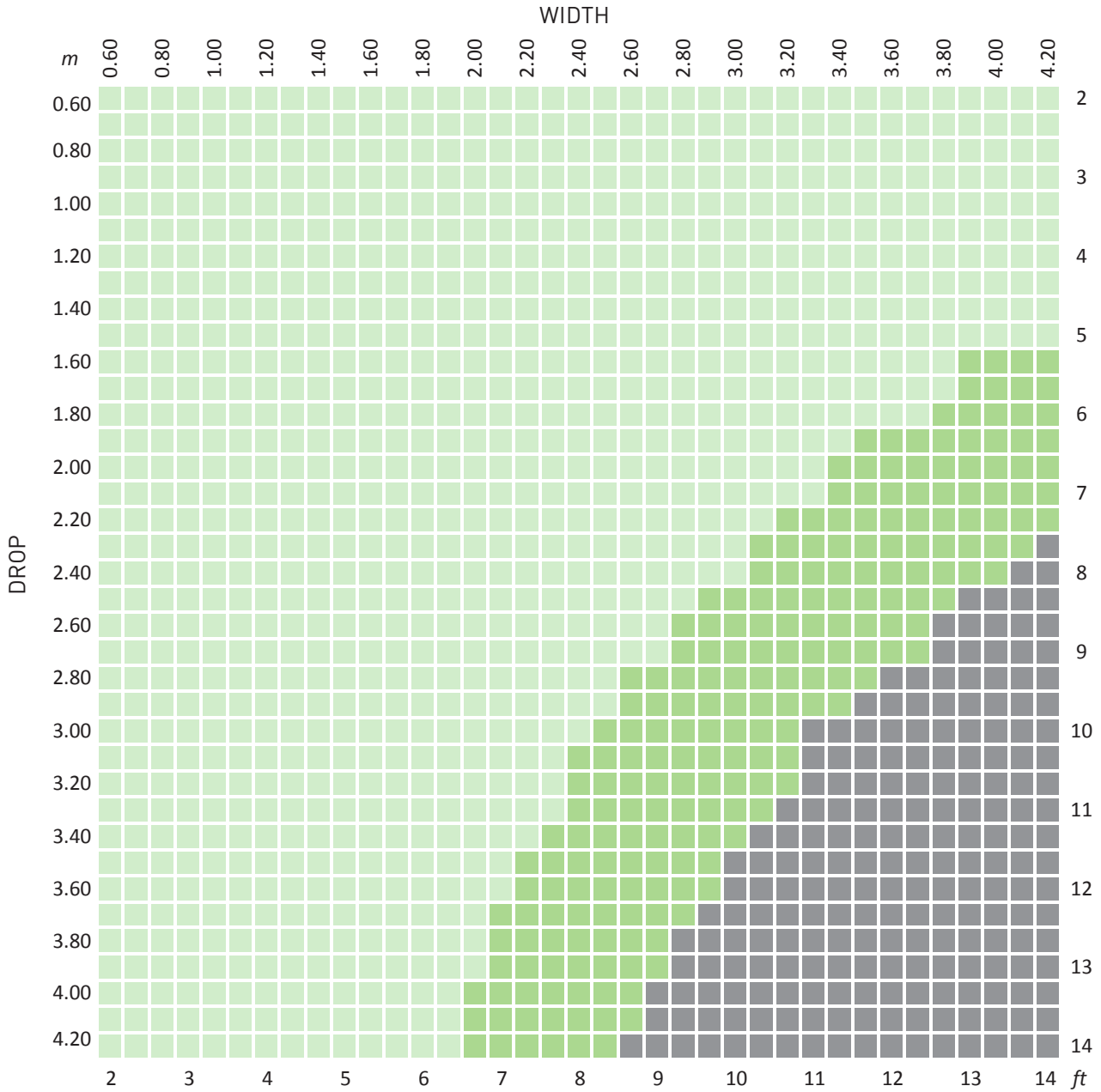
0.6Nm MOTOR - 160gsm (5oz/Yd²)



Minimum Shade Width = 520mm [20"]



LEGEND	DESCRIPTION
	0.6Nm Motor - CTS Spool
	0.6Nm Motor - Slim Spool
	Cannot be achieved - outside product specifications

SECTION B | SPECIFICATION CHARTS

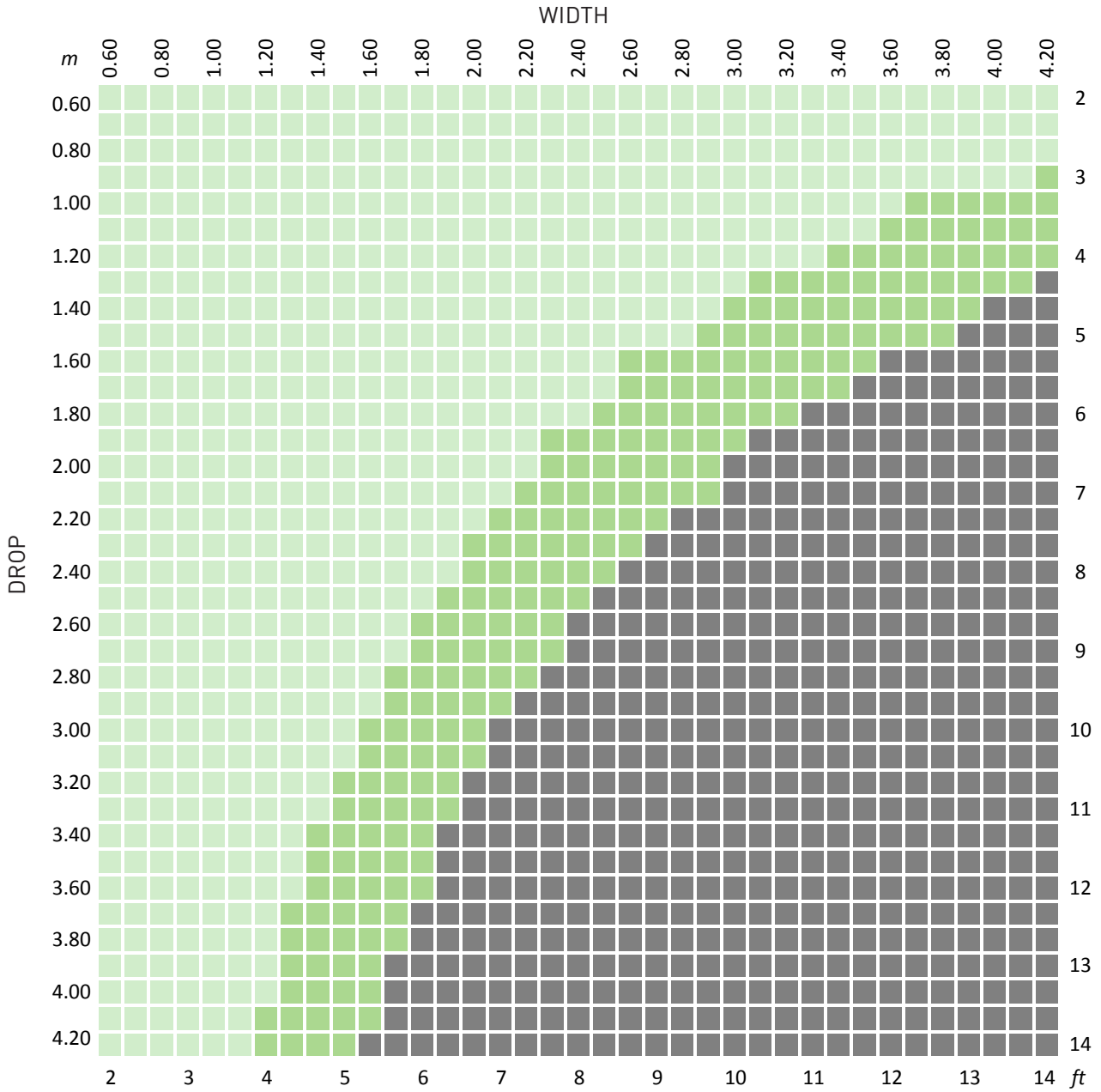
0.6Nm MOTOR - 430gsm (12oz/Yd²)



Minimum Shade Width = 520mm [20"]

LEGEND	DESCRIPTION
	0.6Nm Motor - CTS Spool
	0.6Nm Motor - Slim Spool
	Cannot be achieved - outside product specifications

MOUNTING CLIP MEASUREMENTS

MOUNTING CLIP

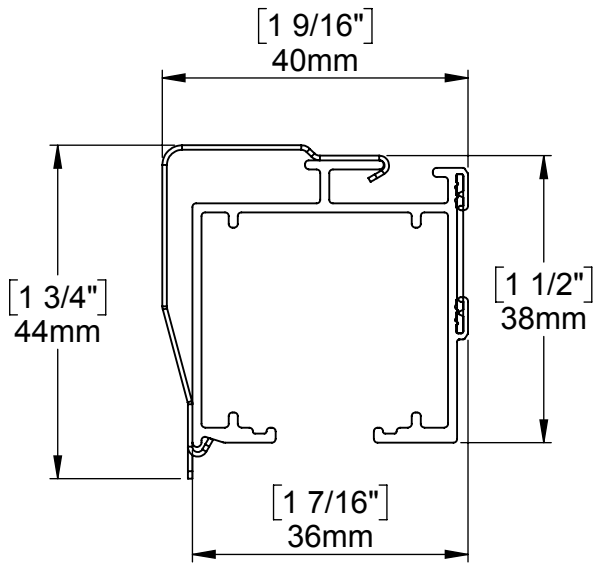

SPRING LOADED MOUNTING BRACKET*

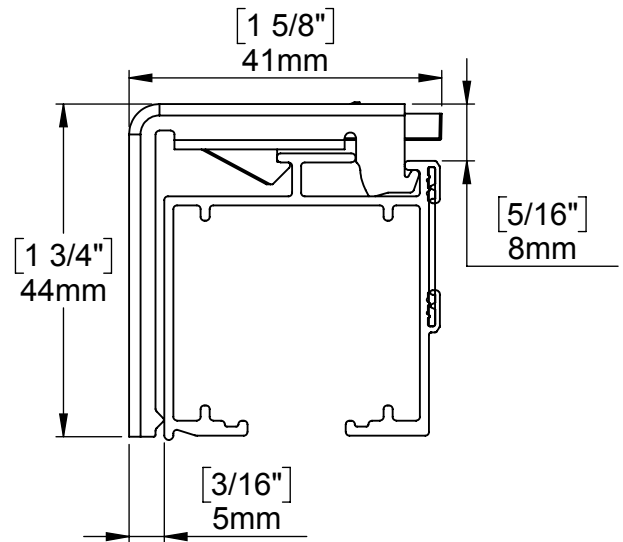

*PRODUCT ONLY AVAILABLE IN AU + EU

SECTION D | MATERIAL COMPOUNDS

PART NUMBER	PRODUCT	MATERIAL	Aluminum & STEEL FINISHES
SS38-0130-XXXLLL	SS38 ALUM. PROFILE + CRIMP TAPE + 5MM SQUARE ROD	ALUMINUM	ANODIZED 15
SS38-0411-XXX051	SS38 DIRECT DRIVE	POM, NYLON, ASA, STEEL	
SS38-0420-XXX051	SS38 PLANETARY DRIVE	POM, NYLON, ASA, STEEL	
SS38-8341-XXX451	SS38 SPOOL WITH CORD (4M)	POM, HDPE, PC, STEEL	
SS38-8331-XXX051	SS38 SLIM SPOOL WITH CORD (4M)	POM, HDPE, NYLON, STEEL	
SS38-0212-XXX034	SS38 LOW PROFILE MOUNTING CLIP	STEEL	ZINC PLATED
SS38-0120-XXX040	SS38 HEAD RAIL END CAP	NYLON	
RB92-1001-001100	10MM ACM FLAT SPLINE - NO TAPE	ASA	
RB92-1002-001075	10MM ACM FLAT SPLINE - WITH DOUBLE SIDED TAPE (1 SIDE)	ASA	
RB92-1003-001075	10MM ACM FLAT SPLINE - WITH DOUBLE SIDED TAPE (2 SIDES)	ASA	
HD31-0125-060025	TOUCH TAPE SEW-ON LOOP 25MM	-	
VA01-1401-010XSS	METAL ROTATION CHAIN	STAINLESS STEEL	
VA01-1401-020ASS	METAL ROTATION CHAIN	ALUMINUM	
VA01-1401-020BSS	METAL ROTATION CHAIN	BRASS	
VA01-1401-020SSS	METAL ROTATION CHAIN	STEEL	NICKLE PLATED
VA01-1401-S20SSS	PRE LOOPED METAL ROTATION CHAIN	STEEL	
VA01-1401-X10SSS	PRE LOOPED METAL ROTATION CHAIN	STAINLESS STEEL	
VA01-1406-XXXSSS	PRE LOOPED PLASTIC ROTATION CHAIN COLORS	POM	
RB91-1321-XXX000	CHAIN TENSIONERS & SCREWS: FACE/WALL MOUNT	POM, PP, STEEL	
RB91-1322-XXX000	CHAIN TENSIONERS & SCREWS: RECESS/INSIDE MOUNT	POM, PP, STEEL	
SS91-1312-000040	CHAIN TENSIONING HOOK 'SMALL' & SCREW	PC	
SS38-0232-069030	SS38 SPRING LOADED MOUNTING CLIP	STEEL	ZINC PLATED
MTAD-CLHRSS38KT	CORD LIFT MOTOR HEADRAIL ADAPTERS	STEEL, POM	

SECTION E | WARRANTY

Rollease Acmeda provide a 5 year hardware warranty against defects to the original purchaser (the fabricator/ manufacturer).

The hardware warranty is not to be transferred to the end consumer.

The hardware warranty is limited to the repair or resupply of defective hardware components to the fabricator/ manufacturer only.

The hardware warranty is applicable to normal use.

The hardware warranty will not apply where the defect arises due to incorrect assembly and installation.

Retailers are obliged to supply consumers with their own warranty, if required, at the point of purchase.