

BRACKET OPTIONS

TUBE OPTIONS

SINGLE

DOUBLE

TUBE

FABRIC OPTIONS

CONTROL OPTIONS

CLUTCH

MOTOR

HEM BAR

HEM BAR OPTIONS

MEDIUM SYSTEM UPGRADES:

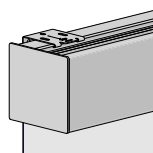

CASSETTE

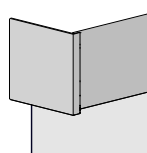

FASCIA

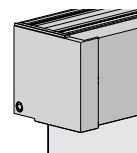

P95 PELMET

WIRE GUIDE

EASY-LINK

MOUNTING RAIL

CF90

POCKET

CONTENTS

CONTROL OPTIONS

CHAIN

- 03** SKYLINE CLUTCH
- Hooked clutches and spring-loaded pin ends allow for fast and forgiving installation.
- SL15 & SL20 SPRING ASSIST BOOSTER
- Spring Assist Booster reduces shade lifting effort by up to 40%.
 - Child safe accessories available.

MOTOR

- 07** MOTORS | ARC PRO LI-ION
- 08** MOTORS | CONTROLLERS
- Smart Home Automation and voice control available with the Pulse PRO App.
 - Multiple power-source configurations suitable for Commercial or Residential use.
 - Wide range of Remotes & Accessories available.

HARDWARE

- 11** ALUMINUM TUBES
- Extrusions available for all shade sizes.

- 12** BRACKETS | SINGLE
- Available in multiple styles.
 - Available for multiple mounting solutions.

- 13** BRACKETS | DOUBLE
- Dual shades for day/night applications.
 - Available for multiple mounting solutions.

- 14** HEM BAR
- Multiple sizes and styles to suit all shade solutions.
 - Multiple add-ons available to customize installation.

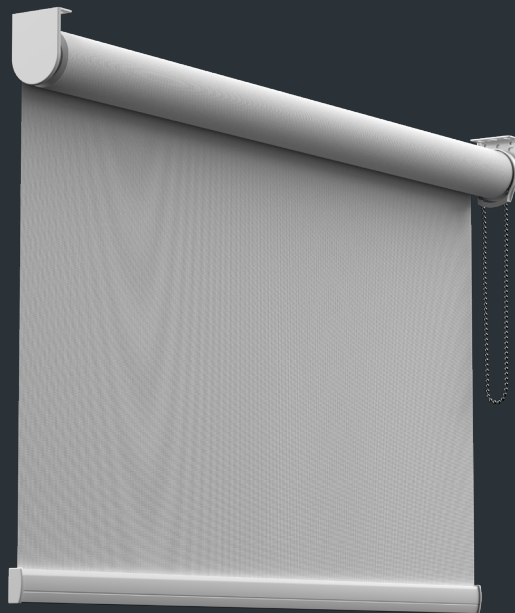

SKYLINE CLUTCH

FEATURES & BENEFITS

- Universal brackets available for single and dual shades with multiple projections.
- Hooked clutches and spring-loaded pin ends allow for fast and forgiving installation.
- Fiberglass-filled nylon construction provides long lasting durability.
- Spring Assist Booster reduces the pull force required to use heavy shades.
- Patented geared clutches provide a smooth operation.
- Exterior versions of SL20 and SL30.



COLOR RANGE

- black
- white
- gray
- vanilla
- satin nickel
- antique bronze

WEBPAGE LINK

HARDWARE

LIMITED LIFETIME WARRANTY

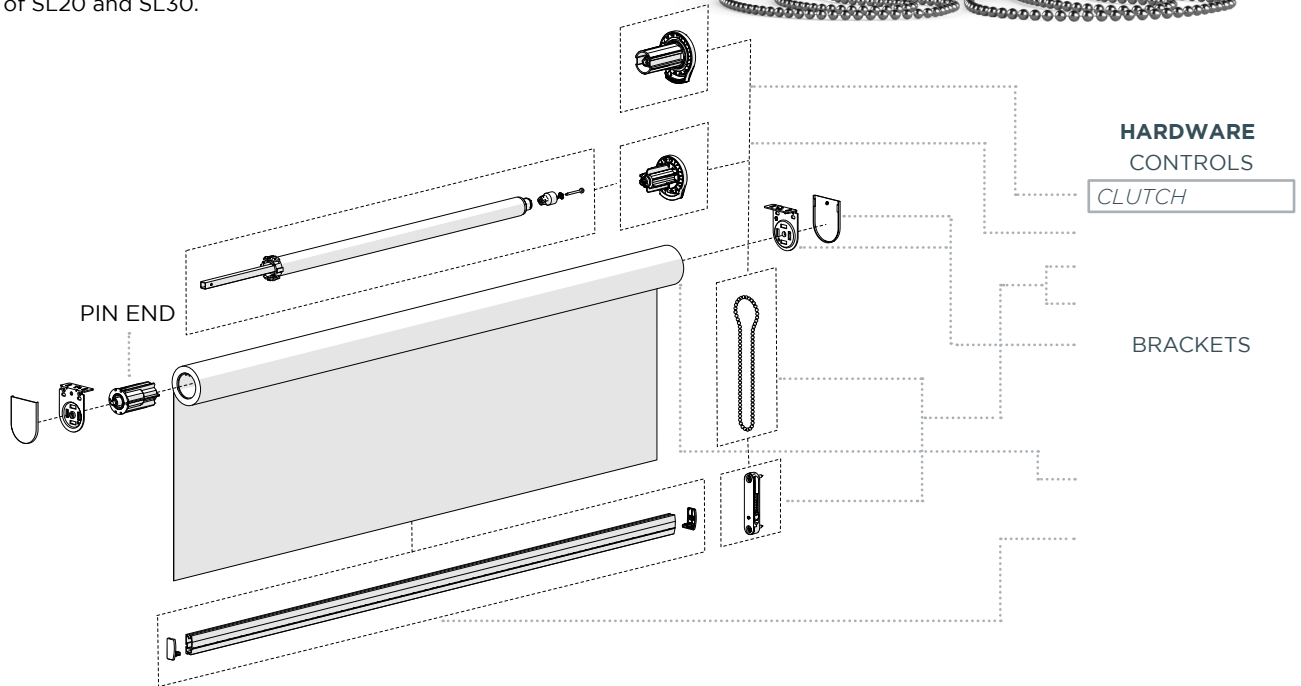

KEY SYSTEM FEATURES

UNIVERSAL BRACKETS

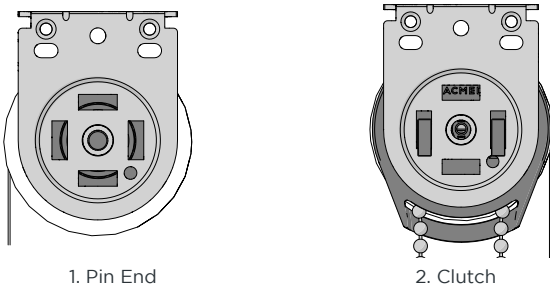

FIXED CHAIN GUARD

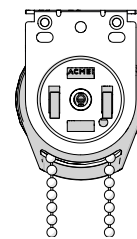

Prevents bead chain from getting tangled.

QUICK AND EASY INSTALLATION

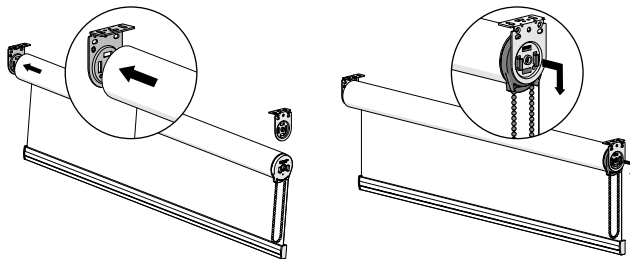

Simply push pin end into bracket. Then, install the clutch.

SPRING ASSIST BOOSTER

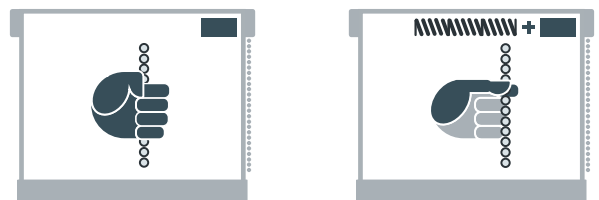

Reduces shade lifting effort by 40%.

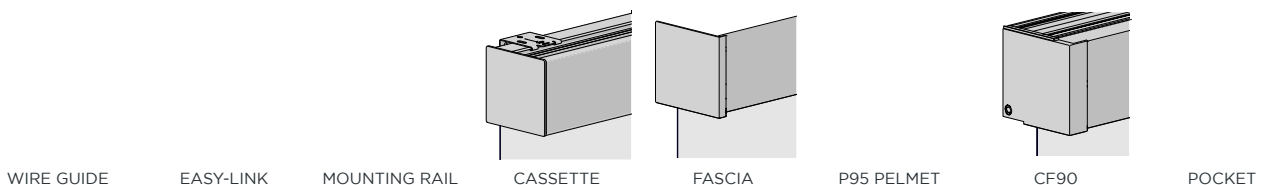

PRODUCT SPECIFICATIONS

TUBE CAPACITY

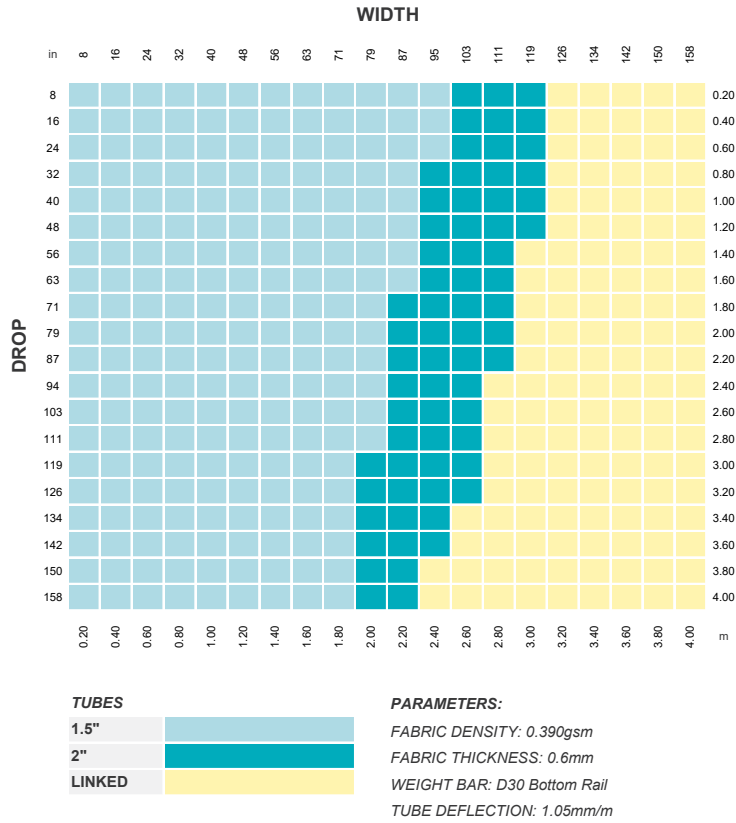

TECHNICAL DATA

MAX HOLD CAPACITY					
CLUTCH	LOAD		TUBE		CORD or BEAD CHAIN
	lbs	kg	inch	mm	
SL10	11	5.0	1-1/8	28	Both
SL15	16.5	7.5			
SL15	12	5.5	1-1/2	38	
SL20	20	9.1			
SL20	15	6.8	2	50	Bead
SL30	22	10			
SL30	18	8.2	2-1/2	63	
SL30	14.4	6.5	3-1/4	83	
G200	24	10.9	1-1/2	38	
G200	18	8.2	2	50	
G200	14.4	6.5	2-1/2	63	
G400	40	18.2	2	50	
G400	32	14.5	2-1/2	63	
G400	25	11.4	3-1/4	83	

Please note that the loads are max loads for clutches. Max loads will not produce comfortable pull forces.

SL15 & SL20 SPRING ASSIST BOOSTER

FEATURES & BENEFITS

- Chain Boosters compatible with SL15/SL20 clutches.
- Decreases shade lifting effort by 40%.
- Control larger or linked shades with minimal effort.
- Retrofit a shade on-site to achieve a lighter lifting solution.
- Standard and Heavy Duty versions available.
- Right hand and left hand versions available.

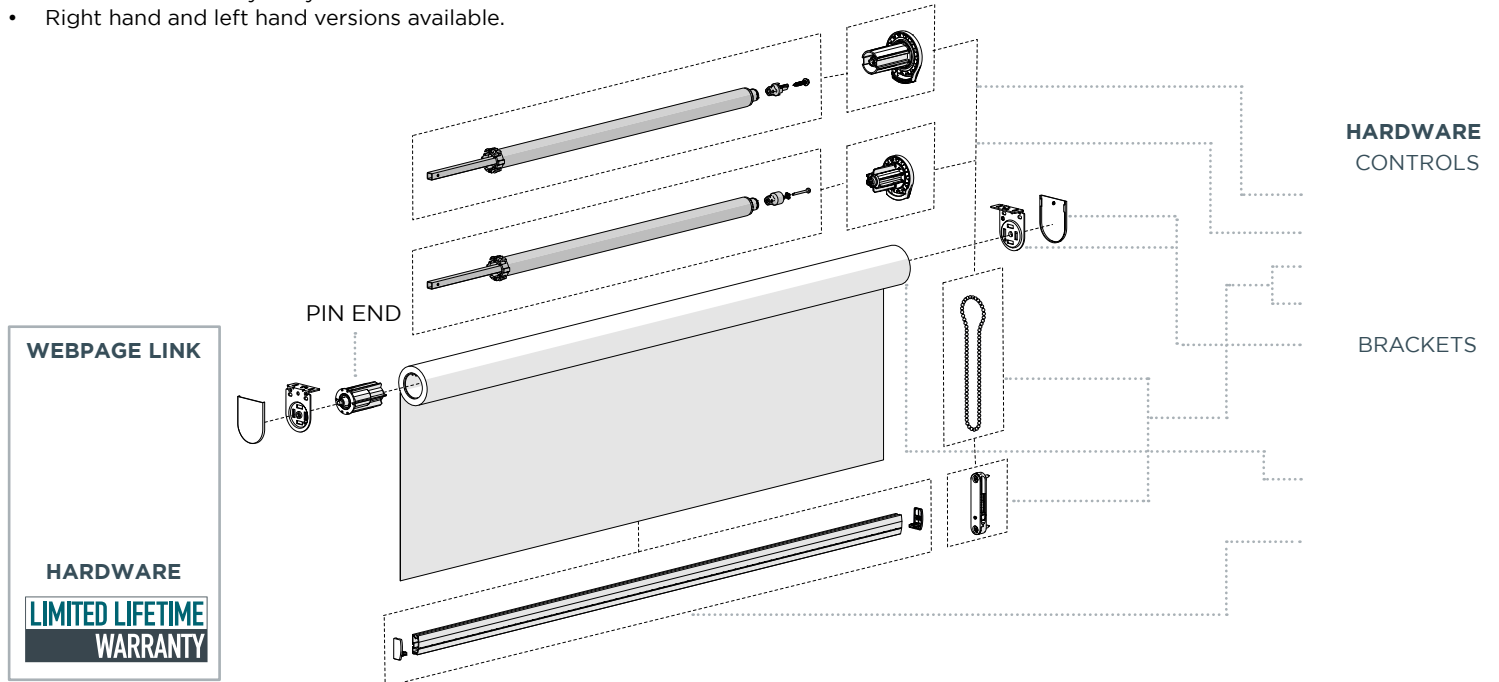

KEY SYSTEM FEATURES

SPRING ASSIST BOOSTER

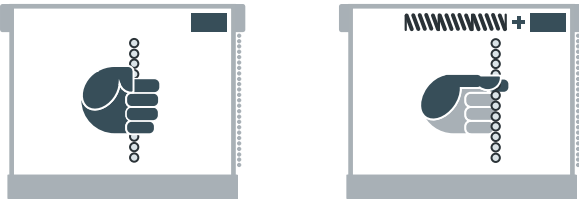

Reduces user effort by 40%.

LARGER SHADES POSSIBLE



Compatible with 1.5" tube and adapters available for use in 2" tube.

SL15 & SL20 BOOSTER ASSEMBLY

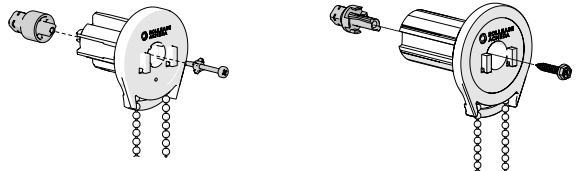

For SL15, align and insert the connector in the clutch and secure it with the screw and washer provided.

For SL20, align and insert the connector in the clutch and secure it with the screw provided.

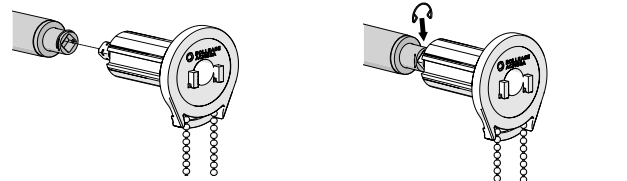

Align and insert the clutch into the booster.

Secure the clutch with seeger clip provided.

Note: Make sure the connector is fully inserted and tightened securely when attaching the screw and washer with a drill or screwdriver.

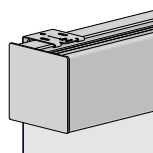

WIRE GUIDE

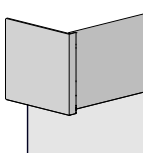

EASY-LINK



MOUNTING RAIL

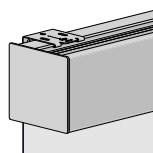

CASSETTE

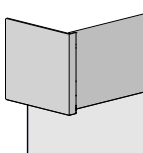

FASCIA

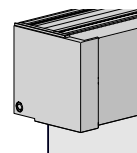

P95 PELMET



CF90



POCKET

PRODUCT SPECIFICATIONS

CONTROL CAPACITY | 1-1/2"

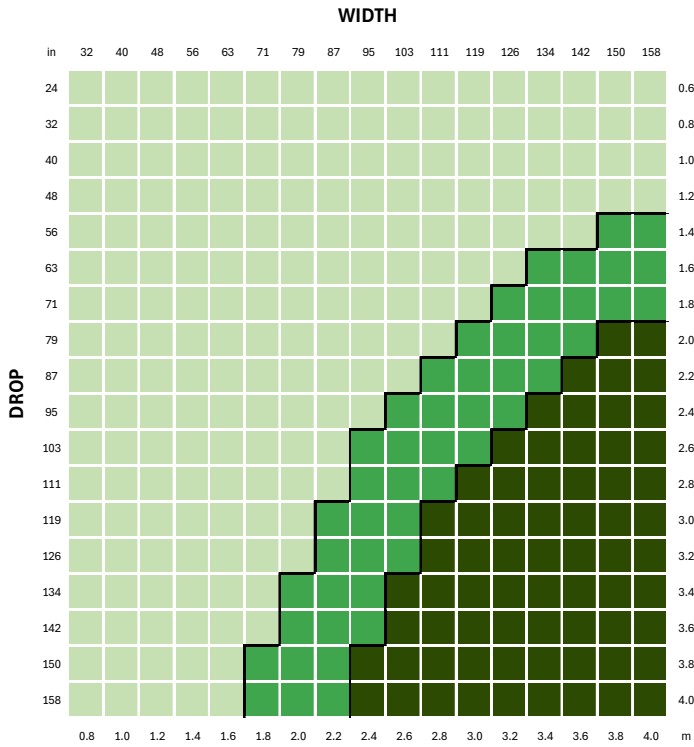

CONTROL CAPACITY | 2"

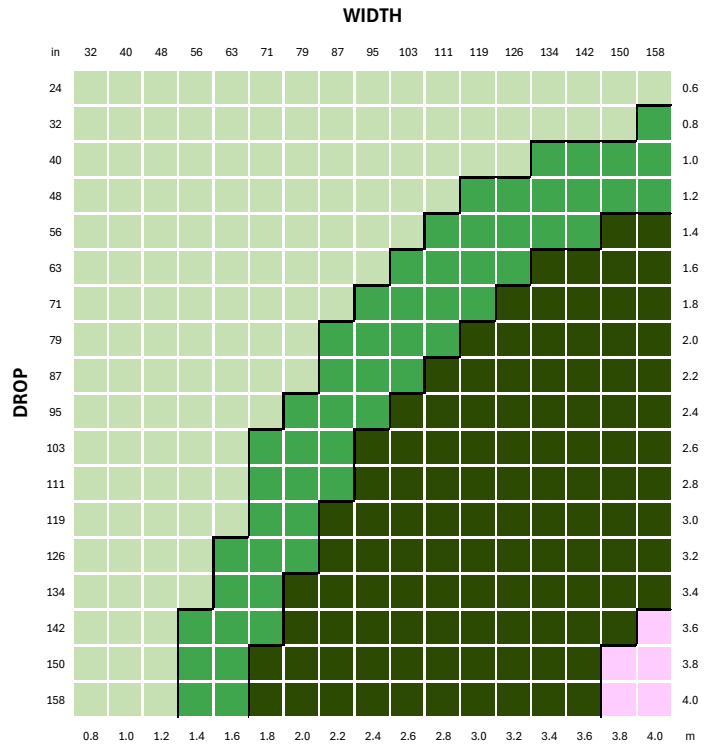

BOOSTER TYPE

SL15
SL20
SL15 or SL20 + Booster

PARAMETERS:

FABRIC DENSITY: 390gsm
 FABRIC THICKNESS: 0.6mm
 WEIGHT BAR: D30 Bottom Rail

BOOSTER TYPE

SL15
SL20
SL15 or SL20 + Booster
SL20 + Booster

PARAMETERS:

FABRIC DENSITY: 390gsm
 FABRIC THICKNESS: 0.6mm
 WEIGHT BAR: D30 Bottom Rail

TECHNICAL DATA

CONTROL OPTIONS	MINIMUM SHADE WIDTH (no covers)		TUBE DEDUCTIONS			
			NO BRACKET COVERS		WITH BRACKET COVERS	
	inch	mm	inch	mm	inch	mm
SL15	4.9	125	1.1	29	1.2	31
SL20	5.2	133	1.2	31	1.3	33
SL15 + STD SPRING ASSIST	31.8	809	1.1	29	1.2	31
SL15 + HD SPRING ASSIST	38.2	971	1.1	29	1.2	31
SL20 + STD SPRING ASSIST	32	813	1.2	31	1.3	33
SL20 + HD SPRING ASSIST	38.4	975	1.2	31	1.3	33

Minimum Shade Width based on 0.8" / 20mm gap between hardware in tube.

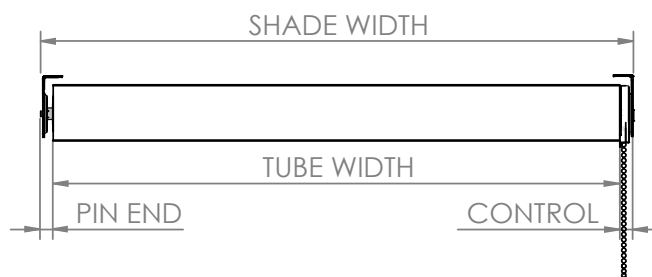

MOTORS | ARC PRO LI-ION

FEATURES & BENEFITS

- Lithium Ion Battery Powered Motors
- Multiple reachable power options: Power Supply with USB C cord, Solar Panel
- Patent ZERO motor head conceals all wires by wrapping them around the head.
- Retro-fit solution, turn manual blinds into motorized shades with ease, simply remove clutch, insert motor & operate.
- Soft Stop technology which slows the blind prior to stopping.
- Color matching motor head cap conceals hardware.

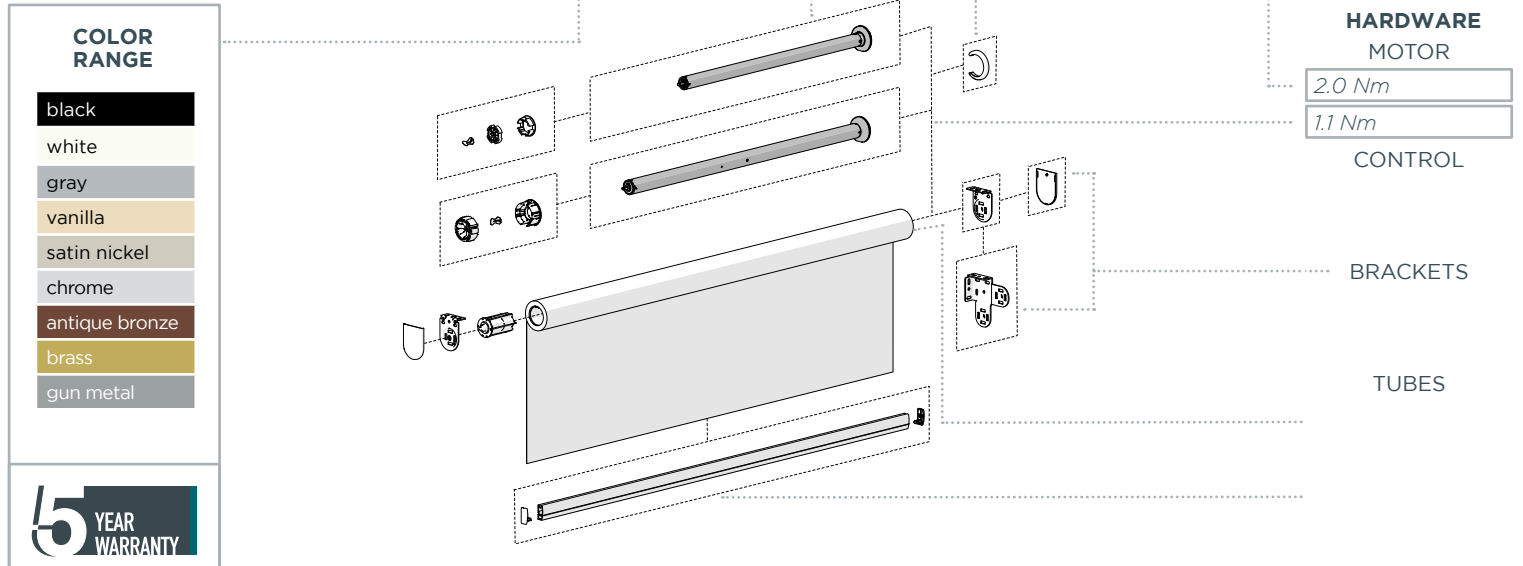

KEY SYSTEM FEATURES

ZERO VISIBLE WIRES

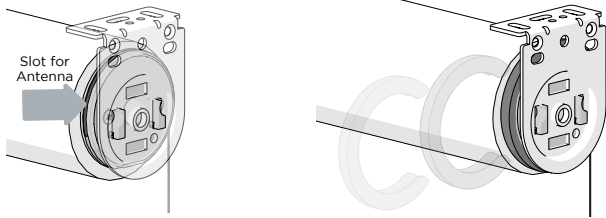

The motor head has a slot which retains the antenna.

Hide the motor head with a color matched Motor Cap.

RETRO-FIT SOLUTION

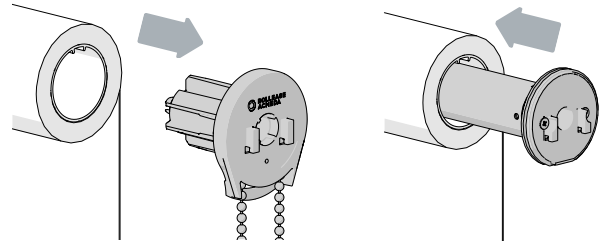

Replace a chain control with a ZERO Li-ion motor without having to change any existing hardware.

BATTERY CHECK FUNCTION

Shade must be at Upper Limit.

Hold UP



Motor Response
Approx. 5s

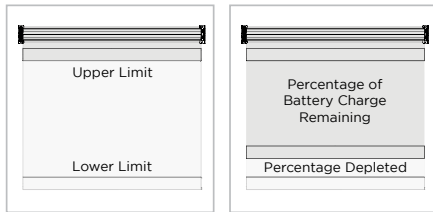

Shade must be at Upper Limit
Hold UP for Approx. 5s

Shade moves to percentage
of battery charge remaining

Send Shade to battery charge level

CHARGING OPTIONS



Wall Charger Plug

Type C Cord

USB Cable

Solar Panel

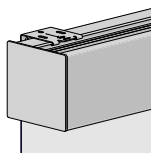

WIRE GUIDE

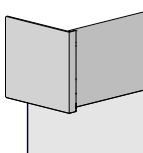

EASY-LINK



MOUNTING RAIL

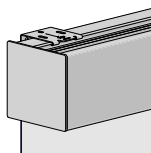

CASSETTE

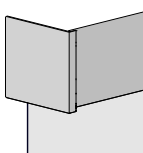

FASCIA

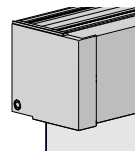

P95 PELMET

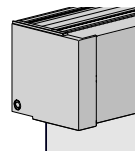

CF90



POCKET

MOTORS | CONTROLLERS

HOME AUTOMATION FEATURES

AUTOMATE SHADES APP

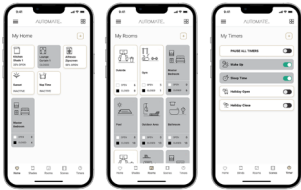

VOICE CONTROL

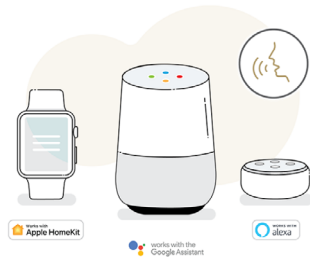

Effortless control of motorized shades when at home or away. Personalize the daily routine via groups, rooms and timers.

SUNSET/SUNRISE TIMERS

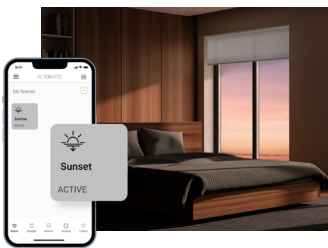

Set shades to follow the sun.

LINQ TOOL



Connect to smart home systems.

HOME AUTOMATION | PULSE PRO

- Group Automate shades by room and conveniently control them accordingly.
- Personalize shade control and organize how your shades operate by specific daily events or scenes automatically at the optimal time.
- Roller shades, Drapery, Outdoor Shades, Awnings... control every shade type from one screen.
- Installers have access to information that assists them identify potential issues.
- The signal indicator highlights when there is no connection between the motor and the hub, to assist with troubleshooting.
- The APP is available in English, Italian, Dutch, French or German.



REMOTE CONTROLS

PUSH SERIES



Push ONE, 5 Channel, 15 Channel & Push PRO Remotes available in black & white

WALL CONTROLS



1, 2 & 15 Channel Controls

ACCESSORIES | COMMERCIAL

DC POWER DISTRIBUTION PANEL



- Power your Automate DCRF motors from a compact, central location that can service up to 18 motors.
- Easily check each individual motors power status by viewing the prominent green LED's on the DC Power Panel.
- The panel can be used with many different wire types (from 26 to 14 AWG). Any pre-wired installation may readily use DCRF motors and the Power Distribution Panel.

ACCESSORIES | GENERAL

ARC REPEATER



Extend range of ARC Protocols.

INTERNAL SUN SENSOR



Control shades with a choice of preset light thresholds and control modes.

ARC RELAY TRANSMITTER



- Provide interface between third party smart home systems and ARC motors.
- Three contact inputs - Up, Down & Stop.
- Group Motor Control.
- Wireless control of ARC motors.
- Roller mode and Step mode for venetian motors.
- 12V or 24V power source compatible.

MOTORS | ARC PRO SPECIFICATIONS

TUBE CAPACITY

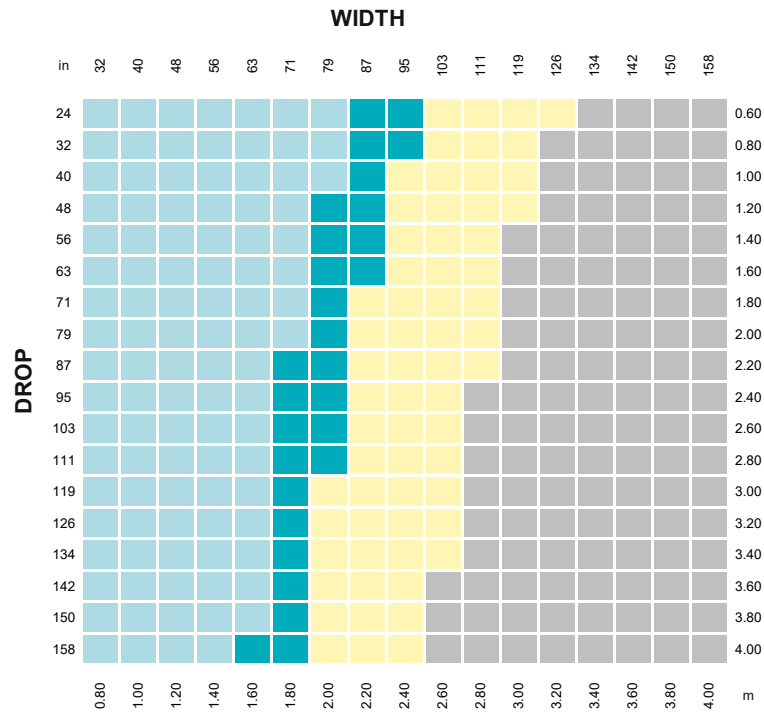

TUBES

1.25"	
1.5"	
2"	
Outside Specification	

PARAMETERS:

FABRIC DENSITY: 0.390gsm
 FABRIC THICKNESS: 0.6mm
 WEIGHT BAR: D30 Bottom Rail
 TUBE DEFLECTION: 1.05mm/m

CONTROL CAPACITY

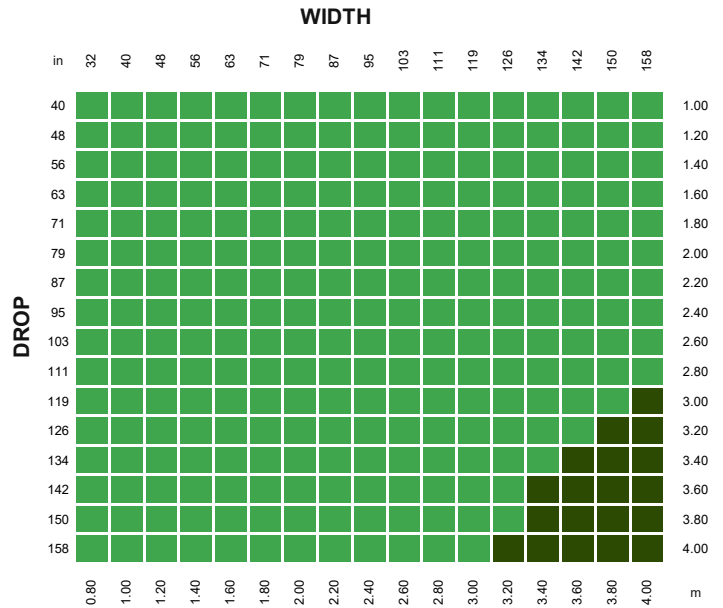

MOTOR

1.1Nm* + 2Nm**	
2Nm**	

PARAMETERS:

FABRIC DENSITY: 0.390gsm
 FABRIC THICKNESS: 0.6mm
 WEIGHT BAR: D30 Bottom Rail
 *Use with 1.5" Tube Only
 ** Use with 1.5" or 2" Tube

PRODUCT SPECIFICATIONS

TECHNICAL DATA

SINGLE BRACKETS	MOTORS	MINIMUM SHADE WIDTH (no covers)				TUBE DEDUCTIONS (no bracket covers)				TUBE DEDUCTIONS (with bracket covers) *			
		STD PIN END		HD PIN END		STD PIN END		HD PIN END		STD PIN END		HD PIN END	
		inch	mm	inch	mm	inch	mm	inch	mm	inch	mm	inch	mm
LX	0.7 Nm	23.7	603	25.4	646	0.6	15	0.6	15	0.6	16	0.6	16
	1.1 Nm	21.8	555	23.6	598	1.1	27	1.1	29	1.2	29	1.2	31
	2.0 Nm	27.7	703	29.4	747	0.6	15	0.6	15	0.6	16	0.6	16
SKYLINE	0.7 Nm	23.7	602	25.4	645	0.6	15	0.6	15	0.6	16	0.6	16
	1.1 Nm	21.8	554	23.5	598	1.1	27	1.1	28	1.2	30	1.2	31
	2.0 Nm	27.7	703	29.4	746	0.6	15	0.6	15	0.7	17	0.7	17
RIBBED	0.7 Nm	23.7	602	25.4	645	0.6	15	0.6	15	0.6	16	0.6	16
	1.1 Nm	21.8	554	23.5	598	1.1	27	1.1	28	1.2	30	1.2	31
	2.0 Nm	27.7	703	29.4	746	0.6	15	0.6	15	0.7	17	0.7	17
NARROW	0.7 Nm	23.7	602	25.4	646	0.6	15	0.6	15	0.6	16	0.6	16
	1.1 Nm	21.8	554	23.5	598	1.1	27	1.1	28	1.2	30	1.2	31
	2.0 Nm	27.7	703	29.4	746	0.6	15	0.6	15	0.7	17	0.7	17
OPULENCE	0.7 Nm	23.8	605	25.5	648	0.6	16	0.6	16	N/A		N/A	
	1.1 Nm	21.9	557	23.7	601	1.2	30	1.2	31	N/A		N/A	
	2.0 Nm	27.8	706	29.5	749	0.7	17	0.7	17	N/A		N/A	

DOUBLE BRACKETS													
DOUBLE VERTICAL	0.7 Nm	23.8	603	25.5	647	0.6	15	0.6	15	N/A		N/A	
	1.1 Nm	21.9	556	23.6	599	1.1	28	1.2	30	N/A		N/A	
	2.0 Nm	27.7	704	29.4	747	0.6	16	0.6	16	N/A		N/A	
DOUBLE V SLIM	0.7 Nm	23.7	603	25.5	647	0.6	15	0.6	15	0.7	18	0.7	18
	1.1 Nm	21.9	555	23.6	599	1.1	28	1.2	29	1.3	33	1.3	34
	2.0 Nm	27.7	704	29.4	747	0.6	16	0.6	16	0.7	18	0.7	18
DOUBLE HORIZONTAL	0.7 Nm	23.8	603	25.5	647	0.6	15	0.6	15	N/A		N/A	
	1.1 Nm	21.9	556	23.6	599	1.1	28	1.2	30	N/A		N/A	
	2.0 Nm	27.7	704	29.4	747	0.6	16	0.6	16	N/A		N/A	
UNIVERSAL DOUBLE (38/48mm pitch)	0.7 Nm	23.7	602	25.4	646	0.6	15	0.6	15	0.7	17	0.7	17
	1.1 Nm	21.8	555	23.5	598	1.1	27	1.1	29	1.2	31	1.3	33
	2.0 Nm	27.7	703	29.4	746	0.6	15	0.6	15	0.7	17	0.7	17

Note: All values in the table apply to the 1.5" tube only.

**Add +1mm to deductions for Motor Cover installations.*

Minimum Shade Width based on 5mm gap between hardware in tube.

ALUMINUM TUBES

TUBE CAPACITY

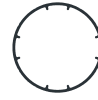

TUBE		1"	1-1/8"	1-1/4"	1-1/2"	2"	2-1/2"	3-1/4"
OD		1.1" 27mm	1.2" 30mm	1.3" 33mm	1.5" 39mm	2" 51mm	2.6" 65mm	3.3" 83mm
D/S TAPE		✓	✓	✓	✓	✓	✓	✓
NO TAPE				✓	✓	✓	✓	
CLUTCH	SL10	✓	✓	✓	✓			
	SL15				✓			
	SL20/ G200				✓	✓		
	SL30/ G400				✓		✓	✓
MOTOR	0.7, 1.1Nm			✓	✓			
	2.0Nm				✓	✓		
	3.0, 6.0, 10.0, 15.0Nm				✓	✓	✓	✓
SPRING	ESP				✓			
	ESU/ESW				✓			
	ESA				✓	✓		

BRACKETS | SINGLE

FEATURES & BENEFITS

- Available in multiple styles.
- Specialized brackets optimized & designed for specific systems.
- Opulence - color matched covers to hide screws.



MOUNTING SOLUTIONS



OPTIONS

OPULENCE™

STANDARD / LX

COVERS

COLOR RANGE

- black
- white
- zinc/gray
- vanilla

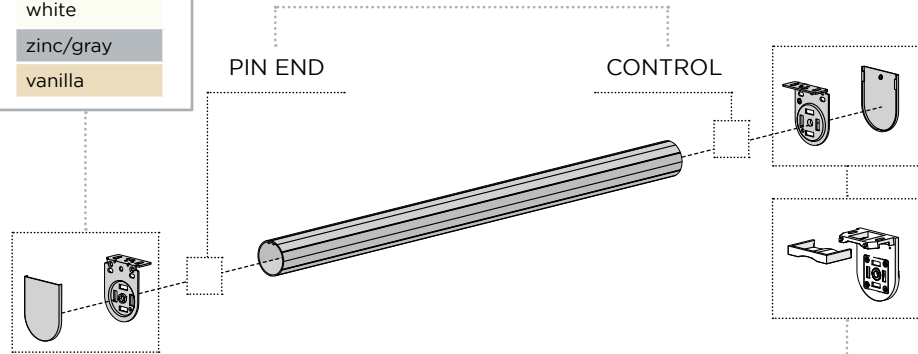

LX SKYLINE BRACKET
Easy installation

OPULENCE™ SERIES BRACKETS
Bearings for reduced shade noise
Magnetic screw covers

COLOR RANGE

- black
- white
- satin nickel
- antique bronze

TECHNICAL DATA

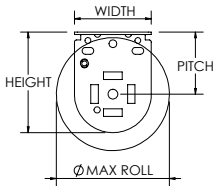

			PITCH		MAX ROLL		BRACKET WIDTH		BRACKET HEIGHT	
			inch	mm	inch	mm	inch	mm	inch	mm
LX		Modern design used for open roll and cassettes	1.6	40	3	77	2	50	2.6	65
			2.2	55	4.1	105			3.2	80
SKYLINE		Standard Skyline brackets with a ribbed option for larger shades, and a narrow option for narrow windows	1.6	41	3	76	2.2	56	2.4	60
RIBBED			2.1	53	4	102			2.9	74
			2.9	74	5	127			3.6	91
NARROW		1.3	32	2.3	59	1.5	38	2	51	
		1.6	41	3	76			2.4	60	
		2.1	54	4	102			2.9	73	
			2.9	73	5	127	2.2	56	3.6	92
OPULENCE™		Premium open roll brackets available in square and round with magnetic screw covers	1.8	45	3	76	2.3	58	2.9	74

BRACKETS | DOUBLE

FEATURES & BENEFITS

- Combine sheer fabric and block-out fabric in one installation.
- Ultimate privacy while still allowing light into any given room.
- Universal bracket to simplify installation.
- Available in multiple configurations for every application.



MOUNTING SOLUTIONS

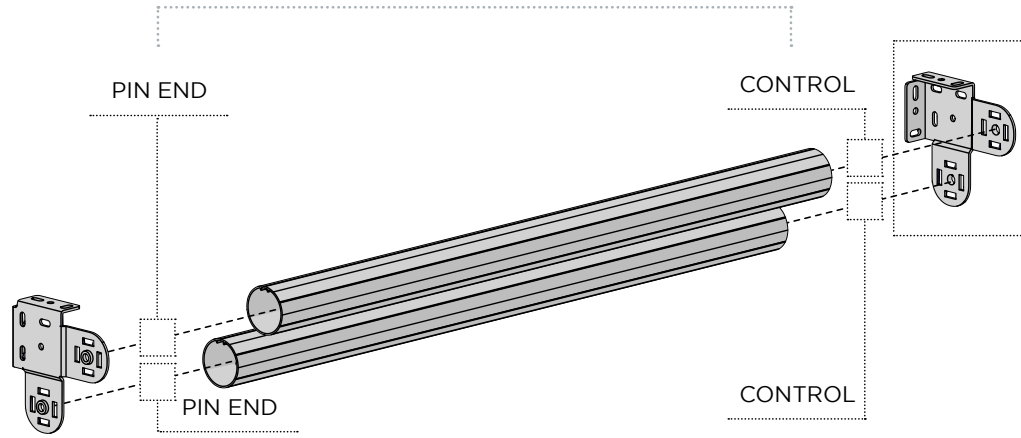
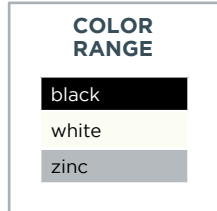

TECHNICAL DATA

			MAX ROLL		BRACKET WIDTH		BRACKET HEIGHT	
			inch	mm	inch	mm	inch	mm
DOUBLE VERTICAL		Slim profile bracket with top shade installed on a 45° angle for improved operation	3	76	2	51	5.7	144
DOUBLE V SLIM		Slim profile bracket that allows top front shade to be standard or reverse roll	2.6	67	3	77	5.1	128
DOUBLE HORIZONTAL		Double brackets used for windows with wide depths	3	76	7	177	3.5	90
UNIVERSAL DOUBLE		Square Profile brackets with 38mm and 48mm pitch options	2.4	60	4	102	4	102
			2.7	68	4.8	122	4.8	122

HEM BARS

FEATURES & BENEFITS

- Variety of sizes to suit all shade solutions.
- Multiple add-ons available to customize installation.
- Ends caps suitable to specific upgrades.
- Feed funnels available to assist in assembly.



COLORS
REFER TO
CATALOG

OPTIONS

- BUBBLE SEAL
- FABRIC BRUSH
- BALLAST
- FABRIC WRAP

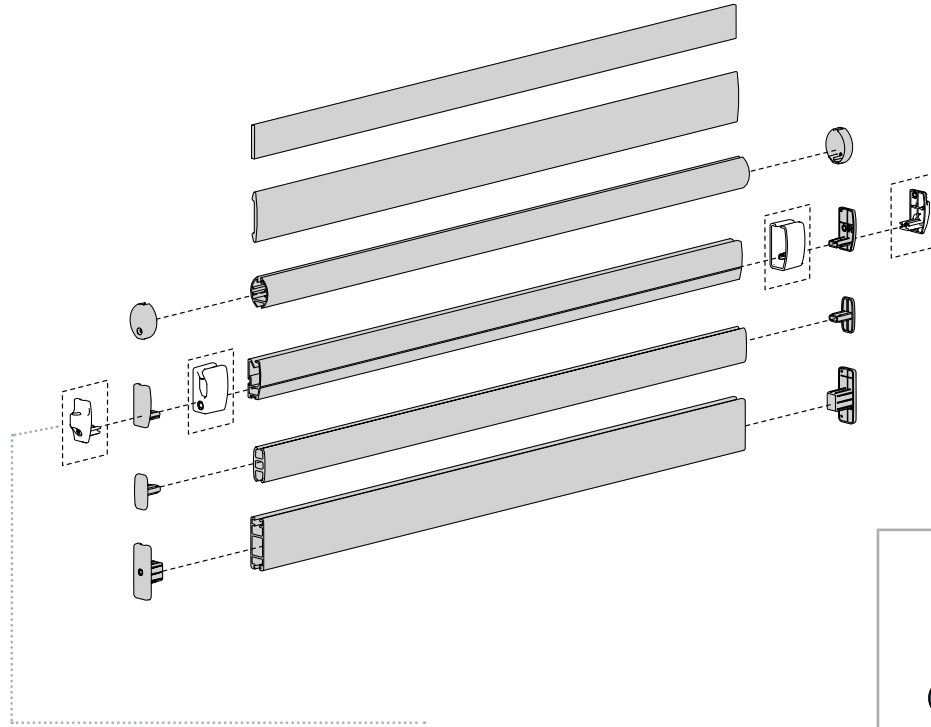

HEM BARS

SLAT
INTERNAL
EXTERNAL

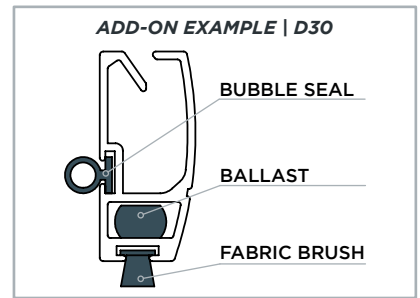

WIRE GUIDE

TECHNICAL DATA

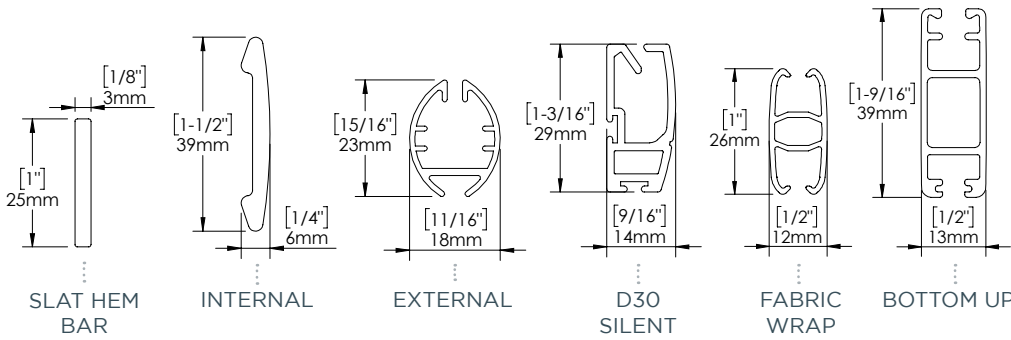

WEIGHT BAR COMPATIBILITY

		lbs/ft	kg/m	ROUND SPLINE 3mm	ROUND SPLINE 5mm	FLAT SPLINE 9mm	FLAT SPLINE 15mm	FABRIC FEEDING FUNNELS	BALLAST	FABRIC BRUSH	BUBBLE SEAL	EDGE SIDE CHANNEL	WIRE GUIDE END CAPS	HEM BAR HANDLES
SLAT	Minimal heat-sealed pocket solution.	0.15	0.2									✓		
INTERNAL	Heat-sealed pocket solution.	2.28	3.4									✓		
EXTERNAL	Round aesthetic.	1.81	2.7				✓							
D30 SILENT	Premium solution. Fabric brush & bubble seal reduces noise and light gap.	2.21	3.3				✓	✓	✓	✓	✓	✓	✓	✓
FABRIC WRAP	Suitable for half wrap and full wrap solutions.	1.70	2.5	✓	✓	✓			✓			✓		✓
BOTTOM UP	Suitable for bottom up shading systems	3.32	4.9			✓			✓					