

CASSETTE ROLLERS

SECTION 1	CF CASSETTE / FASCIA SUITE	
	CF 75	102
	CF 90	104
	CF 75/90 dim-OUT	106
SECTION 2	z-LOCK	
	Box 100 z-LOCK	108
	Box 120 z-LOCK	112
SECTION 3	SKYLIGHTS	
	Box 100 & 120 Zipscreen Skylight	116

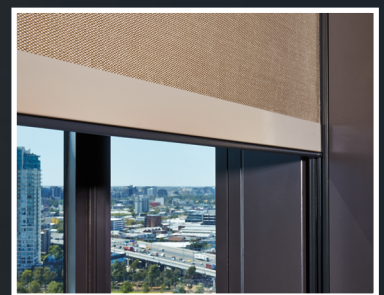

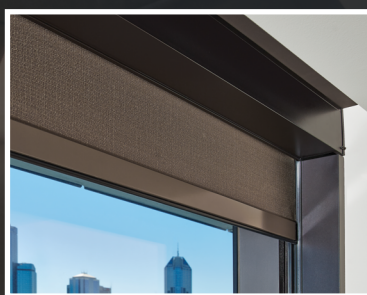
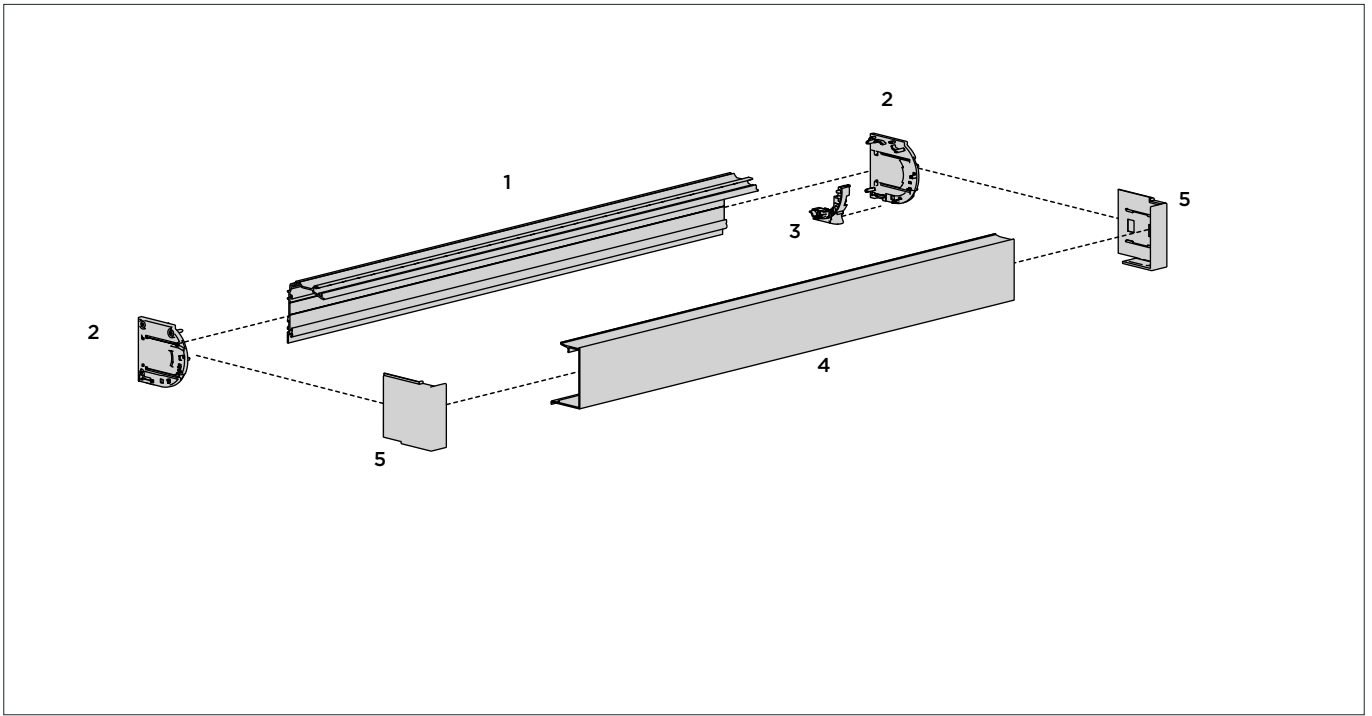

CONTROL OPTIONS

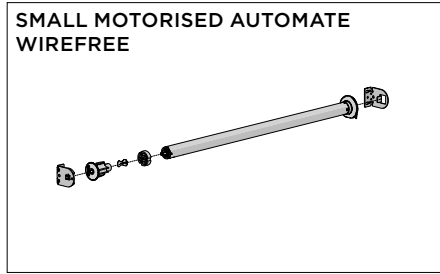
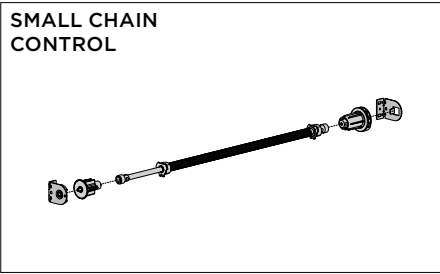

COLOUR RANGE



BRACKETS

- Easy-Lock LX Brackets - 30mm

PRODUCT OPTIONS

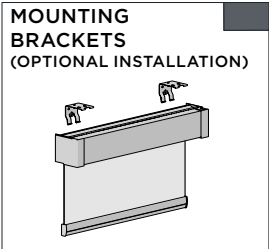

CASSETTE 75 BACK

4.8m length

1

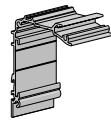

TYPE.	Mill 000	Colours - refer below
CODE.	RC01-0201-000480	RC01-0201-xxx480
PACK.	4 60 Lengths	4 60 Lengths

COLOUR. Black 050, Pure White 069
USE WITH. Cassette 75 Square Cover & End Plate Set

FABRIC BRUSH T SLOT FIT

7mm High x 4.8mm Wide | 350Lm Roll

7

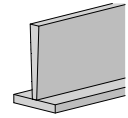

CODE.	AW91-1501-050000
PACK.	350 1400 Metres

COLOUR. Black 050
USE WITH. Cassette Back

CASSETTE 75 END PLATE SET

+ screws

2

CODE.	RC02-0101-338075
PACK.	10 200 Sets

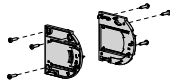

COLOUR. Silver Grey 338
USE WITH. Cassette 75 Square Back, Fascia 75 Bracket

CASSETTE 75 SQUARE CHAIN GUIDE SET

LH & RH

3

CODE.	RC02-0202-001075
PACK.	10 400 Sets

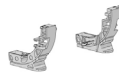

COLOUR. Clear 001
USE WITH. Cassette 75 Square Cover & End Plate Set

CASSETTE 75 SQUARE COVER

4.8m length

4

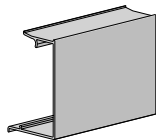

TYPE.	Mill	Colours - refer below
CODE.	RC01-0203-000480	RC01-0203-xxx480
PACK.	4 60 Lengths	4 60 Lengths

COLOUR. Black 050, Pure White 069
USE WITH. Cassette 75 Back, Fascia Bracket & End Plate Set

CASSETTE 75 SQUARE COVER SET

5

CODE.	RC02-0103-xxx075
PACK.	10 80 Sets

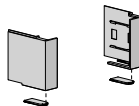

COLOUR. Black 050, Pure White 069
USE WITH. Cassette 75 Square Cover & End Plate Set

CF CASSETTE 75 MOUNTING BRACKET

6

CODE.	RC03-1003-025075
PACK.	50 500 Pcs

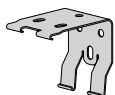

COLOUR. Silver Zinc Plated 25
USE WITH. Cassette Back

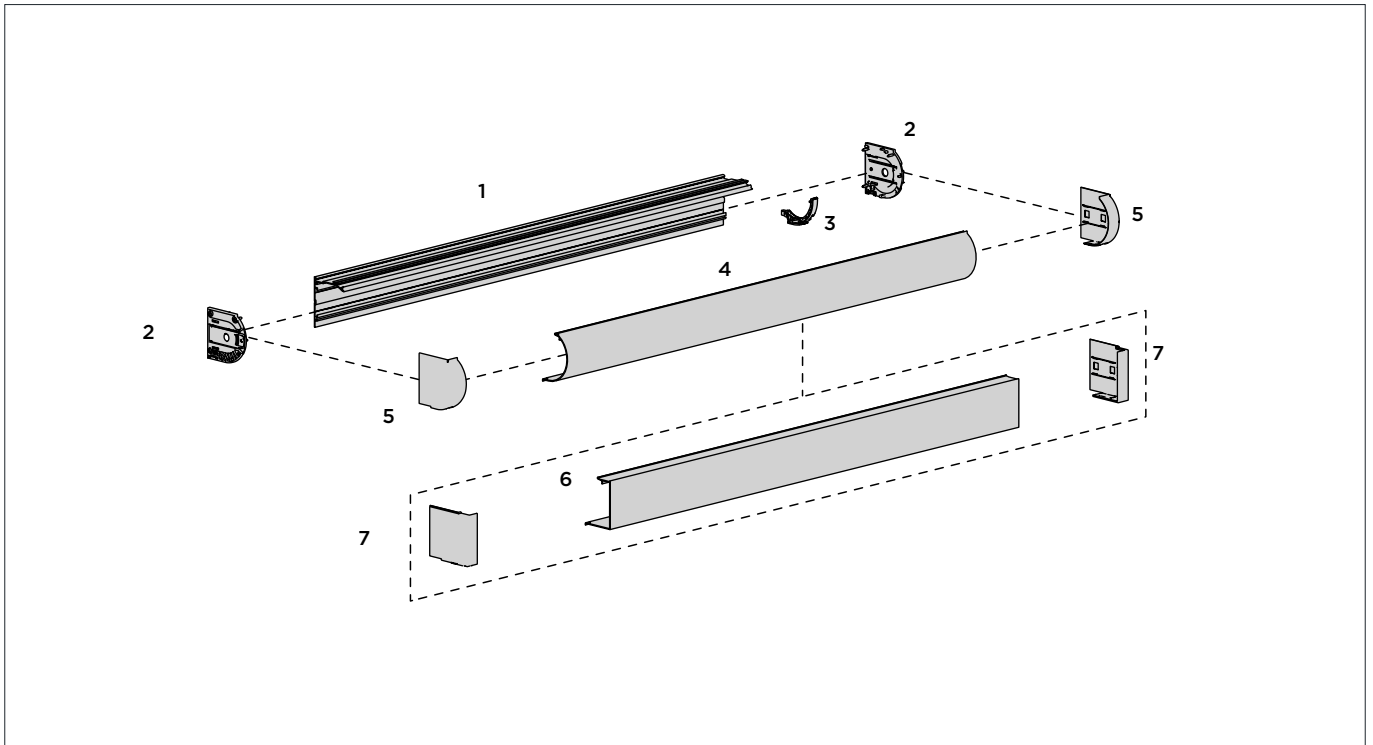

CONTROL OPTIONS

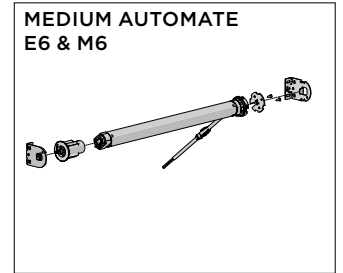
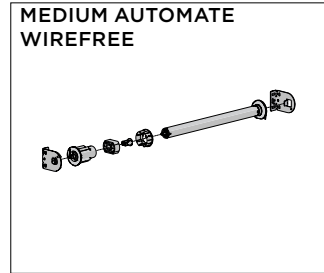
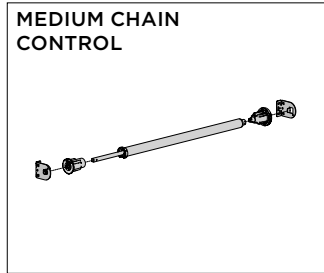
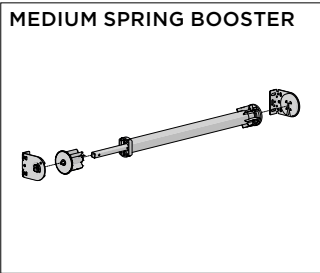

COLOUR RANGE

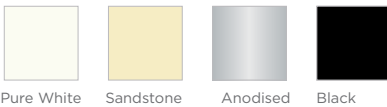

BRACKETS

- Easy-Lock VX/LX Brackets - 40mm

PRODUCT OPTIONS

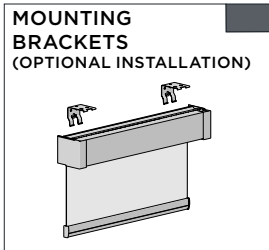

CASSETTE 90 BACK

4.8m length

1

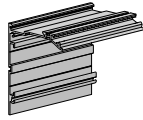

TYPE.	Mill 000	Nat. anodised 020	Colours - refer below
CODE.	RC01-0101-000480	RC01-0101-020480	RC01-0101-xxx480
PACK.	4 48 Lengths	4 48 Lengths	4 48 Lengths

COLOUR. Black 050, Pure White 069, Sandstone 269
USE WITH. Cassette Round Or Square Cover & End Plate Set

CASSETTE 90 SQUARE COVER

4.8m length

6

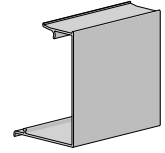

TYPE.	Mill 000	Nat. anodised 020	Colours - refer below
CODE.	RC01-0103-000480	RC01-0103-020480	RC01-0103-xxx480
PACK.	4 48 Lengths	4 48 Lengths	4 48 Lengths

COLOUR. Black 050, Pure White 069, Sandstone 269
USE WITH. Cassette 90 Back, End Plate Set, Fascia Bracket

CASSETTE 90 END PLATE SET + SCREWS

2

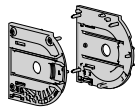

CODE.	RC02-0101-338090
PACK.	10 200 Sets

COLOUR. Silver Grey 338
USE WITH. Cassette 90 Back

CASSETTE 90 SQUARE COVER SET

7

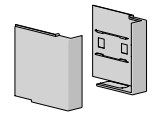

CODE.	RC02-0103-xxx090
PACK.	10 80 Sets

COLOUR. Black 050, Pure White 069, Sandstone 269, Silver Grey 338
USE WITH. Cassette 90 Square Cover, End Plate Set

CASSETTE 90 ROUND CHAIN GUIDE

LH & RH

3a



CODE.	RC02-0201-001090
PACK.	10 400 Sets

COLOUR. Clear 001
USE WITH. Cassette 90 Round Cover & End Plate Set

CF CASSETTE 90 MOUNTING BRACKET

8

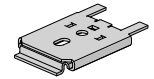

CODE.	RC03-1001-025090
PACK.	50 500 Pcs

COLOUR. Silver Zinc Plated 025
USE WITH. Cassette 90 Back

CASSETTE 90 SQUARE CHAIN GUIDE

LH & RH

3b



CODE.	RC02-0202-001090
PACK.	10 400 Sets

COLOUR. Clear 001
USE WITH. Cassette 90 Square Cover & End Plate Set

CF CASSETTE 90 FACE FIX MOUNTING BRACKET

9

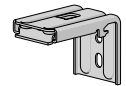

CODE.	RC03-1002-025090
PACK.	50 250 Pcs

COLOUR. Silver Zinc Plated 25
USE WITH. Cassette Back

CASSETTE 90 ROUND COVER

4.8m length

4

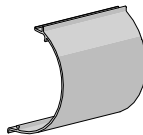

TYPE.	Mill 000	Nat. anodised 020	Colours - refer below
CODE.	RC01-0102-000480	RC01-0102-020480	RC01-0102-xxx480
PACK.	4 48 Lengths	4 48 Lengths	4 48 Lengths

COLOUR. Black 050, Pure White 069, Sandstone 269
USE WITH. Cassette 90 Back, Fascia Bracket

FABRIC BRUSH T SLOT FIT

7mm High x 4.8mm Wide | 350Lm Roll

10

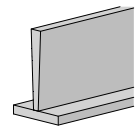

CODE.	AW91-1501-050000
PACK.	350 1400 Metres

COLOUR. Black 050
USE WITH. Cassette Back

CASSETTE 90 ROUND COVER SET

LH & RH

5

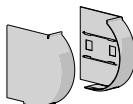

CODE.	RC02-0102-xxx090
PACK.	10 80 Sets

COLOUR. Black 050, Pure White 069, Sandstone 269, Silver Grey 338
USE WITH. Cassette 90 Round Cover, End Plate Set

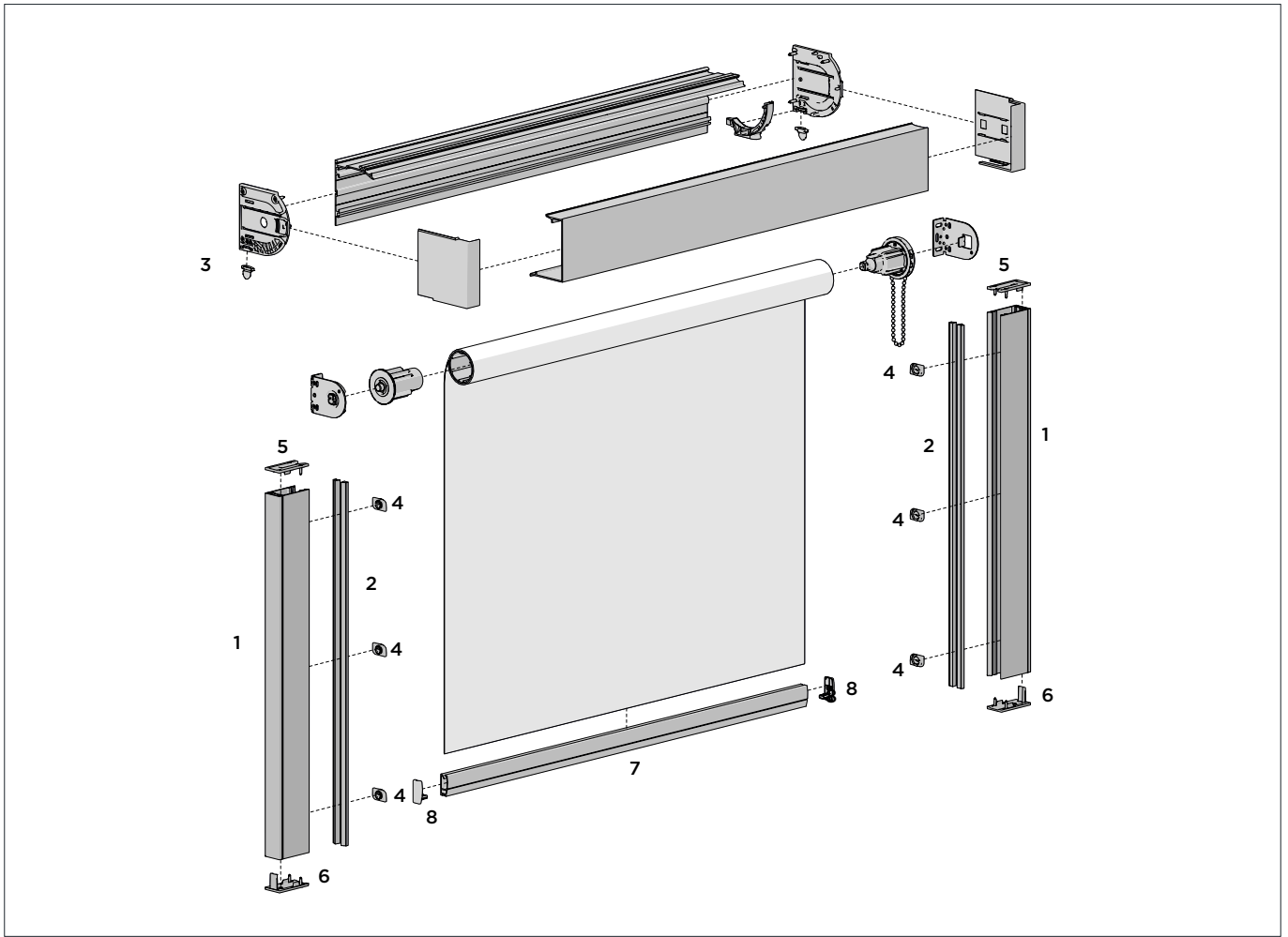

COLOUR RANGE

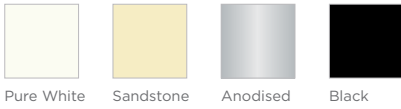

Pure White Sandstone Anodised Black

BOTTOM RAIL COMPATIBILITY

- D30 Bottom Rail (shown above)
- Flat Bottom Rail
- F4115 Heavy Duty Flat Bottom Rail
- Oval Bottom Rail

PRODUCT OPTIONS

EASY-LINK
[S40/45 ONLY]
(FOR WIDER SPANS)

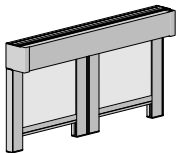

CASSETTE DIM-OUT | SIDE GUIDE

1

5.8m length

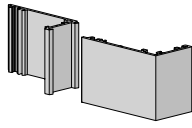

TYPE.	Mill 000	Nat. Anodised	Colours - refer below
CODE.	RC91-0101-000580	RC91-0101-020580	RC91-0101-xxx580
PACK.	4 80 Lengths	4 80 Lengths	4 80 Lengths

COLOUR. Black 050, Pure White 069, Sandstone 269
 USE WITH. Cassette 75/90, Side Guide Ear

FABRIC BRUSH T SLOT FIT

2

7mm High x 4.8mm Wide | 350Lm Roll

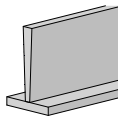

CODE.	AW91-1501-050000
PACK.	350 1400 Metre

COLOUR. Black 050
 USE WITH. Cassette dim-OUT Side Guide

CASSETTE DIM-OUT | SIDE GUIDE EAR

3



CODE.	RC91-0302-338000
PACK.	100 5000 Pcs

COLOUR. Silver Grey 338
 USE WITH. Cassette dim-OUT Side Guide, Cassette 75/90 End Plate

CASSETTE DIM-OUT | SIDE GUIDE LOCK

4



CODE.	RC91-0201-050000
PACK.	200 5000 Pcs

COLOUR. Black 050
 USE WITH. Cassette dim-OUT Side Guide

CASSETTE DIM-OUT | SIDE GUIDE FUNNEL & SCREW SET

5

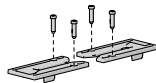

CODE.	RC91-1002-xxx000
PACK.	10 400 Sets

COLOUR. Black 050, Pure White 069, Sandstone 269, Silver Grey 338
 USE WITH. Cassette dim-OUT Side Guide

CASSETTE DIM-OUT | BOTTOM CAP + SCREWS

6

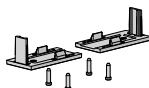

CODE.	RC91-1001-xxx000
PACK.	10 400 Sets

COLOUR. Black 050, Pure White 069, Sandstone 269, Silver Grey 338
 USE WITH. Cassette dim-OUT Side Guide

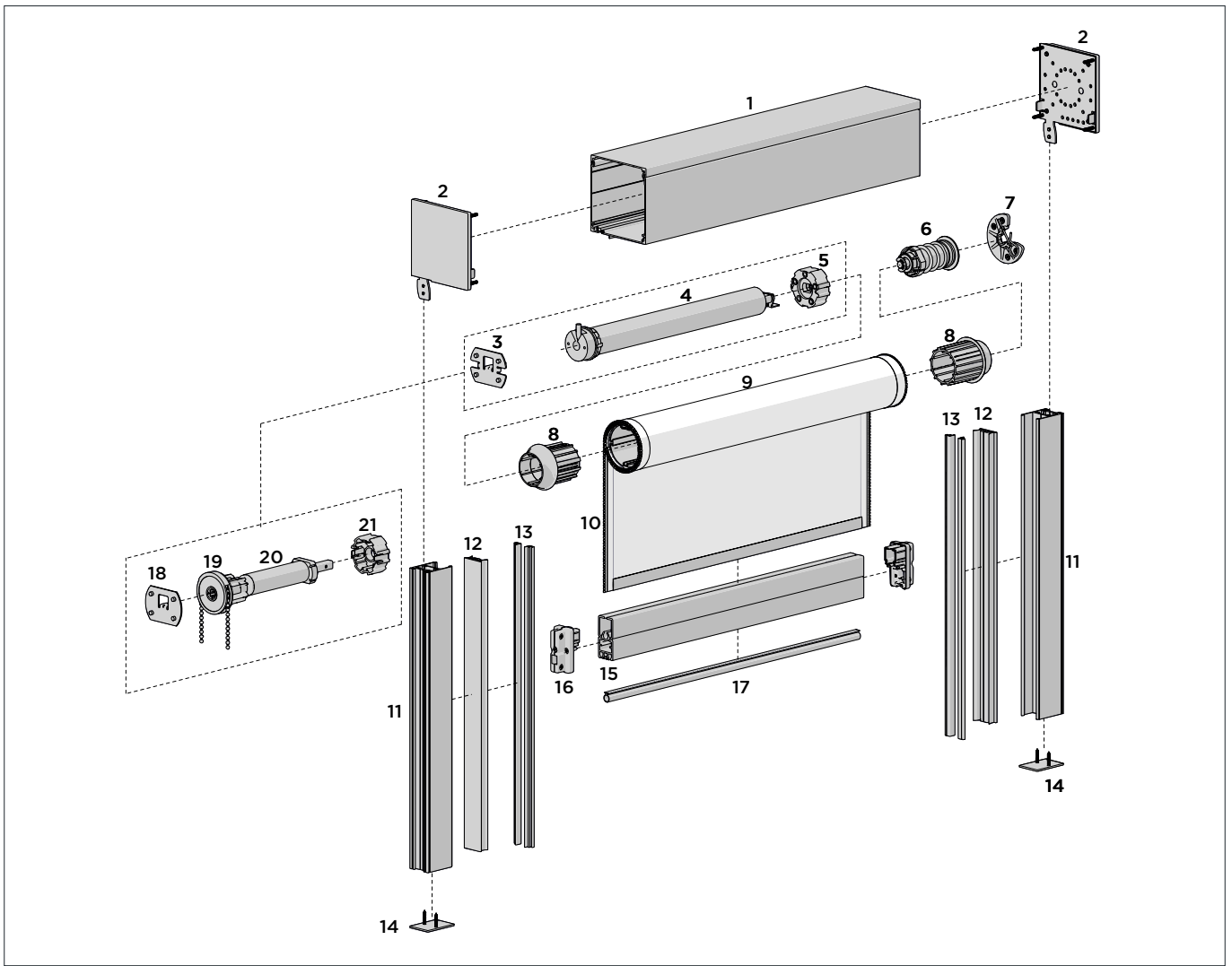

COLOUR RANGE



Mill

PRODUCT OPTIONS

FIXING PLATES
(FOR FACE & SIDE FIXING)

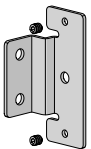

AUTOMATE HUB



AUTOMATE CONTROLS



BOX SQUARE 100 BACK

1a

TYPE.	SQUARE BOX 100
CODE.	SB01-1010-000580
PACK.	4 80 Lengths

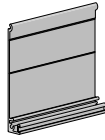

COLOUR. Mill 000
USE WITH. Box Square 100, End Plate Covers

AUTOMATE | M6

S45 ML Motor [Ø35/6Nm/28rpm]

4b

CODE.	MT01-1035-069003
PACK.	1 8 Pcs



COLOUR. Pure White 069
USE WITH. Motor Adaptor Plate, Reducer, Drive Wheel

BOX SQUARE 100 COVER

1b

TYPE.	SQUARE BOX 100
CODE.	SB01-1025-000580
PACK.	4 72 Lengths

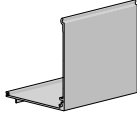

COLOUR. Mill 000
USE WITH. Box Square 100 Back & 100 Top, End Plate Set

DRIVE WHEEL 45MM MOTOR TO S60 TUBE

5

CODE.	RB56-0105-050502
PACK.	5 250 Pcs



COLOUR. Black 050
USE WITH. Automate E6 & M6 Motor

BOX SQUARE 100 TOP

1c

TYPE.	SQUARE BOX 100
CODE.	SB01-1030-000580
PACK.	4 80 Lengths

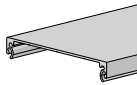

COLOUR. Mill 000
USE WITH. Box Square 100 Cover & 100 Back, End Plate Set

Z-LOCK EXTENDED BEARING IDLER | S45

10mm Round Spindle

6

CODE.	SB11-0812-050045
PACK.	5 50 Pcs

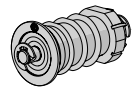

COLOUR. Black 050
USE WITH. Bearing Idler Adaptor, Zip Tube Reducer

FABRIC BRUSH T-SLOT FIT

5mm High x 4.8mm Wide

-

CODE.	SB91-0011-050500
PACK.	500 2000 Metres

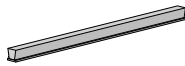

COLOUR. Black 050
USE WITH. Box Square 100 Back

Z-LOCK BEARING IDLER ADAPTOR

10mm Round Spindle

7

CODE.	SB11-0810-050045
PACK.	5 100 Sets

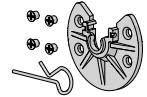

COLOUR. Black 050
USE WITH. Bearing Idler S45, End Plate Set

BOX UNIVERSAL END PLATE SET WITH EARS

+ screws

2a

TYPE.	Box 100
CODE.	SB02-1001-025020
PACK.	5 25 Sets

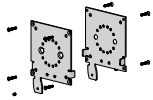

COLOUR. Zinc Plated 025
USE WITH. Box Square 100, End Plate Covers

ZIP TUBE REDUCER - MEDIUM

Reducing from 60mm to 45mm

8

CODE.	SB11-0813-050360
PACK.	4 40 Pcs

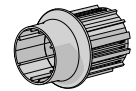

COLOUR. Black 050
USE WITH. S60 Tube, 35mm Motors, S45 Idler

BOX END PLATE COVER SET

LH & RH

2b

TYPE.	Box 100
CODE.	SB02-1020-xxx020
PACK.	5 200 Pairs

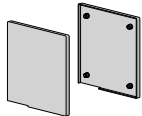

COLOUR. Black 050, Pure White 069, Silver Grey 338
USE WITH. End Plate Sets

ALUMINIUM TUBE - S60 | 60STD

O.D 60.0mm x 5.8mt Length

9

TYPE.	No Tape	with D/S Tape
CODE.	RB91-0260-000580	RB91-6260-000580
PACK.	4 36 Lengths	4 36 Lengths

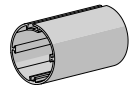

COLOUR. Mill 000
USE WITH. Zip Tube Reducer, Drive Wheel

M40 H/D MOTOR ADAPT PLATE + SCREWS - 12MM | S45

3

CODE.	SB11-0704-025400
PACK.	5 200 Sets

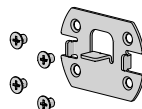

COLOUR. Silver Zinc Plated 025
USE WITH. E6 & M6 motors, End Plates

MULTI-PURPOSE DOUBLE SIDED TAPE

50Lm Roll

-

TYPE.	18mm
CODE.	HD31-0401-001018
PACK.	1 24 Rolls

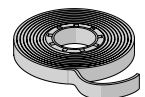

COLOUR. Natural Clear 001
USE WITH. Aluminium Tubes

AUTOMATE | E6

Ø35/6Nm/28rpm

4a

CODE.	MT01-1135-069001
PACK.	1 6 Pcs



COLOUR. Pure White 069
USE WITH. Easy-Lock Auto Idler, M40 Disc Adaptor, M40 Brkts, Aluminium Tube S45

9MM ACM FLAT SPLINE - NO TAPE

100Lm Roll

-

TYPE.	No Tape
CODE.	RB92-0901-001100
PACK.	1 10 Rolls



COLOUR. Natural 001
USE WITH. S60 Tube

9MM ACM FLAT SPLINE - WITH DOUBLE SIDED TAPE

Double Sided MP-HR TAPE | 75Lm Roll

TYPE.	One Side	Two Sides
CODE.	RB92-0902-001075	RB92-0903-001075
PACK.	1 10 Rolls	1 10 Rolls



COLOUR. Natural 001
USE WITH. S60 Tube

F56 | ZIPSCREEN - LOCK END CAP SET

CODE.	RE20-0303-xxx002
PACK.	10 200 Sets

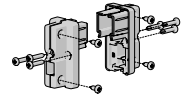

COLOUR. Black 050, Pure White 069
USE WITH. F56 Weight Bar

Z-LOCK ZIP NO. 4 GAUGE

1 Roll = 500Lm

CODE.	SH91-0106-050400
PACK.	500 2000 Metres



COLOUR. Black 050
USE WITH. Fabric, Inner Rails

WEIGHT BAR BUBBLE SEAL STRIP

8 x 12mm

CODE.	SB91-0001-050580
PACK.	10 30 Lengths

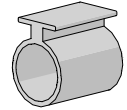

COLOUR. Black 050
USE WITH. F56 Weight Bar

7MM FABRIC SPLINE WITH 15MM TAIL

100m Roll

CODE.	SB91-0409-050015
PACK.	1 10 Rolls

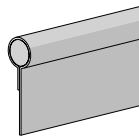

COLOUR. Black 050
USE WITH. F56 Weight Bar

EASY-LOCK CHAIN WINDER ADAPTOR + SCREWS

12mm Tongue

CODE.	SB11-0791-025012
PACK.	5 200 Sets

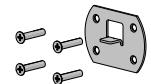

COLOUR. Zinc Plated 025
USE WITH. Easy-Lock Chain Winder S45, End Plate Set

Z-LOCK STANDARD SIDE GUIDE

33 x 48mm

CODE.	SB04-1501-000580
PACK.	4 60 Lengths

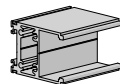

COLOUR. Mill 000
USE WITH. End Plates, Standard Side Guide Bottom Cap, F Rail Covers

RB09 EASY-LOCK CHAIN WINDER

CODE.	RB09-0145-069002
PACK.	25 200 Pcs

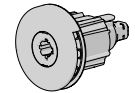

COLOUR. Pure White 069
USE WITH. Chain Winder Adaptor, Zip Tube Reducer, Retro-Fit Spring

Z-LOCK INNER RAIL WITH LEGS

5.8m Length

CODE.	AW08-0302-050580
PACK.	1 21 Lengths

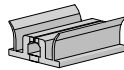

COLOUR. Black 050
USE WITH. Standard Side Guide Rail

EASY-LIFT RETROFIT AC SPRING ASSIST BOOSTER | S45

Standard

TYPE.	L/H [yellow tail]	R/H [white tail]
CODE.	RB04-4391-570001	RB04-4391-069002
PACK.	5 20 Pcs	5 20 Pcs



COLOUR. Pure White 069
USE WITH. S45 Chain Winder, S60 Tube, Spring Tail Adaptor

Z-LOCK SIDE GUIDE - F RAIL COVER

TYPE.	5.8m Length
CODE.	SB05-0341-xxx580
PACK.	10 80 Lengths

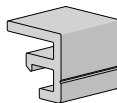

COLOUR. Black 050, White 069
USE WITH. Standard Side Guide Rail

EASY-LIFT RETROFIT AC SPRING ASST BOOSTER | S45

Heavy Duty

TYPE.	L/H [blue tail]	R/H [grey tail]
CODE.	RB04-4392-393001	RB04-4392-338002
PACK.	5 20 Pcs	5 20 Pcs



COLOUR. Pure White 069
USE WITH. S45 Chain Winder, S60 Tube, Spring Tail Adaptor

Z-LOCK STANDARD SIDE GUIDE STEEL BOTTOM CAP

CODE.	SB05-1501-025000
PACK.	10 200 Pcs

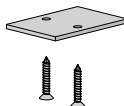

COLOUR. Zinc Plated 025
USE WITH. Standard Side Guide Rail

BOX SQUARE CHAIN GUIDE

+ screws

CODE.	SB11-0790-xxx000
PACK.	5 500 Sets

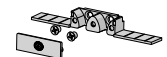

COLOUR. Black 050, Pure White 069, Silver Grey 338
USE WITH. Easy-Lock Chain Winder, End Plate Set

F56 HD WEIGHT BAR

TYPE.	4.2m Length	5.8m Length
CODE.	RE15-0101-000420	RE15-0101-000580
PACK.	2 48 Lengths	2 48 Lengths

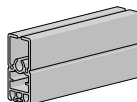

COLOUR. Mill 000
USE WITH. Fabric Spline, F56 End Caps

S45 SPRING TAIL ADAPTOR

For S60 Tube

CODE.	SB11-0105-050045
PACK.	5 500 Pcs

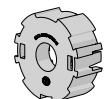

COLOUR. Black 050
USE WITH. S60 Tube, Easy-Lift Retrofit Spring S45

Z-LOCK SIDE GUIDE FACE FIX PLATE

with Grub screws

22a

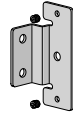

CODE.	SB05-1320-025000
PACK.	10 200 Sets

COLOUR. Zinc Plated 025
USE WITH. Standard Side Guide Rail

Z-LOCK SIDE GUIDE SIDE FIX PLATE

with Grub screws

22b

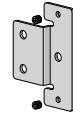

CODE.	SB05-1321-025000
PACK.	10 200 Sets

COLOUR. Zinc Plated 025
USE WITH. Standard Side Guide Rail

AUTOMATE REMOTES

One, Five, Fifteen & Thirty Channels



SIZE.	Push ONE	Push 5
CODE.	MT02-0101-xxx010	MT02-0101-xxx004
PACK.	1 20 Pcs	1 20 Pcs

SIZE.	Push 15	Push PRO
CODE.	MT02-0101-xxx008	MT02-0101-xxx013
PACK.	1 20 Pcs	1 25 Pcs

COLOUR. White 067, Black 050
USE WITH. Automate Motors

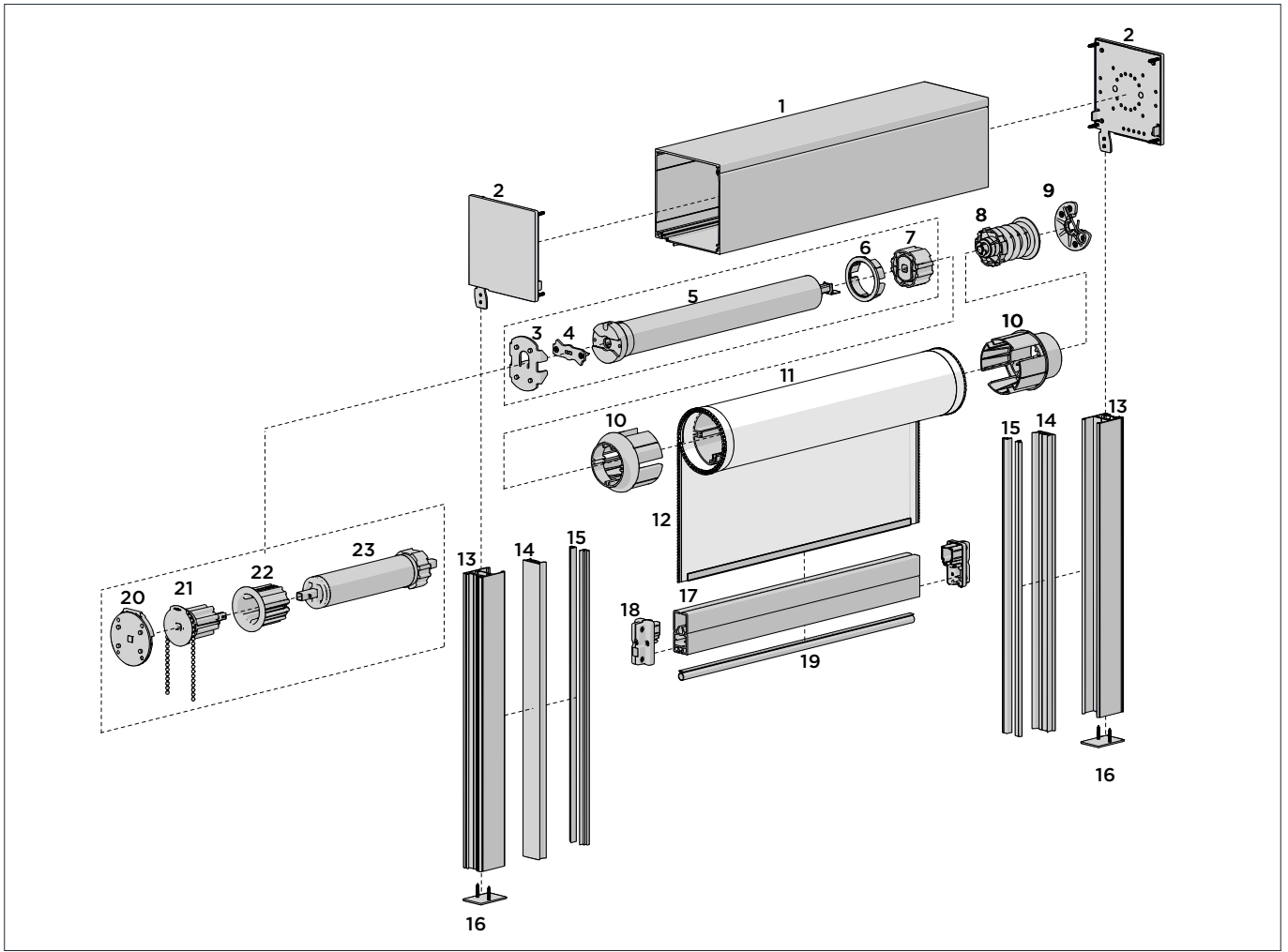

COLOUR RANGE



Mill Finish

PRODUCT OPTIONS

FIXING PLATES
(FOR FACE & SIDE FIXING)

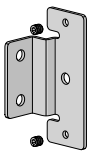

AUTOMATE
CONTROLS



AUTOMATE HUB



BOX SQUARE 120 BACK
120 x 120mm

1a

CODE.	SB01-1340-000580
PACK.	2 16 Lengths

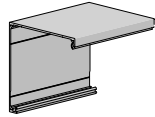

COLOUR. Mill 000
USE WITH. Box Square 120 Cover, End Plate Set

AUTOMATE CROWN WHEEL S60

6

TYPE	S60 STD
CODE.	RB56-0136-050508
PACK.	5 250 Pcs



COLOUR. Black 050
USE WITH. FT Motor, Zip Tube Reducer

BOX SQUARE 120 COVER - V2
120 x 120mm

1b

CODE.	SB01-1326-000580
PACK.	4 48 Lengths

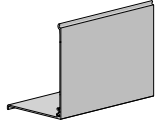

COLOUR. Mill 000
USE WITH. Box Square 120 Back, Box Square 120 Top, End Plate Set

AUTOMATE DRIVE WHEEL | S60

7

CODE.	RB56-0105-050502
PACK.	5 250 Pcs

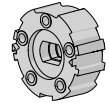

COLOUR. Black 050
USE WITH. S60 Tube, Automate FT Motor

FABRIC BRUSH T-SLOT FIT
5mm High x 4.8mm Wide

-

CODE.	SB91-0011-050500
PACK.	500 2000 Metres

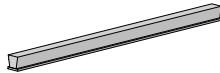

COLOUR. Black 050
USE WITH. Box Square 120 Back

Z-LOCK EXTENDED BEARING IDLER | S60
10mm Round Spindle

8

CODE.	SB11-0812-050060
PACK.	5 50 Pcs

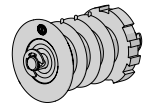

COLOUR. Black 050
USE WITH. Bearing Idler Adaptor, Zip Tube Reducer

BOX 120 UNIVERSAL END PLATE SET WITHOUT EARS
+ screws

2a

CODE.	SB02-1201-025020
PACK.	5 40 Sets

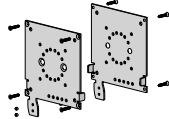

COLOUR. Zinc Plated 025
USE WITH. Box Square 120, End Plate Covers

Z-LOCK BEARING IDLER ADAPTOR
10mm Round Spindle + screws

9

CODE.	SB11-0810-050045
PACK.	5 100 Pcs

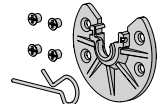

COLOUR. Black 050
USE WITH. Bearing Idler S60, End Plate Set

BOX 120 END PLATE COVER SET
LH & RH

2b

CODE.	SB02-1220-xxx020
PACK.	5 50 Pairs

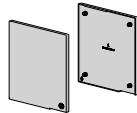

COLOUR. Black 050, Pure White 069, Anodised 020
USE WITH. Box Square 120, End Plate Set

ZIP TUBE REDUCER - MEDIUM
Reducing from 80mm to 60mm

10

CODE.	SB11-0815-050380
PACK.	4 100 Pcs

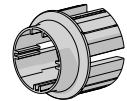

COLOUR. Black 050
USE WITH. S60 | 80HD Tube, M50 Crown Wheel, Bearing Idler, RB10 Tube Adaptor

AUTOMATE S60 MOTOR ADAPTOR SET

3

CODE.	RB56-0701-xxx508
PACK.	5 100 Pcs

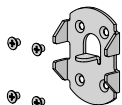

COLOUR. Black 050, Pure White 069
USE WITH. Automate S60 FT Motor & Head Plate, End Plate Set

7MM FABRIC SPLINE WITH 15MM TAIL
100m Roll

-

CODE.	SB91-0409-050015
PACK.	1 10 Rolls

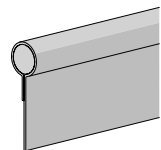

COLOUR. Black 050
USE WITH. F56 Weight Bar

AUTOMATE MOTOR HEAD PLATE | S60

4

TYPE	AUTOMATE / DOOYA
CODE.	RB56-0711-050509
PACK.	5 200 Sets

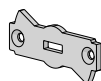

COLOUR. Black 050
USE WITH. Automate S60 FT Motor & Adaptor Set

ALUMINIUM TUBE - S60 | 80HD
O.D 80.0mm x 4.8mt Length

11

SIZE.	4.8m
CODE.	RB91-0280-000480
PACK.	2 20 Lengths

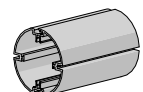

COLOUR. Mill 000
USE WITH. 9mm Flat Spline, RB10 Tube Adaptor, Gear Drive End, M50 Crown Wheel

AUTOMATE | ARC FT MOTOR WITH CLIP
[Ø45/15Nm/15rpm]

5

CODE.	MT01-1145-050001
PACK.	1 8 Pcs

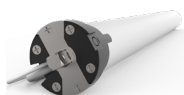

COLOUR. Black 050
USE WITH. S60 Motor Adaptor Set, Automate Drive & Crown Wheel

9MM ACM FLAT SPLINE | NO TAPE
100Lm Roll

-

TYPE.	No Tape
CODE.	RB92-0901-001100
PACK.	1 10 Rolls



COLOUR. Natural 001
USE WITH. S60 | 80 HD Tube

9MM ACM FLAT SPLINE WITH DOUBLE SIDED TAPE

Double Sided MP-HR Tape | 75Lm Roll

TYPE.	One Side	Two Sides
CODE.	RB92-0902-001075	RB92-0903-001075
PACK.	1 10 Rolls	1 10 Rolls



COLOUR. Natural 001
USE WITH. S60 | 80 HD Tube

F56 | ZIPSCREEN - LOCK END CAP SET (2 PIECE)

CODE.	RE20-0303-xxx002
PACK.	10 200 Sets

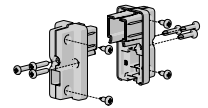

COLOUR. Black 050, Pure White 069
USE WITH. F56 Weight Bar

MULTI-PURPOSE DOUBLE SIDED TAPE

50Lm Roll

TYPE.	18mm
CODE.	HD31-0401-001018
PACK.	1 24 Rolls

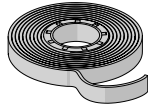

COLOUR. Natural Clear 001
USE WITH. Aluminium Tubes

WEIGHT BAR BUBBLE SEAL STRIP

8 x 12mm

TYPE.	CO-PVC
CODE.	SB91-0001-050580
PACK.	10 30 Lengths

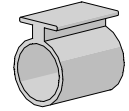

COLOUR. Black 050
USE WITH. F56 Weight Bar

Z-LOCK ZIP

TYPE.	No. 4 Gauge
CODE.	SH91-0106-050400
PACK.	500 2000 Metres

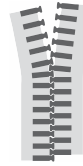

COLOUR. Black 050
USE WITH. Fabric, Inner Rail

RB10 WINDER ADAPTOR SET | S60

+ screws

CODE.	RB56-7109-050060
PACK.	5 50 Sets

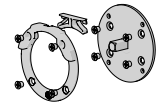

COLOUR. Black 050
USE WITH. RB10 Chain Winder, End Plate Set

Z-LOCK STANDARD SIDE GUIDE

33 x 48mm

CODE.	SB04-1501-000580
PACK.	4 60 Lengths

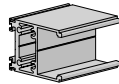

COLOUR. Mill 000
USE WITH. End Plates, Standard Side Guide Bottom Cap, F Rail Covers

RB10 CHAIN WINDER | S60

CODE.	RB10-6100-xxx001
PACK.	5 50 Pcs

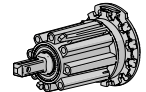

COLOUR. Black 050, Pure White 069
USE WITH. RB10 Tube Adaptor, Winder Adaptor Set

Z-LOCK PVC

5.8m Lengths

CODE.	AW08-0302-050580
PACK.	1 21 Lengths

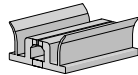

COLOUR. Black 050
USE WITH. Standard Side Guide Rail

RB10 TUBE ADAPTOR | S60

TYPE.	60STD Tube
CODE.	RB10-6000-xxx060
PACK.	5 200 Pcs

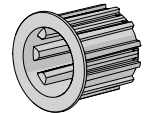

COLOUR. Black 050, Pure White 069
USE WITH. RB10 Winder, Zip Tube Reducer

Z-LOCK SIDE GUIDE - F RAIL COVER

TYPE.	RPVC - Interior
CODE.	SB05-0341-xxx580
PACK.	10 80 Lengths

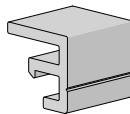

COLOUR. Black 050, White 069
USE WITH. Standard Side Guide Rail

RB10 RETRO-FIT BOOSTER SHORT SPRING LH | S60

TYPE.	LH only
CODE.	RB10-6040-050161
PACK.	4 16 Pcs



COLOUR. Black 050
USE WITH. S60 Tube, RB10 Winder S60

Z-LOCK STANDARD SIDE GUIDE STEEL BOTTOM CAP

CODE.	SB05-1501-025000
PACK.	10 200 Sets

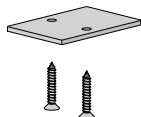

COLOUR. Zinc Plated 025
USE WITH. Standard Side Guide Rail

RB10 RETRO-FIT BOOSTER HEAVY DUTY | S60

TYPE.	L/H	R/H
CODE.	RB10-6040-050041	RB10-6040-050042
PACK.	4 16 Pcs	4 16 Pcs



COLOUR. Black 050
USE WITH. S60 Tube, RB10 Winder S60

F56 HD WEIGHT BAR

4.2m & 5.8m Lengths

TYPE.	4.2m Length	5.8m Length
CODE.	RE15-0101-000420	RE15-0101-000580
PACK.	2 48 Lengths	2 48 Lengths

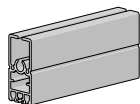

COLOUR. Mill 000
USE WITH. F56 End Caps, Fabric Spline

BOX SQUARE CHAIN GUIDE

+ screws

CODE.	SB11-0790-xxx000
PACK.	5 500 Sets

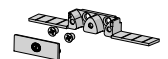

COLOUR. Black 050, Pure White 069, Silver Grey 338
USE WITH. End Plate Set

Z-LOCK SIDE GUIDE SIDE FIX PLATE

24a

with Grub screws

CODE.	SB05-1321-025000
PACK.	10 200 Sets

COLOUR. Zinc Plated 025
USE WITH. Compact & Standard Side Guide Rails

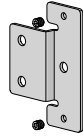

Z-LOCK SIDE GUIDE FACE FIX PLATE

24b

with Grub screws

CODE.	SB05-1320-025000
PACK.	10 200 Sets

COLOUR. Zinc Plated 025
USE WITH. Compact & Standard Side Guide Rails

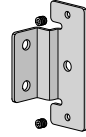

AUTOMATE REMOTES

One, Five, Fifteen & Thirty Channels



SIZE.	Push ONE	Push 5
CODE.	MT02-0101-xxx010	MT02-0101-xxx004
PACK.	1 20 Pcs	1 20 Pcs

SIZE.	Push 15	Push PRO
CODE.	MT02-0101-xxx008	MT02-0101-xxx013
PACK.	1 20 Pcs	1 25 Pcs

COLOUR. White 067, Black 050
USE WITH. Automate Motors

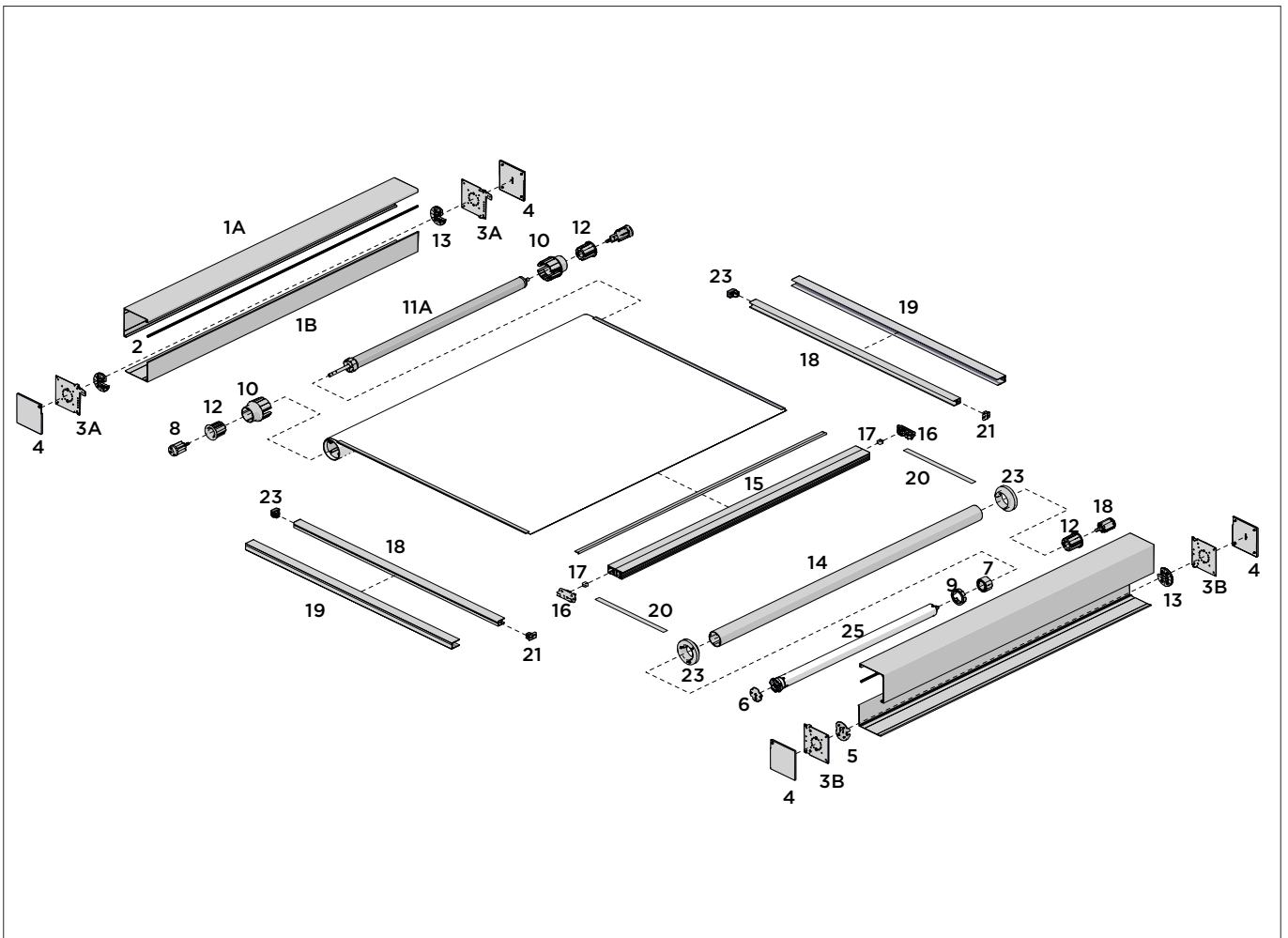

COLOUR RANGE



Mill

PRODUCT OPTIONS



BOX SQUARE BACK

1a

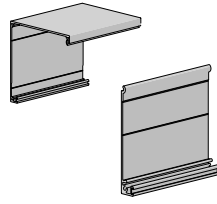

	SQUARE BOX 100	SQUARE BOX 120
TYPE.	Mill 000	Mill 000
CODE.	SB01-1010-000580	SB01-1340-000580
PACK.	4 80 Lengths	2 16 Lengths

COLOUR. Mill 000
USE WITH. Box Extrusions, End Plate Set

BOX 100 UNIVERSAL END PLATE SET WITH EARS

3a

+ screws

CODE.	SB02-1001-025020
PACK.	5 25 Sets

COLOUR. Zinc Plated 025
USE WITH. BOX Square 100, End Plate Covers

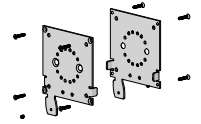

BOX 120 UNIVERSAL END PLATE SET WITH EARS

3b

+ screws

CODE.	SB02-1201-025020
PACK.	5 40 Pairs

COLOUR. Zinc Plated 025
USE WITH. BOX Square 120, End Plate Covers

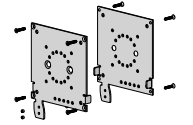

BOX SQUARE COVER

1b

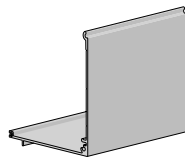

	SQUARE BOX 100	SQUARE BOX 120
TYPE.	mill 000	mill 000
CODE.	SB01-1025-000580	SB01-1326-000580
PACK.	4 72 Lengths	4 48 Lengths

COLOUR. Mill 000
USE WITH. Box Extrusions, End Plate Set

**BOX 100 END PLATE COVER SET
LH & RH**

4a

CODE.	SB02-1020-xxx020
PACK.	5 200 Pairs

COLOUR. Black 050, White 069, Silver Grey 338
USE WITH. End Plate Sets

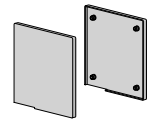

**BOX 120 END PLATE COVER SET
LH & RH**

4b

CODE.	SB02-1220-xxx020
PACK.	5 50 Pairs

COLOUR. Black 050, Pure White 069, Anodised 020
USE WITH. BOX Square 120, End Plate Sets

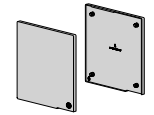

BOX SQUARE 100 TOP

1c

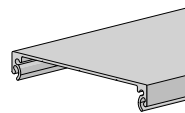

	SQUARE BOX 100
TYPE.	mill 000
CODE.	SB01-1030-000580
PACK.	4 80 Lengths

COLOUR. Mill 000
USE WITH. BOX Square 100 Cover & Back, End Plate Set

M50 MOTOR ADAPTOR SET | S60

5

+ screws

CODE.	RB56-0701-xxx508
PACK.	5 100 Sets

COLOUR. Pure White 069, Black 050
USE WITH. FT15 Motor

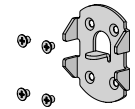

AUTOMATE MOTOR HEAD PLATE | S60

6

TYPE.	AUTOMATE
CODE.	RB56-0711-050509
PACK.	5 200 Sets

COLOUR. Black 050
USE WITH. FT15 Motor & Adaptor Set

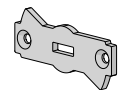

FABRIC BRUSH T-SLOT FIT
5mm High x 4.8mm Wide

2

CODE.	SB91-0011-050500
PACK.	500 2000 Metres

COLOUR. Black 050
USE WITH. BOX Square 120 Back

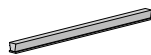

AUTOMATE DRIVE WHEEL SET | S60

7

TYPE.	AUTOMATE
CODE.	RB56-0105-050502
PACK.	5 250 Pcs

COLOUR. Black Satin 050
USE WITH. FT15 Motor

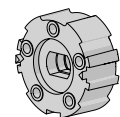

AUTOMATE | ARC FT MOTOR
[Ø45/15Nm/15rpm] with Clip

25

CODE.	MT01-1145-050001
PACK.	1 8 Pcs

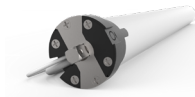

USE WITH. Crown & Drives

RB10 TUBE ADAPTOR | S60

12

TYPE.	60STD Tube	80HD Tube
CODE.	RB10-6000-069060	RB10-6000-050080
PACK.	5 200 Pcs	5 100 Pcs

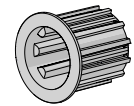

COLOUR. Black 050, Pure White 069
USE WITH. Tubes, Reducers, Pre-tension Idler/Bearing Idler Head

RB10 BEARING IDLER HEAD

8

CODE.	RB10-6200-xxx001
PACK.	5 50 Pcs

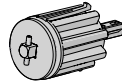

COLOUR. Black 050, Pure White 069
USE WITH. Rb10 Universal Bracket Adaptor

RB10 IDLER UNIVERSAL BRACKET ADAPTOR | S60
+ screws

13

CODE.	RB10-6400-050001
PACK.	5 100 Sets

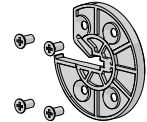

COLOUR. Black 050
USE WITH. RB10 Idler/Booster Head, End Plate Set

M50 CROWN WHEEL

9

TYPE.	AUTOMATE
CODE.	RB56-0136-050508
PACK.	5 250 Pcs



COLOUR. Black 050
USE WITH. AUTOMATE Motor, Zip Tube Reducer

ALUMINIUM TUBE - S60 | 60STD
O.D 60.0mm x 5.8mt Length

14a

TYPE.	No Tape	with D/S Tape
CODE.	RB91-0260-000580	RB91-6260-000580
PACK.	4 36 Lengths	4 36 Lengths

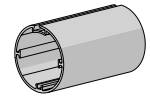

COLOUR. Mill 000
USE WITH. RB10 Tube Adaptor, Zip Tube Reducer Medium, RB10 Retro-fit Booster, 9mm ACM Flat Spline

ZIP TUBE REDUCER | MEDIUM
Reducing from 60mm to 45mm

10a

CODE.	SB11-0813-050360
PACK.	4 40 Pcs

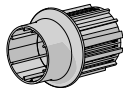

COLOUR. Black 050
USE WITH. S60 Standard Tube, Motor Crown, Box 100

ALUMINIUM TUBE - S60 | 80HD
O.D 80.0mm x 4.8mt Length

14b

SIZE.	4.8m - No Tape
CODE.	RB91-0280-000480
PACK.	2 20 Lengths

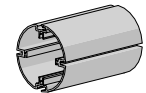

COLOUR. Mill 000
USE WITH. Automate ARC FT motor

ZIP TUBE REDUCER | LONG
Reducing from 80mm to 60mm

10b

CODE.	SB11-0815-050580
PACK.	4 100 Pcs

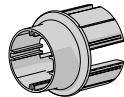

COLOUR. Black 050
USE WITH. S60 | 80HD Tube, RB10 Tube Adaptor, Box 120

9MM ACM FLAT SPLINE
Double Sided MP-HR TAPE · 75Lm Roll

-

TYPE.	One Side
CODE.	RB92-0902-001075
PACK.	1 10 Rolls



COLOUR. Natural 001
USE WITH. S60 Tube

RB10 RETRO-FIT BOOSTER LH | S60
Extra Heavy Duty

11a

TYPE.	LH
CODE.	RB10-6040-050051
PACK.	4 16 Pcs



COLOUR. Black 050
USE WITH. Aluminium Tube S60, RB10 Pre-Tension Idler

MULTI-PURPOSE DOUBLE SIDED TAPE
50Lm Roll

-

TYPE.	18mm
CODE.	HD31-0401-001018
PACK.	1 24 Rolls

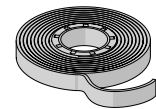

COLOUR. Natural Clear 001
USE WITH. Aluminium Tubes

RB10 RETRO-FIT BOOSTER LH | S60
Short Spring

11b

TYPE.	LH
CODE.	RB10-6040-050161
PACK.	4 16 Pcs

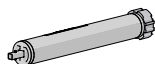

COLOUR. Black 050
USE WITH. Aluminium Tube S60, RB10 Pre-Tension Idler

Z-LOCK ZIP

-

TYPE.	No.5	No.6
CODE.	SH91-0115-050400	SH91-0135-050180
PACK.	400 800 Metres	180 360 Metres



COLOUR. Black 050
USE WITH. Fabric, Inner Rail

RB10 PRE-TENSION IDLER - LEFT HAND

18

CODE.	RB10-6220-050001
PACK.	5 50 Pcs

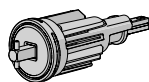

COLOUR. Black 050
USE WITH. RB10 Idler Head

F72 HD EXTERNAL WEIGHT BAR

72mm x 31mm x 7m Length

15

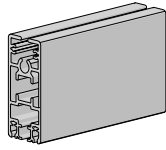

TYPE.	Mill 000 only	Colours - refer below
CODE.	RE15-0112-000700	RE15-0112-xxx700 -PF
PACK.	1 36 Lengths	1 36 Lengths

COLOUR. Black 050, Pure White 069
USE WITH. F72 Multi-Bar End Cap Set, F72 Multi-Bar Cord Guide Set

ZIPSCREEN | U MOUNTING RAIL

19

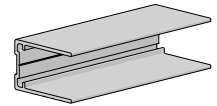

TYPE.	Mill 000	Colours - refer below
CODE.	SB04-0702-000550	SB04-0702-xxx550 -PF
PACK.	10 120 Lengths	10 120 Lengths

COLOUR. Black 050, Pure White 069
USE WITH. Zip Inner Rail, End Bracket Plates

F72 MULTI-BAR | END CAP SET

L/H & R/H + screws

16

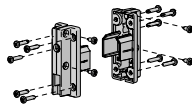

CODE.	RE15-0512-xx000
PACK.	5 200 Sets

COLOUR. Black 050, Pure White 069
USE WITH. F72 Weight Bar

LIFT TAPE

20

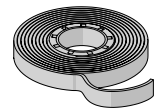

CODE.	SS95-6038-050500
PACK.	500 Metre Roll

COLOUR. Black 050
USE WITH. Cord Guide Set, Spool

7.2MM SPLINE WITH 15MM TAIL

100m roll

-

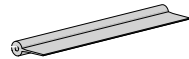

CODE.	SB91-0408-001015
PACK.	1 10 Rolls

COLOUR. Clear 001
USE WITH. F72 Weight Bar

SKYLIGHT ZIPSCREEN INNER RAIL END CAP

+ screw

21

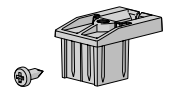

CODE.	SB05-1611-050001
PACK.	10 500 Sets

COLOUR. Black 050
USE WITH. ZipScreen Inner Rail

F72 MULTI-BAR | CORD GUIDE SET

-

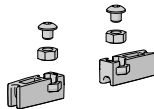

CODE.	RE15-0532-060000
PACK.	5 200 Sets

COLOUR. Natural White 060
USE WITH. F72 Weight Bar, Lift Tape

ZIPSCREEN | INNER RAIL FUNNEL & STOP SET

+ screws

22

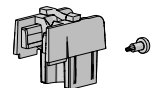

CODE.	SB05-1412-050001
PACK.	50 500 Sets

COLOUR. Black 050
USE WITH. ZipScreen Inner Rail

ZIPSCREEN | INNER RAIL

18

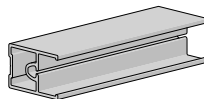

TYPE.	Mill 000	Colours - refer below
CODE.	SB04-0701-000550	SB04-0701-xxx550
PACK.	10 120 Lengths	10 120 Lengths

COLOUR. Black 050, Pure White 069
USE WITH. U Mounting Rail

SKYLIGHT TAPE SPOOL 9MM

+ Fixing Screw

23



CODE.	SS48-1061-066090
PACK.	10 80 Sets

COLOUR. Off White 066
USE WITH. Lift Tape, Cord-Braid, S60 | 60mm Tube