



Zipscreen

INSTALLATION MANUAL

v5.1 | February 2024



CONTENTS

SECTION A TOOLS AND ADDITIONAL ITEMS REQUIRED	3
TOOLS REQUIRED	3
SECTION B PREPARATION	4
PRE-ASSEMBLED SHADE COMPONENTS	4
OPTIONAL ASSEMBLE SHADE ACCESSORIES	5
SECTION C INSTALLATION	6
MOUNTING ORIENTATION	6
78MM TUBE	7
S100 TUBE	8
SPRING TENSION ADJUSTMENT	9
SHADE OPERATION	10
SIDE GUIDE INSTALLATION (FACE FIX ONLY)	11
SIDE GUIDE INSTALLATION U-MOUNTING RAIL	12
SIDE GUIDE INSTALLATION INNER RAIL	13
TEST OPERATION	15
INSTALL FRONT COVER	15
SECTION D OPERATION	16
ULTRA LOCK OPERATION	16
SECTION E ACCESSORIES	17
BOLT LOCK INSTALLATION	17
WALL MOUNTING CLIPS	17
SECTION F APPENDIX	18
MAX SPRING TURNS REFERENCE	18
MOTOR PROGRAMMING	19
SECTION G DOCUMENT CHANGE NOTES	22

DISCLAIMER

INTRODUCTION

This installation manual for Zipscreen System has been produced by Rollease Acmeda to supply the necessary information for the safe and correct installation of Zipscreen System.

DISCLAIMER

Rollease Acmeda has used reasonable care in preparing the information included in this document, but makes no representations or warranties as to the completeness or accuracy of the information. Information is supplied upon the condition that the persons receiving the information will make their own determination as to its suitability for their purposes prior to use. Rollease Acmeda assumes no liability whatsoever for any damages incurred by you resulting from errors in or omissions from the information included herein. Rollease Acmeda reserves the right to make changes without further notice to any products to improve reliability, function or design.

COPYRIGHT

COPYRIGHT © ROLLEASE ACMEDA

All rights are reserved. No part of this document may be reproduced or utilised in any means, by any means, electronic or mechanical including photocopying, recordings, or by any information storage or retrieval system, without the express permission from Rollease Acmeda.

TOOLS REQUIRED

- 1** Phillips Head / Flat Head Screwdriver

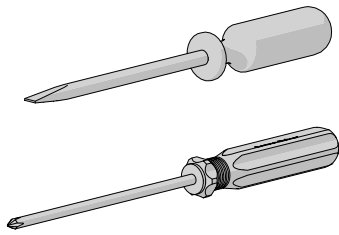

- 2** Drill

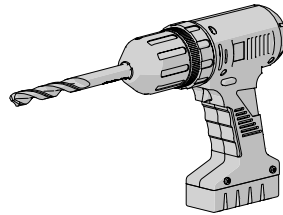

- 3** Drill Bits

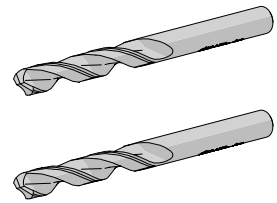

- 4** Hex Bit - 1/4"

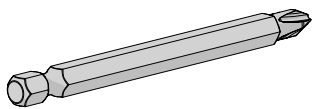

- 5** Step Drill

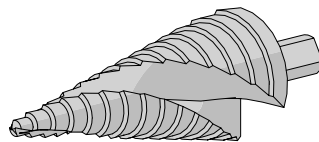

- 6** Spirit Level

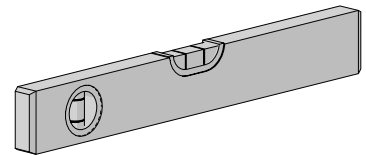

- 7** Measuring Tape

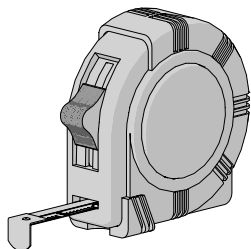

- 8** Pencil

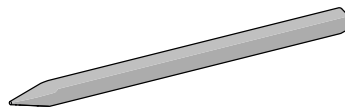

- 9** Allen Key Set

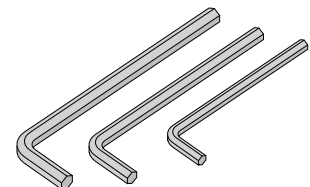

- 10** Suitable Fasteners

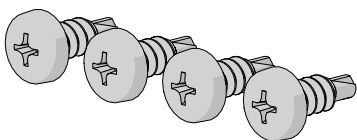

PRE-ASSEMBLED SHADE COMPONENTS

Note: Images shown below are indicative only and will vary with system requirements.

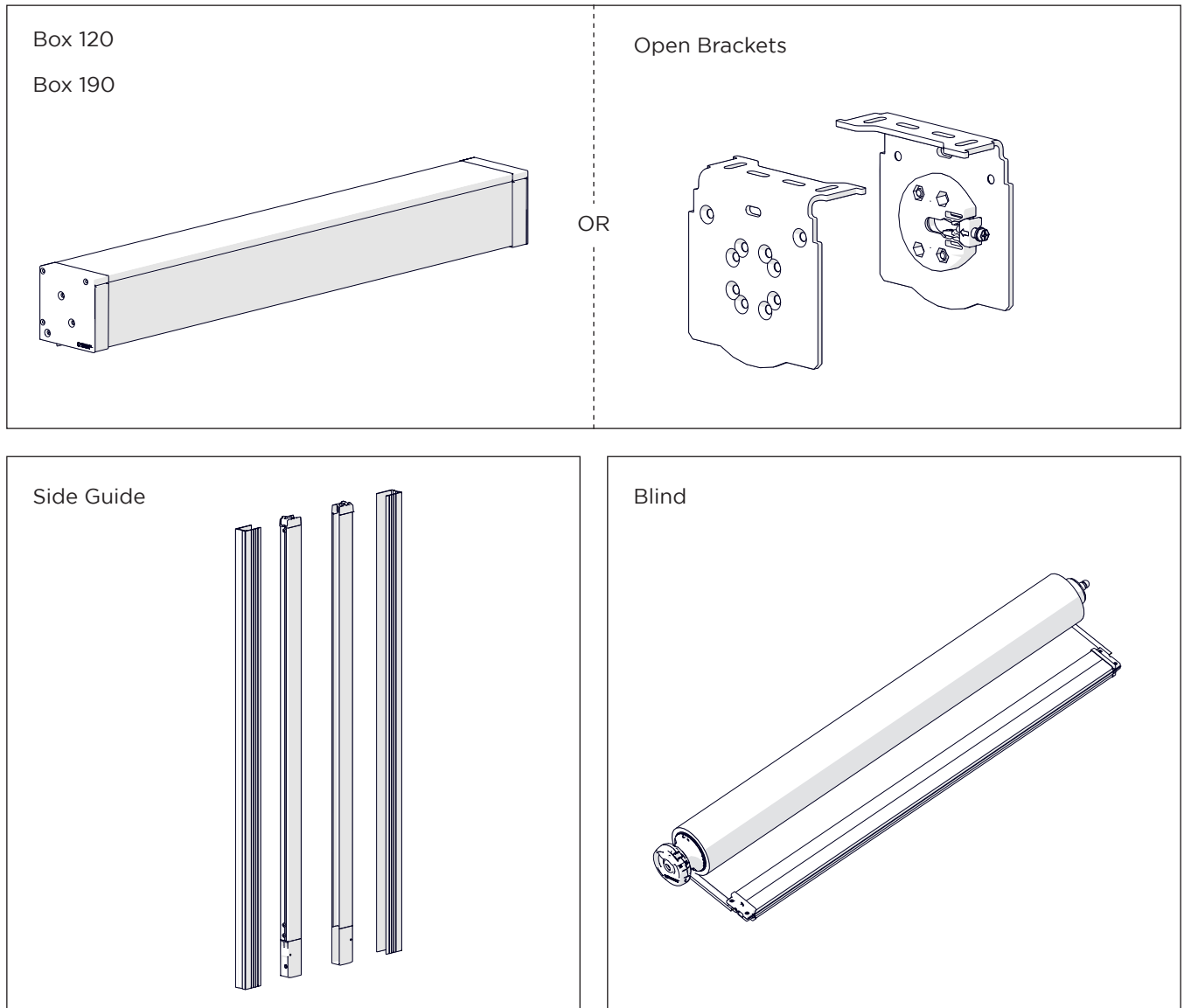

OPTIONAL | ASSEMBLE SHADE ACCESSORIES

1 Attach bolt locks (if required)

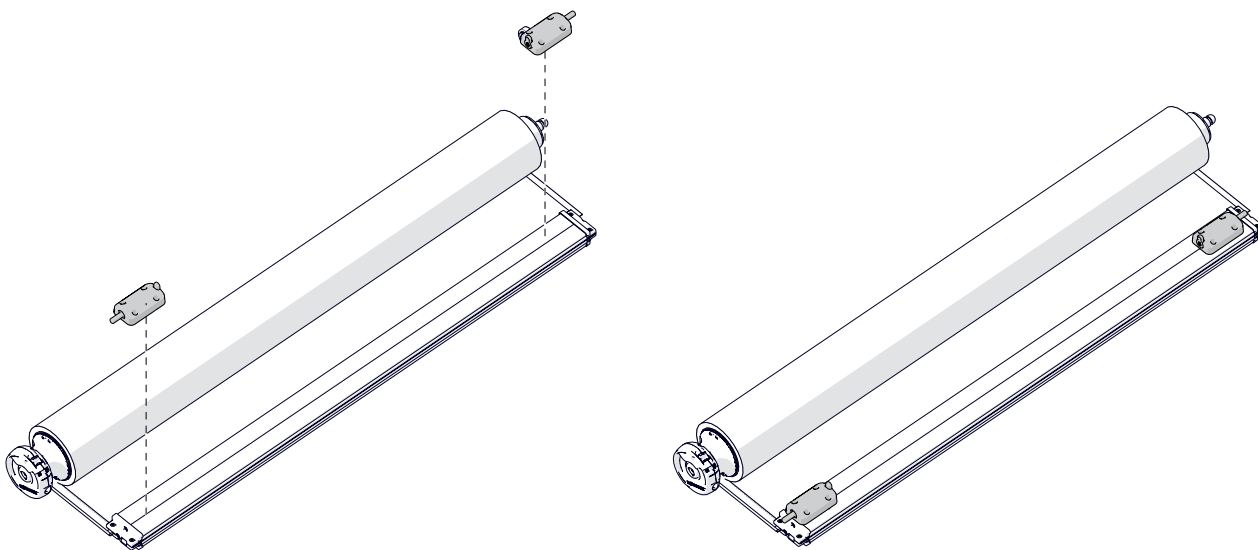

2 (Only for spring operated blinds) - If required, secure handle to weight bar

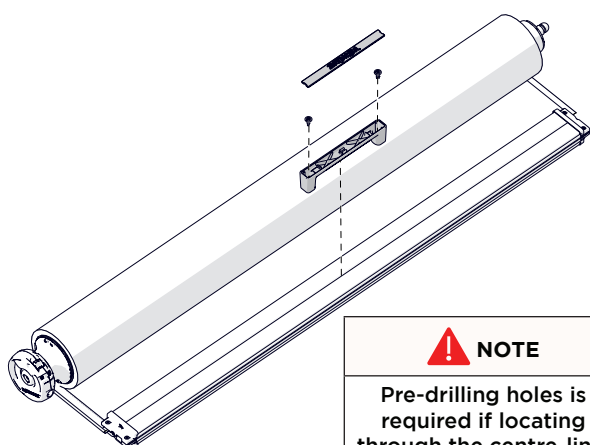

NOTE
Pre-drilling holes is required if locating through the centre-line.

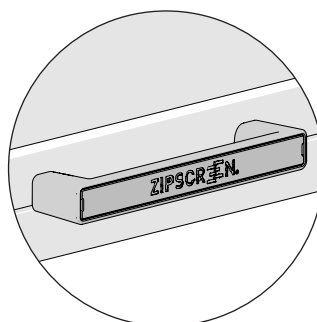

PLASTIC HANDLE

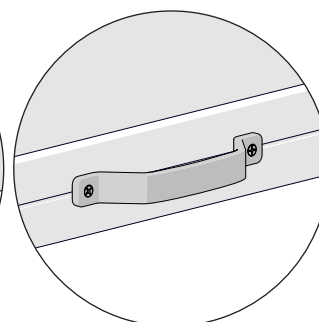

METAL HANDLE

MOUNTING ORIENTATION

Use appropriate fasteners to install box/open brackets. Fasteners below are indicative only.

NOTE

- Ensure brackets are level.
- Recommend pre-drilling holes in cassette brackets prior to installation.
- Pre-drill Ø22mm access hole for motor cable.

	FACE	CEILING	RECESS
Box 120			
Box 190			
Open Brackets			
Extreme Open Brackets			

78MM TUBE

- 1** Remove Retainer Clip in Bracket Adaptor

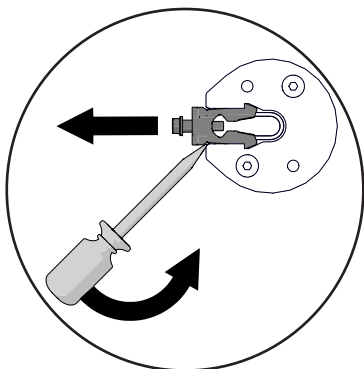

- 2** Insert shade into box (control end first)

MOTOR

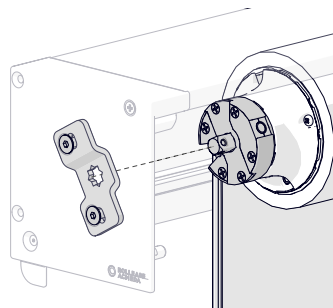

CRANK

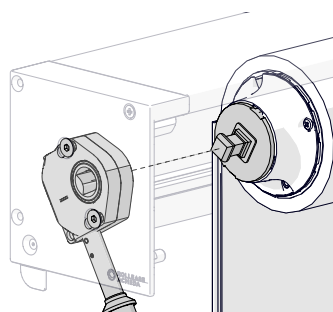

SPRING

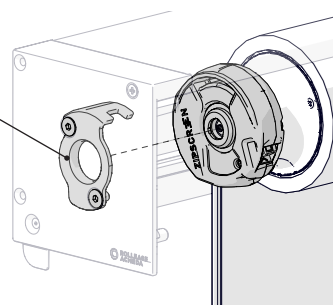

NOTE

Align control hardware with bracket and ensure tube assembly is engaged.



NOTE

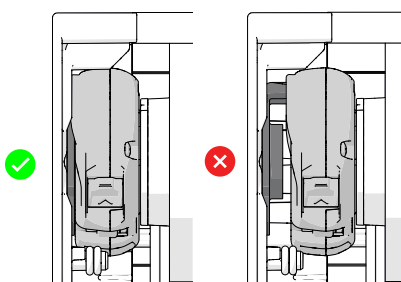

Ensure the spring tensioner head is fully engaged with the bracket adapter.

- 3** Align idler end and secure idler in place

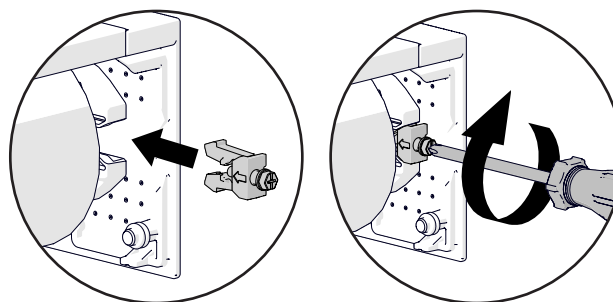
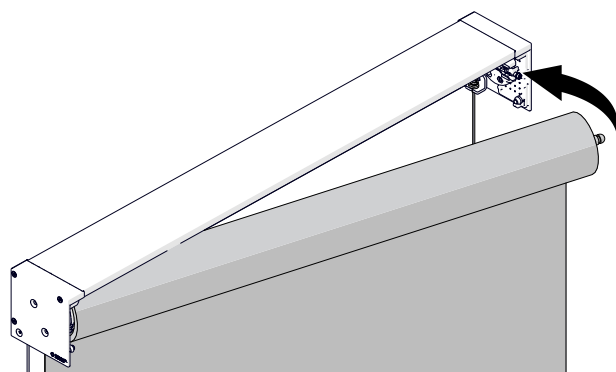

NOTE

User effort will be required to push the Idler pin into the adapter, a noticeable “click” will indicate that the component is correctly located.

S100 TUBE

- 1** Remove screw from zamak adaptor and bolt from idler adaptor

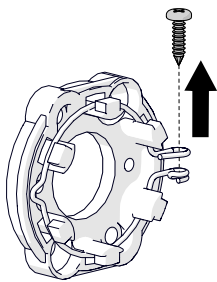

Zamak Adaptor

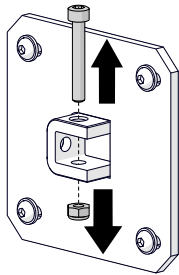

Idler Adaptor

- 2** Mount shade to brackets (motor end first)

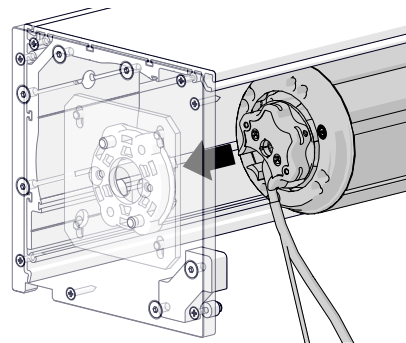

- 3** Align idler end and secure idler in place

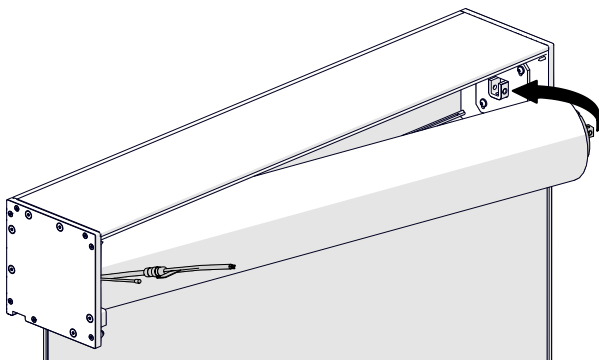

- 4** Fasten shade in place with fasteners removed in Step **1**

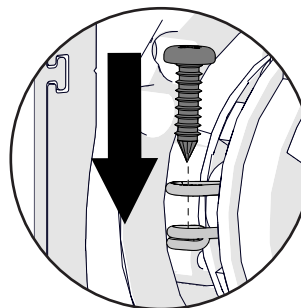

Zamak Adaptor

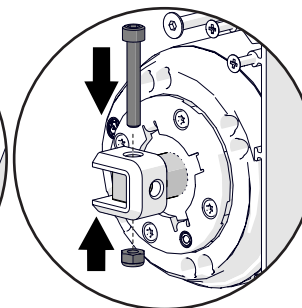

Idler Adaptor

SPRING TENSION ADJUSTMENT

⚠ WARNING

Do not unlock the tensioner head before applying tension. The weight bar will fall to the ground.

Do not operate drill in reverse if pin has not been activated. (see step 2)

DO NOT use an impact driver.

⚠ NOTE

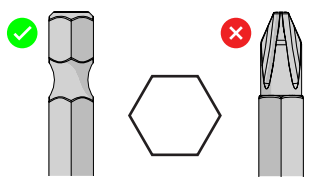

Use a drill with a 1/4" Hex Bit.

⚠ NOTE

Ensure drill bit inserts on correct angle - it will engage smoothly when correct.

Ensure the drill bit is 'pushing' up the internal lock before rotating.

Lock the tensioner head before attempting to remove the blind.

1 INSERT DRILL
with a 1/4" Hex bit - it will engage smoothly on correct angle.

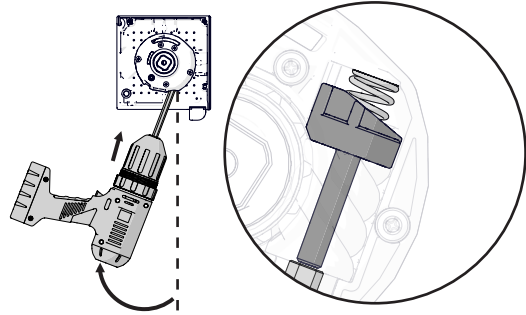

2 ACTIVATE PIN
Push against the spring loaded pin prior to adding or removing tension.

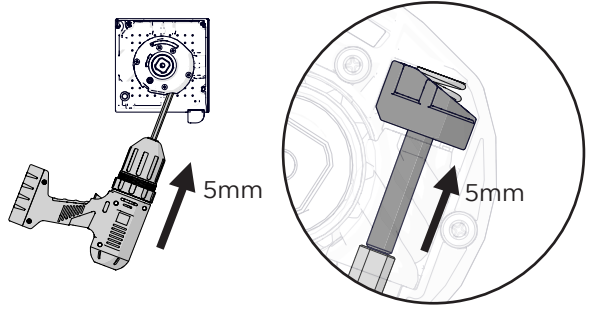

3 ADD OR REMOVE SPRING TENSION
Engage drill clockwise to apply tension. Anticlockwise will remove tension. The weight bar will move up slightly when enough pre-turns have been applied. Tension can be adjusted at any time, even while unlocked.

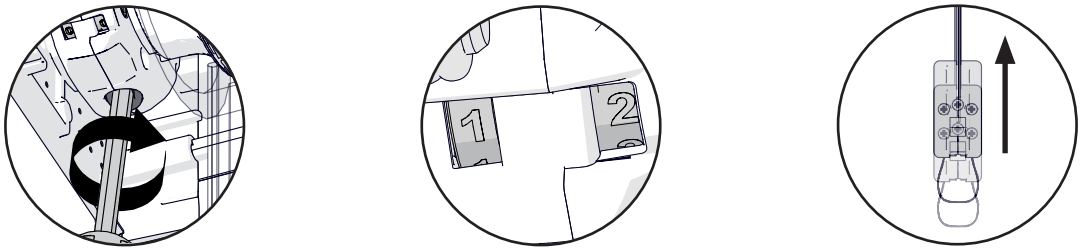

⚠ WARNING Recommend to use the drill's slip clutch mechanism to prevent accidental damage. If you hear clicking in clockwise, the drill has not been pushed in correctly.

4 UNLOCK SPRING TO OPERATE SHADE
Push grey lock to the unlocked position. The lock button will remain fully retracted.

⚠ WARNING **LOCK SPRING TO REMOVE SHADE**
Push grey lock again, tube may require 1/4 turn to re-engage locked position.

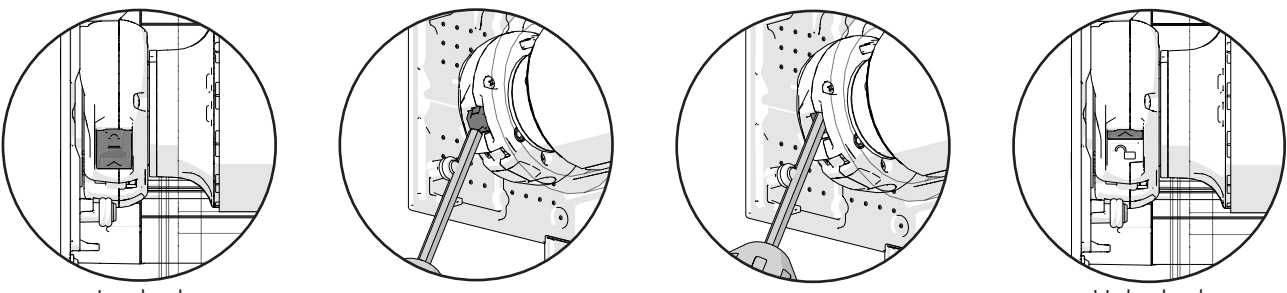

Locked

Unlocked

SHADE OPERATION

2 Run shade down

SPRING

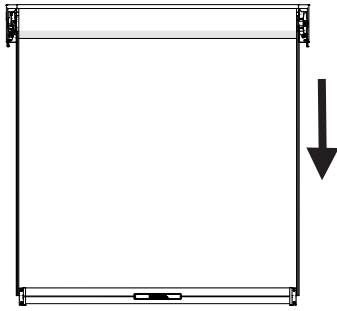

! NOTE

Blind should creep up slowly when pulled down. Refer to the spring tension adjustment section.

MOTOR

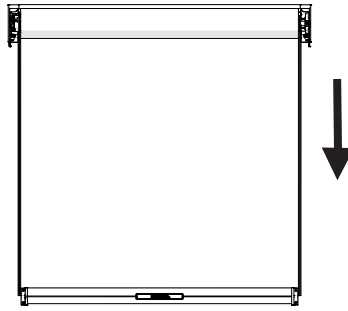

! NOTE

Refer to appendix for pairing remote to motor and check operation.

CRANK

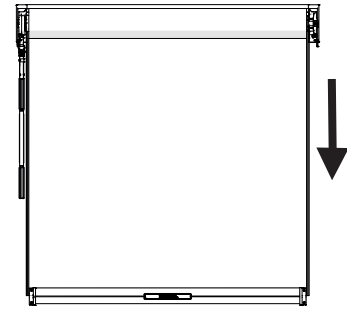

! NOTE

Ensure operation is smooth.

3 Ensure fabric is centered to the brackets

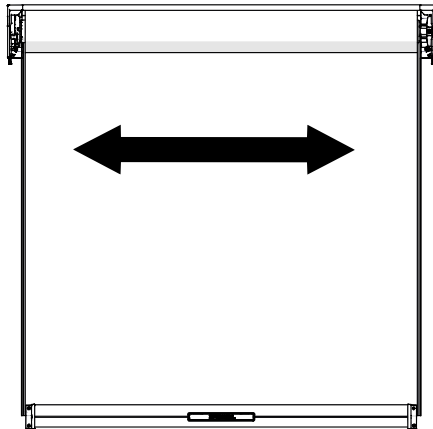

SIDE GUIDE INSTALLATION | (FACE FIX ONLY)

1 Mount Rail to wall on both sides

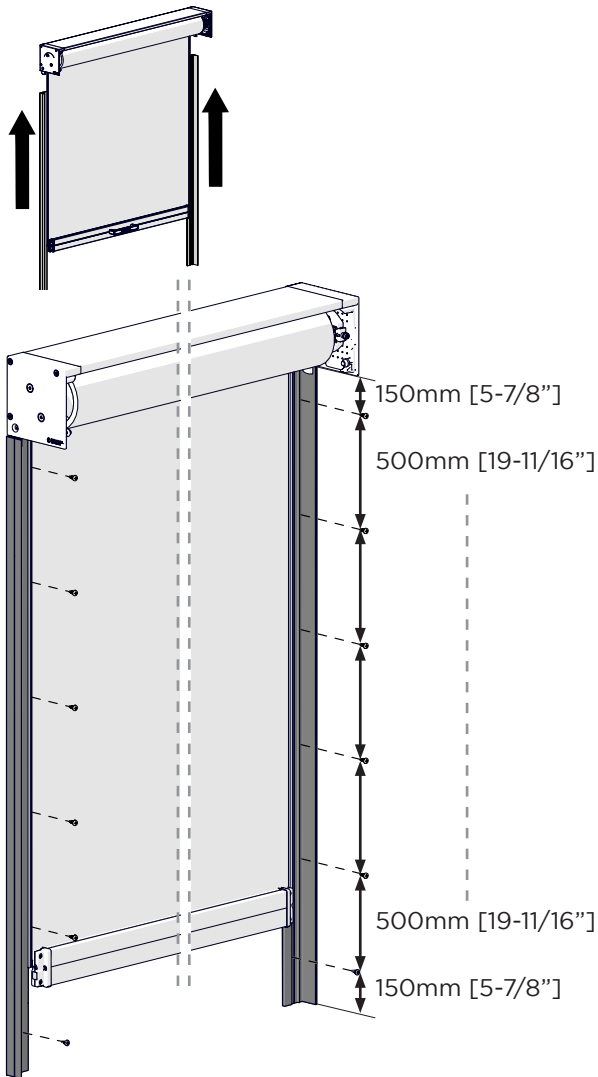

NOTE

L FIXING RAIL

Use an off cut of the U mounting rail to install the L-fixing rail at the correct distance from the end plate.

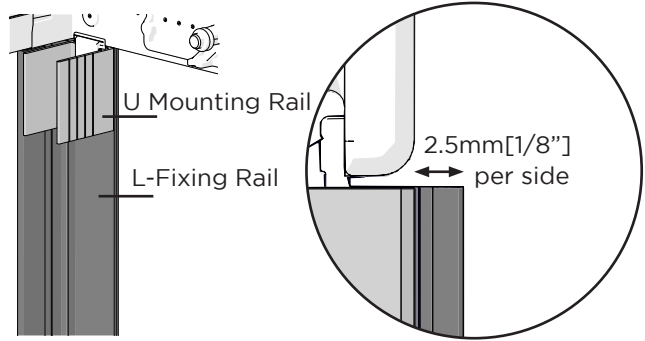

FACE FIX U MOUNTING RAIL

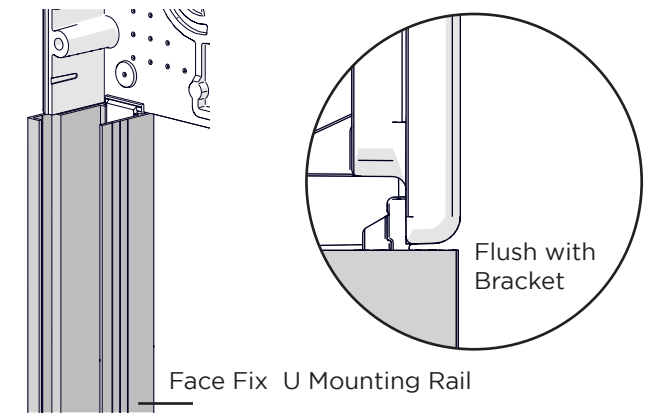

L FIXING RAIL

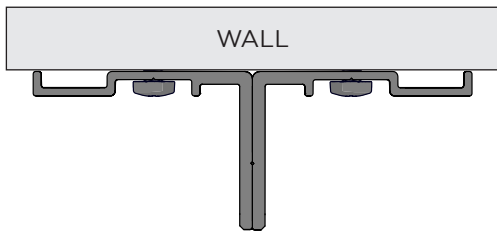

FACE FIX U MOUNTING RAIL

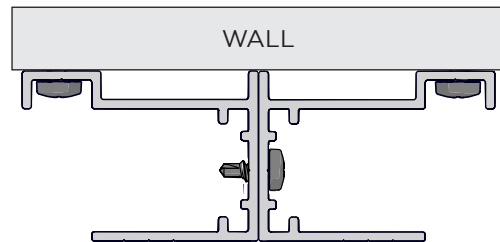

BOX 120

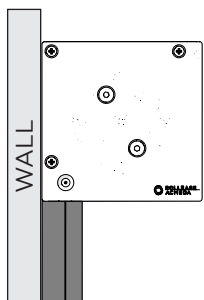

OPEN BRACKET

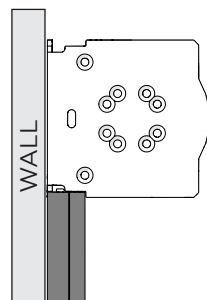

BOX 190

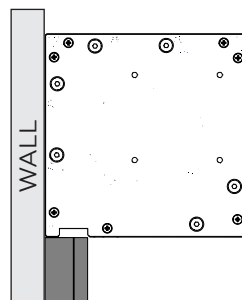

EXTREME OPEN BRACKET

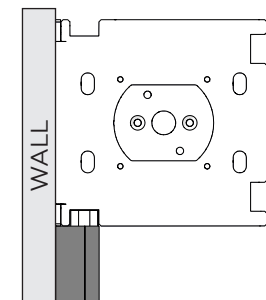

SIDE GUIDE INSTALLATION | U-MOUNTING RAIL

1 Insert and secure U-Mounting rail

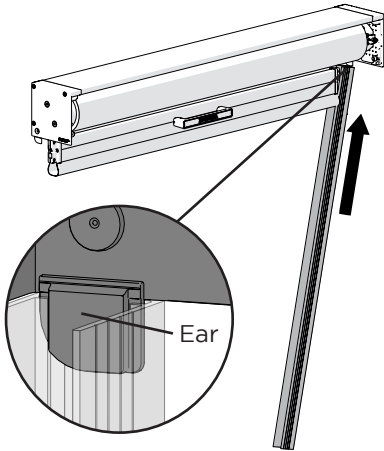

Locate ear of end plate with U-mounting rail

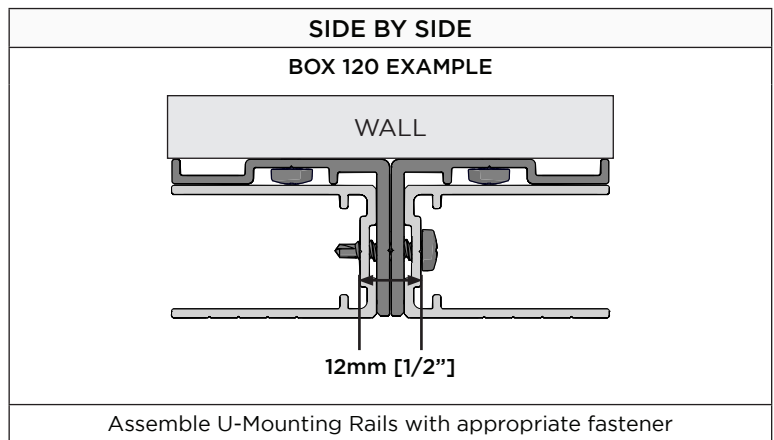
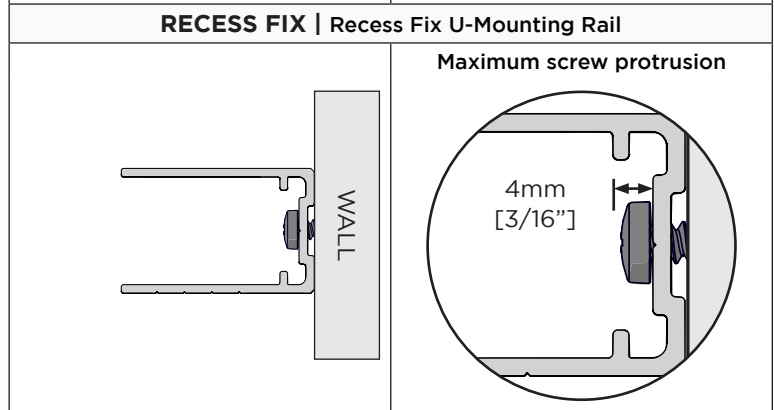
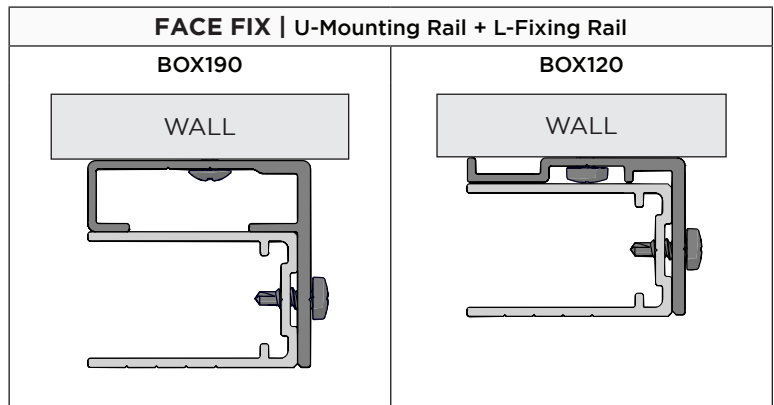
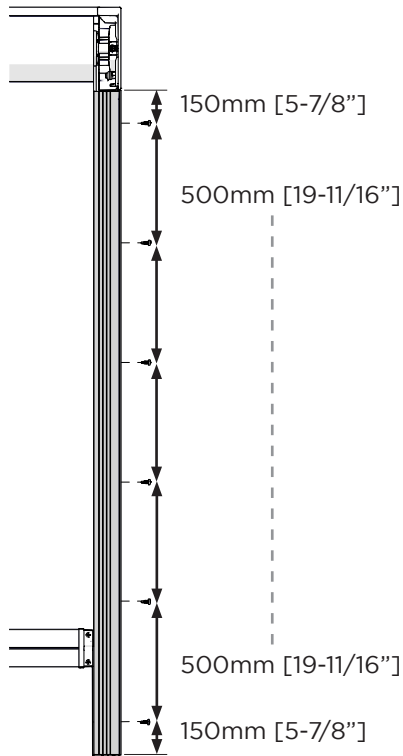

U-MOUNTING RAIL

BOX 120

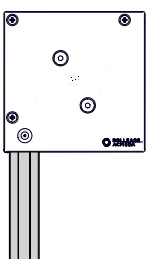

OPEN BRACKET

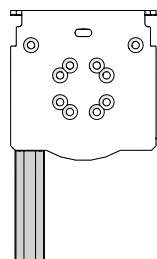

BOX 190

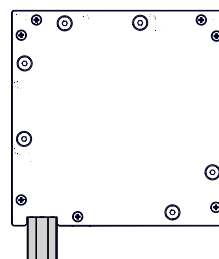

EXTREME OPEN BRACKET

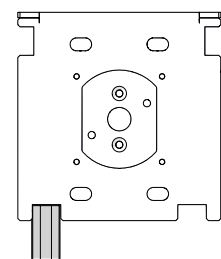

SIDE GUIDE INSTALLATION | INNER RAIL

- 1** Insert the Inner Rail into the U-Mounting Rail

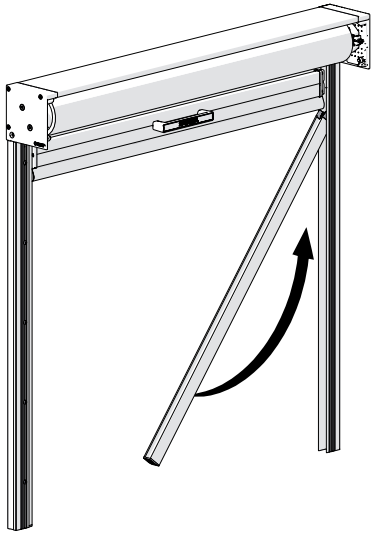

! NOTE

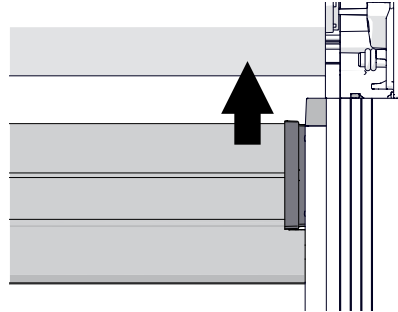

Lift weight bar up as much as possible as the Inner Rail is angled in to collect the zip.

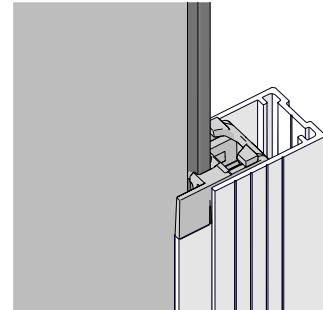

Feed zip into inner Rail Funnel while aligning with U-Mounting Rail.

- 2** Run shade up and down multiple times to allow inner rail to move into natural position

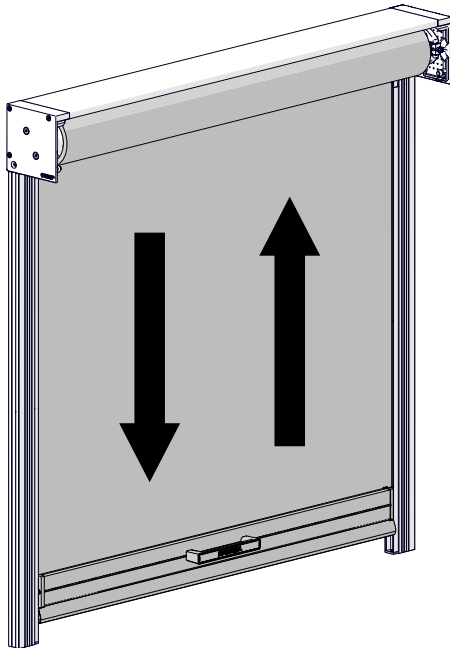

SIDE GUIDE INSTALLATION | INNER RAIL

3. 1. Align the Inner Rail to the 52mm notch and secure Inner Rail with a fastener.
2. Lower the shade and ensure the Inner Rails are parallel then secure with a fastener.
3. Continue to secure the Inner Rails at MAX 500mm spacing, operate the shade at each stage. For spring controls, adjust tension as necessary.

DO NOT pull the Inner Rails tight as this will create excess friction preventing smooth operation.

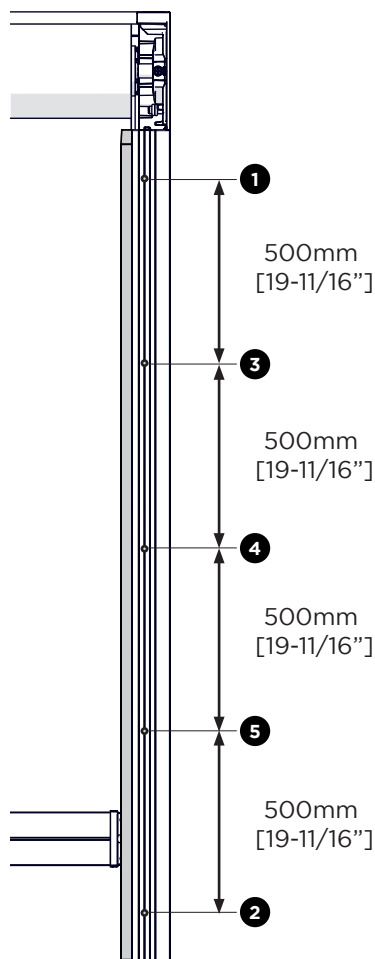

NOTE

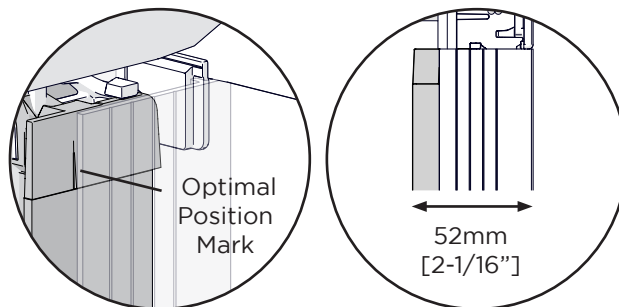

NOTE

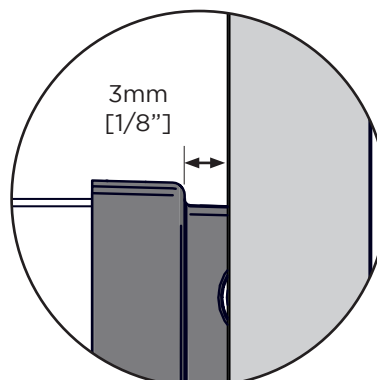

The distance between the weight bar end cap and the edge of the inner rail should always be approximately 3mm [1/8\"/>

NOTE

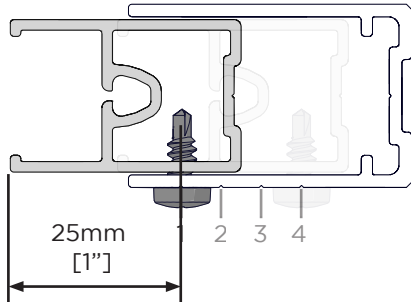

The overall dimension of the U-Mounting Rail and Inner Rail must be between 42mm - 62mm.

NOTE

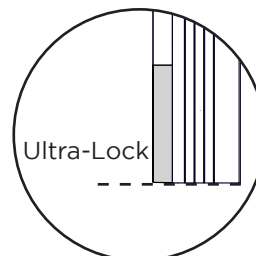

Ensure the Lock Housings are perfectly level. Test this by lowering the weight bar into the Ultra-Lock housings (both pins should click at the same time). Adjust position of Inner Rails as required.

Note: Screw position shown above is not to scale (only for illustration purpose)

TEST OPERATION

- 1 Test operation and appearance of shade

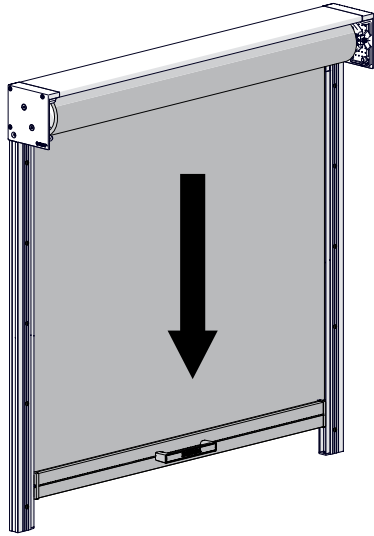

⚠️ SPRING CONTROL CHECK

Balanced	Not Balanced
<p>Pull ↓ stays ✓</p>	<p>Pull ↓ soves ✗</p>

Pull weight bar down slightly to check if shade is balanced. The weight bar should stay at the same position upon release. Refer to Spring Tension Adjustment for tuning.

INSTALL FRONT COVER

- 1 Swing box cover into box top and clip into place

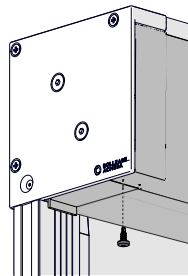
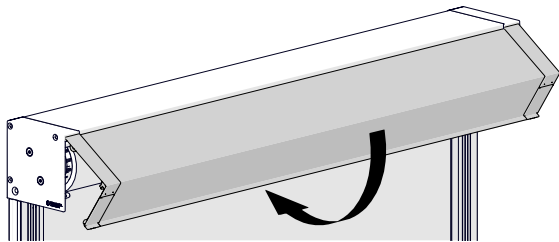

⚠️ NOTE

- Always secure the front cover with a screw at each end. There is a dimple on the End Plate Cover to ensure correct position.
- Do not force cover closed, ensure End Plates are engaging correctly

INSTALL FRONT COVER - BOX 190

- 1 Install front cover and fasten in place

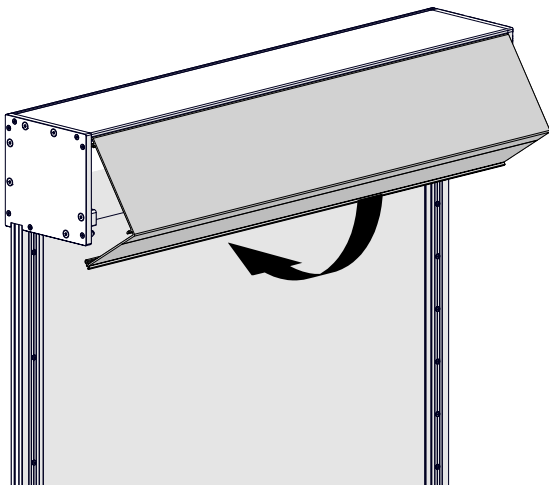

OPTION 1 (SIDE FIX):

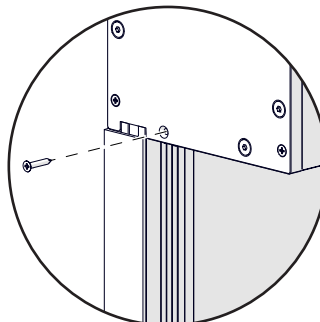

Self tapping screws are required

OPTION 2 (FACE FIX):

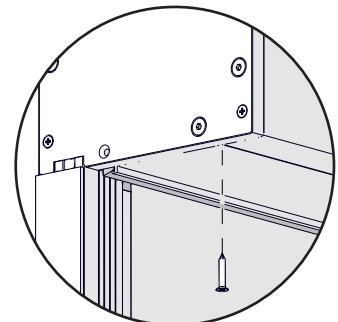

Position the screw 7-8mm from the end of the extrusion. Pre-drilling into the aluminium block may be required.

ULTRA LOCK OPERATION | LOCK

- 1 Lower shade until you hear the lock click once

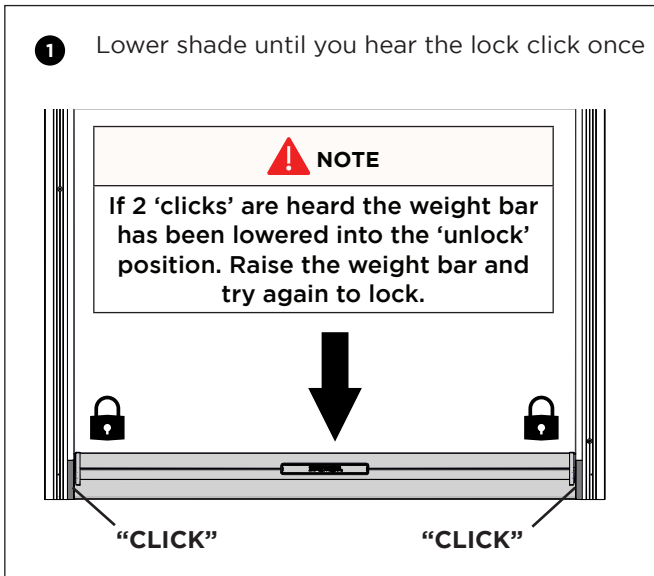

ULTRA LOCK OPERATION | UNLOCK

- 1 Lower shade until you hear the lock click

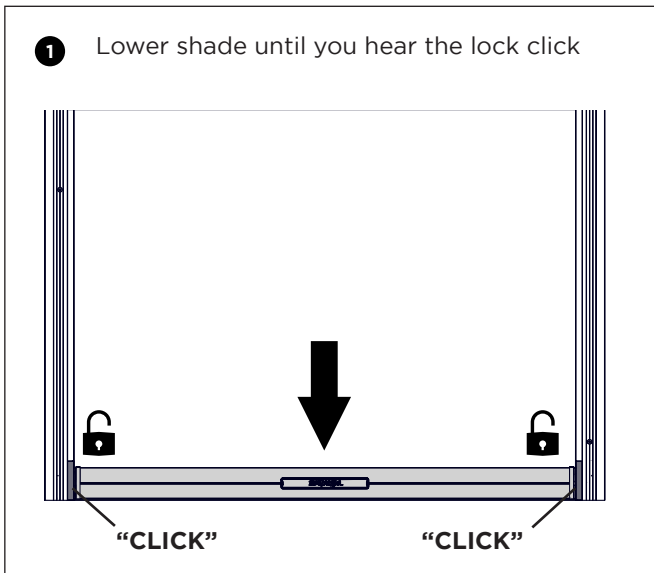

- 2 Raise the weight bar

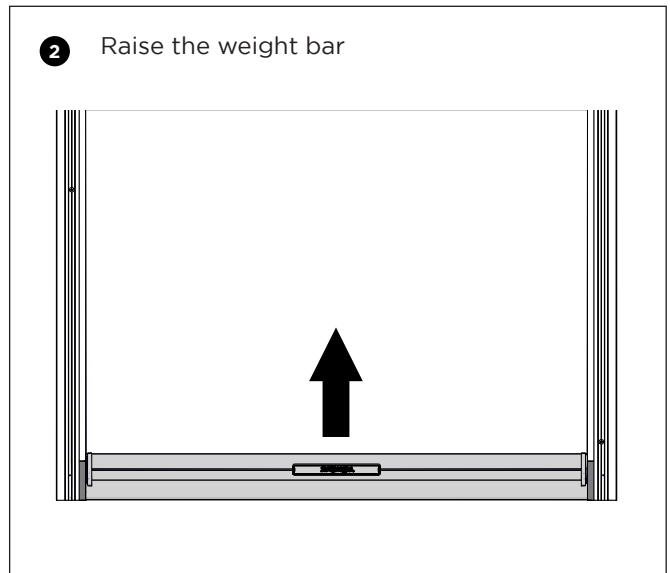

BOLT LOCK INSTALLATION

- 1 Lower weight bar and secure the latch to weight bar

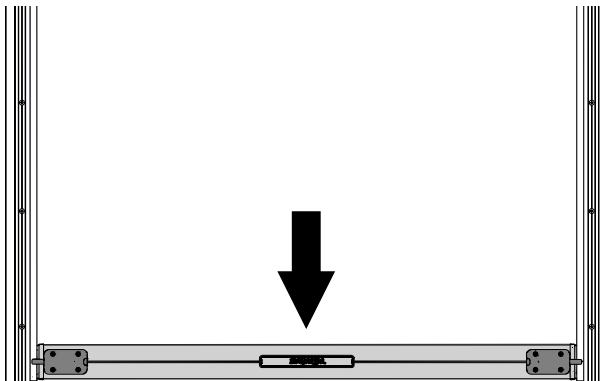

- 2 Align weight bar with bottom limit and secure latch to U-Mounting Rail on both sides

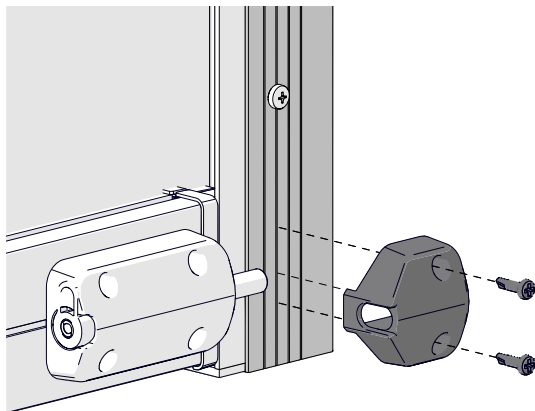

NOTE

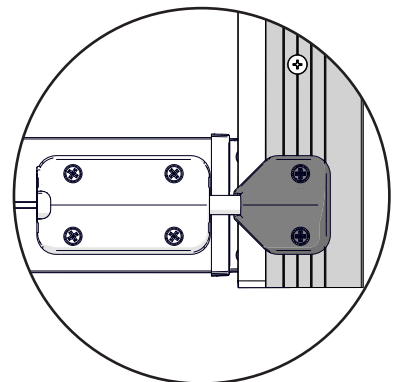

Align lip of latch to Inner Rail

WALL MOUNTING CLIPS

Secure to an appropriate location to store the Crank Handle or the Pull Stick.

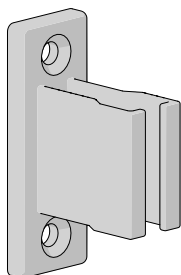

Crank Handle Clip

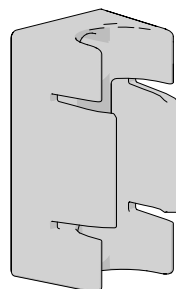

Pull Stick Wall Clip

MAX SPRING TURNS REFERENCE

A spring has a maximum number of turns to ensure longevity.

The 'total turns' of a spring is the sum of the # of tube turns & the # of pre-turns applied.

e.g. for a COMPACT spring on a 2.4m drop blind, do not apply more than 16 pre-turns.

SPRING MAX PRE-TURNS @ DROP				
DROP		# TUBE TURNS	SPRING	
[m]	[in]		COM LGT	STD HD XHD UHD
0.6	24	2	23	31
0.8	31	3	22	30
1.0	39	4	21	29
1.2	47	4	21	29
1.4	55	5	20	28
1.6	63	6	19	27
1.8	71	7	18	26
2.0	79	7	18	26
2.2	87	8	17	25
2.4	94	9	16	24
2.6	102	9	16	24
2.8	110	10	15	23
3.0	118	11	14	22
3.2	126	11	14	22
3.4	134	12	13	21
3.6	142	12	13	21
3.8	150	13	12	20
4.0	157	14	11	19

MOTOR PROGRAMMING



Scan this QR code to download FT Motor programming instructions



Scan this QR code to watch our FT Motor programming guide

- 1** Select channel on controller

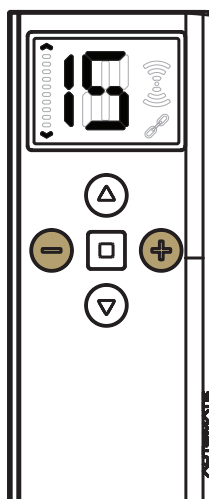

- 2** Hold P1 button on motor

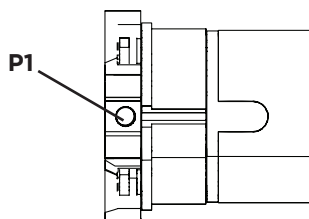

Motor Response:

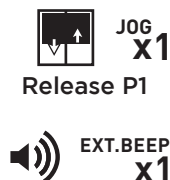

- 3** Hold STOP on controller

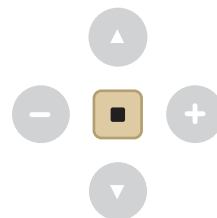

Motor Response:

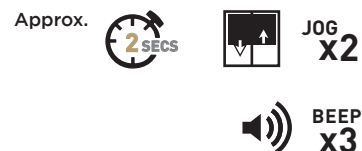

CHECK FOR MOTOR DIRECTION

- 1** To check travel direction of shade, press UP or DOWN on controller.



Quick press = Step
Long Press = Continuous Travel

! IMPORTANT

Damage to shade may occur when operating motor prior to setting limits. Attention should be given.

- 2** To reverse shade direction, hold both UP and DOWN. Until the motor responds.

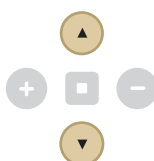

Motor Response:



! IMPORTANT

Motor direction reversal is only possible during initial setup.

SET UPPER LIMIT

- 1 Move shade to the desired highest position by pressing the UP button on controller

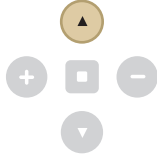
**IMPORTANT**

Cycle shade up and down prior to setting limits to settle fabric.

- 2 To save upper limit, hold UP and STOP

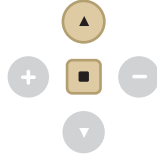

Motor Response:

Approx.



JOG
X2



BEEP
X3

**ADJUST UPPER LIMIT**

Hold UP & STOP together for 5 seconds to enter top limit adjustment mode. Then repeat Steps 1 and 2

SET LOWER LIMIT

- 1 Move shade to the desired lowest position by pressing the DOWN button on controller

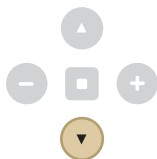
**IMPORTANT (Ultra-Lock)**

- The motor lower limit must be set correctly between the locking & unlocking position.
- Jog the motor down to find the lock position (Jog until you hear BOTH pins click), then set the lower limit.

- 2 To save lower limit, hold DOWN and STOP

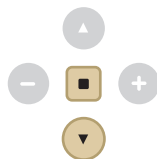

Motor Response:

Approx.



JOG
X2

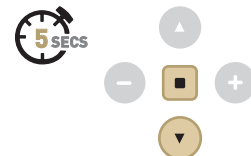

BEEP
X3

**ADJUST LOWER LIMIT**

Hold DOWN & STOP together for 5 seconds to enter top limit adjustment mode. Then repeat Steps 1 and 2

ACTIVATE FABRIC TENSION MODE (FOR ULTRA-LOCK)

- 1** Press P2 on controller

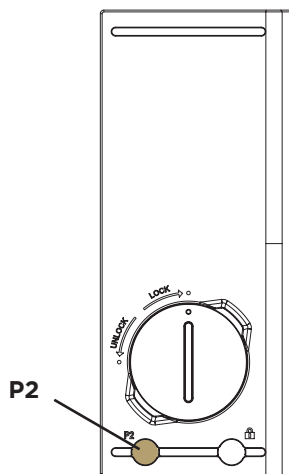

NOTE

- Once the bottom limit is set, FT Mode will need to be activated to operate the Ultra-Lock.

- 2** Press UP on controller two times

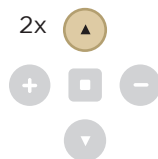

FT Mode - Motor Response:



No FT Mode - Motor Response:



ULTRA LOCK OPERATION

LOCK

Press DOWN on the controller. The motor will lower the weight bar to the set bottom limit, then automatically tension the fabric.

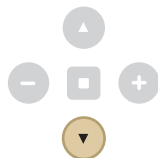

UNLOCK

Press UP on the controller. The motor will lower the weight bar past the bottom limit to unlock, then raise the weight bar, continuing to the upper limit.

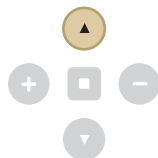

IMPORTANT

Make sure that the FT mode is turned ON while locking and unlocking the blind.

SECTION G | DOCUMENT CHANGE NOTES

REVISION	CHANGES
v5.0 September 2023	Combined Zipscreen & Zipscreen Extreme Manuals. Updates throughout relating to Zipscreen Top Hardware upgrade.
v5.1 February 2024	Clarified spring installation notes.