

BRACKETS | DOUBLE

FEATURES & BENEFITS

- Combine sheer fabric and block-out fabric in one installation.
- Ultimate privacy while still allowing light into any given room.
- Easy-Lock assembly to simplify installation.
- Available in multiple configurations for every application.
- HD Adapter increases the standard bracket's strength for larger motors.

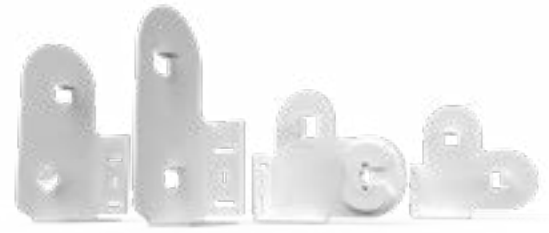

MOUNTING SOLUTIONS



COLOUR RANGE

- black
- pure white
- sandstone
- barley
- silver grey

OPTIONS

HD ADAPTER

*RB07 CHAINWINDER

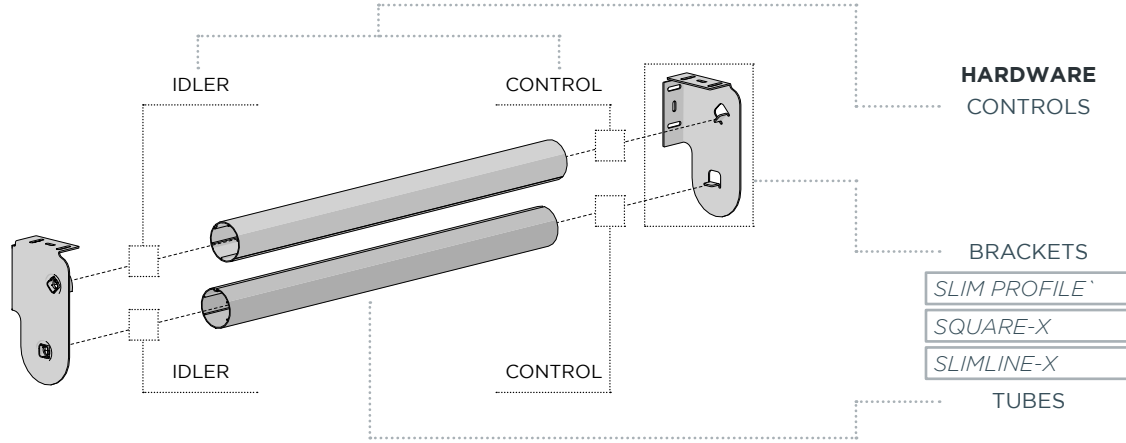

FABRIC ORIENTATION

SLIM PROFILE TOP-FRONT*	SLIM PROFILE TOP-BACK*	SQUARE-X	SLIMLINE-X

TECHNICAL DATA

**SLIM PROFILE BRACKETS REQUIRE FIXED GUIDE RB07 CHAIN CONTROL*

Rollease Acmeda recommends Slim Profile double brackets use the RB07 Chainwinder in the top position. The RB07 chainguard extends past the chainwinder housing, minimising chain contact with the bottom chainwinder. Please note, there are different deductions for each chainwinder.

INCREASED DOUBLE BRACKET CAPACITY WITH THE HD ADAPTER

The HD Adapter is required for all 3.0Nm and 6.0Nm motors.

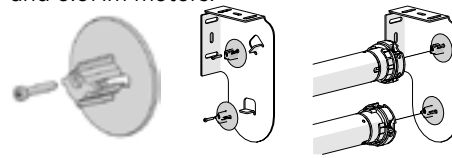

MAX ROLL SIZE (x2)	WINDER		MOTOR	MOTOR & HD ADAPTER	SPRINGS	IDLER		UPGRADE	
	RB07/08	RB09	1.1Nm/2.0Nm 5V	3.0Nm 12V	6.0Nm AC	ESU / ESW	RB07/08	RB09	EASY-LINK
70mm	✓	✓	✓	✓	✓	✓	✓	✓	✓
70mm	✓	✓	✓	✓	✓	✓	✓	✓	✓
70mm	✓	✓	✓	✓	✓	✓	✓	✓	✓
65mm	✓	✓	✓	✓	✓	✓	✓	✓	✓

SLIM PROFILE TOP FRONT		Top Front configured brackets use front over-rolled fabric to conceal both rolls. The Top Front fabric roll is installed on a 45° angle for improved chain control experience.
SLIM PROFILE TOP BACK		Slim profile bracket with tube controls both located on the same side bracket to minimise footprint in living space. Top Back configured brackets have the back roll at the top for optimum light blocking.
SQUARE-X		Square profile bracket with both tube controls located on the same bracket side.
SLIM-LINE-X		Square profile bracket with tube controls located on the alternate sides. Separating one chain control to each side simplifies operation for the user.