

OVERVIEW

Acmeda's range of Round Bottom Rail sees the introduction of a new universal slimline end cap as well as an updated colour range.

FEATURES

- Universal end caps resulting in no specific left or right hand version.
- Reduced rim size, providing an improved slimline appearance.
- Enhanced flexible fitment ensuring a perfect fit.
- Durable UV stabilised compound.

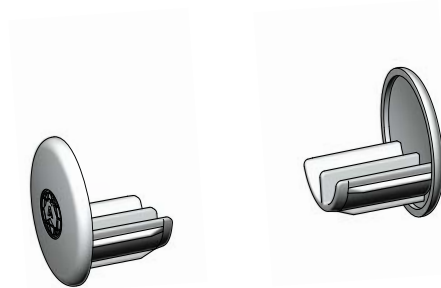

ROUND SLIMLINE Bottom Rail End Cap - Universal

CODE: RB91-2104-xxx022

COLOUR: black 050, pure white 069, bronze pearl 082, sandstone 269, bone 280, barley 283, dune 428, silver grey 338

PACK: 100 | 5,000 Pieces

USE WITH: ROUND Aluminium Closed Bottom Rail

END CAP DEDUCTIONS

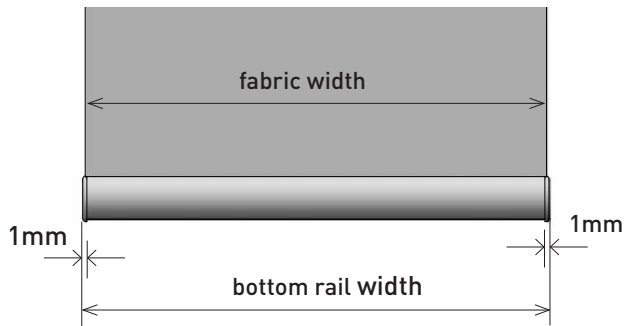

bottom rail width = fabric width + 2mm

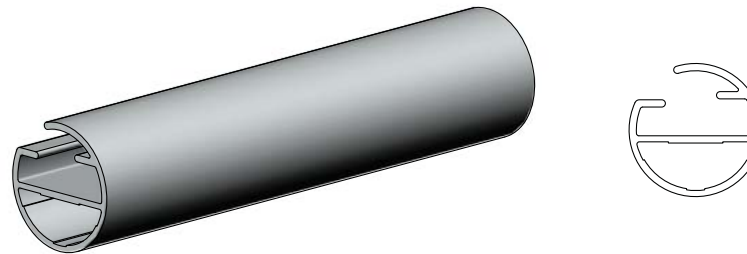

**ROUND Aluminium Closed Bottom Rail
22.0mm x 5.8mt Length**

CODE: RB91-1203-xxx580

COLOUR: anodised 020, black 050, pure white 069, bronze pearl 082, sandstone 269, bone 280, barley 283, dune 428

PACK: anodised 10 | 320 Lengths
colours 10 | 100 Lengths

USE WITH: ROUND SLIMLINE Bottom rail End Cap