



# Yuki

## INSTALLATION MANUAL

v1.2 | June 2025

# CONTENTS

<b>SECTION A   TOOLS AND ADDITIONAL ITEMS REQUIRED</b>	<b>3</b>
TOOLS REQUIRED .....	3
<b>SECTION B   PREPARATION</b>	<b>4</b>
PRE-ASSEMBLED AWNING COMPONENTS .....	4
<b>SECTION C   INSTALLATION</b>	<b>5</b>
MOUNTING ORIENTATION .....	5
END PLATE PREPARATION (IF REQUIRED) .....	6
AWNING INSTALLATION .....	7
AWNING ADJUSTMENT .....	7
<b>APPENDICES</b>	<b>9</b>
APPENDIX A: DOCUMENT CHANGE NOTES .....	9

## DISCLAIMER

**INTRODUCTION**  
This installation manual for Yuki system has been produced by Rollease Acmeda to supply the necessary information for the safe and correct installation of Yuki system.

**DISCLAIMER**  
Rollease Acmeda has used reasonable care in preparing the information included in this document, but makes no representations or warranties as to the completeness or accuracy of the information. Information is supplied upon the condition that the persons receiving the information will make their own determination as to its suitability for their purposes prior to use. Rollease Acmeda assumes no liability whatsoever for any damages incurred by you resulting from errors in or omissions from the information included herein. Rollease Acmeda reserves the right to make changes without further notice to any products to improve reliability, function or design.

**COPYRIGHT**  
COPYRIGHT © ROLLEASE ACMEDA  
All rights are reserved. No part of this document may be reproduced or utilised in any means, by any means, electronic or mechanical including photocopying, recordings, or by any information storage or retrieval system, without the express permission from Rollease Acmeda.

## TOOLS REQUIRED

- 1** Phillips Head / Flat Head Screwdriver

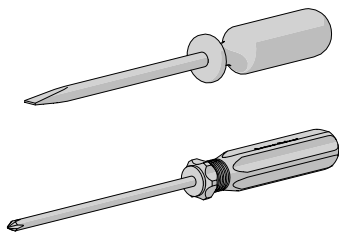

- 2** Drill

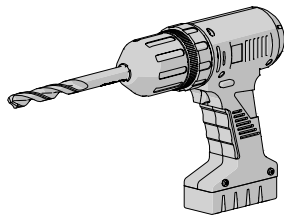

- 3** Drill Bits

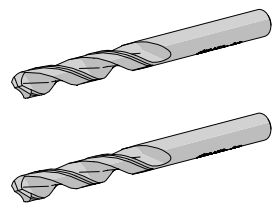

- 4** Suitable Fasteners

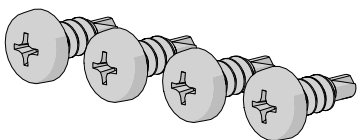

- 5** Step Drill

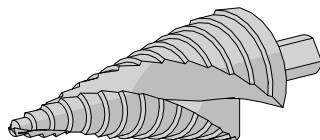

- 6** Spirit Level

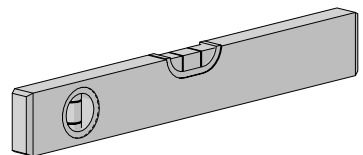

- 7** Measuring Tape

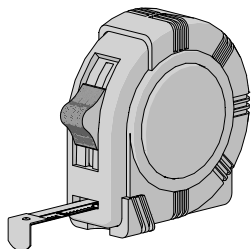

- 8** Pencil

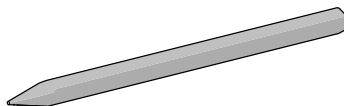

- 9** Allen Key Set

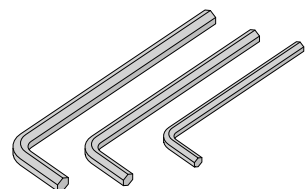

## PRE-ASSEMBLED AWNING COMPONENTS

Note: Images shown below are indicative only and will vary with system requirements.

Brackets

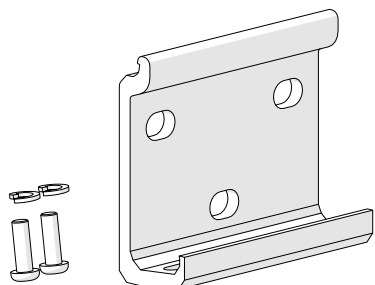

Assembled Awning

**FACE FIX**

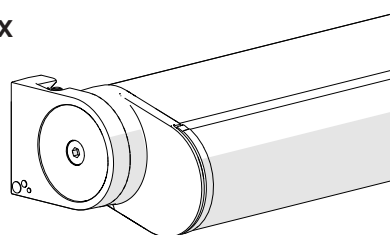

OR

**TOP FIX**

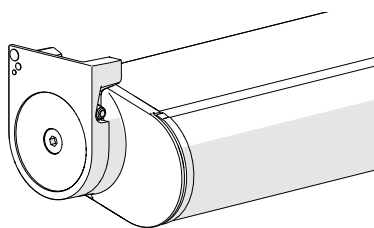

### IMPORTANT

#### INSTALLERS RESPONSIBILITY:

Before installing, please read & ensure you understand the safety information and installation instructions as defined in this installation manual.

- If you do not fully understand these instructions, contact Rollease Acmeda for clarification before installing.
- The Installer is responsible to ensure that all installation personnel have been adequately trained on the safe & correct installation and operation.
- The Installer is responsible to ensure that a Job Safety Analysis or Safe Work Method Statement is completed prior to installation to identify hazards, to determine appropriate risk control measures and to implement the control measures.
- The Installer is responsible to ensure that supporting structures are sound and can adequately support the load.
- The Installer is responsible to ensure that the devices used to anchor the product to the supporting structure are suitable for the application.

#### SAFETY INFORMATION:

- Ensure Job Safety Analysis/Safe Work Method Statement is completed and actions to reduce risks are implemented.
- Ensure that electrical works are done only by a LICENSED ELECTRICIAN.
- DO NOT modify any of the components of this system.
- Only suitable trained/qualified personal should undertake installation.

## MOUNTING ORIENTATION

## BRACKET

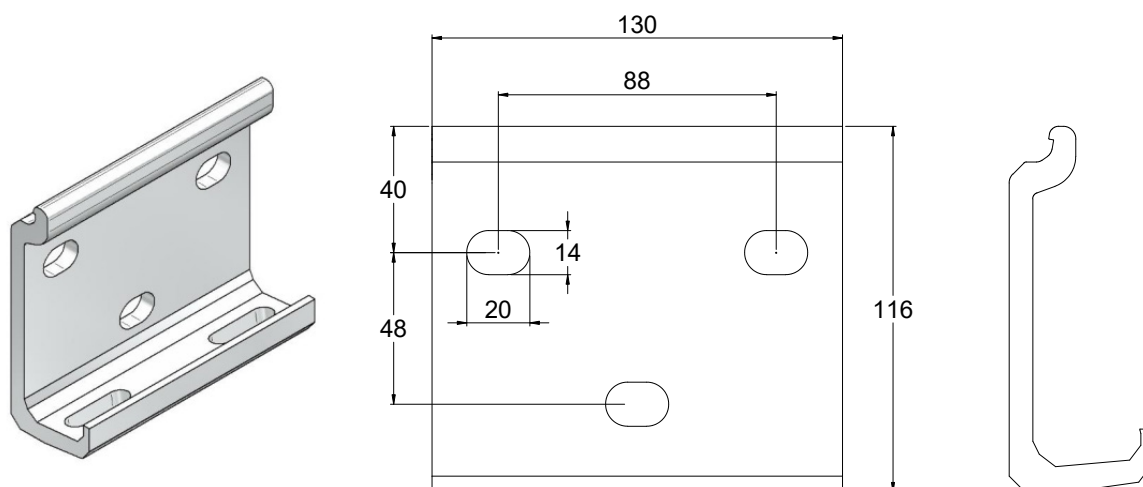

## FACE FIX

Define the distance of the brackets and position them on the awning assembly frame.

L is the width of the awning.

Use anchors M10, or at most M12.

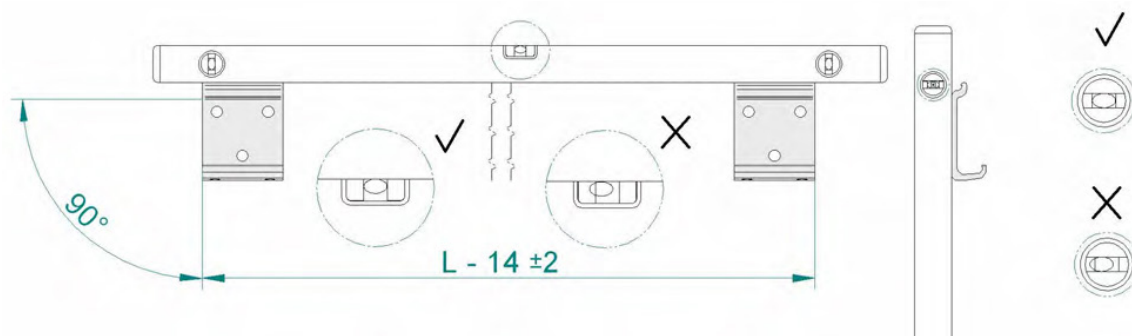

## TOP FIX

Define the distance of the brackets and position them on the awning assembly frame.

L is the width of the awning.

Use anchors M10, or at most M12.

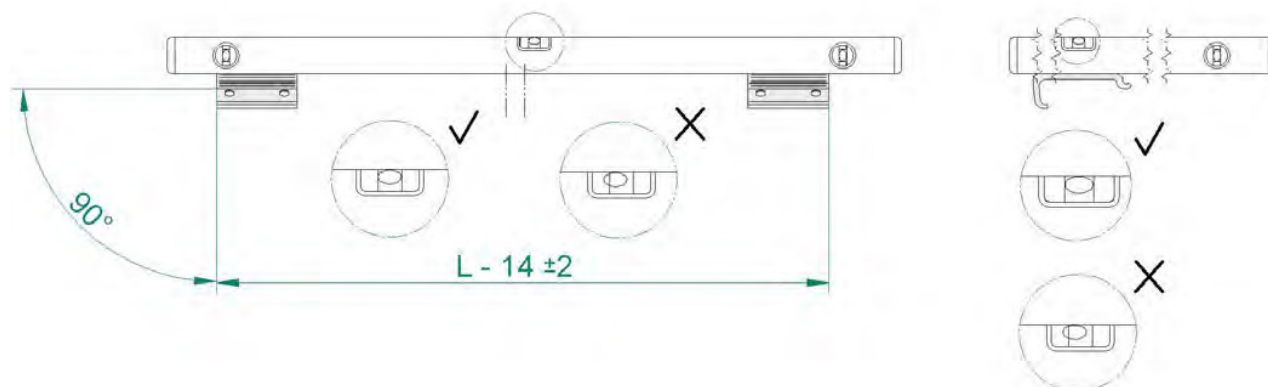

**END PLATE PREPARATION (IF REQUIRED)****! NOTE**

This step is typically completed during assembly. However, it is included here to guide installers in case a change in bracket orientation (Face Fix or Top Fix) is required during installation.

Fix the supports onto the levers by inserting the screw (A) in the hole provided using 10mm allen key.

**FACE FIX**

Insert the square nut into the slot (B).

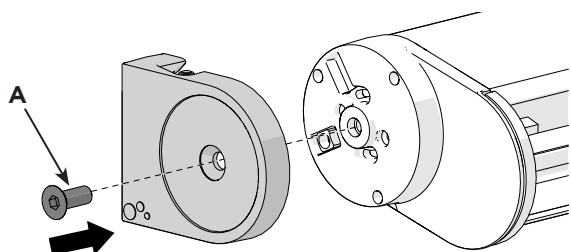
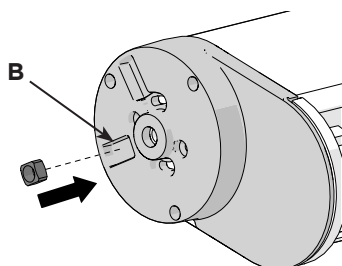
**TOP FIX**

Insert the square nut into the slot (C).

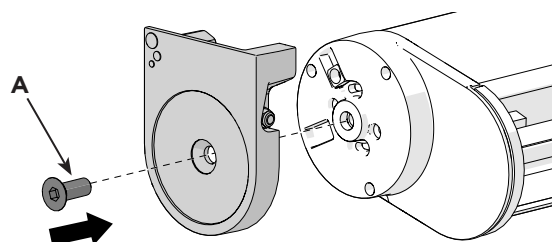
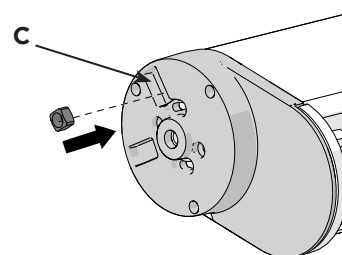
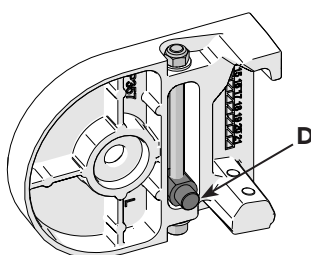
**! NOTE**

Set the regulating cylinder at minimum (D).

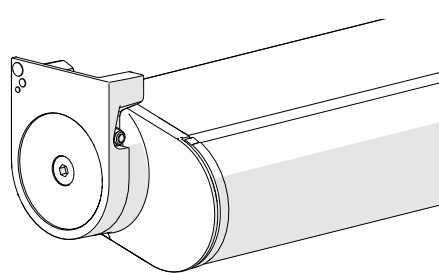
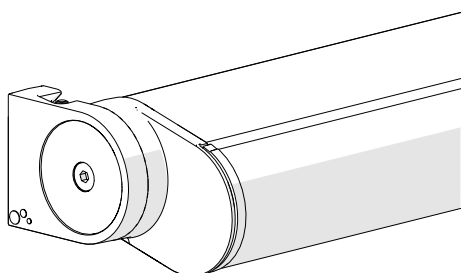

## AWNING INSTALLATION

- 1** Install the awning on the brackets fixed to the wall.

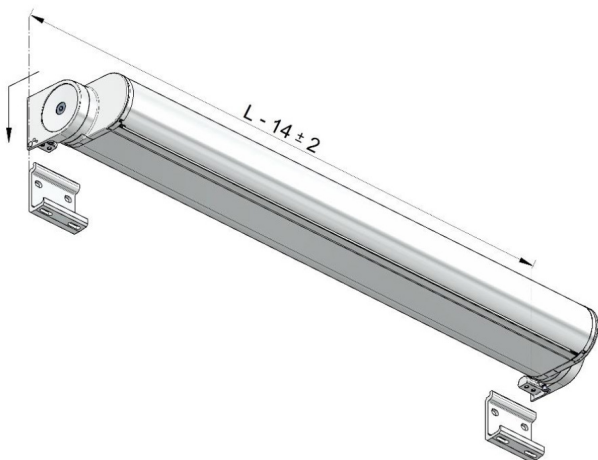

- 2** Secure the awning with the screws.

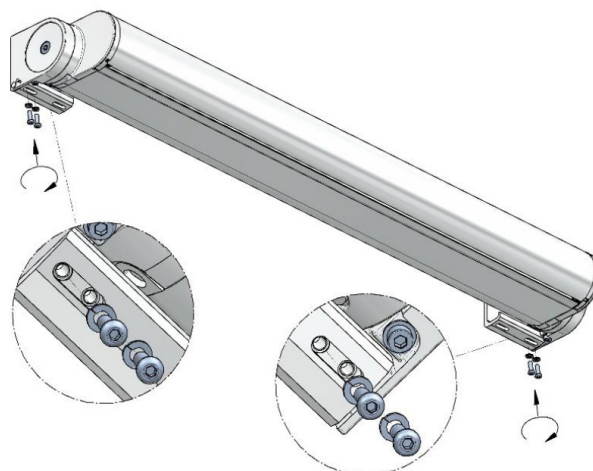

## AWNING ADJUSTMENT

- 1** Open the awning.



### IMPORTANT

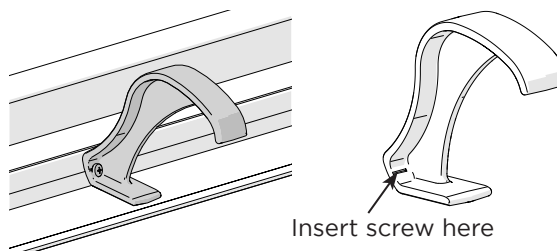

- Ensure the conveyor is attached to the centre of the awning using #8 X 16mm to 25mm screws.
- Pre-drilling into plastic is recommended.

- 2** Loosen the side screw.

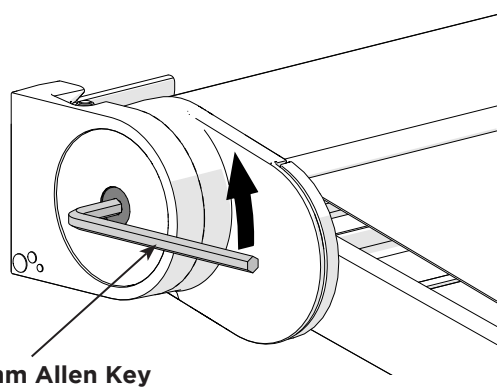

10mm Allen Key

**AWNING ADJUSTMENT (CONTINUED)**

- 3** Adjust the socket-head screw to raise or lower the terminal bar.

**NOTE**

- Support the weight of the Terminal Bar & Arms when adjusting the awning.
- Check that the terminal bar is perfectly horizontal.

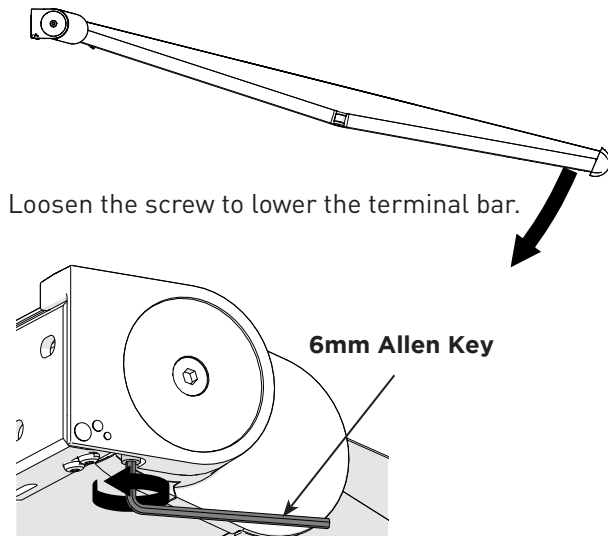
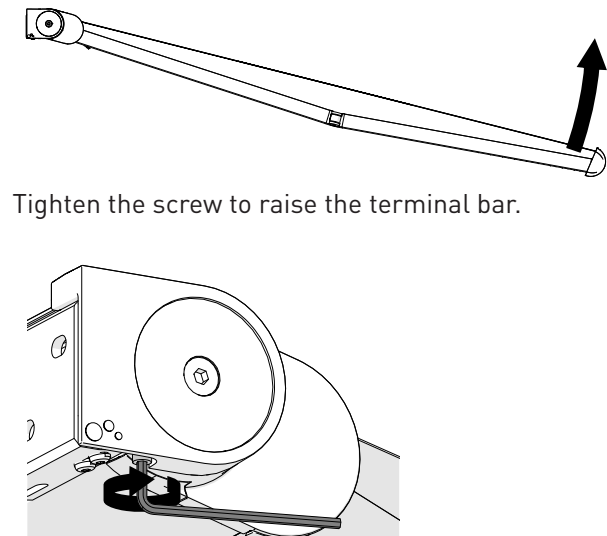
**LOWER****RAISE**

- 4** Firmly tighten the side screw.

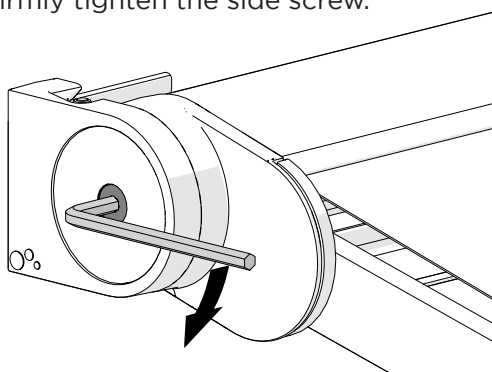

- 5** With the awning almost closed, check that the arms are parallel to the cassette.

If they are not parallel, tighten or slacken the dowel (E) in the lever using 3mm Allen Key.

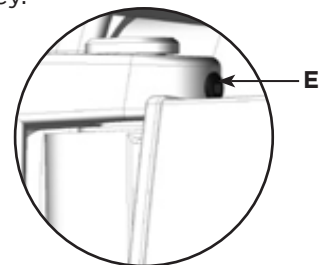



### APPENDIX A: DOCUMENT CHANGE NOTES

REVISION	CHANGES
v1.2   June 2025	Updated layout and some illustrations.