

OVERVIEW: RB08 SMALL CHAIN CONTROL S35 SYSTEM

The RB08 S35 MKII Chain Control System offers a solution for smaller roller blind applications.

AESTHETIC FEATURES

- Aesthetically well proportioned, compact design.
- Snap-on slim bracket cover.
- Minimal light gaps.

ASSEMBLY / INSTALLATION BENEFITS

- Improved chain retention.
- Universal Retro-Fit Booster, secures directly to winder.

FUNCTIONAL BENEFITS

- New S35 T-Spline Standard & Heavy Duty tubes with improved balance and performance.
- Blinds up to 6sqm or 5.5kgs

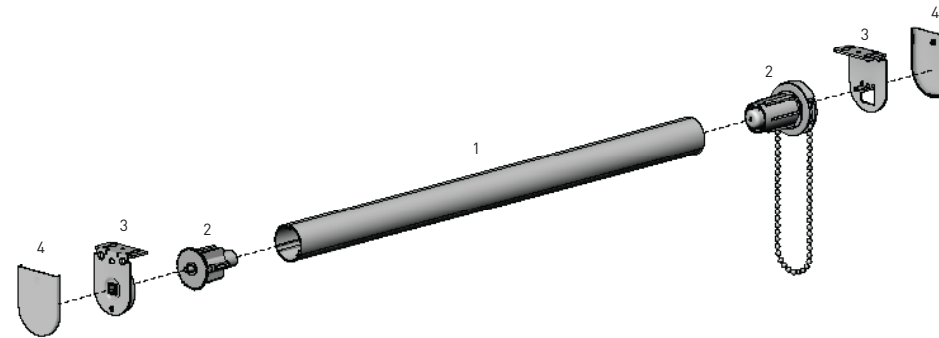

SYSTEM INDEX

1	Aluminium Tube - S35 RB93-033#-000580
2	Easy-Lock MKII Chain Winder & Auto Idler - S35 RB08-3501-xxx010
3	LX Easy-Lock Bracket RB08-8345-xxx030
4	LX / VX Bracket Cover Cap RB08-4141-xxx030

xxx= colour

= size

COLOUR RANGE

pure white 069	sandstone 269	barley 283	silver grey 338	black 050

SYSTEM OPTIONS

EASY-LIFT SPRING
ASSIST BOOSTER

MOUNTING RAIL

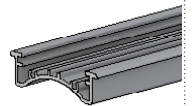

ADD ON SYSTEMS

FRS80 VALANCE SYSTEM

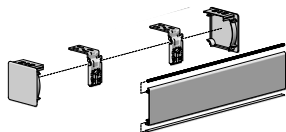

SQUARE BOX 85

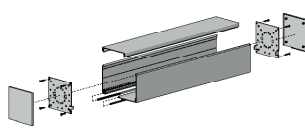

ROUND BOX 70

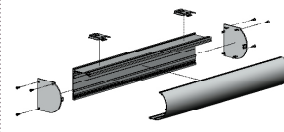

INTERNAL WIRE GUIDE



SPECIFICATIONS: RB08 SMALL CHAIN CONTROL S35 SYSTEM

SYSTEM CAPACITY

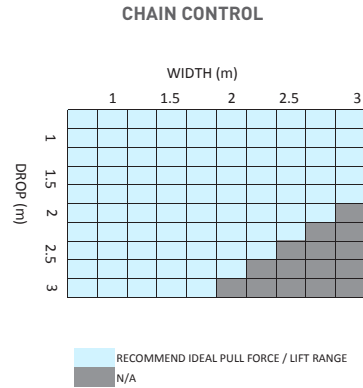

CHAIN CONTROL WITH BOOSTER

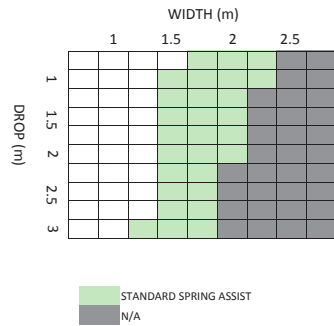

*Based on fabric weight of 420 grams per square meter, and oval base bar.

MAX ROLL

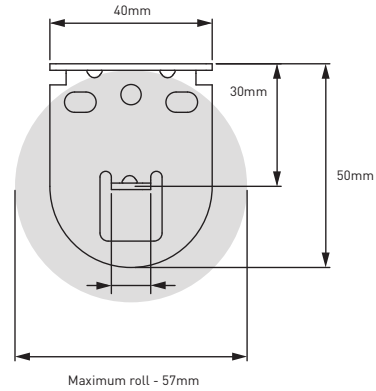

DEDUCTIONS

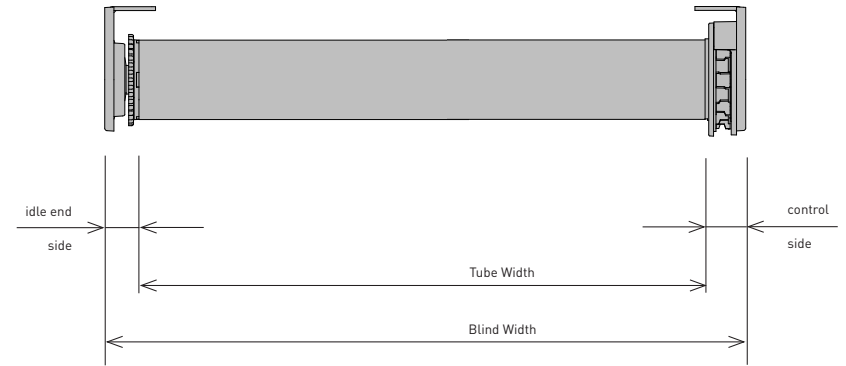

	IDLE END SIDE	CONTROL SIDE	OVERALL DEDUCTION
LX BRACKETS - with covers	14mm [0.55"]	17mm [0.66"]	31mm [1.22"]
LX BRACKETS - withOUT covers	13mm [0.51"]	15mm [0.59"]	28mm [1.10"]

ALUMINIUM TUBES

TUBE CAPACITY CHART

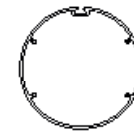
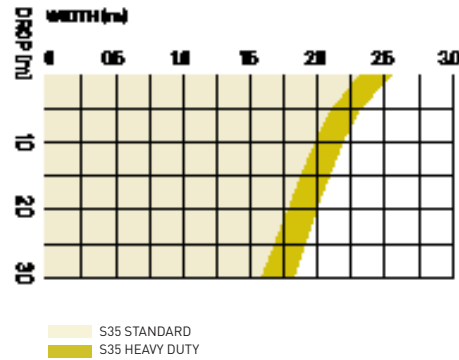

S35 STANDARD
T-Spline Tube

CODE: RB93-0333-000580
RB93-6333-000580 (with D/S tape)
O.D.: 33mm
Length: 5.8metres

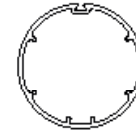

S35 HEAVY DUTY
T-Spline Tube

CODE: RB93-0335-000580
RB93-6335-000580 (with D/S tape)
O.D.: 34mm
Length: 5.8metres