

AUTOMATE™

Wirefree Li-ion Zero Q2

Ultra-quiet, rechargeable, battery-powered. This Wire-Free motor is perfect for medium to large shade applications.



PATENTED MOTOR HEAD DESIGN
A slim motor head for a minimal light-gap and a purpose-designed groove for the antenna cable.



INNOVATIVE MOTOR CAP
This optional, decorative cover ensures that all wires are completely out of sight.



ULTRA-QUIET
Variable speed and soft stop function makes this the quietest Automate motor yet.



ELEGANT SOFT STOP
Slows the motor down upon shade closure, rather than coming to a complete stop.



BATTERY CHECK ACTION
When paired with Push5 remote, motor will move shade to indicate battery percentage.



MICRO USB CHARGING
Custom motor charger not required. Utilise any micro USB cable and charger to renew battery.



SECURE HOLD
Motor head design accommodates bracket with a 12mm tongue for a more secure fit.



SIMPLIFIED RETRO-FIT
Motor can be swapped yet system retains deductions, bracket adjustments are eliminated and minimal light-gap is achieved.



5 YEAR WARRANTY



ARC™ (Automate Radio Communication) is Rollease Acmeda's proprietary technology utilising 433MHz radio communication with bi-directional feedback that brings Automate motorised shading systems together.



© Rollease Acmeda Pty Ltd

PRODUCT SPECIFICATIONS

Part #: MT01-1328-069002 Automate Wire-Free Li-ion Zero Q2

Voltage	5	Limit Switch Type	Electronic
Torque	2.0Nm	Current	1.25 A
Max Run Time	12 min.	Battery Size/Type	2600mAH
Speed	20 RPM (Adjustable to 24 or 28)	Temp Working Range	32°F to 140°F (0°C to 60°C)
Radio Frequency	433.92 MHz	Insulation Class	III
RF Modulation	FSK	Sound Level	~46 dB
IP Rating	IP44	Power	15 W

COMPATIBLE TUBES

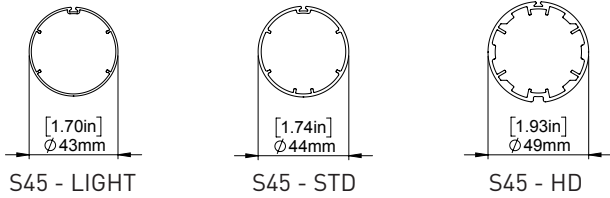

APPLICATIONS

- S45 Roller Shades
- Roman Shades

DIMENSIONS

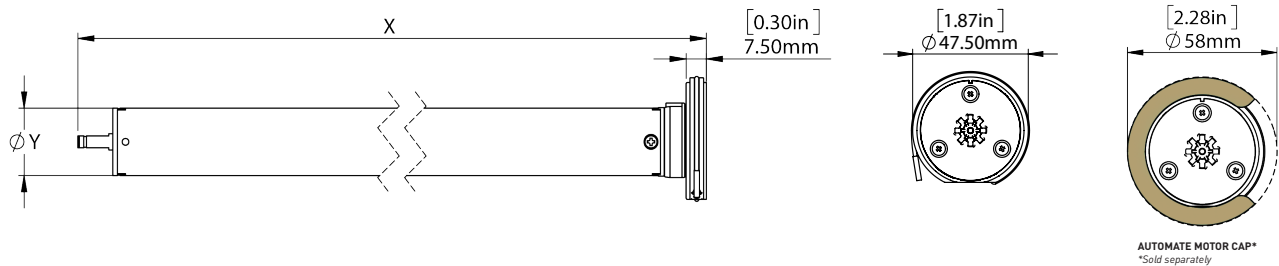

COMPATIBLE PRODUCTS (refer to catalog for full item listings)

Controllers



Charging Options

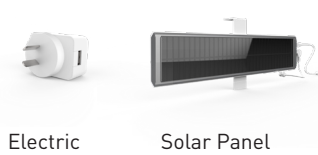

Motor Cap



Sensors

