

# External Rollers

## SECTION 1

### CORE HARDWARE

Box Cassettes	175
Open Brackets	176
Controls	177
Tubes	178
Weight Bars	180

## SECTION 2

### SIDE GUIDE OPTIONS

Zipscreen	183
Pivot Arm	184
Wire Guide	184

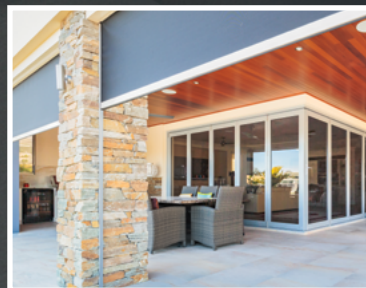

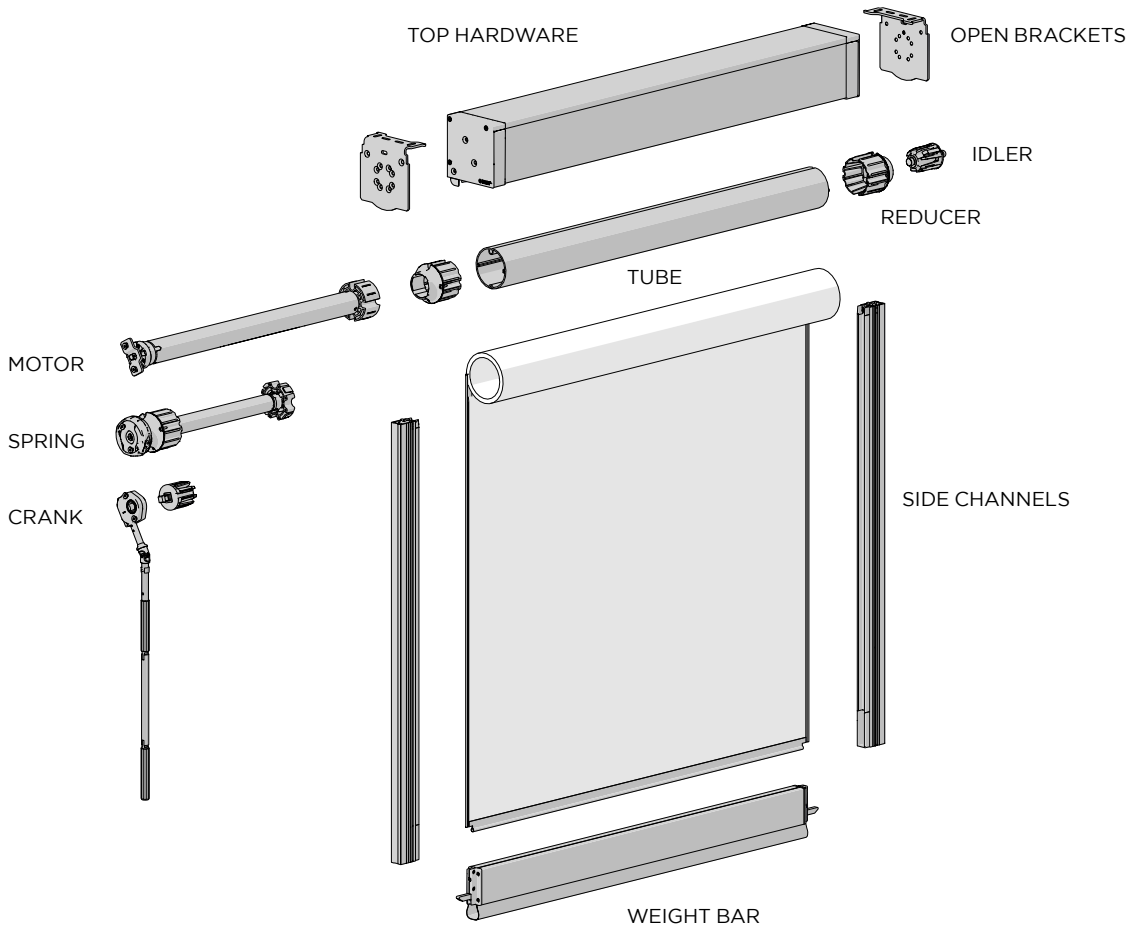

COLOUR RANGE

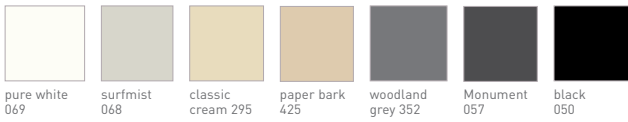

SYSTEM OPTIONS

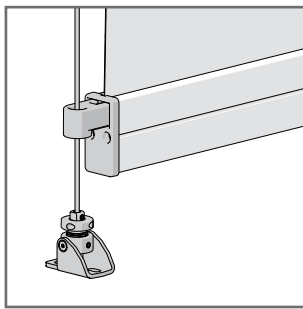

WIRE GUIDE

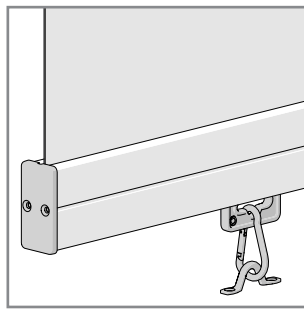

STRAIGHT DROP

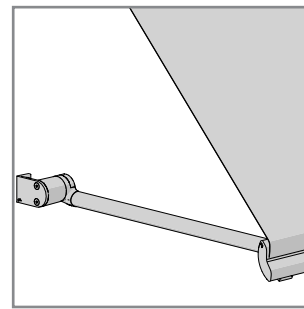

PIVOT ARM

System	Top Hardware			Tubes				Controls			W.Bars		
	Box 120	Box 190	Open	78mm	110mm	130mm	160mm	Spring	Crank	Motor	F56	F72	Pivot
Zipscreen	✓	✓	✓	✓	✓	✓		✓	✓	✓	✓	✓	
Wire Guide	✓	✓	✓	✓	✓	✓	✓		✓	✓	✓	✓	
Straight Drop	✓	✓	✓	✓	✓	✓			✓	✓	✓	✓	
Pivot Arm	✓		✓	✓					✓	✓			✓

**CASSETTE**

**BOX 120**

**BOX 120 END PLATE SET  
LH & RH**

TYPE.	Mill 000	Colours - refer below
CODE.	RE01-1101-000120	RE01-1101-xxx120
PACK.	4   16 Pairs	4   16 Pairs

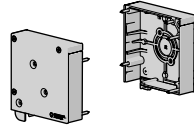

COLOUR. Refer to range on system overview page, (excl. anodised 018), s/grey 338  
USE WITH. Box 120 Back, Box 120 Full Cover, Box 120 Fascia

**BOX 120 BACK**

Colours include protective film | 4.2m & 5.8m Lgth

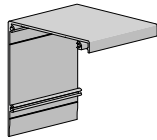

TYPE.	mill 000	anodised 018	Colours - refer below
PRICE.			
CODE.	RE01-0101-000420	RE01-0101-018420	RE01-0101-xxx420-PF
CODE.	1   16 Lgths	1   16 Lgths	1   16 Lgths

TYPE.	mill 000	anodised 018	Colours - refer below
PRICE.			
CODE.	RE01-0101-000580	RE01-0101-018580	RE01-0101-xxx580-PF
PACK.	1   16 Lgths	1   16 Lgths	1   16 Lgths

COLOUR. Refer to colour range on system overview page.

**BOX 120 FRONT COVER | FULL**

Colours include protective film | 4.2m & 5.8m Lgth

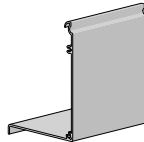

TYPE.	mill 000	anodised 018	Colours - refer below
PRICE.			
CODE.	RE01-0102-000420	RE01-0102-018420	RE01-0102-xxx420-PF
CODE.	2   32 Lgths	2   32 Lgths	2   32 Lgths

TYPE.	mill 000	anodised 018	Colours - refer below
PRICE.			
CODE.	RE01-0102-000580	RE01-0102-018580	RE01-0102-xxx580-PF
PACK.	2   32 Lgths	2   32 Lgths	2   32 Lgths

COLOUR. Refer to colour range on system overview page.

**BOX 120 FRONT COVER | SEMI**

Colours include protective film | 5.8m Lgth

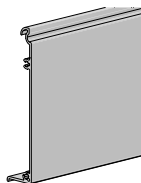

TYPE.	mill 000	anodised 018	Colours - refer below
PRICE.			
CODE.	RE01-0103-000580	RE01-0103-018580	RE01-0103-xxx580-PF
PACK.	4   64 Lgths	4   64 Lgths	4   64 Lgths

COLOUR. Refer to colour range on system overview page.  
USE WITH. Box 120 Back, Box 120 End Plate Set

**CASSETTE**

**BOX 190**

**BOX 190 TWO-SIDE END PLATE SET  
+Screws**

TYPE.	mill 000	Colours - refer below
PRICE.		
CODE.	RE01-1105-000001	RE01-1105-xxx001
PACK.	1   5 Sets	1   5 Sets

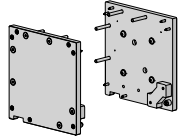

COLOUR. Black 050, white 069, monument 057  
USE WITH. Box190 extrusion, extr. bkt adaptors, wire guide adaptor plate, uni.bracket

**BOX 190 FRONT COVER**

Colours include protective film | 7.0m Lgth

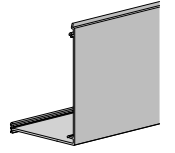

TYPE.	mill 000	Colours - refer below
PRICE.		
CODE.	RE01-0107-000700	RE01-0107-xxx700-PF
PACK.	1   12 Lgths	1   12 Lgths

COLOUR. Black 050, pure white 069, monument 057  
USE WITH. Box 190 Universal Extrusion, Box 190 Two-Side End Plate Set

**BOX 190 UNIVERSAL EXTRUSION**

Colours include protective film | 7.0m Lgth

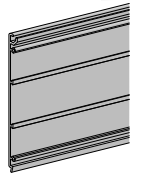

TYPE.	mill 000	Colours - refer below
PRICE.		
CODE.	RE01-0106-000700	RE01-0106-xxx700-PF
PACK.	1   24 Lgths	1   24 Lgths

COLOUR. Black 050, pure white 069, monument 057  
USE WITH. Box 190 Front Cover & Box 190 Two-Side End Plate Set

**BOX 190 UNIVERSAL BRACKET EXTRUSION**

100mm extrusion has pre-drilled holes

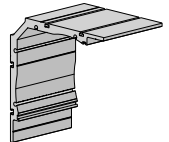

SIZE.	100mm	4m
PRICE.		
CODE.	RE01-1105-020100	RE01-1104-000400
PACK.	2   10 Pcs	1   8 Lgths

COLOUR. Mill finish 000, Anodised 020  
USE WITH. Box 190 Universal Extrusion

**FOAM TAPE**

1.6mm x 9.0mm | 45m Roll

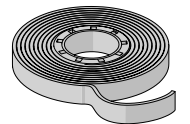

PRICE.	
CODE.	SB91-0516-050009
PACK.	45   450 Metres

COLOUR. Black 050  
USE WITH. Box 190 Universal Extrusion, Box 190 Front Cover

**FABRIC BRUSH T SLOT FIT**

10m x 4.8mm | 200m Roll



PRICE.	
CODE.	SB91-0012-050300
PACK.	300   1200 Lm

COLOUR. Black 050  
USE WITH. Box 190 Front Cover, Universal Bracket Extrusion

OPEN BRACKETS

**OPEN BRACKETS | ROUND | 78MM**

TYPE.	S/S Satin	steel (Colours below)
PRICE.		
CODE.	RE01-3021-012000	RE01-3020-xxx000
PACK.	2   20 Sets	2   20 Sets

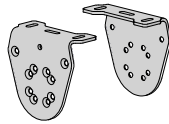

COLOUR. Refer to colour range on system overview page  
 USE WITH. Idler/Spring Adaptor

**OPEN BRACKETS | SQUARE | 78MM**

TYPE.	S/S Satin	steel (Colours below)
PRICE.		
CODE.	RE01-3031-012000	RE01-3030-xxx000
PACK.	2   16 Set	2   16 Set

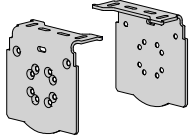

COLOUR. Refer to colour range on system overview page  
 USE WITH. Idler/Spring Adaptor

**ZIPSCREEN | OPEN BRACKET KIT | S100**

Universal + Screws

TYPE.	Polished SS
PRICE.	
CODE.	SB03-1301-009190
PACK.	1   4 Kit

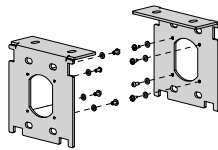

COLOUR. Stainless steel- polished 009  
 USE WITH. Extreme Bracket Adaptor Kit

**TOP/FACE FIX BRACKET SET | S100**

& Adaptor

TYPE.	Mill	Colour
PRICE.		
CODE.	RB80-1201-000109	RB80-1201-xxx109
PACK.	1   12 Sets	1   12 Sets

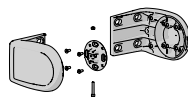

COLOUR. Pure white 069, black 050, mill finish 000  
 USE WITH. Zamak Adapter, Extreme Bearing Idler

**RECESS FIX BRACKET KIT | MOTOR | S100**

Side / Recess Fix

TYPE.	Zinc plated	Colours - refer below
PRICE.		
CODE.	RB80-0478-025100	RB80-0478-xxx100
PACK.	1   10 Sets	1   10 Sets

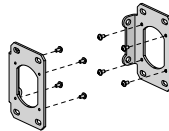

COLOUR. Pure white 069, black 050  
 USE WITH. Extreme Bracket Adaptor Kit



**CONTROL SPRINGS 78MM TUBES**

**EXTERNAL BOOSTER V2 | 45MM**  
with bracket adaptor and screws

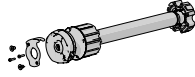

TYPE.	Compact	Light	Standard
PRICE.			
CODE.	RE01-0421-050001	RE01-0421-050002	RE01-0421-050003
PACK.	4   40 Pcs	4   40 Pcs	4   40 Pcs
TYPE.	Heavy Duty	Extra Heavy Duty	Ultra Heavy Duty
PRICE.			
CODE.	RE01-0421-050004	RE01-0421-050005	RE01-0421-050006
PACK.	4   40 Pcs	4   40 Pcs	4   40 Pcs

COLOUR. Black 050 only  
USE WITH. 78mm Tube, Box 120, Open Brackets

**EXTERNAL PULL STICK | ADJUSTABLE W/WALL CLIP**



PRICE.	
CODE.	RE01-0420-050000
PACK.	10   50 Kit

COLOUR. Black 050  
USE WITH. Spring controlled systems with weight bar handles

**CONTROL CRANKS 78MM TUBES**

**CRANK OPERATION GEAR - RATIO 5:1**  
with fixing screws

TYPE.	mill finish	Black
PRICE.		
CODE.	RE01-0513-000003	RE01-0513-050003
PACK.	5   50 Kit	5   50 Kit

COLOUR. Black 050, mill 000  
USE WITH. Locks, tie downs or Pivot arms only

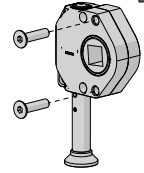

**CRANK OPERATION GEAR - RATIO 8:1**  
with fixing screws

TYPE.	mill finish	Black
PRICE.		
CODE.	RE01-0517-000003	RE01-0517-050003
PACK.	5   50 Kit	5   50 Kit

COLOUR. Black 050, mill 000  
USE WITH. Locks, tie downs or Pivot arms only

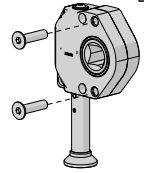

**RE01 GEAR | UNIVERSAL JOINT**

PRICE.	
CODE.	RE01-0510-020000
PACK.	10   100 Pcs

COLOUR. Anodised 020  
USE WITH. Crank Gear, Control Arm

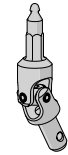

**CRANK ADAPTOR | 45MM**

PRICE.	
CODE.	RE01-0502-050045
PACK.	5   100 Pcs

COLOUR. Black 050 only  
USE WITH. Crank Operation Gear, 45mm reducer, 45mm to 78mm Crown

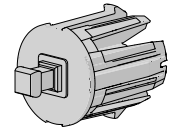

**GEAR/CRANK OPERATION CONTROL ARM**



SIZE.	100cm	150cm	200cm
PRICE.			
CODE.	RB05-9101-050100	RB05-9101-050150	RB05-9101-050200
PACK.	5   100 Pcs	5   100 Pcs	5   100 Pcs

SIZE.	100cm	150cm	200cm
PRICE.			
CODE.	RB05-9101-340100	RB05-9101-340150	RB05-9101-340200
PACK.	5   100 Pcs	5   100 Pcs	5   100 Pcs

COLOUR. Grey 340, black 050  
USE WITH. Crank Operation Gear, Gear/Crank Operation Arm Support

**GEAR/CRANK OPERATION ARM SUPPORT**

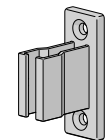

PRICE.	
CODE.	RB05-9102-xxx000
PACK.	5   100 Pcs

COLOUR. Grey 340, black 050  
USE WITH. Gear/Crank Operation Control Arm

**CONTROL MOTORS 78MM TUBES**

**AUTOMATE | ARC FT MOTOR WITH CLIP**  
[Ø45/15Nm/15rpm]

TYPE.	Std Cable	Long Cable
CODE.	MT01-1145-050001	MT01-1145-050012
PACK.	1   10 Piece	1   10 Piece

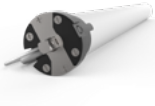

COLOUR. Pure white 069  
USE WITH. 78mm Alu/Steel Tube, 78mm Automate Drive & Crown Wheel

**AUTOMATE DRIVE WHEEL 78MM**  
Impact Detection

PRICE.	
CODE.	RE01-0680-050508
PACK.	5   100 Pcs



COLOUR. Black 050  
USE WITH. Automate FT Motor, 78mm Alu/Steel Tube

**AUTOMATE 78MM DRIVE WHEEL V2**

PRICE.	
CODE.	MT03-0106-050006
PACK.	5   50 Pcs



COLOUR. Black 050  
USE WITH. Automate FT motor, 78mm Tubes

**CONTROL MOTORS 110/130MM TUBES**

**AUTOMATE | AX30 30NM MOTOR AU [Ø45/240V/15RPM]**  
2.5m Cable

CODE.	MT01-1145-069013
PACK.	1   10 Pcs



COLOUR. Pure white 069  
USE WITH. Extreme Crown Wheel, Extreme Drive Wheel, Drive Adaptor Kit.

**AUTOMATE | AX50 50NM MOTOR AU [Ø45/240V/12RPM]**  
2.5m Cable

CODE.	MT01-1145-069015
PACK.	1   10 Pcs



COLOUR. Pure white 069  
USE WITH. Extreme Crown Wheel, Extreme Drive Wheel, Drive Adaptor Kit.

**AUTOMATE | 50NM MOTOR DRIVE ADAPTOR KIT**

CODE.	MT03-0198-025008
PACK.	1   100 Set

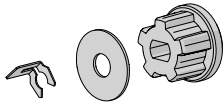

COLOUR. Silver zinc plated 025  
USE WITH. AX30 & AX50 Motors, Extreme Drive Wheel

**EXTREME DRIVE WHEEL | S100**

PRICE.	
CODE.	RB80-0301-073100
PACK.	1   8 Pcs

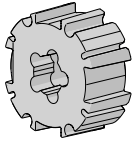

COLOUR. Grey cloud 073 only  
USE WITH. Aluminium Tube S100-110STD & 130HD, Automate Motor, Drive Adapt. Kit

**EXTREME CROWN WHEEL | S100**

PRICE.	
CODE.	RB80-0701-073100
PACK.	1   12 Pcs

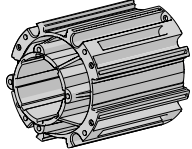

COLOUR. Grey cloud 073 only  
USE WITH. Aluminium Tube S100-100STD & 130HD, Automate Motor

**UNIVERSAL ZAMAK ADAPTOR**  
With Lock Ring & M8x16 Screws

PRICE.	
CODE.	RB56-0762-014050
PACK.	1   20 Sets

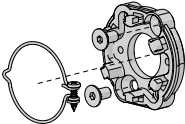

COLOUR. Cast silver 014 only  
USE WITH. Extreme Square Motor Bracket Plate

**78MM ALUMINIUM TUBE V2 W/ SCREW FEATURES**

4.2m & 5.8m Lgths

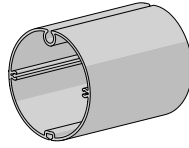

TYPE.	STD- 4.2m	STD- 5.8m	HD- 5.8m
PRICE.			
CODE.	RE01-0377-000420	RE01-0377-000580	RE01-0380-000580
PACK.	2   24 Lgths	2   24 Lgths	2   24 Lgths

COLOUR. Mill finish only  
 USE WITH. 78/45mm Reducer, 78/45mm Crown, #6 Zip, 7mm Spline

**STEEL TUBE 78MM**

4.8m & 7m Lgths

SIZE.	4.8m (Steel)	7.0m (Steel)
PRICE.		
CODE.	AW92-0901-000480	AW92-0901-000700
PACK.	28 Lgths	28 Lgths

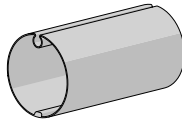

COLOUR. Mill finish only  
 USE WITH. 78mm Reducer, 78mm Tube Adaptor, 7mm Spline

**ALUMINIUM TUBE 78MM**

4.2m, 5.8m & 6.0m Lgths

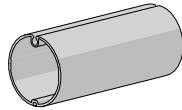

TYPE.	STD- 4.2m	STD- 5.8m	HD- 6.0m
PRICE.			
CODE.	RE01-0378-000420	RE01-0378-000580	RE01-0379-000600
PACK.	2   20 Lgths	2   20 Lgths	2   20 Lgths

COLOUR. Mill finish only  
 USE WITH. 78mm Reducer, 78mm Tube Adaptor, 7mm Spline

**ZIPSCREEN REDUCER 78MM TO 45MM W/SCREW**

PRICE.	
CODE.	RE20-0311-050178
PACK.	4   100 Pcs

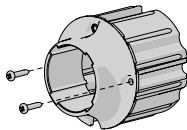

COLOUR. Black 050 only  
 USE WITH. 78mm Tubes, 45mm Bearing Idler, 45mm Crank Adaptor, 45mm Motors

**CROWN | 45MM TO 78MM TUBE W/ SCREWS**

PRICE.	
CODE.	MT03-0106-050005
PACK.	5   50 Pcs

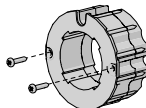

COLOUR. Black 050 only  
 USE WITH. 78mm Tubes, 45mm Bearing Idler, 45mm Crank Adaptor, 45mm Motors

**BEARING IDLER | 45MM**

PRICE.	
CODE.	RE01-0213-050045
PACK.	10   50 Pcs

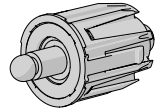

COLOUR. Black 050  
 USE WITH. 45mm Reducer, 45mm Crown

**IDLER/SPRING ADAPTOR MKII**

PRICE.	
CODE.	RE01-0214-050000
PACK.	5   200 Sets

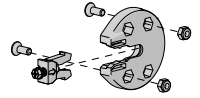

COLOUR. Black 050  
 USE WITH. 45mm or 63mm Bearing Idler, 63mm Booster, Box 120, Open Brackets

**TUBES** S100

**ALUMINIUM TUBE | S100 - 110 STANDARD**  
O.D 110mm x 7.0mt Lgth

PRICE.	
CODE.	RB93-0110-000700
PACK.	2   12 Lgths



COLOUR. Mill finish 000  
USE WITH. Tube End Plates, Extreme Crown & Idler

**ALUMINIUM TUBE | S100 - 130 HEAVY DUTY**  
O.D 130mm x 7.0mt Lgths

PRICE.	
CODE.	RB93-0130-000700
PACK.	1   9 Lgths

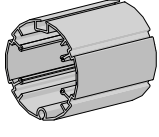

COLOUR. Mill finish 000  
USE WITH. Tube End Plates, Extreme Crown & Idler

**ALUMINIUM TUBE | S100 - 160 EXTRA HEAVY DUTY**  
O.D 160mm x 7mt Lgth

PRICE.	
CODE.	RB93-0160-000700
PACK.	1   6 Lgths

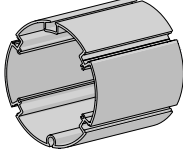

COLOUR. Mill finish 000  
USE WITH. Tube End Plates, S100 - 130 HD Tube (Internal Sleeve)

**ZIPSCREEN | REDUCER END PLATE SET | S100**  
2 Piece Set + screws

TYPE.	110 Standard	130 Heavy Duty
PRICE.		
CODE.	RB80-0501-050110	RB80-0501-050130
PACK.	2   100 Sets	2   100 Sets

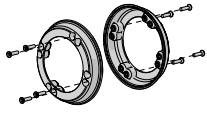

COLOUR. Black 050 only  
USE WITH. S100 Aluminium Tube - 110mm & 130mm

**WIREGUIDE | TUBE END PLATE | S100**  
2 Piece Set + screws

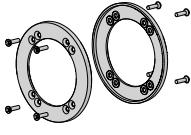

TYPE.	110 Standard	130 Heavy Duty	160 Extra Heavy Duty
PRICE.			
CODE.	RB80-0601-073110	RB80-0601-073130	RB80-0601-073160
PACK.	1   40 Set	1   40 Set	1   40 Set

COLOUR. Grey cloud 073  
USE WITH. S100 Aluminium Tube- 110mm, 130mm & 160mm

**EXTREME BEARING IDLER | UNIVERSAL | S100**  
15mm Extendable Square Shaft & screws

PRICE.	
CODE.	RB80-0202-073100
PACK.	1   12 Pcs

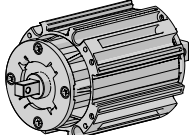

COLOUR. Grey cloud 073 only  
USE WITH. Extreme Bracket Set or Plate, Aluminium Tube S100-110STD & 130HD

**EXTREME BRACKET ADAPTOR KIT (MOTOR & IDLER PLATE)**  
[+ screws]

PRICE.	
CODE.	RB80-1503-xxx110
PACK.	1   10 Kit

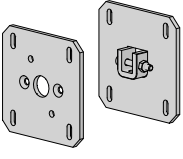

COLOUR. Pure white 069, black 050  
USE WITH. Ex. Bearing Idler, Zamak Adpt, Box 190, Extreme Open/Recess Fix Brkt

**TUBES/WEIGHT BAR** FABRIC ATTACHMENT

**ZIP | NO.6 GAUGE**  
Double Sided - 1 Roll = 200Mts

PRICE.	
CODE.	SH91-0135-050200
PACK.	200   400 Mts



COLOUR. Black 050  
USE WITH. Fabric Attachment for 78mm Aluminium Tubes.

**7.2MM SPLINE WITH 15MM TAIL**  
100m Roll

PRICE.	
CODE.	SB91-0408-001015
PACK.	1   10 Rolls

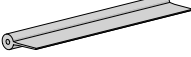

COLOUR. Clear 001  
USE WITH. Weight Bar, Tubes

**FABRIC SPLINE WITH 15MM TAIL**  
100m Roll

TYPE.	7mm
PRICE.	
CODE.	SB91-0409-050015
PACK.	1   10 Rolls

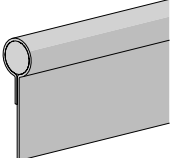

COLOUR. Black 050  
USE WITH. Weight Bar, Tubes



**F56 WEIGHT BAR**

26mm x 56mm | 4.2m & 5.8m | Colours incl. protective film

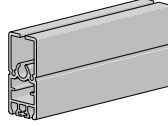

TYPE.	mill 000	anodised 018	Colours - refer below
-------	----------	--------------	-----------------------

PRICE.			
--------	--	--	--

CODE.	RE15-0101-000420	RE15-0101-018420	RE15-0101-xxx420-PF
-------	------------------	------------------	---------------------

PACK.	2   48 Lgths	2   48 Lgths	2   48 Lgths
-------	--------------	--------------	--------------

TYPE.	mill 000	anodised 018	Colours - refer below
-------	----------	--------------	-----------------------

PRICE.			
--------	--	--	--

CODE.	RE15-0101-000580	RE15-0101-018580	RE15-0101-xxx580-PF
-------	------------------	------------------	---------------------

PACK.	2   48 Lgths	2   48 Lgths	2   48 Lgths
-------	--------------	--------------	--------------

COLOUR. Refer to colour range on system overview page.  
 USE WITH. F56 End Caps

**WIRE GUIDE F56 WEIGHT BAR END CAP SET + SCREWS**

PRICE.	
CODE.	RE15-0601-xxx001
PACK.	5   200 Sets

COLOUR. Black 050, pure white 069  
 USE WITH. F56 Weight Bar, 3.2mm Wire

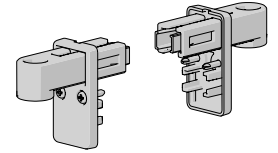

**F72 MULTI-BAR END CAPS | WIRE GUIDE + SCREWS**

PRICE.	
CODE.	RE15-0522-xxx000
PACK.	5   200 Set

COLOUR. Black 050, pure white 069  
 USE WITH. F72 Weight Bar, 3.2mm Wire, 4mm Wire

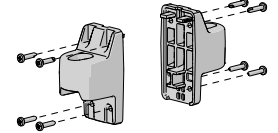

**F72 HD EXTERNAL WEIGHT BAR**

31mm x 72mm | 7m | Colours include protective film

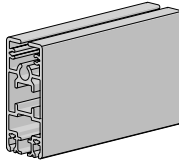

TYPE.	Mill Finish	Anodised 018	Colours - refer below
-------	-------------	--------------	-----------------------

PRICE.			
--------	--	--	--

CODE.	RE15-0112-000700	RE15-0112-018700	RE15-0112-xxx700-PF
-------	------------------	------------------	---------------------

PACK.	1   36 Length	1   36 Length	1   36 Length
-------	---------------	---------------	---------------

COLOUR. Refer to colour range on system overview page.  
 USE WITH. F72 End Caps

**F56 | ZIPSCREEN - LOCK END CAP SET + SCREWS**

PRICE.	
CODE.	RE20-0303-xxx002
PACK.	10   200 Set

COLOUR. Black 050, classic cream 295, pure white 069, paperbark 425  
 USE WITH. F56 Weight Bar

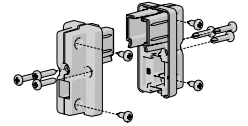

**F72 WEIGHT BAR END CAP SET + Screws**

PRICE.	
CODE.	RE15-0512-xxx000
PACK.	5   200 Sets

COLOUR. Black 050, pure white 069  
 USE WITH. F72 Weight Bar

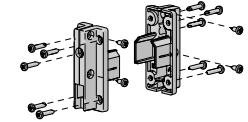

**F56 WEIGHT BAR PLAIN END CAP**

PRICE.	
CODE.	RE15-0501-050000
PACK.	5   200 Sets

COLOUR. Black 050  
 USE WITH. F56 weight bar

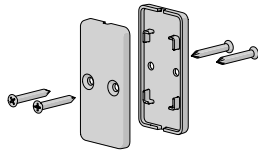

**F72 WEIGHT BAR PLAIN END CAP**

PRICE.	
CODE.	RE15-0540-050000
PACK.	5   200 Set

COLOUR. Black 050  
 USE WITH. F72 weight bar

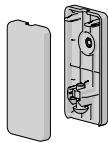

**25MM STRAP DOWN LOOP**

PRICE.	
CODE.	RE91-1102-050025
PACK.	10   1000 Pcs

COLOUR. Black 050 only  
USE WITH. F56 weight bar

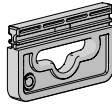

**16MM BUBBLE SEAL | F72**  
40lm Roll

PRICE.	
CODE.	SB91-0018-050040
PACK.	40   2000 Lm

COLOUR. Black 050  
USE WITH. F72 Weight Bar



**25MM FOOTMANS LOOP KIT | F72**

PRICE.	
CODE.	RE91-1111-013025
PACK.	5   100 Kit

COLOUR. S/Steel polished 013  
USE WITH. F72 weight bar

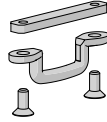

**ULTRA LOCK SEAL V3**  
50lm Roll

PRICE.	
CODE.	SB91-0008-050050
PACK.	50   500Lm

COLOUR. Black 050  
USE WITH. F56, F72 Weight bar, Zipscreen Ultra-Lock V2

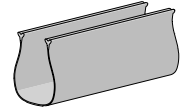

**STRAP DOWN PAD EYE SADDLE - 30MM**

PRICE.	
CODE.	RE91-1104-013030
PACK.	10   100 Pcs

COLOUR. Polished 304, stainless steel 013  
USE WITH. Straight drop spring clip - 50mm



**WEIGHT BAR BUBBLE SEAL PUSH FIT - 150M ROLL**

PRICE.	
CODE.	SB91-0013-050150
PACK.	150   1500 Lm

COLOUR. Black 050  
USE WITH. F56 & F72 Weight Bar

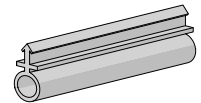

**25MM FOOTMANS LOOP**

PRICE.	
CODE.	RE91-1101-013025
PACK.	10   200 Pcs

COLOUR. Stainless steel 013  
USE WITH. 25mm strap down loop



**EXTERNAL WEIGHT BAR HANDLE**

PRICE.	
CODE.	SB07-2202-xxx000
PACK.	10   50 Sets

COLOUR. Polished stainless 013, dark electroplate 054  
USE WITH. F56 and F72 Weight Bar, Spring Systems

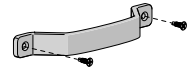

**FLUSH MOUNT STRAP DOWN LOOP**

PRICE.	
CODE.	RE91-1105-009000
PACK.	4   100 Piece

COLOUR. Polished Stainless Steel 316  
USE WITH. Spring Clip or Strap Loop



**ZIPSCREEN WEIGHT BAR HANDLE**

PRICE.	
CODE.	SB07-2203-050001
PACK.	20   100 Kits

COLOUR. Black 050  
USE WITH. F56 & F72 weight bar, Spring systems

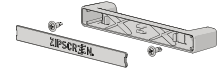

**25MM CAM BUCKLE & STRAP ASSEMBLY (60CM)**

PRICE.	
CODE.	RE91-0100-025025
PACK.	2   100 Pcs

COLOUR. Silver zinc plated 025 only  
USE WITH. 25mm straight drop loop

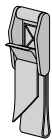

**WEIGHT BAR LOCK SET**

PRICE.	
CODE.	SB07-2103-050001
PACK.	10   100 Sets

COLOUR. Black 050  
USE WITH. Zipscreen & Channel Guide, F56/F72 Weight bar

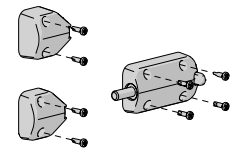

**STRAP DOWN SPRING CLIP - 50MM**

PRICE.	
CODE.	RE91-1103-009050
PACK.	10   200 Pcs

COLOUR. Stainless steel 009  
USE WITH. 25mm straight drop loop



**BALLAST - FLAT GALVANISED BAR**  
F56: 0.8kg/m F72: 1.6kg/m

TYPE.	20x5mm   Wrapped	25x8mm   Wrapped
PRICE.		
CODE.	SB91-1015-050200	SB91-1018-050200
PACK.	10   100 Lgths	5   50 Lgths

COLOUR. Black 050  
USE WITH. F56: 20x5mm, F72: 25x8mm

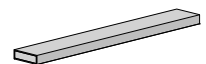

**BUBBLE SEAL STRIP**  
5.8m Lgth

TYPE.	10mm	16mm
PRICE.		
CODE.	SB91-0001-050580	SB91-0019-050580
PACK.	10   30 Lgths	20   200 Lgth

COLOUR. Black 050  
USE WITH. F56 Weight bar

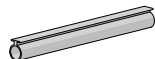

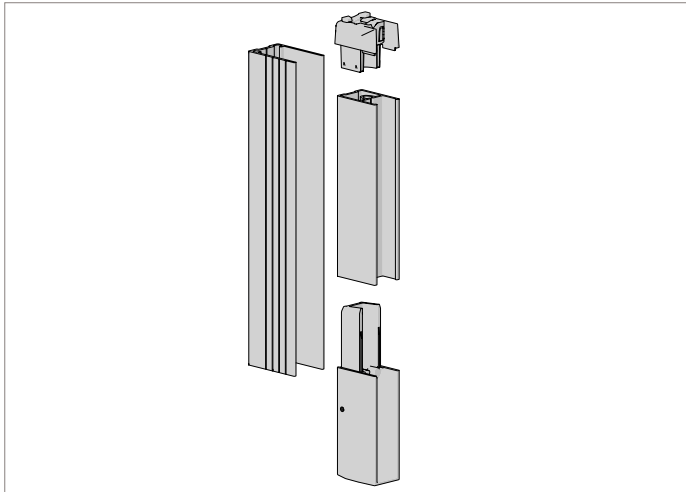

ZIPSCREEN | L FIXING RAIL

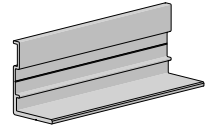

SIZE.	5.5 Metre Lgths	5.5 Metre Lgths	5.5 Metre Lgths
TYPE.	mill 000	anodised 018	Colour - refer below
PRICE.			
CODE.	SB04-0703-000550	SB04-0703-018550	SB04-0703-xxx550
PACK.	10   120 Lgths	10   120 Lgths	10   120 Lgths

COLOUR. Refer to colour range of system overview page  
 USE WITH. U Mounting Rail

ZIP | NO.6 GAUGE  
 Double Sided - 1 Roll = 200Mts



PRICE.	
CODE.	SH91-0135-050200
PACK.	200   400 Mts

COLOUR. Black 050  
 USE WITH. Fabric, Zip Inner Rail, 78mm Aluminium Tube

ZIPSCREEN | L FIXING RAIL FOR BOX 190

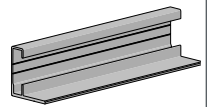

TYPE.	Mill 000	Colours - refer below
PRICE.		
CODE.	SB04-0708-000550	SB04-0708-xxx550-PF
PACK.	8   80 Lgths	8   80 Lgths

COLOUR. Refer to range on system overview page  
 USE WITH. Box 190, Extreme Open Brackets

ZIPSCREEN | ZIP INNER RAIL

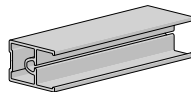

SIZE.	2.5 Metre Lgths
TYPE.	mill 000
PRICE.	
CODE.	SB04-0701-000250
PACK.	10   120 Lgths

SIZE.	5.5 Metre Lgths	5.5 Metre Lgths	5.5 Metre Lgths
TYPE.	mill 000	anodised 018	Colours - refer below
PRICE.			
CODE.	SB04-0701-000550	SB04-0701-018550	SB04-0701-xxx550
PACK.	10   120 Lgths	10   120 Lgths	10   120 Lgths

COLOUR. Refer to colour range on system overview page.  
 USE WITH. U Mounting Rail, Inner Rail Funnel & Stop Set, Inner Rail Bottom Cap Set

FIXING RAIL  
 40 x 40 x 3mm - 5.5m Lgth

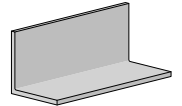

TYPE.	mill 000	colours - refer below
PRICE.		
CODE.	SB04-0704-000550	SB04-0704-xxx550
PACK.	2   10 Lgths	2   10 Lgths

COLOUR. Black 050, pure white 069  
 USE WITH. F56 & F72 Weight Bars

ZIPSCREEN | FUNNEL W/INTEGRATED STOP SET + SCREW

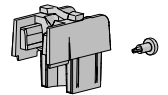

PRICE.	
CODE.	SB05-1412-050001
PACK.	50   500 Set

COLOUR. Black 050  
 USE WITH. Zip Inner Rail

ZIPSCREEN | U MOUNTING RAIL

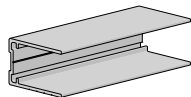

SIZE.	2.5 Metre Lgths
TYPE.	mill 000
PRICE.	
CODE.	SB04-0702-000250
PACK.	10   120 Lgths

SIZE.	5.5 Metre Lgths	5.5 Metre Lgths	5.5 Metre Lgths
TYPE.	mill 000	anodised 018	Colours - refer below
PRICE.			
CODE.	SB04-0702-000550	SB04-0702-018550	SB04-0702-xxx550-PF
PACK.	10   120 Lgths	10   120 Lgths	10   120 Lgths

COLOUR. Refer to colour range on system overview page.  
 USE WITH. Zip Inner Rail, L Fixing Rail, End Plate Set

ZIPSCREEN | ZIP INNER RAIL BOTTOM CAP SET  
 + Screw

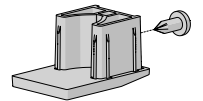

PRICE.	
CODE.	SB05-1511-050001
PACK.	10   500 Sets

COLOUR. Black 050 only  
 USE WITH. Zip Inner Rail

ULTRA LOCK V2 - KIT ASSEMBLY

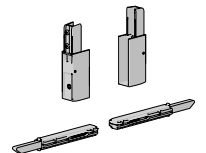

PRICE.	
CODE.	RE15-0422-050001
PACK.	5   50 Kit

COLOUR. Black 050  
 USE WITH. Weight Bar, Side Channels

ZIPSCREEN | FACE FIX - U MOUNTING RAIL  
 5.5 Metre Lgth

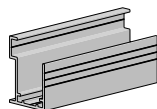

COLOUR.	mill 000	colours.
PRICE.		
CODE.	SB04-0705-000550	SB04-0705-xxx550
PACK.	8   120 Lgths	8   120 Lgths

COLOUR. Refer to colour range on system overview page.  
 USE WITH. Zip Inner Rail, End Plate Set

**PIVOT ARM**

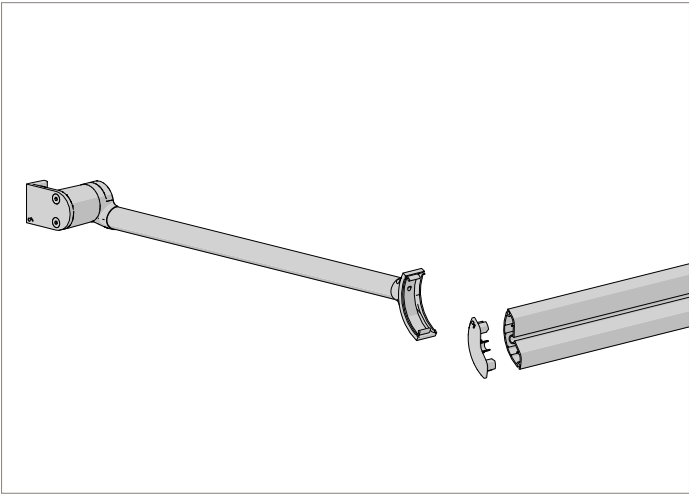

**PIVOT ARMS- 1.6M**  
1 Piece = 2 Arms

PRICE.	
CODE.	AW05-0701-xxx160
PACK.	1 Piece = 2 Arms

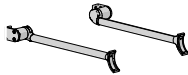

COLOUR. Pure white 069, black 050  
USE WITH. Pivot Arm Terminal Bar

**PIVOT ARM TERMINAL BAR**  
5m Length

TYPE.	Mill	Colours
PRICE.		
CODE.	RE29-0102-000500	RE29-0102-xxx500
PACK.	1   10 Lgths	1   10 Lgths

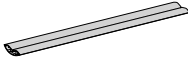

COLOUR. Mill 000, pure white 069, black 050  
USE WITH. Pivot Arms

**PIVOT ARM COVER CAP FOR TERMINAL BAR**

PRICE.	
CODE.	AW05-0801-xxx000
PACK.	1 Kit

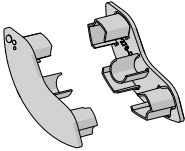

COLOUR. Pure white 064, black 050  
USE WITH. Pivot Arm Terminal Bar

**WIRE GUIDE 3.2MM** **EXT**

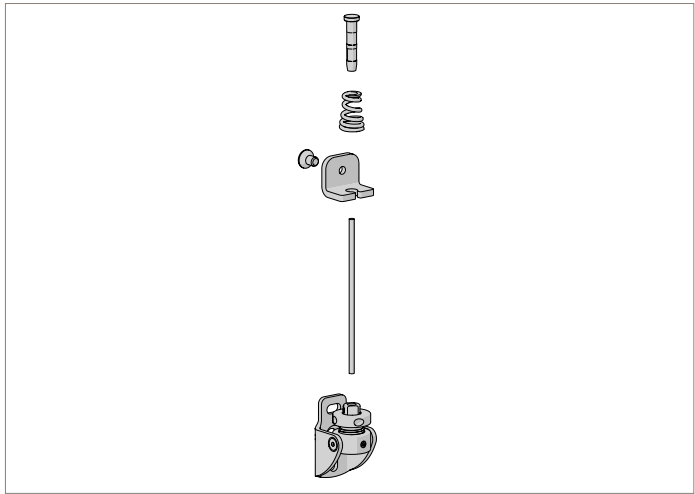

**WIRE GUIDE TOP SADDLE TERMINAL KIT + Spring**

PRICE.	
CODE.	RE24-4004-010032
PACK.	8   200 Sets

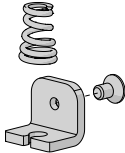

COLOUR. Stainless steel 010  
USE WITH. Brackets, Dome Stud Terminal

**SWAGED DOME STUD TERMINAL + 4.2 Metre Wire**

PRICE.	
CODE.	RE24-1312-009420
PACK.	4   40 Piece

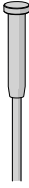

COLOUR. Polished stainless steel 009 only  
USE WITH. Wire Guide Top Terminal, Wire Guide Top Bracket, tensioning spring

**DOMED HEAD TERMINAL**  
3.2mm Wire

PRICE.	
CODE.	RE24-1312-009002
PACK.	20   200 Pcs



COLOUR. Polished stainless steel 009 only  
USE WITH. 3.2mm Wire Tensioning Guide, Crimping Die

**WIRE TENSIONING GUIDE - 3.2MM**  
Thread: 1 x 19 | 1 Roll = 50Mts

PRICE.	
CODE.	RB91-3602-010032
PACK.	50   300 Mts

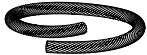

COLOUR. Natural stainless steel 010 only  
USE WITH. Dome head terminal

**BOTTOM WIRE GUIDE SWIVEL BRACKET**  
Floor/Face Fix

PRICE.	
CODE.	RE24-2205-009000
PACK.	4   200 Sets

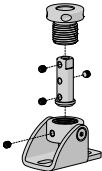

COLOUR. Polished stainless steel 009 only  
USE WITH. 3.2mm Wire

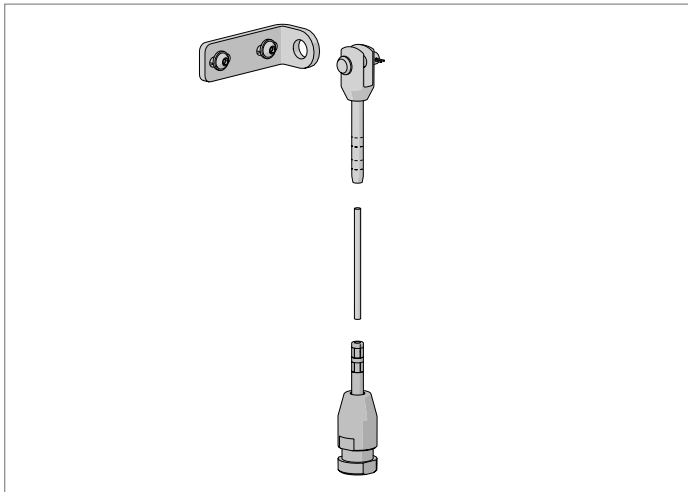

**THREADED STUD TERMINAL + NUT & WASHER**

PRICE.	
CODE.	RE24-1401-009040
PACK.	2   40 Sets

COLOUR. Polished stainless steel 009  
 USE WITH. 4mm Tensioning Cable, Wall Mounting L Bracket.



**WALL MOUNTING L BRACKET - LH AND RH SET 90 x 38mm**

PRICE.	
CODE.	RE24-2301-009090
PACK.	1   40 Pairs

COLOUR. Polished stainless steel 009  
 USE WITH. Threaded Stud Terminal

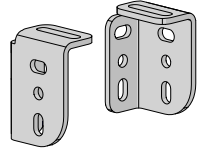

**BOX 190 WIRE GUIDE ADAPTOR PLATE + Screws**

PRICE.	
CODE.	RB80-0481-012000
PACK.	2   100 Pcs

COLOUR. Stainless steel 012  
 USE WITH. Box 190 End Plate Set, Fork Terminal



**ZAMAK ADAPTOR SPACER**

PRICE.	
CODE.	RB80-0411-025050
PACK.	1   20 Pcs

COLOUR. Zinc plated 025 only  
 USE WITH. Zamak Adaptor in Box 190 & Recess Brackets

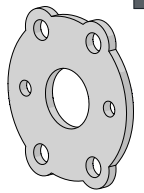

**MOTOR EXTREME WIRE GUIDE BRACKET ADAPTOR KIT Top / Face Fix**

TYPE.	zinc plated	Colours - refer below
PRICE.		
CODE.	RB80-0476-025100	RB80-0476-xxx100
PACK.	1   20 Sets	1   20 Sets

COLOUR. Black 050, pure white 069  
 USE WITH. Extreme Bracket Set - Top/Face Fix

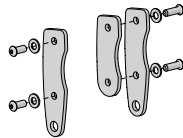

**SWAGE FORK TERMINAL 4mm stainless steel wire**

PRICE.	
CODE.	RE24-1314-009400
PACK.	2   40 Pcs

COLOUR. Polished stainless steel 009  
 USE WITH. Extreme Bracket Set - Top/Face Fix, Wire Guide Cable

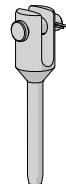

**WIRE GUIDE TENSIONING CABLE 4MM 50Lm Roll**

TYPE.	Plain	Clear PVC Coated
PRICE.		
CODE.	RB91-3602-006040	RB91-3602-006041
PACK.	50   300 Lm	50   300 Lm

CCOLOUR. Stainless steel 006  
 USE WITH. Flat Head Stud & Swage Fork Terminals, F72 Weight Bar End Cap



**TENSIONING BRACKET & FLAT HEAD STUD TERMINAL 4mm stainless steel wire**

PRICE.	
CODE.	RE24-2601-009040
PACK.	2   40 Sets

COLOUR. Polished stainless steel 009  
 USE WITH. 4mm Wire Guide Cable

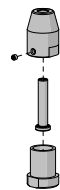

**TENSION SPRING 14.5 I.D. x 23.5 O.D x 50mm**

PRICE.	
CODE.	RE24-9101-009050
PACK.	25   500 Pcs

COLOUR. Polished stainless steel 009  
 USE WITH. Threaded Stud Terminal, Wall Mounting L Bracket





OPTIONAL ACCESSORIES

EXT

**WELDING TAPE 9MM**

\*net pricing. no discount applied.

PRICE.	
CODE.	HD31-0501-001010
PACK.	50   500 Metre

COLOUR. Clear 001 only  
USE WITH. Zip tail spline

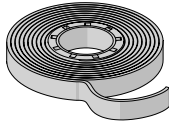

**R-CLIP | 1\2" ROUND SHAFT | 10MM SQUARE SHAFT**

Net Pricing - No Discounts

PRICE.	
CODE.	HD85-2001-025902
PACK.	100   1000 Piece

COLOUR. Silver zinc plated 025  
USE WITH. Motors using Square Shaft Adaptor



**IDLER HOUSING & PIN KIT**

63mm \*RUNOUT\*

PRICE.	
CODE.	RE01-0212-050063
PACK.	5   50 Pcs

COLOUR. Black 050  
USE WITH. Idler Spring Adaptor, 78mm Tube Adaptor, 63mm Tube

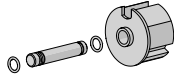

**CABLE GROMMET - 7MM ID X 22MM HOLE | EPDM**

PRICE.	
CODE.	HD87-3007-050022
PACK.	50   1000 Pcs

COLOUR. Black 050  
USE WITH. Box 120 End plates, Cassette Extrusion, FT Motor In-Line Connector.

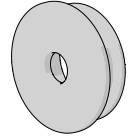

**SOLID ROUND PVC SPLINE | 250M ROLL**

6mm & 7mm

TYPE.	6mm PVC	7mm PVC
PRICE.		
CODE.	SB91-0016-050250	SB91-0017-050250
PACK.	250   2500 Lm	250   2500 Lm

COLOUR. Black 050  
USE WITH. Roller Tube, Terminal Bar

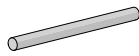

**78MM TUBE STICKERS**

100 per Roll \*No discounts applied. Net pricing.

PRICE.	
CODE.	AW91-3001-xxx000
PACK.	1   10 Roll

COLOUR. White 064, graphite 315  
USE WITH. 78mm Tubes

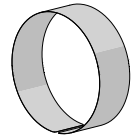

**ALUMINIUM TUBE 63MM**

TYPE.	5.8m Lgth
PRICE.	
CODE.	RE01-0363-000580
PACK.	4   36 Lgths

COLOUR. Mill 000 only  
USE WITH. Bearing Idler, 63mm Crank Housing, Motor Crown, 5mm Spline or #6 Zip.

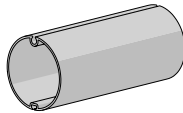

**WIRE ROPE TOP CLAMP TERMINAL ROUND**

PRICE.	
CODE.	RE24-4001-009032
PACK.	4   200 Sets

COLOUR. Polished stainless steel 009 only  
USE WITH. Brackets, 3.2mm Wire

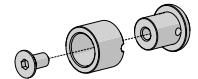

**HOOK FOR CRANK CONTROL ARM**

PRICE.	
CODE.	RB05-9104-025000
PACK.	5   100 Pcs

COLOUR. Silver zinc plated 025  
USE WITH. RB05 Crank Arms, Cranks with a loop attachment



**5MM FABRIC SPLINE W/ 15MM TAIL**

(100m rolls)

PRICE.	
CODE.	SB91-0405-050015
PACK.	1   10 Roll

COLOUR. Black 050

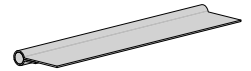

**AUTOMATE 63MM DRIVE WHEEL**

PRICE.	
CODE.	RE01-0666-050508
PACK.	5   100 Piece

COLOUR. Black 050  
USE WITH. 63mm Tubes, FT Motors

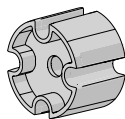

**SELF DRILLING PAINTED SCREWS**

PRICE.	
CODE.	HD82-1923-xxx013
PACK.	500   5000 Pcs

COLOUR. Black 050, Monument 057, Surfmist 068, White 069, Classic Cream 295, Woodland Grey 352, Paperbark 425



**AUTOMATE | FT MOTOR IN-LINE TAIL - 2.5M**

PRICE.	
CODE.	RB24-9105-069025
PACK.	1   48 Piece

COLOUR. Pure white 069  
USE WITH. FT & AX Motors



**BOX 120 END PLATE - O RING**

PRICE.	
CODE.	HD87-1060-050030
PACK.	1,000   5,000 Piece

COLOUR. Black 050  
 USE WITH. Box 120 End Plates (RE01-1101-xxx120)

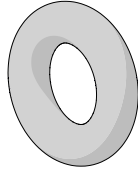

**UNIVERSAL | M50 MOTOR BRACKET + SCREWS**

PRICE.	
CODE.	RE01-0601-025000
PACK.	5   100 Set

COLOUR. Zinc 025  
 USE WITH. FT Motor

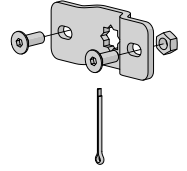

**CRANK HANDLE CLIP**

PRICE.	
CODE.	MG05-9103-340013
PACK.	20   200 Piece

COLOUR. Grey 340  
 USE WITH. Crank Control Arm (RB05-9101-xxxLLL)

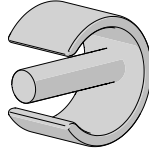

**FLAT HEAD STUD TERMINAL - 4MM S/STEEL WIRE**

PRICE.	
CODE.	RE24-2601-009902
PACK.	1 Piece

COLOUR. Stainless Steel Polish 009  
 USE WITH. Extreme Wire Guide Tensioning Bracket Terminal

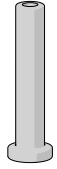

**BOX 120 END PLATE - COVER**

PRICE.	
CODE.	ME01-1101-xxx905
PACK.	4   20 Piece

COLOUR. Per Box120 standard colours  
 USE WITH. Box 120 End Plates (RE01-1101-xxx120)

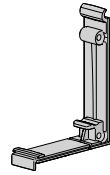

**EXTREME SQUARE BRACKET PLATE SIDE FIX**

PRICE.	
CODE.	RB80-1501-025110
PACK.	1   20 Pcs

USE WITH. Box190 End Plates, Zipscreen Extreme Open Brackets (when using RE01-0214 Bracket Adaptor for 78mm hardware)

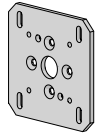

**IDLER/SPRING ADAPTOR MKII RETAINING CLIP  
 With Screw**

PRICE.	
CODE.	RE01-0214-050004
PACK.	10   500 Piece

COLOUR. Black 050  
 USE WITH. Idler/Spring Adaptor Kit MKII (RE01-0214-050000)

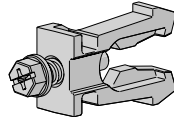

**EXTERNAL BOOSTER V2 | TENSIONER ONLY**

PRICE.	
CODE.	RE01-0421-050900
PACK.	4   40 Pcs

COLOUR. Black 050  
 USE WITH. RE01 Springs

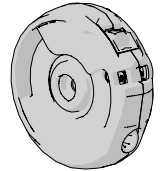

**RE01 CRANK FUNNEL**

PRICE.	
CODE.	MG05-9104-344000
PACK.	10   100 Pcs

COLOUR. Grey 340  
 USE WITH. RE01 Gears

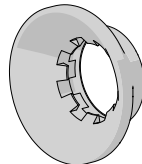

**EXTERNAL BOOSTER V2 | BRACKET ADAPTOR W/ SCREWS**

PRICE.	
CODE.	RE01-0421-054920
PACK.	4   40 Kits

COLOUR. Black plating 054  
 USE WITH. RE01 Springs

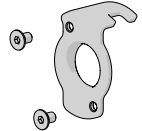

Description	Part Number	Pack	Price
Box 190 Extreme Headbox Sample (300mm)	MK01-RE01-069801	1 Piece	
Zipscreen Drop Awning Colour Swatch	MK04-SB04-000001	1 Piece	
Zipscreen User Guide	MK91-9999-ZIP001	200 Pieces	
Zipscreen Brochure	MK91-9999-ZIP000	300 Piece	
External Brochure	MK91-9999-EXT000	200 Piece	
Zipscreen Bottom Rail Sticker - Polyester (40 pcs)	MK04-Sb04-000007	1 Sheet = 40 Stickers	
F56/F72 Weight Bar & Bubble Seal Range Sample Kit	MK04-SB91-069000	1 Kit	
Zipscreen Mini Sample with Box 120 - No Frame (600mm)	MK01-SB04-352178	1 Kit	
Wire Guide Framed Mini Sample (600mm) - Woodland Grey Wire Guide Framed Mini Sample (600mm) - Black Wire Guide Framed Mini Sample (600mm) - Monument	MK01-RE24-352000 MK01-RE24-050000 MK01-RE24-057000	1 Kit	
Zipscreen Mini Sample with Box 120- Framed (600mm) - Woodland Grey Zipscreen Mini Sample with Box 120- Framed (600mm) - Black Zipscreen Mini Sample with Box 120- Framed (600mm) - Monument	MK01-SB04-352078 MK01-SB04-050078 MK01-SB04-057078	1 Kit	
Zipscreen Sample Bag	MK04-RE01-050001	1 Piece	



Wire Guide Mini Sample



Zipscreen Mini Sample



Zipscreen Sample Case