

# CASSETTE ROLLERS

<b>SECTION 1</b>	<b>CF CASSETTE / FASCIA SUITE</b>	
	CF 75	144
	CF 90	148
	CF 75/90 dim-OUT	154
	CF90 Bottom Up	156
<b>SECTION 2</b>	<b>Z-LOCK</b>	
	Box 100 z-LOCK	160
	Box 120	164
<b>SECTION 3</b>	<b>SKYLIGHTS</b>	
	Box 100 & 120 Zipscreen	168

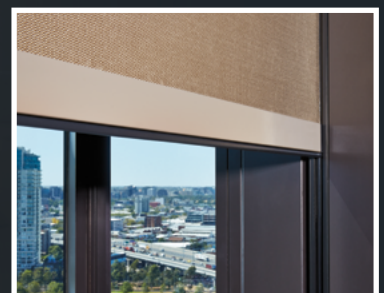

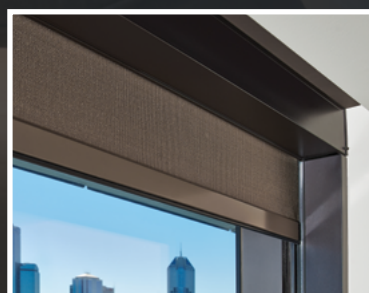
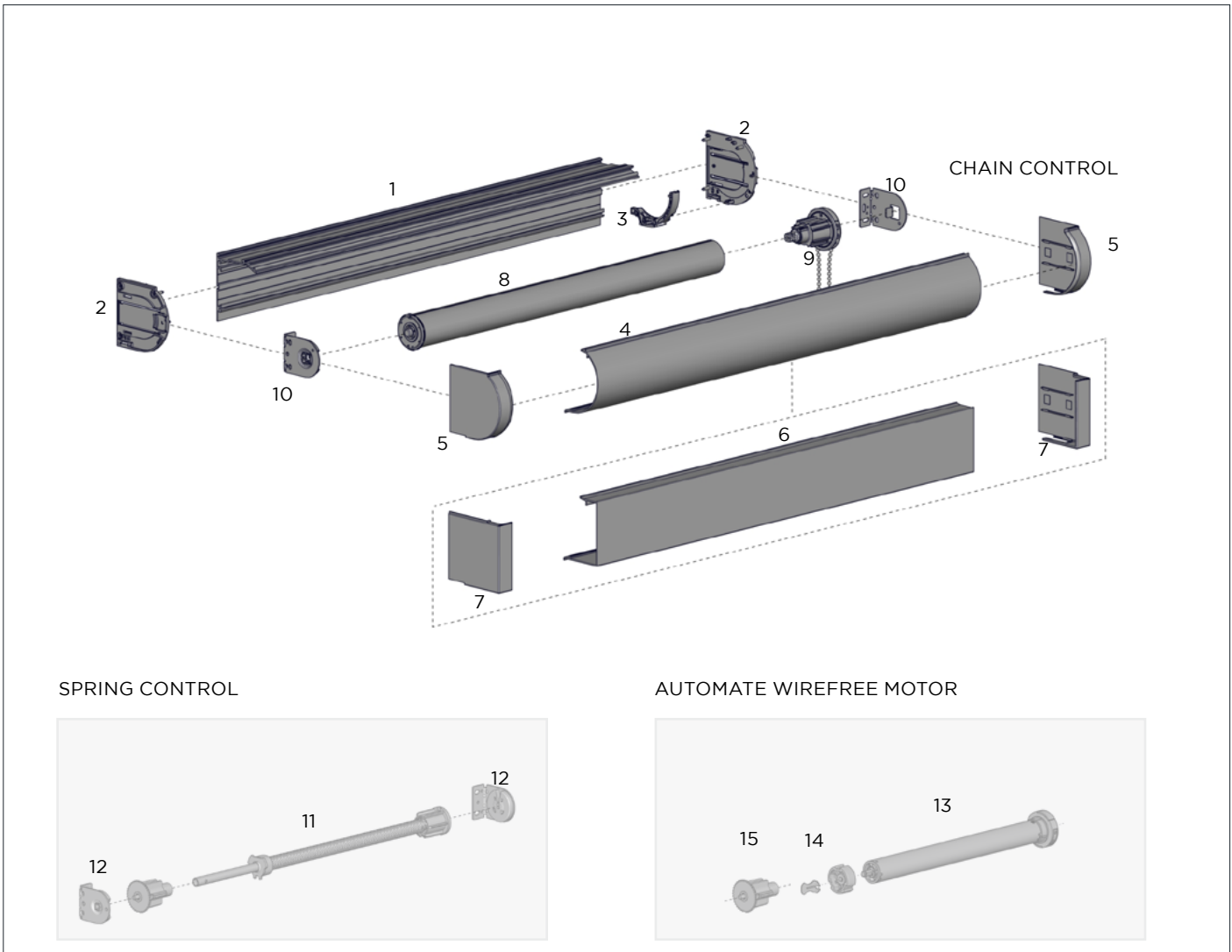

COLOUR RANGE



PRODUCT OPTIONS

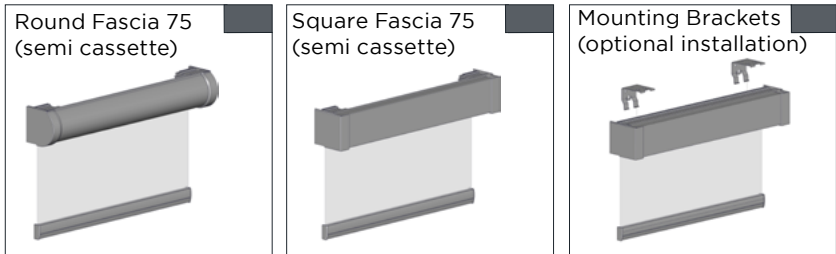

**CASSETTE 75 BACK**  
4.8m length

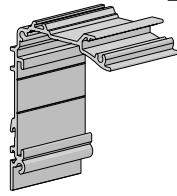

TYPE.	mill	nat. anodised	Colours - refer below
CODE.	RC01-0201-000480	RC01-0201-020480	RC01-0201-xxx480
PACK.	4   60 Lgths	4   60 Lgths	4   60 Lgths

COLOUR. satin black 050, pure white 069, sandstone 269  
USE WITH. Cassette 75 Round or Square Cover & End Plate set

**CASSETTE 75 SQUARE COVER**  
4.8m length

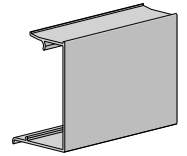

TYPE.	mill	nat. anodised	Colours - refer below
CODE.	RC01-0203-000480	RC01-0203-020480	RC01-0203-xxx480
PACK.	4   60 Lgths	4   60 Lgths	4   60 Lgths

COLOUR. satin black 050, pure white 069, sandstone 269  
USE WITH. Cassette 75 Back, Fascia Bracket & End Plate Set

**CASSETTE 75 END PLATE SET**  
+ Screws

CODE.	RC02-0101-338075
PACK.	10   200 Sets

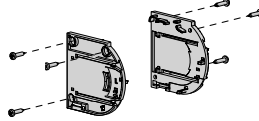

COLOUR. silver grey 338  
USE WITH. Cassette 75 Round or Square Back, Fascia 75 bracket

**CASSETTE 75 SQUARE COVER SET**

CODE.	RC02-0103-xxx075
PACK.	10   80 Sets

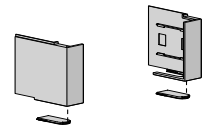

COLOUR. black 050, pure white 069, sandstone 269, silver grey 338  
USE WITH. Cassette 75 Square Cover & End Plate set

**CASSETTE 75 ROUND CHAIN GUIDE SET**  
LH & RH

CODE.	RC02-0201-001075
PACK.	10   400 Sets

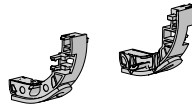

COLOUR. clear 001  
USE WITH. Cassette 75 Round Cover & End Plate set

**T-SPLINE ALUMINIUM TUBE | S35 | STD**  
O.D 33.0mm x 5.8m Length

TYPE.	with D/S Tape
CODE.	RB93-6333-000580
PACK.	10   120 Lgths

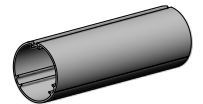

COLOUR. mill finish 000  
USE WITH. S35; Chain Winders, Spring Booster & Automate motor, T-SPLINE

**CASSETTE 75 SQUARE CHAIN GUIDE SET**  
LH & RH

CODE.	RC02-0202-001075
PACK.	10   400 Sets

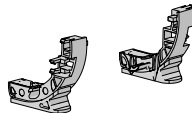

COLOUR. clear 001  
USE WITH. Cassette 75 Square Cover & End Plate set

**T-SPLINE ALUMINIUM TUBE | S35 | HD**  
O.D 34.0mm x 5.8m Length

TYPE.	with D/S Tape
CODE.	RB93-6335-000580
PACK.	10   120 Lgths

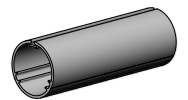

COLOUR. mill finish 000  
USE WITH. S35; Chain Winders, Spring Booster & Automate motor, T-SPLINE

**CASSETTE 75 ROUND COVER**  
4.8m length

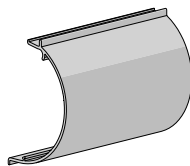

TYPE.	mill	nat. anodised	Colours - refer below
CODE.	RC01-0202-000480	RC01-0202-020480	RC01-0202-xxx480
PACK.	4   60 Lgths	4   60 Lgths	4   60 Lgths

COLOUR. satin black 050, pure white 069, sandstone 269  
USE WITH. Cassette 75 Back, Fascia Bracket & End Plate Set

**T-SPLINE - SLIDE-ON**  
18mm Tail x 200 Lm roll

TYPE.	SLIDE ON
CODE.	RB92-0404-311215
PACK.	1   10 Rolls

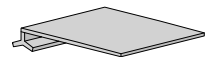

COLOUR. light grey 311 only  
USE WITH. T-SPLINE Aluminium Tube S35

**MULTI-PURPOSE DOUBLE SIDED TAPE**  
50Lm Roll

TYPE.	12mm	18mm
CODE.	HD31-0401-001012	HD31-0401-001018
PACK.	1   36 rolls	1   24 rolls



COLOUR. natural clear 001 only  
USE WITH. T-SPLINE, Aluminium Tube S35

**CASSETTE 75 ROUND COVER SET**  
LH & RH

CODE.	RC02-0102-xxx075
PACK.	10   80 Sets

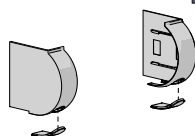

COLOUR. black 050, pure white 069, sandstone 269, silver grey 338  
USE WITH. Cassette 75 Round Cover & End Plate set

**EASY-LOCK AC MKII CHAIN WINDER & AUTO IDLER | S35**  
[\*=INDENT]

CODE.	RB08-3501-xxx010
PACK.	25   200 Sets

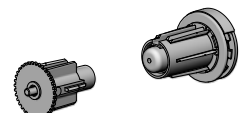

COLOUR. black 050, pure white 069, sandstone 269, barley 283\*, silver grey 338  
USE WITH. Aluminium Tube S35, Easy-Lock LX brackets

**EASY-LIFT RETRO-FIT SPRING ASSIST BOOSTER | S35**  
Universal

CODE.	RB04-3512-069000
PACK.	1   10 Pcs



USE WITH. Aluminium Tube S35, MKII Chain Winder S35

**EASY-LOCK LX INSTALLATION BRACKETS | S35**  
10 / 30mm Projection [\*=INDENT]

SIZE.	30mm projection
CODE.	RB08-8345-xxx030
PACK.	25   250 Sets

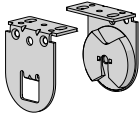

COLOUR. black 050, pure white 069, sandstone 269, barley 283\*, silver grey 338  
USE WITH. MKII Chain Winder, Automate Li-ion motor & Auto Idler S35

**STOP SPRING AC + AUTO IDLER | S35**  
LH only

SIZE.	Junior	Standard
CODE.	RB01-3001-069000	RB01-3002-069000
PACK.	25   200 Sets	25   200 Sets



COLOUR. pure white 069 only  
USE WITH. Aluminium Tube S35, Easy-Lock Spring Installation Brackets LX

**EASY-LOCK LX SPRING INSTALLATION BRACKET | S35**

SIZE.	30mm projection
CODE.	RB01-8346-069030
PACK.	25   250 Sets

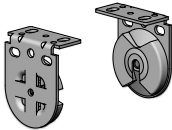

COLOUR. pure white 069 only  
USE WITH. Stop Spring & Auto Idler

**AUTOMATE | WIREFREE LI-ION ZERO MOTOR**

TYPE.	Short 1.1Nm	1.1Nm
CODE.	MT01-1325-069005	MT01-1325-069003
PACK.	1   20 Pcs	1   20 Pcs



USE WITH. LX Easy-Lock Brackets - 30p, S35 Auto Idler, S35 Aluminium Tube

**AUTOMATE S35 ACCESSORY PACK**  
Drive wheel and retaining clip for 1.1Nm motor

CODE.	MTCRDR-25-S35
PACK.	1   100 Sets



COLOUR. black 050 only  
USE WITH. Aluminium Tube S35, Easy-Lock LX brackets 10/30p

**EASY-LOCK AC AUTO IDLER | S35**

CODE.	RB08-0501-069034
PACK.	5   400 Sets

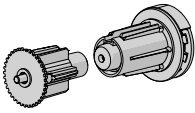

COLOUR. pure white 069  
USE WITH. Aluminium Tube S35, Easy-Lock LX brackets

**AUTOMATE REMOTES**  
One Channel, Five Channel & Fifteen Channel



SIZE.	Push ONE Channel	Push 5 Channel
CODE.	MT02-0101-xxx010	MT02-0101-xxx004
PACK.	1   100 Pcs	1   100 Pcs

SIZE.	Push 15 Channel
CODE.	MT02-0101-xxx008
PACK.	1   100 Pcs

COLOUR. white 067, black 050  
USE WITH. Automate Motors

**AUTOMATE / 5V CHARGER**

TYPE.	2A Charger	4M USB Micro Cable
CODE.	MT03-0301-069011	MT03-0301-069007
PACK.	1   100 Pcs	1   100 Pcs



USE WITH. Used to charge Zero Li-ion 5v Motors

**AUTOMATE PULSE 2.0 | WI-FI HUB**

CODE.	MT02-0401-067001
PACK.	1   10 Pcs



USE WITH. Automate Motors

**CASSETTE 75 MOUNTING BRACKET**  
Top/ Face Fix

CODE.	RC03-1003-025075
PACK.	50   500 Pcs



COLOUR. silver zinc plated 025  
USE WITH. Cassette 75 Back

**FABRIC BRUSH T-SLOT FIT**

TYPE.	5mm / 1 roll=500lm	7mm / 1 roll=350lm
CODE.	SB91-0011-050500	AW91-1501-050000
PACK.	500   2000 Lm	350   1400 Lm

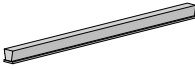

COLOUR. black 050 only  
USE WITH. D30 & F4115 Flat Heavy Duty Bottom Rail, Cassette 75 Back

**SOLAR PANEL V2 FOR 5V/12V MOTORS**

CODE.	MT03-0302-067001
PACK.	1   10 Set



USE WITH. Automate Li-ion Motor

**USB EXTENDER CABLE 210MM**

CODE.	MT03-0301-069014
PACK.	10   500 Pcs



USE WITH. USB Wall Charger, Zero Li-ion Motors

5V 2A WALL CHARGER & 4M USB CABLE | AU

CODE.	MT03-0301-069016
PACK.	1   50 Pcs



USE WITH. Zero 1.1, 2.0nm Li-ion Motors

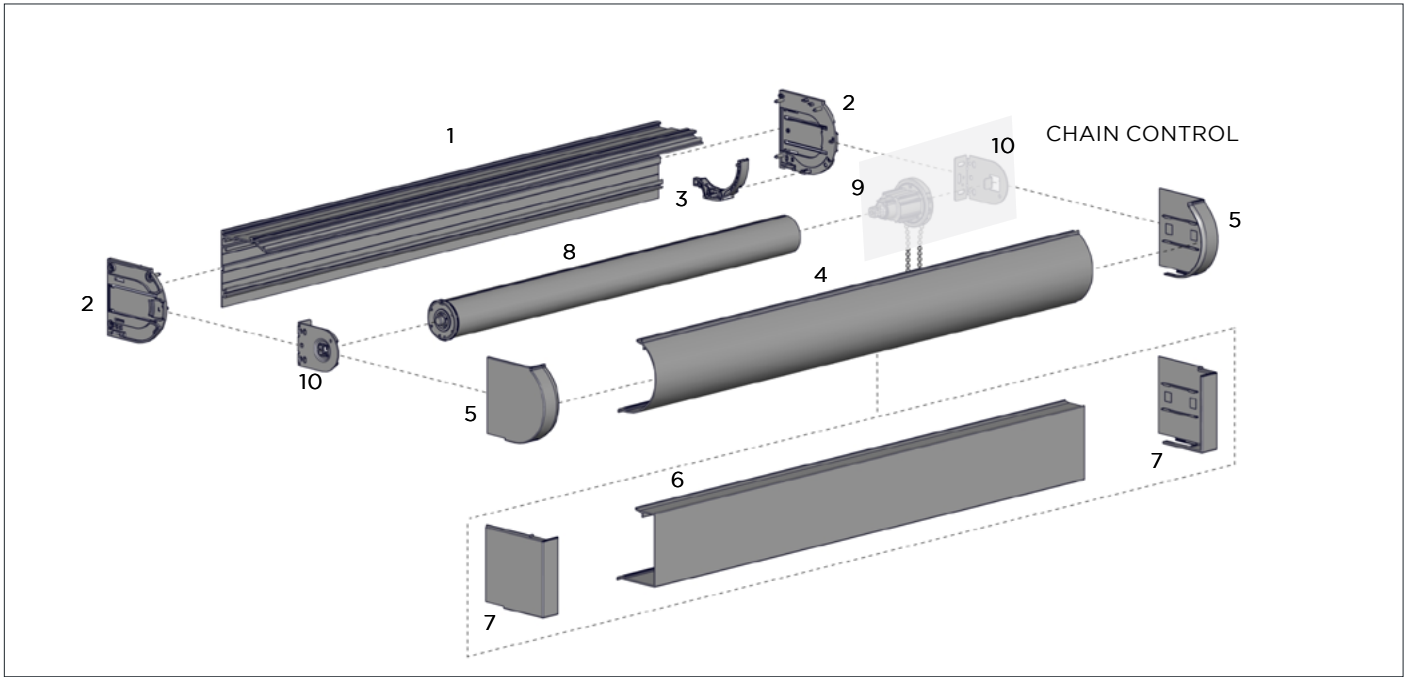

Spring Control

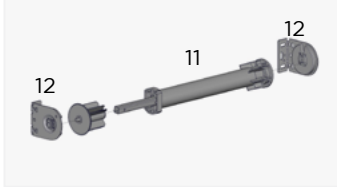

Easy Spring Ultra

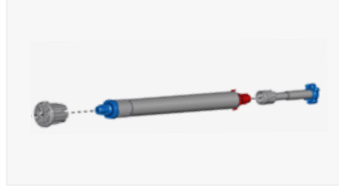

Automate Wirefree Control

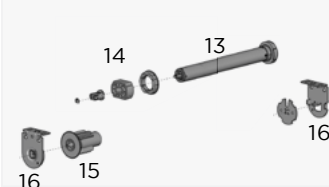

Automate Motor Control

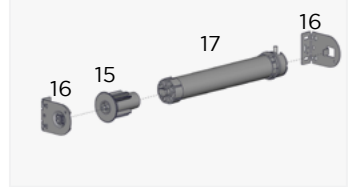

COLOUR RANGE



PRODUCT OPTIONS

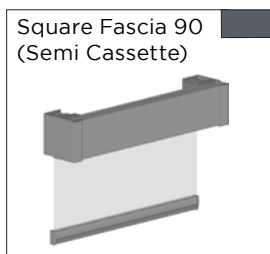
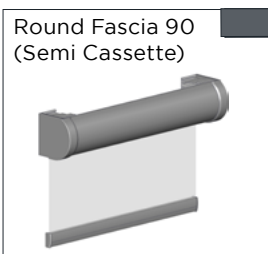

**CASSETTE 90 BACK**  
4.8m length

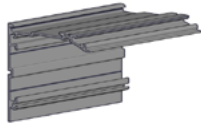

TYPE.	mill 000	nat. anodised 020	Colours - refer below
CODE.	RC01-0101-000480	RC01-0101-020480	RC01-0101-xxx480
PACK.	4   48 Lgths	4   48 Lgths	4   48 Lgths

COLOUR. satin black 050, pure white 069, sandstone 269  
USE WITH. Cassette Round or Square Cover & End Plate set

**CASSETTE 90 SQUARE COVER**  
4.8m length



TYPE.	mill 000	nat. anodised 020	Colours - refer below
CODE.	RC01-0103-000480	RC01-0103-020480	RC01-0103-xxx480
PACK.	4   48 Lgths	4   48 Lgths	4   48 Lgths

COLOUR. satin black 050, pure white 069, sandstone 269  
USE WITH. Cassette 90 Back, End Plate set, Fascia Bracket

**CASSETTE 90 END PLATE SET + SCREWS**  
+ Screws

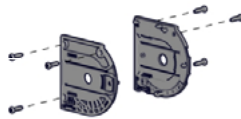

CODE.	RC02-0101-338090
PACK.	10   200 sets

COLOUR. silver grey 338 only  
USE WITH. Cassette 90 Back

**CASSETTE 90 SQUARE COVER SET**

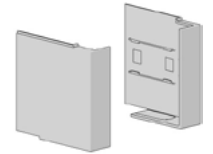

CODE.	RC02-0103-xxx090
PACK.	10   80 Sets

COLOUR. black 050, pure white 069, sandstone 269, silver grey 338  
USE WITH. Cassette 90 Square Cover, End Plate set

**CASSETTE 90 ROUND CHAIN GUIDE**  
LH & RH



CODE.	RC02-0201-001090
PACK.	10   400 Sets

COLOUR. clear 001 only  
USE WITH. Cassette 90 Round Cover & End Plate set

**ALUMINIUM TUBE | S40 | 39SPLINE**  
O.D 39.0mm x 5.8mt Length

TYPE.	No Tape	with D/S Tape   Bulk
CODE.	RB91-0237-000580	RB91-6237-000582
PACK.	10   120 Length	120 Length

COLOUR. mill 000 only  
USE WITH. S40; Chain Winders & Springs, 9mm Flat Spline

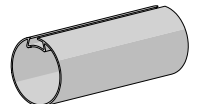

**CASSETTE 90 SQUARE CHAIN GUIDE**  
LH & RH



CODE.	RC02-0202-001090
PACK.	10   400 Sets

COLOUR. clear 001 only  
USE WITH. Cassette 90 Square Cover & End Plate set

**ALUMINIUM TUBE | S40 | 40HD**  
O.D 40.0mm x 5.5mt Length

TYPE.	No Tape
CODE.	RB91-0241-000550
PACK.	10   120 Lgths

COLOUR. mill 000 only  
USE WITH. S40; Chain Winders & Springs, 9mm Flat Spline

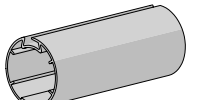

**CASSETTE 90 ROUND COVER**  
4.8m length



TYPE.	mill 000	nat. anodised 020	Colours - refer below
CODE.	RC01-0102-000480	RC01-0102-020480	RC01-0102-xxx480
PACK.	4   48 Lgths	4   48 Lgths	4   48 Lgths

COLOUR. satin black 050, pure white 069, sandstone 269  
USE WITH. Cassette 90 Back, Fascia Bracket

**9MM ACM FLAT SPLINE - NO TAPE**  
100 Lm Roll

TYPE.	No Tape
CODE.	RB92-0901-001100
PACK.	1   10 rolls

COLOUR. natural 001 only  
USE WITH. Aluminium Tube S40 | 39SPLINE & 40HD



**9MM ACM FLAT SPLINE - WITH DOUBLE SIDED TAPE**  
Double Sided MP-HR TAPE 75 Lm Roll

TYPE.	One Side	Two Sides
CODE.	RB92-0902-001075	RB92-0903-001075
PACK.	1   10 rolls	1   10 rolls

COLOUR. natural 001 only  
USE WITH. Aluminium Tube S40 | 39SPLINE & 40HD

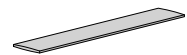

**CASSETTE 90 ROUND COVER SET**  
LH & RH

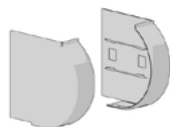

CODE.	RC02-0102-xxx090
PACK.	10   80 Sets

COLOUR. black 050, pure white 069, sandstone 269, silver grey 338

**MULTI-PURPOSE DOUBLE SIDED TAPE**  
50Lm Roll

TYPE.	8mm	18mm
CODE.	HD31-0401-001008	HD31-0401-001018
PACK.	1   48 rolls	1   24 rolls

COLOUR. natural clear 001 only  
USE WITH. Aluminium tubes, Flat Spline

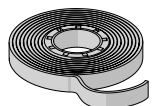

**T-SPLINE ALUMINIUM TUBE · S40 | STANDARD**  
O.D 39.4mm x 5.8m Length

TYPE.	No Tape	No Tape   Bulk
CODE.	RB93-0440-000580	RB93-0440-000582
PACK.	10   100 Lgths	96 Lgths

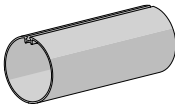

COLOUR. mill finish 000 only  
USE WITH. S40; Springs & Chain winders, T - Spline

**FIXED GUIDE 70 CHAIN WINDER & EXTENDABLE IDLER | S40**  
[\*=INDENT]

TYPE.	S40	S45
CODE.	RB07-4002-xxx070	RB07-4502-xxx070
PACK.	25   200 Sets	25   200 Sets



COLOUR. black 050, pure white 069, sandstone 269, barley 283\*, silver grey 338  
USE WITH. RB08 Easy-Lock Brackets, S40/45 Alu. Tube

**T-SPLINE ALUMINIUM TUBE · S40 | STANDARD**  
O.D 39.4mm x 5.8m Length

TYPE.	With Tape
CODE.	RB93-6440-000582
PACK.	96 Lgths

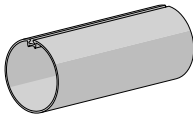

COLOUR. mill finish 000 only  
USE WITH. S40; Springs & Chain winders, T - Spline

**RB09 EASY-LOCK CHAIN WINDER & EXTENDABLE IDLER | S45**

SIZE.	S45
CODE.	RB09-4502-xxx000
PACK.	25   200 Sets

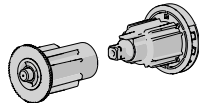

COLOUR. black 050, pure white 069, sandstone 269, barley 283, silver grey 338  
USE WITH. RB09 Easy-Lock Brackets, S45 Alu. Tube

**T-SPLINE ALUMINIUM TUBE | S45 | LIGHT**  
O.D 43.0mm x 5.8m Length

TYPE.	No Tape	with D/S Tape
CODE.	RB93-0443-000580	RB93-6443-000580
PACK.	10   80 Lgths	10   80 Lgths

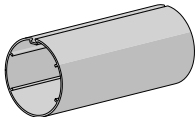

COLOUR. mill 000 only  
USE WITH. S45; Springs, Chain winders & Automate motors, T - Spline

**STANDARD EASY-LIFT RETROFIT BOOSTER | S40**  
Spring Assist

TYPE.	L/H [yellow tail]	R/H [white tail]
CODE.	RB04-4091-570001	RB04-4091-069002
PACK.	5   20 Pcs	5   20 Pcs



COLOUR. yellow 570, pure white 069  
USE WITH. Chain Winder & Aluminium Tube S40

**T-SPLINE ALUMINIUM TUBE | S45 | STANDARD**  
O.D 44.0mm x 5.8m Length

TYPE.	No Tape	with D/S Tape
CODE.	RB93-0444-000580	RB93-6444-000580
PACK.	10   80 Lgths	10   80 Lgths

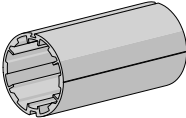

COLOUR. mill 000 only  
USE WITH. S45; Springs, Chain winders & Automate motors, T - Spline

**HEAVY DUTY EASY-LIFT RETROFIT BOOSTER | S40**  
Spring Assist

TYPE.	L/H [blue tail]	R/H [grey tail]
CODE.	RB04-4092-393001	RB04-4092-338002
PACK.	5   20 Pcs	5   20 Pcs



COLOUR. blue 393, apo grey 340  
USE WITH. Chain Winder & Aluminium Tube S40

**T-SPLINE ALUMINIUM TUBE | S45 | HEAVY**  
O.D 49.0mm x 5.8m Length

TYPE.	No Tape	with D/S Tape
CODE.	RB93-0449-000580	RB93-6449-000580
PACK.	6   54 Lgths	6   54 Lgths

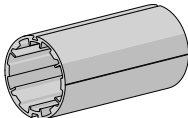

COLOUR. mill 000 only  
USE WITH. S45; Springs, Chain winders & Automate motors, T - Spline

**STANDARD EASY-LIFT RETROFIT BOOSTER | S45**  
Spring Assist

TYPE.	L/H [yellow tail]	R/H [white tail]
CODE.	RB04-4391-570001	RB04-4391-069002
PACK.	5   20 Pcs	5   20 Pcs



COLOUR. yellow 570, pure white 069  
USE WITH. Chain Winder & Aluminium Tube S45

**T-SPLINE - SLIDE-ON**  
18mm tail 200 Lm Roll

TYPE.	No Tape
CODE.	RB92-0404-311215
PACK.	1   10 rolls

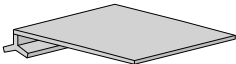

COLOUR. light grey 311only  
USE WITH. T - SPLINE Aluminium Tube S45

**HEAVY DUTY EASY-LIFT RETROFIT BOOSTER | S45**  
Spring Assist

TYPE.	L/H [blue tail]	R/H [grey tail]
CODE.	RB04-4392-393001	RB04-4392-338002
PACK.	5   20 Pcs	5   20 Pcs



COLOUR. blue 393, apo grey 340  
USE WITH. Chain Winder & Aluminium Tube S45

**RB08 MKII EASY-LOCK CHAIN WIND. & EXTEND. IDLER | S40/45**

SIZE.	S40	S45
CODE.	RB08-4002-xxx000	RB08-4502-xxx000
PACK.	25   200 Sets	25   200 Sets

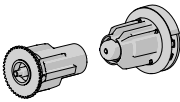

COLOUR. black 050, pure white 069, sandstone 269, barley 283, silver grey 338  
USE WITH. RB08 Easy-Lock Brackets, S40/45 Alu. Tube

**EASY-LOCK VX INSTALLATION BRACKET | S40/S45**  
40mm Projection

CODE.	RB08-8351-xxx040
PACK.	25   200 Sets

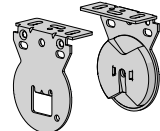

COLOUR. black 050, pure white 069, sandstone 269, barley 283, silver grey 338  
USE WITH. Easy-Lock Chain Winder & Auto Idler S40/45

**RB08 MKI EASY-LOCK CHAIN WINDER & AUTO IDLER | S40/45**

SIZE.	S40	S45
CODE.	RB08-3822-xxx000	RB08-4322-xxx000
PACK.	25   200 Sets	25   200 Sets

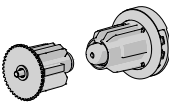

COLOUR. black 050, pure white 069, sandstone 269  
USE WITH. RB08 Easy-Lock Brackets, S40/45 Alu. Tube

**RB09 EASY-LOCK LX INSTALLATION BRACKET | S45**  
40mm Projection

CODE.	RB09-0352-xxx040
PACK.	25   200 Sets

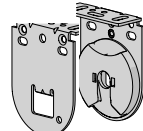

COLOUR. black 050, pure white 069, sandstone 269, barley 283, silver grey 338  
USE WITH. RB09 Chain Winder & Extend Idler S45



**STOP SPRING AC + AUTO IDLER | S40**  
LH only

SIZE.	Junior	Standard
CODE.	RB01-4001-069000	RB01-4002-069000
PACK.	25   200 Sets	25   200 Sets

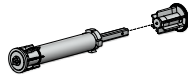

COLOUR. pure white 069 only  
USE WITH. Aluminium Tube S40, Easy-Lock Spring Installation Brackets LX

**STOP SPRING AC + AUTO IDLER | S45**  
LH only

SIZE.	Junior	Standard
CODE.	RB01-4501-069000	RB01-4502-069000
PACK.	25   200 Sets	25   200 Sets

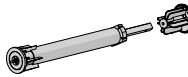

COLOUR. pure white 069 only  
USE WITH. Aluminium Tube S45, Easy-Lock Spring Installation Brackets LX

**EASY-LOCK LX SPRING INSTALL. BRKTS | S40/45**  
40mm Projection

CODE.	RB01-8353-069040
PACK.	25   200 Sets

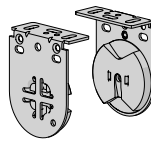

COLOUR. pure white 069 only  
USE WITH. Stop Spring & Auto Idler S40/45

**AUTOMATE | WIREFREE LI-ION ZERO - 1.1, 2.0**

TYPE.	1.1 Nm	2.0 Nm
CODE.	MT01-1325-069003	MT01-1328-069002
PACK.	1   20 / Pcs	1   15 / Pcs



USE WITH. Crown & Drive wheel

**AUTOMATE - CROWN AND DRIVE SET**  
Crown, drive wheel, disc adaptor & clip for Q2.0Nm motor

CODE.	MT03-0103-069005
PACK.	1   100 Sets



COLOUR. white 069 only  
USE WITH. Aluminium Tube S45, Automate Li-ion Q2.0Nm

**AUTOMATE REMOTES**  
One Channel, Five Channel & Fifteen Channel



SIZE.	Push ONE Channel	Push 5 Channel
CODE.	MT02-0101-xxx010	MT02-0101-xxx004
PACK.	1   100 Pcs	1   100 Pcs

SIZE.	Push 15 Channel
CODE.	MT02-0101-xxx008
PACK.	1   100 Pcs

COLOUR. white 067, black 050  
USE WITH. Automate Motors

**AUTOMATE / 5V CHARGER**

TYPE.	2A Charger	4M USB Micro Cable
CODE.	MT03-0301-069016	MT03-0301-069007
PACK.	1   50 Pcs	1   100 Pcs



USE WITH. 5V Li-Ion Motors

**SOLAR PANEL V2 FOR 5V/12V MOTORS**

CODE.	MT03-0302-067001
PACK.	1   10 Set



USE WITH. Automate Li-ion Motor

**USB EXTENDER CABLE 210MM**

CODE.	MT03-0301-069014
PACK.	10   500 Pcs



USE WITH. USB Wall Charger, Zero Li-ion Motors

**EASY-LOCK AUTO IDLER | S45**  
Standard - MKI & Extended - MKII

TYPE.	Standard - MKI	Extended - MKII
CODE.	RB08-0501-xxx043	RB08-0503-xxx045
PACK.	25   200 Pcs	25   200 Pcs

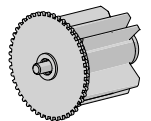

COLOUR. black 050, pure white 069, sandstone 269, barley 283, silver grey 338  
USE WITH. Aluminium Tube S45, Easy-Lock Installation Brackets

**AUTOMATE - CROWN AND DRIVE SET**  
Crown, drive wheel and clip for 1.1Nm motor

CODE.	MTCRDR-25-S40
PACK.	1   100 Sets



COLOUR. black 050 only  
USE WITH. Aluminium Tube S40-STD, Automate Li-ion 1.1Nm

**RB09 EASY-LOCK EXTENDABLE IDLER | S45**

CODE.	RB09-0245-xxx001
PACK.	25   200 Pcs

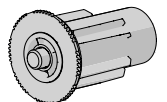

COLOUR. black 050, pure white 069, sandstone 269, barley 283, silver grey 338  
USE WITH. Aluminium Tube S45, RB09 Easy-Lock Installation Brackets VX/LX

**AUTOMATE - CROWN AND DRIVE SET**  
Crown, drive wheel, shaft adaptor & clip for 1.1Nm motor

CODE.	MT03-0103-069004
PACK.	1   100 Sets



COLOUR. white 069 only  
USE WITH. Aluminium Tube S45, Automate Li-ion 1.1Nm

**M40 H/D EASY-LOCK LX INSTAL. BRKT | S40/45**  
40mm projection

TYPE.	RB08	RB09
CODE.	RB40-8355-xxx040	RB40-9355-xxx040
PACK.	25   200 Sets	25   200 Sets

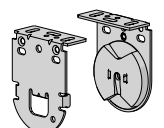

COLOUR. black 050, pure white 069  
USE WITH. AUTOMATE EL motor, Easy-Lock Auto Idler S45

**AUTOMATE | E6**  
 Ø35/6Nm/33rpm

CODE.	MT01-1135-069001
PACK.	1   12 Pcs

COLOUR. pure white 069  
 USE WITH. Easy-Lock Auto Idler, Aluminium Tube S45, Easy-Lock Brackets



**AUTOMATE | M6**  
 S45 ML Motor [Ø35/6Nm/28rpm]

CODE.	MT01-1035-069003
PACK.	1   12 Set

COLOUR. pure white 069 only  
 USE WITH. Easy-Lock Auto Idler, Aluminium Tube S45, Easy-Lock Brackets



**CASSETTE 90 MOUNTING BRACKET | TOP FIX**

CODE.	RC03-1001-025090
PACK.	50   500 Pcs

COLOUR. zinc plated 025 only  
 USE WITH. Cassette 90 Back

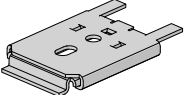

**CASSETTE 90 MOUNTING BRACKET | FACE FIX**

CODE.	RC03-1002-025090
PACK.	50   250 Pcs

COLOUR. zinc plated 025 only  
 USE WITH. Cassette 90 Back



**FABRIC BRUSH T-SLOT FIT**

TYPE.	5mm / 1 roll=500lm	7mm / 1 roll=350lm
CODE.	SB91-0011-050500	AW91-1501-050000
PACK.	500   2000 Lm	350   1400 Lm

COLOUR. black 050 only  
 USE WITH. D30 & F4115 Flat Heavy Duty Bottom Rail, Cassette 90 Back

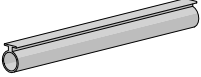

**MEDIUM HD BRACKET ADAPTOR + SCREW**

CODE.	RB09-0701-xxx012
PACK.	25   200 Set

COLOUR. pure white 069, black 050  
 USE WITH. E6 & M6 Motors, RB07/08/09 Chain Winders & Brackets

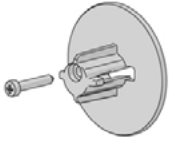

---

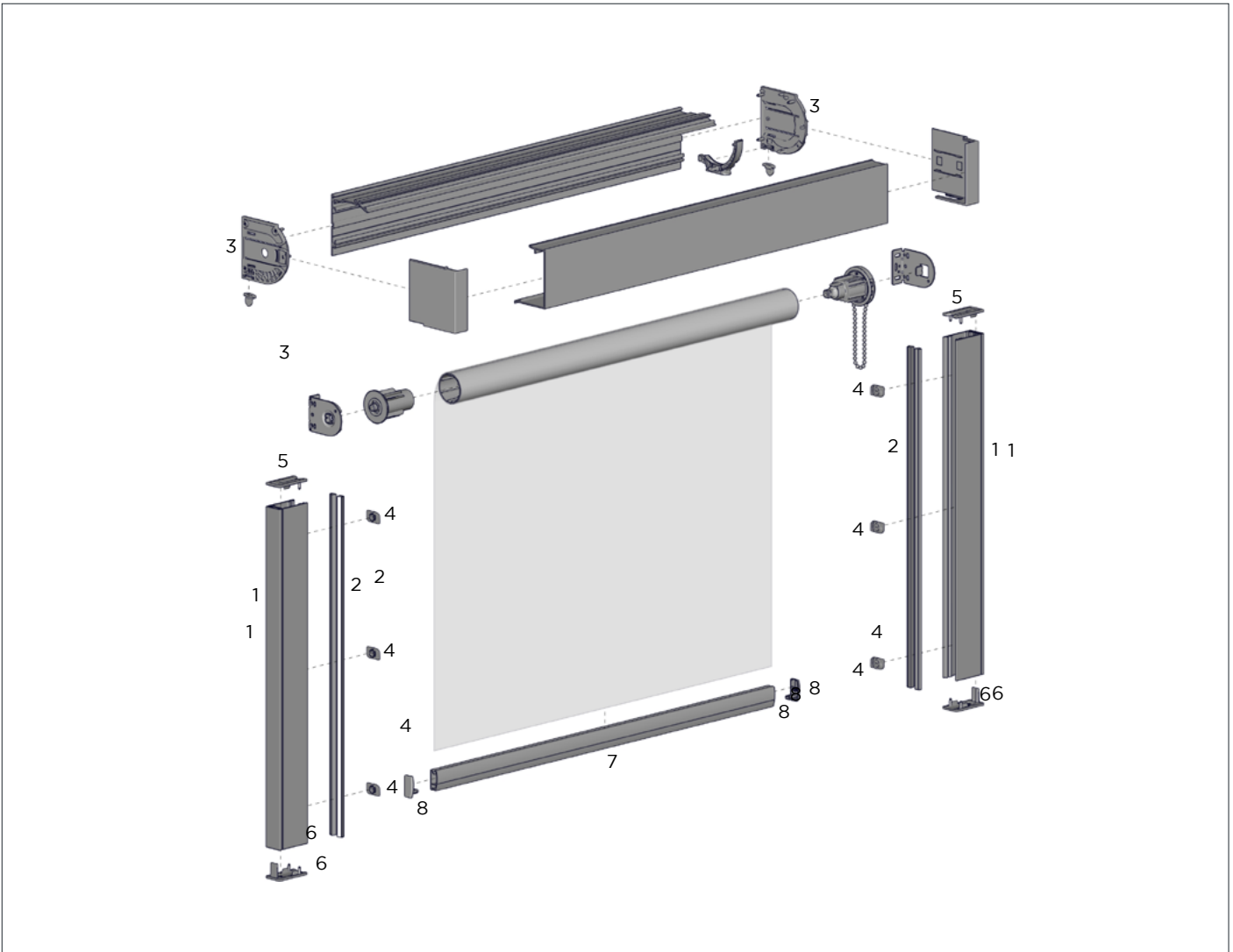

COLOUR RANGE



pure white sandstone anodised black

Bottom Rail Compatibility (Refer BK04 Section 4)

D30 BOTTOM RAIL (shown above)  
 FLAT BOTTOM RAIL  
 F4115 HEAVY DUTY FLAT BOTTOM RAIL  
 OVAL BOTTOM RAIL

PRODUCT OPTIONS

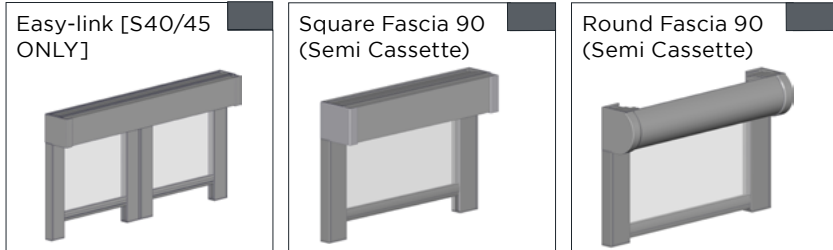

**CASSETTE DIM-OUT | SIDE GUIDE**  
5.8m length

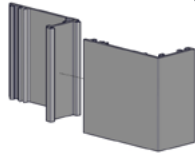

TYPE.	Mill	Nat. Anodised	Colours - refer
CODE.	RC91-0101-000580	RC91-0101-020580	RC91-0101-xxx580
PACK.	4   80 Lgths	4   80 Lgths	4   80 Lgths

COLOUR. satin black 050, pure white 069, sandstone 269  
USE WITH. Cassette 75/90, Side Guide Ear

**D30 SILENT MEDIUM ALUMINIUM BOTTOM RAIL**  
14.0 x 31.0mm x 5.8mt Length

TYPE.	Nat Anodised	Colours - refer below
CODE.	RB91-1232-020580	RB91-1232-069580
PACK.	10   140 Length	10   140 Length

COLOUR. satin black 050, pure white 069, sandstone 269  
USE WITH. Spline - Flat 15mm, D30 End Cap

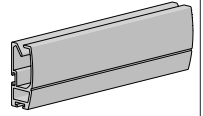

**D30 BOTTOM RAIL END CAP**  
LH & RH

CODE.	RB91-2131-xxx002
PACK.	50   2500 Pairs

COLOUR. black 050, pure white 069, sandstone 269, silver grey 338  
USE WITH. D30 Bottom Rail

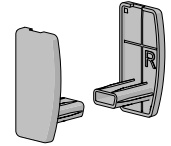

**FABRIC BRUSH T SLOT FIT**  
7mm High x 4.8mm Wide | 350 Lm Roll

CODE.	AW91-1501-050000
PACK.	350 Lm

COLOUR. black 050 only  
USE WITH. Cassette dim-OUT Side Guide

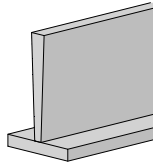

**EASY-LINK INTERMEDIATE MALE DRIVE | S40/S45**

TYPE.	S40	S45
CODE.	RB41-1002-xxx040	RB41-1002-xxx045
PACK.	5   25 Sets	5   25 Sets

COLOUR. black 050, pure white 069, sandstone 269, barley 283, silver grey 338  
USE WITH. Easy-Link Female drive, Bearing Bracket, Aluminium tube S40/45

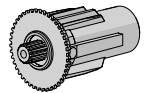

**FABRIC BRUSH T SLOT FIT**  
5mm High x 4.8mm Wide | 500 Lm Roll

CODE.	SB91-0011-050500
PACK.	500   2000 Metre

COLOUR. black 050 only  
USE WITH. Cassette dim-OUT Side Guide

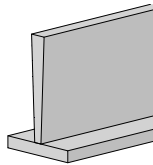

**EASY-LINK INTERMEDIATE FEMALE DRIVE | S40/S45**

TYPE.	S40	S45
CODE.	RB41-1001-xxx040	RB41-1001-xxx045
PACK.	5   25 Sets	5   25 Sets

COLOUR. black 050, pure white 069, sandstone 269, barley 283, silver grey 338  
USE WITH. Easy-Link Male drive, Bearing Bracket, Aluminium tube S40/45

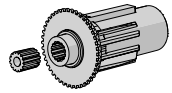

**CASSETTE DIM-OUT | SIDE GUIDE EAR**

CODE.	RC91-0302-338000
PACK.	100   5000 Pcs

COLOUR. silver grey 338  
USE WITH. Cassette dim-OUT Side Guide, Cassette 75/90 End Plate



**EASY-LINK INTERMEDIATE BRACKET | S40/S45**  
40mm Projection + Grub Screw

TYPE.	AX	LX
CODE.	RB41-0411-050040	RB41-0453-xxx040
PACK.	5   25 Sets	25   200 Sets

COLOUR. black 050, pure white 069, silver grey 338  
USE WITH. Cassette 90 Back, Easy-Link Intermediate Female & Male Drive



**CASSETTE DIM-OUT | SIDE GUIDE LOCK**

CODE.	RC91-0201-050000
PACK.	200   5000 Pcs

COLOUR. black 050 only  
USE WITH. Cassette dim-OUT Side Guide

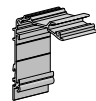

**CASSETTE DIM-OUT | SIDE GUIDE FUNNEL & SCREW SET**

CODE.	RC91-1002-xxx000
PACK.	10   400 sets

COLOUR. black 050, pure white 069, silver grey 338  
USE WITH. Cassette dim-OUT Side Guide



**CASSETTE DIM-OUT | BOTTOM CAP + SCREWS**

CODE.	RC91-1001-xxx000
PACK.	10   400 sets

COLOUR. black 050, pure white 069, silver grey 338  
USE WITH. Cassette dim-OUT Side Guide



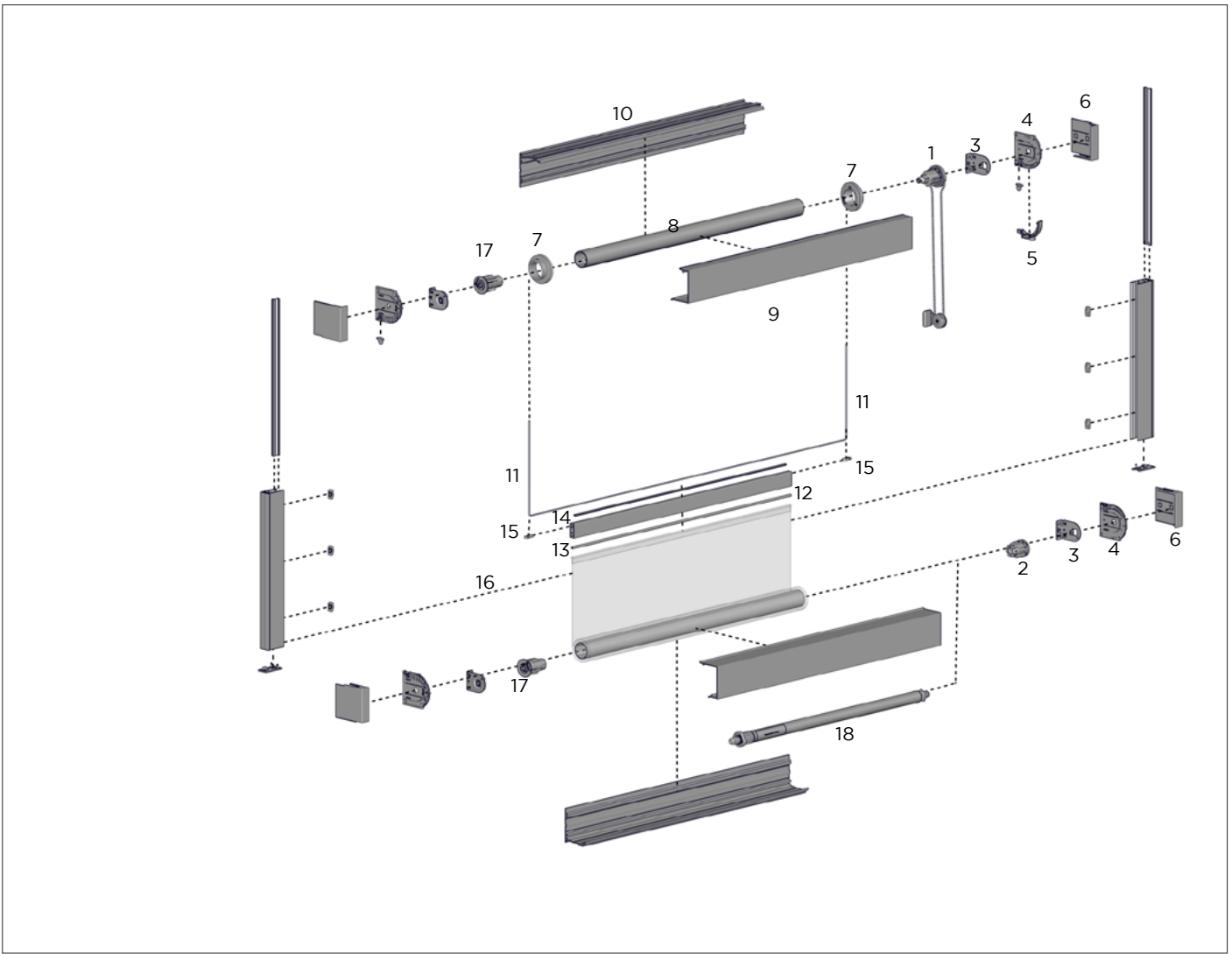

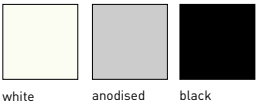

COLOUR RANGE

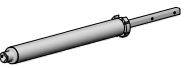
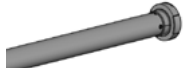

white anodised black

PRODUCT OPTIONS

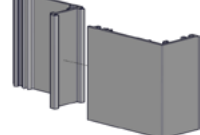
<p><b>EASY LIFT BOOSTER</b></p> 	<p><b>WIREFREE MOTOR</b></p> 	<p><b>WIRED MOTOR</b></p> 	<p><b>CF DIM-OUT CHANNELS</b></p> 
---	--	---	--

**RB09 EASY-LOCK CHAIN WINDER & EXTENDABLE IDLER | S45**

CODE.	RB09-4502-xxx000
PACK.	25   200 Sets

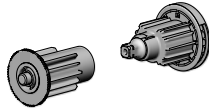

COLOUR. black 050, pure white 069, sandstone 269, silver grey 338, barley 283  
 USE WITH. Brackets, S45 Alu. Tube

**ROMAN LIFT SPOOL S45 | STD + Screw**

CODE.	SS48-1043-066060
PACK.	10   80 Sets



COLOUR. off whites 066 only  
 USE WITH. S45 STD Aluminium Tube, Braided Cord 1.4mm

**CHAINFREE CONTROL**

TYPE.	S45
CODE.	RB12-3200-069045
PACK.	10   400 Pcs

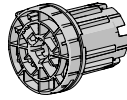

COLOUR. pure white 069  
 USE WITH. Booster Universal

**T-SPLINE ALUMINIUM TUBE | S45 | STANDARD**  
 O.D 44.0mm x 5.8m Length

TYPE.	No Tape	with D/S Tape
CODE.	RB93-0444-000580	RB93-6444-000580
PACK.	10   80 Lgths	10   80 Lgths

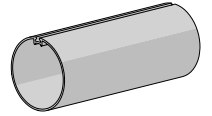

COLOUR. mill 000 only  
 USE WITH. S45 Controls, Lift Spool, Idler

**RB09 EASY-LOCK LX INSTALLATION BRACKET | S45**  
 40mm Projection

CODE.	RB09-0352-xxx040
PACK.	25   200 Sets

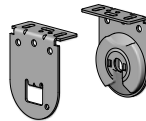

COLOUR. black 050, pure white 069, sandstone 269, barley 283, silver grey 338  
 USE WITH. RB09 Chain Winder & Extend Idler S45

**T-SPLINE HD ALUMINIUM TUBE | S45**  
 O.D 49.0mm x 5.8m Length

CODE.	RB93-0449-000580
PACK.	6   54 Lgths

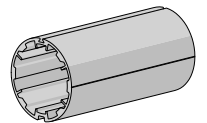

COLOUR. mill 000 only  
 USE WITH. S45 Springs, T-Spline, Idler

**CASSETTE 90 END PLATE SET + SCREWS**  
 + Screws

CODE.	RC02-0101-338090
PACK.	10   200 sets

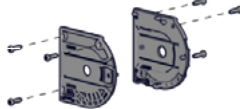

COLOUR. silver grey 338 only  
 USE WITH. Cassette 90 Back

**T-SPLINE - SLIDE-ON**  
 18mm tail 200 Lm Roll

TYPE.	No Tape
CODE.	RB92-0404-311215
PACK.	1   10 rolls



COLOUR. light grey 311only  
 USE WITH. T - SPLINE Aluminium Tube S45

**CASSETTE 90 SQUARE CHAIN GUIDE**  
 LH & RH

CODE.	RC02-0202-001090
PACK.	10   400 Sets



COLOUR. clear 001 only  
 USE WITH. Cassette 90 Square Cover & End Plate set

**CASSETTE 90 SQUARE COVER**  
 4.8m length



TYPE.	mill 000	nat. anodised 020	Colours - refer below
CODE.	RC01-0103-000480	RC01-0103-020480	RC01-0103-xxx480
PACK.	4   48 Lgths	4   48 Lgths	4   48 Lgths

COLOUR. satin black 050, pure white 069, sandstone 269  
 USE WITH. Cassette 90 Back, End Plate set

**CASSETTE 90 ROUND CHAIN GUIDE**  
 LH & RH

CODE.	RC02-0201-001090
PACK.	10   400 Sets



COLOUR. clear 001 only  
 USE WITH. Cassette 90 Round Cover & End Plate set

**CASSETTE 90 SQUARE COVER SET**

CODE.	RC02-0103-xxx090
PACK.	10   80 Sets

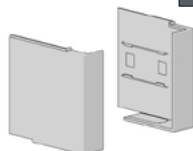

COLOUR. black 050, pure white 069, sandstone 269, silver grey 338  
 USE WITH. Cassette 90 Square Cover, End Plate set

**CASSETTE 90 ROUND COVER**  
 4.8m length



TYPE.	mill 000	nat. anodised 020	Colours - refer below
CODE.	RC01-0102-000480	RC01-0102-020480	RC01-0102-xxx480
PACK.	4   48 Lgths	4   48 Lgths	4   48 Lgths

COLOUR. satin black 050, pure white 069, sandstone 269  
 USE WITH. Cassette 90 Back

**CASSETTE 90 ROUND COVER SET**  
 LH & rh

CODE.	RC02-0102-xxx090
PACK.	10   80 Sets

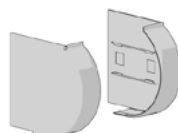

COLOUR. black 050, pure white 069, sandstone 269, silver grey 338  
 USE WITH. Cassette 90 Round Cover, End Plate set

**CASSETTE 90 BACK**  
4.8m length

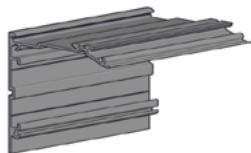

TYPE.	mill 000	nat. anodised 020	Colours - refer below
CODE.	RC01-0101-000480	RC01-0101-020480	RC01-0101-xxx480
PACK.	4   48 Lgths	4   48 Lgths	4   48 Lgths

COLOUR. satin black 050, pure white 069, sandstone 269  
USE WITH. Cassette Round or Square Cover & End Plate set

**BOTTOM UP RAIL - END CAP**

CODE.	RB91-2139-xxx000
PACK.	20   500 Piece

COLOUR. pure white 069, black 050, silver grey 338  
USE WITH. Bottom up rail



**RB09 EASY-LOCK EXTENDABLE IDLER | S45**

CODE.	RB09-0245-xxx001
PACK.	25   200 Pcs

COLOUR. black 050, pure white 069, silver grey 338  
USE WITH. Aluminium Tube S45

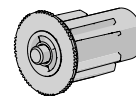

**BRAIDED CORD 1.4MM | 16PLY**  
1 Roll = 500 Lm

CODE.	AC01-1416-062500
PACK.	500   10000 Lm

COLOUR. White 062  
USE WITH. Spool set S45

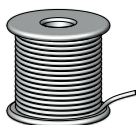

**NON-STOP BOOSTER UNIVERSAL | S45**  
Light

CODE.	RB12-4521-069145
PACK.	1   5 Pcs

COLOUR. pure white 069  
USE WITH. Chainfree Control,

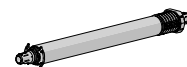

**WOVEN LIFT TAPE**

CODE.	SS95-3217-062005
PACK.	200   1000 Lm

COLOUR. White 062  
USE WITH. Spool set S45

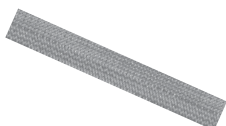

**CHAINHOLD TD TENSIONER + SCREWS**

CODE.	RB91-1331-069000
PACK.	25   400 Sets

COLOUR. pure white 069  
USE WITH. #10 Rotation Chains - Plastic or Metal



**BOTTOM UP RAIL**  
5.8m length

CODE.	RB91-1239-xxx580
PACK.	6   96 / Lgth

COLOUR. pure white 069, black 050, anodised 020  
USE WITH. Fabric, Bottom up end cap & Seal



**STANDARD EASY-LIFT RETROFIT BOOSTER | S45**  
Spring Assist

TYPE.	L/H [yellow tail]	R/H [white tail]
CODE.	RB04-4391-570001	RB04-4391-069002
PACK.	5   20 Pcs	5   20 Pcs

COLOUR. yellow 570, pure white 069  
USE WITH. Chain Winder & Aluminium Tube S45



**BOTTOM UP RAIL SEAL**  
100 metre rolls

CODE.	SB91-0007-001100
PACK.	100   400 Lm

COLOUR. clear 001  
USE WITH. Bottom up rail

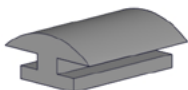

**AUTOMATE | WIREFREE LI-ION ZERO - 1.1, 2.0**

TYPE.	1.1 Nm	2.0 Nm
CODE.	MT01-1325-069003	MT01-1328-069002
PACK.	1   20 / Pcs	1   15 / Pcs

USE WITH. Crown & Drive wheel



**9MM ACM FLAT SPLINE - WITH DOUBLE SIDED TAPE**

TYPE.	Two Sides
CODE.	RB92-0903-001075
PACK.	1   10 rolls

COLOUR. natural 001 only  
USE WITH. fabric, Bottom up rail

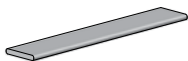

**AUTOMATE / 5V CHARGER**

TYPE.	2A Charger	4M USB Micro Cable
CODE.	MT03-0301-069016	MT03-0301-069007
PACK.	1   50	1   100 Pcs

USE WITH. Used to charge Zero Li-ion 5v Motors



**CORD GUIDE KIT**

CODE.	RB91-2239-050001
PACK.	10   250 Set

COLOUR. black 050  
USE WITH. Bottom up rail, 1.4mm Cord

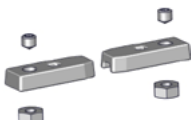

**USB EXTENDER CABLE 210MM**

CODE.	MT03-0301-069014
PACK.	10   500 Pcs

USE WITH. USB Wall Charger, Zero Li-ion Motors





**AUTOMATE REMOTES**

One Channel, Five Channel & Fifteen Channel



SIZE.	Push ONE Channel	Push 5 Channel
CODE.	MT02-0101-xxx010	MT02-0101-xxx004
PACK.	1   100 Pcs	1   100 Pcs

SIZE.	Push 15 Channel
CODE.	MT02-0101-xxx008
PACK.	1   100 Pcs

COLOUR. white 067, black 050  
USE WITH. Automate Motors

**AUTOMATE PULSE 2.0 | WI-FI HUB**



CODE.	MT02-0401-067001
PACK.	1   10 Pcs

USE WITH. Automate Motors

**AUTOMATE - CROWN AND DRIVE SET**

Crown, drive wheel, shaft adaptor & clip for 1.1Nm motor



CODE.	MT03-0103-069004
PACK.	1   100 Sets

COLOUR. white 069 only  
USE WITH. Aluminium Tube S45, Automate Li-ion Motor 1.1Nm

**AUTOMATE - CROWN AND DRIVE SET**

Crown, drive wheel, disc adaptor & clip for Q2.0Nm motor



CODE.	MT03-0103-069005
PACK.	1   100 Sets

COLOUR. white 069 only  
USE WITH. Aluminium Tube S45, Automate Li-ion Motor Q2.0Nm

**AUTOMATE | E6**  
Ø35/6Nm/33rpm



CODE.	MT01-1135-069001
PACK.	1   12 Pcs

COLOUR. pure white 069  
USE WITH. Easy-Lock Auto Idler, M40 Disc Adapter, M40 Brkts, Aluminium Tube S45

**M40 RB09 H/D EASY-LOCK LX INSTAL. BRKT | S40/45**



SIZE.	12/40mm projection
CODE.	RB40-9355-xxx040
PACK.	25   200 Sets

COLOUR. black 050, pure white 069  
USE WITH. H/D Motor Disc Adaptor, Easy-Lock Auto Idler S45

**CASSETTE DIM-OUT | SIDE GUIDE**

5.8m length

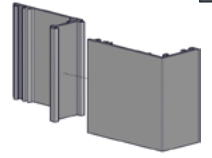

TYPE.	mill	nat. anodised	Colours - refer below
CODE.	RC91-0101-000580	RC91-0101-020580	RC91-0101-xxx580
PACK.	4   80 Lgths	4   80 Lgths	4   80 Lgths

COLOUR. satin black 050, pure white 069  
USE WITH. Cassette 90, Side Guide Ear

**FABRIC BRUSH T SLOT FIT**

7mm High x 4.8mm Wide | 350 Lm Roll

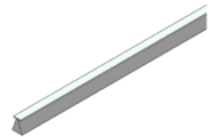

CODE.	AW91-1501-050000
PACK.	350 Roll

COLOUR. black 050 only  
USE WITH. Cassette dim-OUT Side Guide

**FABRIC BRUSH T SLOT FIT**

5mm High x 4.8mm Wide | 500 Lm Roll

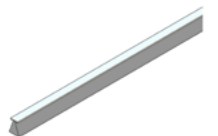

CODE.	SB91-0011-050500
PACK.	500   2000

COLOUR. black 050 only  
USE WITH. Cassette dim-OUT Side Guide

**CASSETTE DIM-OUT | SIDE GUIDE EAR**



CODE.	RC91-0302-338000
PACK.	100   5000 Pcs

COLOUR. silver grey 338  
USE WITH. Cassette dim-OUT Side Guide, Cassette 75/90 End Plate

**CASSETTE DIM-OUT | SIDE GUIDE LOCK**



CODE.	RC91-0201-050000
PACK.	200   5000 Pcs

COLOUR. black 050 only  
USE WITH. Cassette dim-OUT Side Guide

**CASSETTE DIM-OUT | SIDE GUIDE FUNNEL & SCREW SET**



CODE.	RC91-1002-xxx000
PACK.	10   400 sets

COLOUR. black 050, pure white 069, silver grey 338  
USE WITH. Cassette dim-OUT Side Guide

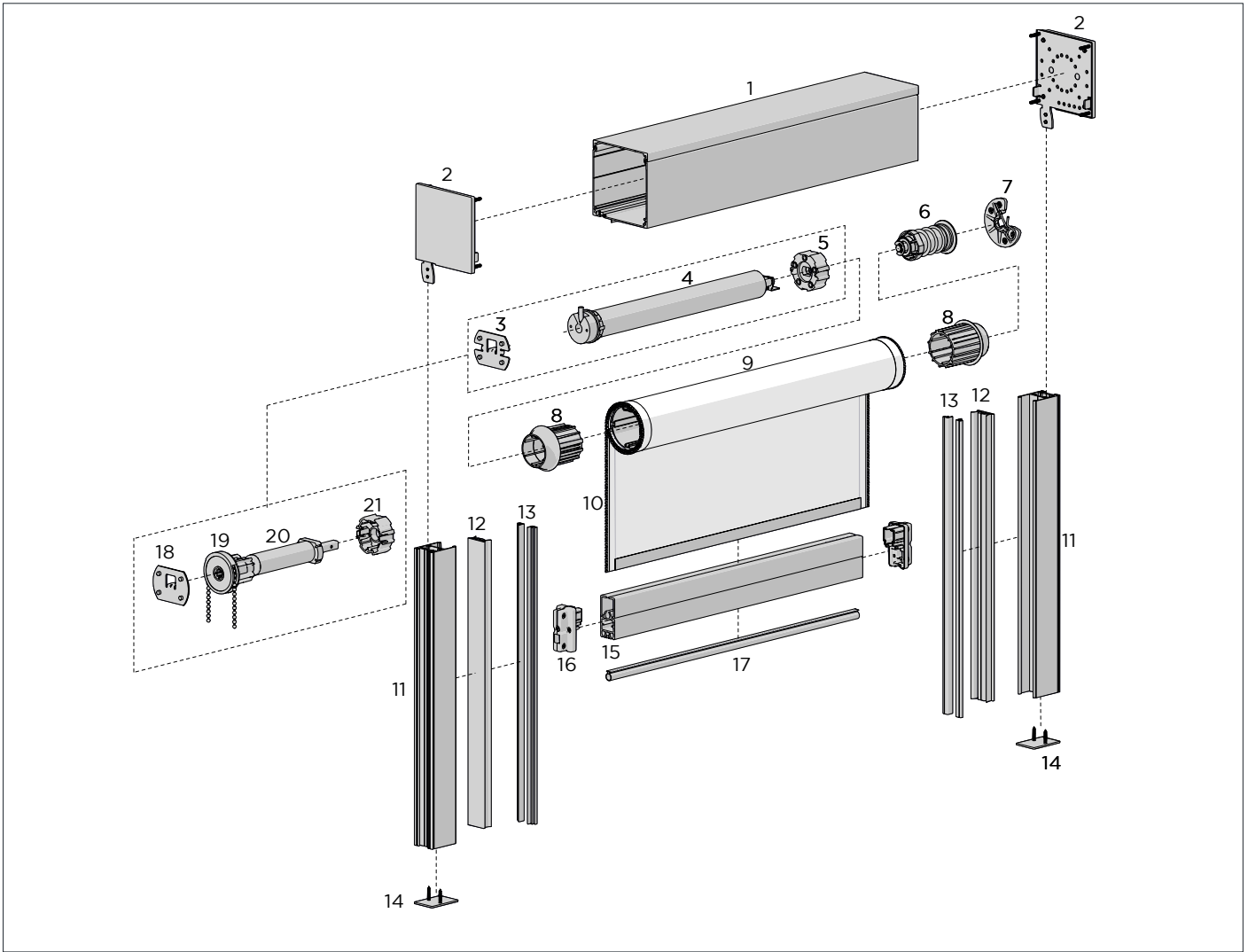

COLOUR RANGE



mill

PRODUCT OPTIONS

Fixing Plates  
(for face & side fixing)



**BOX SQUARE 100 BACK**

TYPE.	SQUARE BOX 100
CODE.	SB01-1010-000580
PACK.	4   80 Lgths

COLOUR. mill 000 only  
 USE WITH. BOX Square100, End Plate Covers

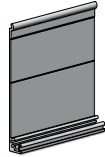

**AUTOMATE | M6**

S45 ML Motor [Ø35/6Nm/28rpm]

CODE.	MT01-1035-069003
PACK.	1   12 Set

COLOUR. pure white 069 only  
 USE WITH. Motor Adaptor Plate, Reducer, Drive Wheel



**BOX SQUARE 100 COVER**

TYPE.	SQUARE BOX 100
CODE.	SB01-1025-000580
PACK.	4   72 Lgths

COLOUR. mill 000 only  
 USE WITH. BOX Square 100 Back & 100 Top, End Plate Set

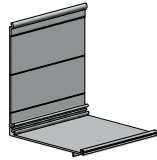

**DRIVE WHEEL 45MM MOTOR TO S60 TUBE**

CODE.	RB56-0105-050502
PACK.	5   250 Pcs

COLOUR. black 050 only  
 USE WITH. Automate E6 & M6 Motor

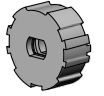

**BOX SQUARE 100 TOP**

TYPE.	SQUARE BOX 100
CODE.	SB01-1030-000580
PACK.	4   80 Lgths

COLOUR. mill 000 only  
 USE WITH. BOX Square 100 Cover & 100 Back, End Plate Set

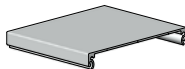

**Z-LOCK EXTENDED BEARING IDLER | S45**  
 10mm Round Spindle

CODE.	SB11-0812-050045
PACK.	5   50 Pcs

COLOUR. black 050 only  
 USE WITH. Bearing Idler Adapter, Zip Tube Reducer



**FABRIC BRUSH T-SLOT FIT**  
 5mm High x 4.8mm Wide

CODE.	SB91-0011-050500
PACK.	500   2000 Lm

COLOUR. black 050 only  
 USE WITH. BOX Square 100 Back

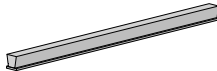

**Z-LOCK BEARING IDLER ADAPTER**  
 10mm Round Spindle

CODE.	SB11-0810-050045
PACK.	5   100 Sets

COLOUR. black 050 only  
 USE WITH. Bearing Idler S45, End Plate Set

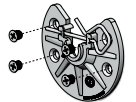

**BOX UNIVERSAL END PLATE SET WITH EARS**  
 + Screws

TYPE.	Box 100
CODE.	SB02-1001-025020
PACK.	5   25 Sets

COLOUR. zinc plated 025 only  
 USE WITH. BOX Square 100, End Plate Covers

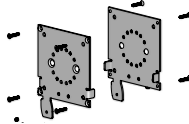

**ZIP TUBE REDUCER - MEDIUM**  
 Reducing from 60mm to 45mm

CODE.	SB11-0813-050360
PACK.	4   40 Pcs

COLOUR. black 050 only  
 USE WITH. S60 Tube, 35mm Motors, S45 Idler

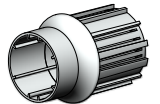

**BOX END PLATE COVER SET**  
 LH & RH

TYPE.	Box 100
CODE.	SB02-1020-xxx020
PACK.	5   200 Pairs

COLOUR. black 050, pure white 069, silver grey 338  
 USE WITH. End Plate Sets

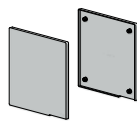

**ALUMINIUM TUBE - S60 | 60STD**  
 O.D 60.0mm x 5.8mt Length

TYPE.	No Tape	with D/S Tape
CODE.	RB91-0260-000580	RB91-6260-000580
PACK.	4   36 Lgths	4   36 Lgths

COLOUR. mill 000 only  
 USE WITH. Zip Tube Reducer, Drive Wheel

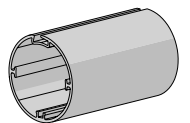

**M40 H/D MOTOR ADAPT PLATE + SCREWS - 12MM | S45**

CODE.	SB11-0704-025400
PACK.	5   200 Sets

COLOUR. silver zinc plated (025)  
 USE WITH. E6 & M6 motors, End Plates

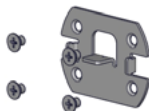

**MULTI-PURPOSE DOUBLE SIDED TAPE**  
 50Lm Roll

TYPE.	8mm	18mm
CODE.	HD31-0401-001008	HD31-0401-001018
PACK.	1   48 rolls	1   24 rolls

COLOUR. natural clear 001 only  
 USE WITH. Aluminium tubes, Flat Spline



**AUTOMATE | E6**  
 Ø35/6Nm/33rpm

CODE.	MT01-1135-069001
PACK.	1   12 Pcs

COLOUR. pure white 069  
 USE WITH. Easy-Lock Auto Idler, M40 Disc Adapter, M40 Brkts, Aluminium Tube S45



**9MM ACM FLAT SPLINE - NO TAPE**  
 100 Lm Roll

TYPE.	No Tape
CODE.	RB92-0901-001100
PACK.	1   10 rolls

COLOUR. natural 001 only  
 USE WITH. S60 Tube

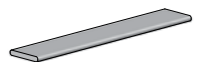

**9MM ACM FLAT SPLINE - WITH DOUBLE SIDED TAPE**  
Double Sided MP-HR TAPE | 75 Lm Roll

TYPE.	One Side	Two Sides
CODE.	RB92-0902-001075	RB92-0903-001075
PACK.	1   10 rolls	1   10 rolls

COLOUR. natural 001 only  
USE WITH. S60 Tube



**F56 | ZIPSCREEN - LOCK END CAP SET**

CODE.	RE20-0303-xxx002
PACK.	10   200 Sets

COLOUR. black 050, pure white 069  
USE WITH. F56 Weight Bar

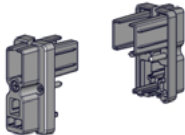

**Z-LOCK ZIP NO. 4 GAUGE**  
1 Roll = 500Lm

CODE.	SH91-0106-050400
PACK.	500 lm

COLOUR. black 050  
USE WITH. Fabric, Inner Rails



**WEIGHT BAR BUBBLE SEAL STRIP**  
8 x 12mm

CODE.	SB91-0001-050580
PACK.	10   30 Lgths

COLOUR. black 050 only  
USE WITH. F56 Weight bar



**7MM FABRIC SPLINE WITH 15MM TAIL**  
100m Roll

CODE.	SB91-0409-050015
PACK.	1   10 Roll

COLOUR. black 050  
USE WITH. F56 Weight Bar

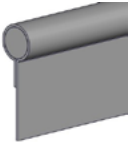

**EASY-LOCK CHAIN WINDER ADAPTOR + SCREWS**  
12mm Tongue

CODE.	SB11-0791-025012
PACK.	5   200 Sets

COLOUR. zinc plated 025 only  
USE WITH. Easy-Lock Chain Winder S45, End Plate Set

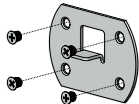

**Z-LOCK STANDARD SIDE GUIDE**  
33 x 48mm

CODE.	SB04-1501-000580
PACK.	4   60 Lgths

COLOUR. mill 000 only  
USE WITH. End Plates, Standard Side Guide Bottom Cap, F rail covers

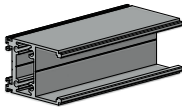

**RB09 EASY-LOCK CHAIN WINDER**

CODE.	RB09-0145-069002
PACK.	25   200 Pcs

COLOUR. pure white 069  
USE WITH. Chain winder adaptor, Zip Tube Reducer, Retro-fit spring

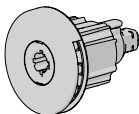

**Z-LOCK INNER RAIL WITH LEGS**  
29 x 17mm

CODE.	AW08-0302-050600
PACK.	1   21 Length

COLOUR. black 050 only  
USE WITH. Standard Side Guide Rail



**EASY-LIFT RETROFIT AC SPRING ASSIST BOOSTER | S45**  
Standard

TYPE.	L/H [yellow tail]	R/H [white tail]
CODE.	RB04-4391-570001	RB04-4391-069002
PACK.	5   20 Units	5   20 Units

COLOUR. pure white 069  
USE WITH. S45 Chain Winder, S60 Tube, Spring tail adaptor

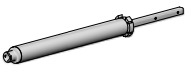

**Z-LOCK SIDE GUIDE - F RAIL COVER**

TYPE.	RPVC
CODE.	SB05-0341-xxx580
PACK.	10   80 Length

COLOUR. black 050, white 069  
USE WITH. Standard Side Guide Rail

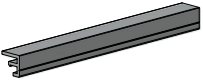

**EASY-LIFT RETROFIT AC SPRING ASST BOOSTER | S45**  
Heavy Duty

TYPE.	L/H [blue tail]	R/H [grey tail]
CODE.	RB04-4392-393001	RB04-4392-338002
PACK.	5   20 Units	5   20 Units

COLOUR. pure white 069  
USE WITH. S45 Chain Winder, S60 Tube, Spring tail adaptor

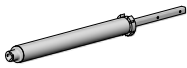

**Z-LOCK STANDARD SIDE GUIDE STEEL BOTTOM CAP**

CODE.	SB05-1501-025000
PACK.	10   200 Pcs

COLOUR. zinc plated 025  
USE WITH. Standard Side Guide Rail

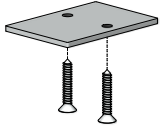

**BOX SQUARE CHAIN GUIDE**  
+ Screws

CODE.	SB11-0790-xxx000
PACK.	5   500 Sets

COLOUR. black 050, pure white 069, silver grey 338  
USE WITH. Easy-Lock Chain Winder, End Plate Set

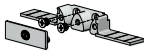

**F56 HD WEIGHT BAR**

TYPE.	4.2m Length	5.8m Length
CODE.	RE15-0101-000420	RE15-0101-000580
PACK.	2   48 Length	2   48 Length

COLOUR. mill 000 only  
USE WITH. Fabric Spline, F56 End Caps

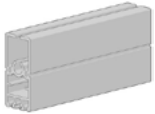

**S45 SPRING TAIL ADAPTOR**  
For S60 Tube

CODE.	SB11-0105-050045
PACK.	5   500 Pcs

COLOUR. black 050 only  
USE WITH. S60 Tube, Easy-Lift Retrofit Spring S45

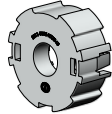

**Z-LOCK SIDE GUIDE FACE FIX PLATE**  
with Grub Screws

CODE.	SB05-1320-025000
PACK.	10   200 Sets

COLOUR. zinc plated 025 only  
USE WITH. Standard Side Guide Rail

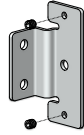

**Z-LOCK SIDE GUIDE SIDE FIX PLATE**  
with Grub Screws

CODE.	SB05-1321-025000
PACK.	10   200 Sets

COLOUR. zinc plated 025 only  
USE WITH. Standard Side Guide Rail

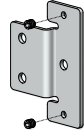

**AUTOMATE REMOTES**  
One Channel, Five Channel & Fifteen Channel



SIZE.	Push ONE Channel	Push 5 Channel
CODE.	MT02-0101-xxx010	MT02-0101-xxx004
PACK.	1   100 Pcs	1   100 Pcs

SIZE.	Push 15 Channel
CODE.	MT02-0101-xxx008
PACK.	1   100 Pcs

COLOUR. white 067, black 050  
USE WITH. Automate Motors

**AUTOMATE PULSE 2.0 | WI-FI HUB**

CODE.	MT02-0401-067001
PACK.	1   10 Pcs

USE WITH. Automate Motors



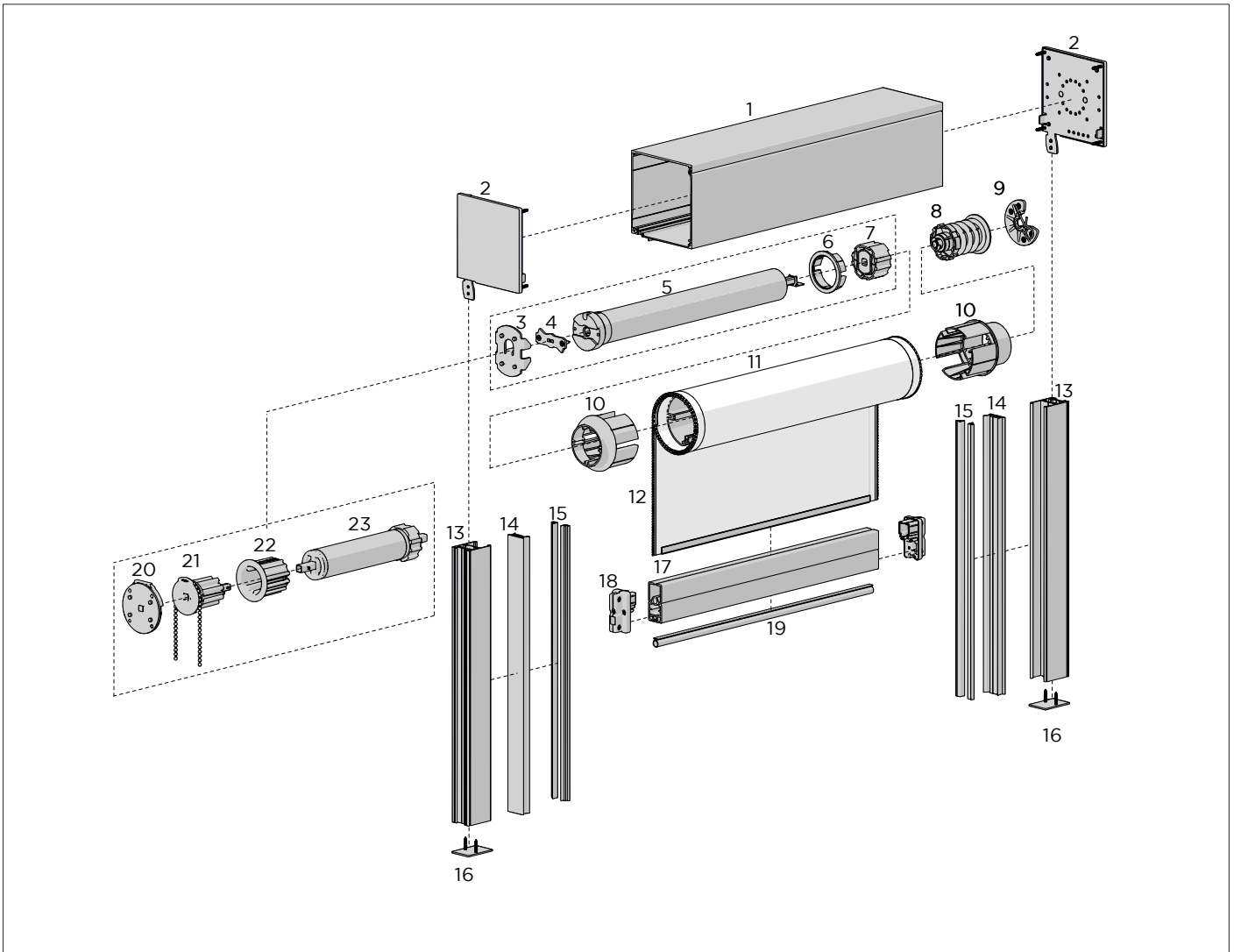

COLOUR RANGE



mill finish

PRODUCT OPTIONS

Fixing Plates  
(for face & side fixing)



**BOX SQUARE 120 BACK**  
120 x120mm

CODE.	SB01-1340-000580
PACK.	2   16 Lgths

COLOUR. mill only 000  
USE WITH. BOX Square 120 Cover, End Plate Set

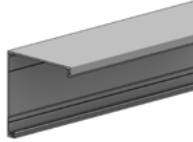

**BOX SQUARE 120 COVER - V2**  
120 x 120mm

CODE.	SB01-1326-000580
PACK.	4   48 Lgths

COLOUR. mill only 000  
USE WITH. Box Square 120 Back, Box Square 120 Top, End Plate Set

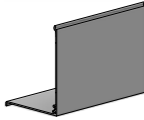

**FABRIC BRUSH T-SLOT FIT**  
5mm High x 4.8mm Wide

CODE.	SB91-0011-050500
PACK.	500   2000 Lm

COLOUR. black 050 only  
USE WITH. BOX Square 120 Back

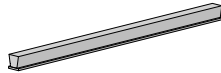

**BOX 120 UNIVERSAL END PLATE SET WITHOUT EARS**  
+ Screws

CODE.	SB02-1201-025020
PACK.	5   40 Sets

COLOUR. zinc plated 025 only  
USE WITH. BOX Square 120, End Plate Covers

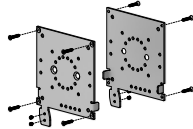

**BOX 120 END PLATE COVER SET**  
LH & RH

CODE.	SB02-1220-xxx020
PACK.	5   50 Pairs

COLOUR. black 050, pure white 069, anodised 020  
USE WITH. BOX Square 120, End Plate Set

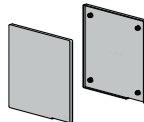

**AUTOMATE S60 MOTOR ADAPTOR SET**

CODE.	RB56-0701-xxx508
PACK.	5   100 Pcs

COLOUR. black 050, pure white 069  
USE WITH. Automate S60 FT Motor & Head Plate, End Plate set

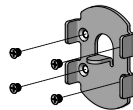

**AUTOMATE MOTOR HEAD PLATE | S60**

TYPE	AUTOMATE / DOOYA	
CODE.	RB56-0711-050509	
PACK.	5   200 Pcs	

COLOUR. black 050  
USE WITH. Automate S60 FT Motor & Adapter set



**AUTOMATE | ARC FT MOTOR WITH CLIP**  
[Ø45/15Nm/15rpm]

CODE.	MT01-1145-050001
PACK.	1   10 Piece

COLOUR. pure white 069  
USE WITH. S60 Motor Adaptor Set, Automate Drive & Crown Wheel



**AUTOMATE CROWN WHEEL S60**

TYPE	S60 60 STD
CODE.	RB56-0136-050508
PACK.	5   250 Pcs

COLOUR. black 050  
USE WITH. FT Motor, Zip tube reducer



**AUTOMATE DRIVE WHEEL | S60**

CODE.	RB56-0105-050502
PACK.	5   250 Sets

COLOUR. black 050  
USE WITH. S60 Tube, Automate FT Motor



**Z-LOCK EXTENDED BEARING IDLER | S60**  
10mm Round Spindle

CODE.	SB11-0812-050060
PACK.	5   50 Pcs

COLOUR. black 050 only  
USE WITH. Bearing Idler Adaptor, Zip Tube Reducer

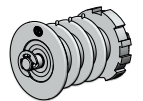

**Z-LOCK BEARING IDLER ADAPTER**  
10mm Round Spindle + screws

CODE.	SB11-0810-050045
PACK.	5   100 Sets

COLOUR. black 050 only  
USE WITH. Bearing Idler S60, End Plate Set

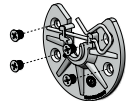

**ZIP TUBE REDUCER - MEDIUM**  
Reducing from 80mm to 60mm

CODE.	SB11-0815-050380
PACK.	4   100 Pcs

COLOUR. black 050 only  
USE WITH. S60|80HD Tube, M50 Crown Wheel, Bearing Idler, RB10 Tube Adaptor



**7MM FABRIC SPLINE WITH 15MM TAIL**  
100m Roll

CODE.	SB91-0409-050015
PACK.	1   10 Roll

COLOUR. black 050  
USE WITH. F56 Weight Bar

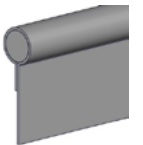

**ALUMINIUM TUBE - S60 | 80HD**  
O.D 80.0mm x 4.8mt & 5.8mt Length

SIZE.	4.8m	5.8m
CODE.	RB91-0280-000480	RB91-0280-000580
PACK.	2   20 Lgths	2   20 Lgths

COLOUR. mill 000 only  
USE WITH. 9mm Flat Spline, RB10 Tube Adaptor, Gear Drive End, M50 Crown Wheel

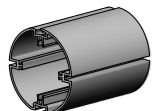

**9MM ACM FLAT SPLINE | NO TAPE**  
100 Lm Roll

TYPE.	No Tape
CODE.	RB92-0901-001100
PACK.	1   10 rolls

COLOUR. natural 001 only  
USE WITH. S60 | 80 HD Tube



**9MM ACM FLAT SPLINE WITH DOUBLE SIDED TAPE**  
Double Sided MP-HR Tape | 75 Lm Roll

TYPE.	One Side	Two Sides
CODE.	RB92-0902-001075	RB92-0903-001075
PACK.	1   10 rolls	1   10 rolls

COLOUR. natural 001 only  
USE WITH. S60 | 80 HD Tube

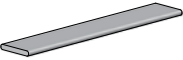

**F56 | ZIPSCREEN - LOCK END CAP SET (2 PIECE)**

CODE.	RE20-0303-xxx002
PACK.	10   200

COLOUR. black 050, pure white 069  
USE WITH. F56 Weight Bar

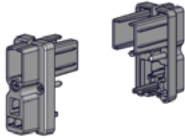

**MULTI-PURPOSE DOUBLE SIDED TAPE**  
50Lm Roll

TYPE.	8mm	18mm
CODE.	HD31-0401-001008	HD31-0401-001018
PACK.	1   48 rolls	1   24 rolls

COLOUR. natural clear 001 only  
USE WITH. Aluminium tubes, Flat Spline



**WEIGHT BAR BUBBLE SEAL STRIP**  
8 x 12mm

TYPE.	CO-PVC
CODE.	SB91-0001-050580
PACK.	10   30 Lgths

COLOUR. black 050 only  
USE WITH. F56 Weight Bar



**Z-LOCK ZIP**

TYPE.	No. 4 Gauge
CODE.	SH91-0106-050400
PACK.	500 Lm

COLOUR. black 050  
USE WITH. Fabric, Inner Rail



**RB10 WINDER ADAPTOR SET | S60**  
+ Screws

CODE.	RB56-7109-050060
PACK.	5   50 Sets

COLOUR. black 050 only  
USE WITH. RB10 Chain Winder, End Plate Set



**Z-LOCK STANDARD SIDE GUIDE**  
33 x 48mm

CODE.	SB04-1501-000580
PACK.	4   60 Lgths

COLOUR. mill 000 only  
USE WITH. End Plates, Standard Side Guide Bottom Cap, F rail covers

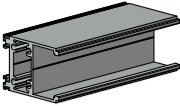

**RB10 CHAIN WINDER | S60**

CODE.	RB10-6100-xxx001
PACK.	5   50 Pcs

COLOUR. black 050, pure white 069  
USE WITH. RB10 Tube Adaptor, Winder Adaptor Set

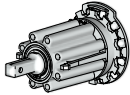

**Z-LOCK PVC**  
6m Lengths

CODE.	AW08-0302-050600
PACK.	1 Length

COLOUR. black 050 only  
USE WITH. Standard Side Guide Rail

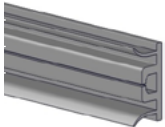

**RB10 TUBE ADAPTOR | S60**

TYPE.	60STD Tube
CODE.	RB10-6000-xxx060
PACK.	5   200 Pcs

COLOUR. black 050, pure white 069  
USE WITH. RB10 Winder, Zip Tube Reducer

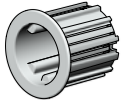

**Z-LOCK SIDE GUIDE - F RAIL COVER**

TYPE.	RPVC - Interior
CODE.	SB05-0341-xxx580
PACK.	10   80 Lgths

COLOUR. black 050, white 069  
USE WITH. Standard Side Guide Rail

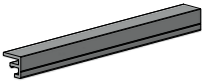

**RB10 RETRO-FIT BOOSTER SHORT SPRING LH | S60**

TYPE.	LH only
CODE.	RB10-6040-050161
PACK.	4 Units

COLOUR. black 050 only  
USE WITH. S60 Tube, RB10 Winder S60

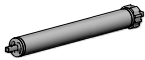

**Z-LOCK STANDARD SIDE GUIDE STEEL BOTTOM CAP**

CODE.	SB05-1501-025000
PACK.	10   200 Sets

COLOUR. Zinc Plated 025  
USE WITH. Standard Side Guide Rail

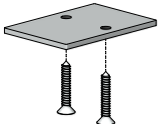

**RB10 RETRO-FIT BOOSTER LIGHT | S60**

TYPE.	L/H	R/H
CODE.	RB10-6040-050011	RB10-6040-050012
PACK.	4   4 Units	4   4 Units

COLOUR. black 050 only  
USE WITH. S60 Tube, RB10 Winder S60



**F56 HD WEIGHT BAR**  
4.2m & 5.8m Lengths

TYPE.	4.2m Length	5.8m Length
CODE.	RE15-0101-000420	RE15-0101-000580
PACK.	2   48 Lgths	2   48 Lgths

COLOUR. mill 000 only  
USE WITH. F56 End Caps, Fabric Spline

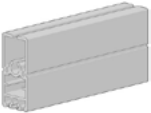

**RB10 RETRO-FIT BOOSTER STANDARD | S60**

TYPE.	L/H	R/H
CODE.	RB10-6040-050031	RB10-6040-050032
PACK.	4   16 Units	4   16 Units

COLOUR. black 050 only  
USE WITH. S60 Tube, RB10 Winder S60





**RB10 RETRO-FIT BOOSTER HEAVY DUTY | S60**

TYPE.	L/H	R/H
CODE.	RB10-6040-050041	RB10-6040-050042
PACK.	4   16 Units	4   16 Units



COLOUR. black 050 only  
 USE WITH. S60 Tube, RB10 Winder S60

**BOX SQUARE CHAIN GUIDE**

+ Screws

CODE.	SB11-0790-xxx000
PACK.	5   500 Sets

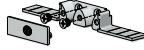

COLOUR. black 050, pure white 069, silver grey 338  
 USE WITH. End Plate Set

**Z-LOCK SIDE GUIDE SIDE FIX PLATE**

with Grub Screws

CODE.	SB05-1321-025000
PACK.	10   200 Sets



COLOUR. zinc plated 025 only  
 USE WITH. Compact & Standard Side Guide Rails

**Z-LOCK SIDE GUIDE FACE FIX PLATE**

with Grub Screws

CODE.	SB05-1320-025000
PACK.	10   200 Sets



COLOUR. zinc plated 025 only  
 USE WITH. Compact & Standard Side Guide Rails

**AUTOMATE REMOTES**

One Channel, Five Channel & Fifteen Channel



SIZE.	Push ONE Channel	Push 5 Channel
CODE.	MT02-0101-xxx010	MT02-0101-xxx004
PACK.	1   100 Pcs	1   100 Pcs

SIZE.	Push 15 Channel
CODE.	MT02-0101-xxx008
PACK.	1   100 Pcs

COLOUR. white 067, black 050  
 USE WITH. Automate Motors

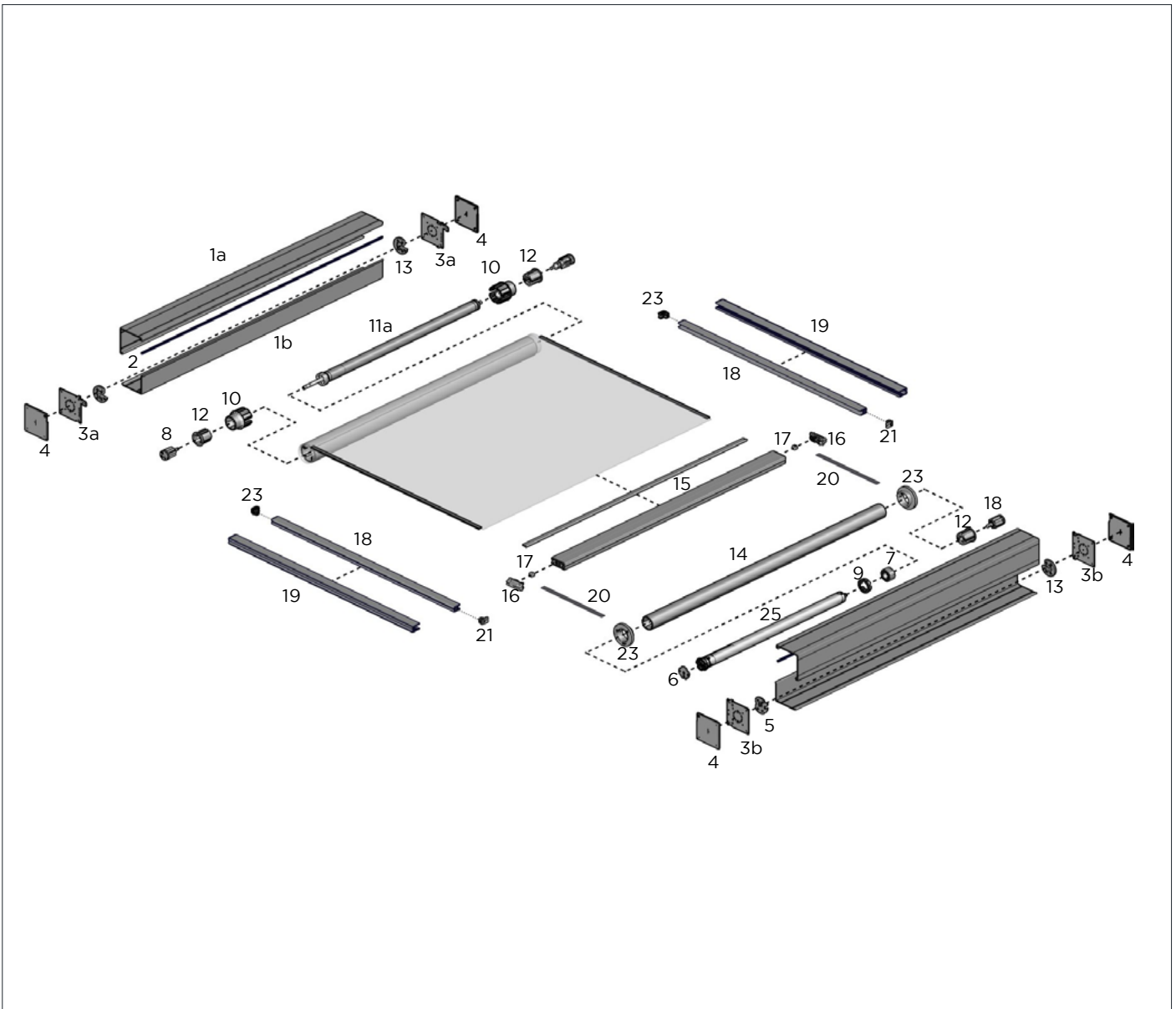

COLOUR RANGE



mill

**BOX SQUARE BACK**

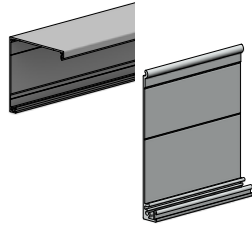

	SQUARE BOX 100	SQUARE BOX 120
TYPE.	mill 000	mill 000
CODE.	SB01-1010-000580	SB01-1340-000580
PACK.	4   80 Lgths	2   16 Lgths

COLOUR. mill 000  
USE WITH. Box Extrusions, End Plate Set

**BOX 100 UNIVERSAL END PLATE SET WITH EARS + Screws**

CODE.	SB02-1001-025020
PACK.	5   25 Set

COLOUR. zinc plated 025 only  
USE WITH. BOX Square 100, End Plate Covers

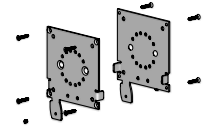

**BOX 120 UNIVERSAL END PLATE SET WITH EARS + Screws**

CODE.	SB02-1201-025020
PACK.	5   40

COLOUR. zinc plated 025 only  
USE WITH. BOX Square 120, End Plate Covers

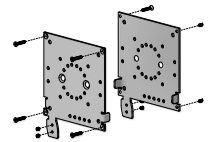

**BOX SQUARE COVER**

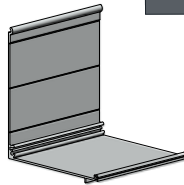

	SQUARE BOX 100	SQUARE BOX 120
TYPE.	mill 000	mill 000
CODE.	SB01-1025-000580	SB01-1326-000580
PACK.	4   72 Lgths	4   48 Lgths

COLOUR. mill 000  
USE WITH. Box Extrusions, End Plate Set

**BOX 100 END PLATE COVER SET LH & RH**

CODE.	SB02-1020-xxx020
PACK.	5   200

COLOUR. 050 Black, 069 White, 338 Silver Grey  
USE WITH. End Plate Sets

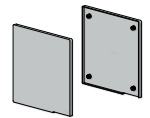

**BOX 120 END PLATE COVER SET LH & RH**

CODE.	SB02-1220-xxx020
PACK.	5   50 Pair

COLOUR. black 050, pure white 069, Anodised 020  
USE WITH. BOX Square 120, End Plate Sets

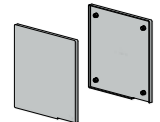

**BOX SQUARE 100 TOP**

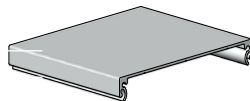

	SQUARE BOX 100
TYPE.	mill 000
CODE.	SB01-1030-000580
PACK.	4   80 Lgths

COLOUR. mill 000  
USE WITH. BOX Square 100 Cover & Back, End Plate Set

**M50 MOTOR ADAPTOR SET | S60 + Screws**

CODE.	RB56-0701-xxx508
PACK.	5   100 Set

COLOUR. pure white 069, black 050  
USE WITH. FT15 Motor

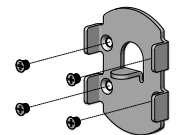

**AUTOMATE MOTOR HEAD PLATE | S60**

TYPE.	AUTOMATE
CODE.	RB56-0711-050509
PACK.	5   200 Pcs

COLOUR. black 050  
USE WITH. FT15 Motor & Adaptor Set

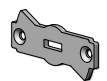

**FABRIC BRUSH T-SLOT FIT  
5mm High x 4.8mm Wide**

CODE.	SB91-0011-050500
PACK.	500   2000 Lm

COLOUR. black 050 only  
USE WITH. BOX Square 120 Back

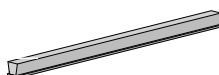

**AUTOMATE DRIVE WHEEL SET | S60**

TYPE.	Automate
CODE.	RB56-0105-050502
PACK.	5   250 Pcs

COLOUR. black satin 050  
USE WITH. FT15 Motor

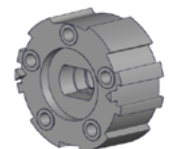

**AUTOMATE | ARC FT MOTOR**  
[Ø45/15Nm/15rpm] with Clip

TYPE.	AUTOMATE
CODE.	MT01-1145-050001
PACK.	1   10 Piece

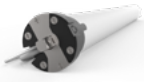

USE WITH. Crown & Drives

**RB10 TUBE ADAPTOR | S60**

TYPE.	60STD Tube	80HD Tube
CODE.	RB10-6000-069060	RB10-6000-050080
PACK.	5   200 Pcs	5   100 Pcs

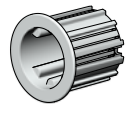

COLOUR. black 050, pure white 069  
USE WITH. Tubes, Reducers, Pre-tension Idler/Bearing Idler Head

**RB10 BEARING IDLER HEAD**

TYPE.	RB10
CODE.	RB10-6200-xxx001
PACK.	5   50 Piece

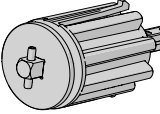

COLOUR. black 050, pure white 069  
USE WITH. RB10 Universal bracket adaptor

**RB10 IDLER UNIVERSAL BRACKET ADAPTOR | S60 + Screws**

TYPE.	RB10
CODE.	RB10-6400-050001
PACK.	5   100 Sets



COLOUR. black 050  
USE WITH. RB10 Idler/Booster Head, End Plate Set

**M50 CROWN WHEEL**

TYPE.	AUTOMATE
CODE.	RB56-0136-050508
PACK.	5   250 Piece



COLOUR. black 050 only  
USE WITH. AUTOMATE Motor, Zip Tube Reducer

**ALUMINIUM TUBE - S60 | 60STD**  
O.D 60.0mm x 5.8mt Length

TYPE.	No Tape	with D/S Tape
CODE.	RB91-0260-000580	RB91-6260-000580
PACK.	4   36 Lgths	4   36 Lgths

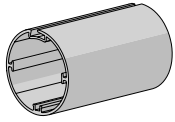

COLOUR. mill 000 only

**ZIP TUBE REDUCER | MEDIUM**  
Reducing from 60mm to 45mm

TYPE.	SB11
CODE.	SB11-0813-050360
PACK.	4   40 Pcs



COLOUR. black 050 only  
USE WITH. S60 Standard Tube, Motor Crown, Box 100

**ALUMINIUM TUBE - S60 | 80HD**  
O.D 80.0mm x 4.8mt & 5.8mt Length

SIZE.	4.8m - No Tape	5.8m - No Tape
CODE.	RB91-0280-000480	RB91-0280-000580
PACK.	2   20 Lgths	2   20 Lgths



COLOUR. mill 000 only  
USE WITH. Automate ARC FT motor

**ZIP TUBE REDUCER | LONG**  
Reducing from 80mm to 60mm

TYPE.	SB11
CODE.	SB11-0815-050580
PACK.	4   100 Pcs



COLOUR. black 050 only  
USE WITH. S60 | 80HD Tube, RB10 Tube Adaptor, Box 120

**9MM ACM FLAT SPLINE | WITH DOUBLE SIDED TAPE**

TYPE.	One Side
CODE.	RB92-0902-001075
PACK.	1   10 rolls



COLOUR. natural 001 only  
USE WITH. S60 Tube

**RB10 RETRO-FIT BOOSTER LH | S60**  
Extra Heavy Duty

TYPE.	LH
CODE.	RB10-6040-050051
PACK.	4   16 Set



COLOUR. black 050 only  
USE WITH. Aluminium Tube S60, RB10 Pre-Tension Idler

**MULTI-PURPOSE DOUBLE SIDED TAPE**  
50Lm Roll

TYPE.	8mm	18mm
CODE.	HD31-0401-001008	HD31-0401-001018
PACK.	1   48 rolls	1   24 rolls



COLOUR. natural clear 001 only  
USE WITH. S60 Tube, Flat Spline

**RB10 RETRO-FIT BOOSTER LH | S60**  
Short Spring

TYPE.	LH
CODE.	RB10-6040-050161
PACK.	4   16 Piece



COLOUR. black 050 only  
USE WITH. Aluminium Tube S60, RB10 Pre-Tension Idler

**Z-LOCK ZIP**

TYPE.	No.5	No.6
CODE.	SH91-0115-050400	SH91-0135-050200
PACK.	400   2000 Mts	200   400 Mts

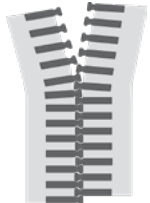

COLOUR. black 050  
USE WITH. Fabric, Inner Rail

**RB10 PRE-TENSION IDLER - LEFT HAND**

TYPE.	RB10
CODE.	RB10-6220-050001
PACK.	5   50 Piece

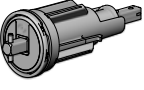

COLOUR. black 050 only  
USE WITH. RB10 Idler Head

**F72 HD EXTERNAL WEIGHT BAR**  
72mm x 31mm x 7m Length

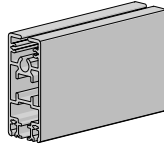

TYPE.	mill 000 only	nat anodised 018	see colour codes
CODE.	RE15-0112-000700	RE15-0112-018700	RE15-0112-xxx700-PF
PACK.	1   36 Lgths	1   36 Lgths	1   36 Lgths

COLOUR. black 050, pure white 069  
USE WITH. F72 multi-bar end cap set, F72 Multi-bar cord guide set

**ZIPSCREEN | U MOUNTING RAIL**

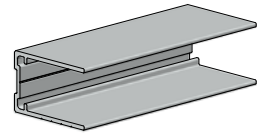

TYPE.	mill 000	anodised 018	Colours - refer below
CODE.	SB04-0702-000550	SB04-0702-018550	SB04-0702-xxx550
PACK.	10   120 Lgths	10   120 Lgths	10   120 Lgths

COLOUR. black 050, pure white 069  
USE WITH. Zip Inner Rail, End Bracket Plates

**F72 MULTI-BAR | END CAP SET**  
L/H & R/H + Screws

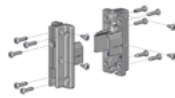

CODE.	RE15-0512-xxx000
PACK.	5   200

COLOUR. black 050, pure white 069  
USE WITH. F72 weight bar

**LIFT TAPE**



CODE.	SS95-6038-050500
PACK.	500 Metre Roll

COLOUR. black 050 only  
USE WITH. Cord Guide Set, Spool

**7.2MM SPLINE WITH 15MM TAIL**  
100m roll



CODE.	SB91-0408-001015
PACK.	1   10 Roll

COLOUR. clear 001  
USE WITH. F72 Weight bar

**SKYLIGHT ZIPSCREEN INNER RAIL END CAP + SCREW**



CODE.	SB05-1611-050001
PACK.	10   500 SET

COLOUR. black 050 only  
USE WITH. ZipScreen Inner Rail

**F72 MULTI-BAR | CORD GUIDE SET**

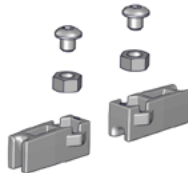

CODE.	RE15-0532-060000
PACK.	5   200 SET

COLOUR. natural white 060  
USE WITH. F72 weight bar, Lift Tape

**ZIPSCREEN | INNER RAIL FUNNEL & STOP SET + Screws**

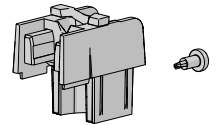

CODE.	SB05-1412-050001
PACK.	50   500 Sets

COLOUR. black 050  
USE WITH. ZipScreen inner rail

**ZIPSCREEN | INNER RAIL**

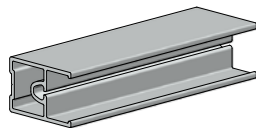

TYPE.	mill 000	anodised 018	Colours - refer below
CODE.	SB04-0701-000550	SB04-0701-018550	SB04-0701-xxx550
PACK.	10   120 Lgths	10   120 Lgths	10   120 Lgths

COLOUR. black 050, pure white 069  
USE WITH. U Mounting Rail

**SKYLIGHT TAPE SPOOL 9MM + Fixing Screw**



CODE.	SS48-1061-066090
PACK.	10   80 SET

COLOUR. off white 066 only  
USE WITH. lift tape, cord-braid, S60 | 60mm Tube